

PROFILE SURVEYED: _____ DATE: _____
 GRADES CHECKED: _____ BY: _____
 B.M. NOTED: _____
 NO. _____
 PROFILE NO. _____
 SURVEYED: _____ DATE: _____
 PLAN NOTE BOOK NO. _____
 SURVEYED: _____ DATE: _____
 ALIGNED CHECKED: _____
 IF OF WAY CHECKED: _____
 ROAD FILE NAME: _____

CHRISTOPHER B. BURKE ENGINEERING LTD.
 9575 West Higgins Road, Suite 600
 Rosemont, Illinois 60018
 (847) 823-0500

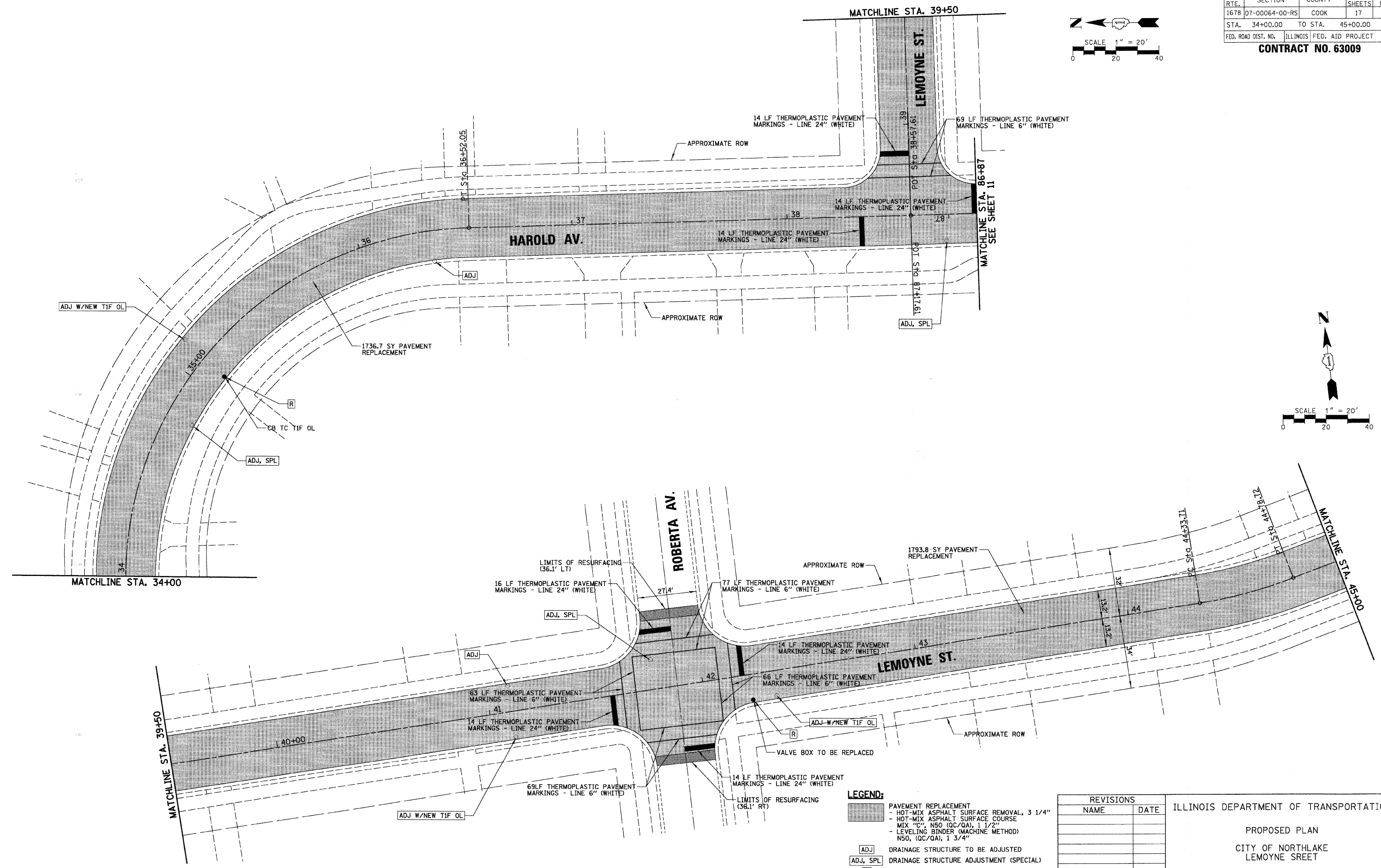

P.A. RTE.	SECTION	COUNTY	TOTAL SHEETS	SHEET NO.
1678	07-00064-00-RS	COOK	17	7
STA. 34+00.00		TO STA. 45+00.00		
FED. ROAD DIST. NO.		ILLINOIS FED. AID PROJECT		
CONTRACT NO. 63009				

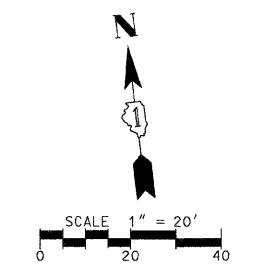
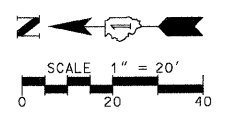

- LEGEND:**
- PAVEMENT REPLACEMENT
 - HOT-MIX ASPHALT SURFACE REMOVAL, 3 1/4"
 - HOT-MIX ASPHALT SURFACE COURSE
 MIX "C", N50 (QC/QA), 1 1/2"
 - LEVELING BINDER (MACHINE METHOD)
 N50, (QC/QA), 1 3/4"
 - DRAINAGE STRUCTURE TO BE ADJUSTED
 - DRAINAGE STRUCTURE ADJUSTMENT (SPECIAL)
 - DRAINAGE STRUCTURE TO BE REMOVED
 - HMA SURFACE REMOVAL - BUTT JOINT

REVISIONS	
NAME	DATE

ILLINOIS DEPARTMENT OF TRANSPORTATION
 PROPOSED PLAN
 CITY OF NORTHLAKE
 LEMOYNE SREET
 SCALE 1" = 20'
 DATE 1/2/2008
 DRAWN BY EDT
 CHECKED BY MW