

TRAFFIC SIGNAL LEGEND

PROPOSED		EXISTING		PROPOSED		EXISTING	
CONTROLLER CABINET SERVICE INSTALLATION			PEDESTRIAN PUSHBUTTON DETECTOR			DETECTOR LOOP	
SIGNAL HEAD			CAST IRON JUNCTION BOX			EMERGENCY VEHICLE LIGHT DETECTOR	
SIGNAL HEAD WITH BACKPLATE			CONFIRMATION BEACON			SIGNAL HEAD OPTICALLY PROGRAMMED	
SIGNAL HEAD, PEDESTRIAN			CONDUIT SPLICE			WOOD POLE	
SIGNAL POST			RACEWAY FOR MAGNETIC DETECTOR, TYPE I OR TYPE II			VEHICLE DETECTOR, NON COMPENSATED MAGNETIC TYPE	
MAST ARM ASSEMBLY AND POLE, STEEL			RAILROAD CONTROL CABINET			TELEPHONE CONNECTION	
MAST ARM ASSEMBLY AND POLE, ALUMINUM			ILLUMINATED SIGN "NO LEFT TURN"			ILLUMINATED SIGN "NO RIGHT TURN"	
COMBINATION MAST ARM ASSEMBLY AND POLE, STEEL WITH LUMINAIRE			UNINTERRUPTIBLE POWER SUPPLY			DOME CAMERA (PAN/TILT/ZOOM)	
UNIT DUCT			VEHICLE DETECTION CAMERA				
COMMON TRENCH							
HANDHOLE							
HEAVY DUTY HANDHOLE							
DOUBLE HANDHOLE							
G.S. CONDUIT IN TRENCH (T) OR PUSHED (P)							

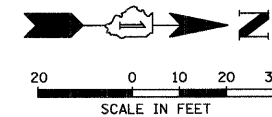

MATCH LINE STA. 154 + 50
(SEE SHEET NO. 27)

MATCH LINE STA. 160 + 50
(SEE SHEET NO. 27)

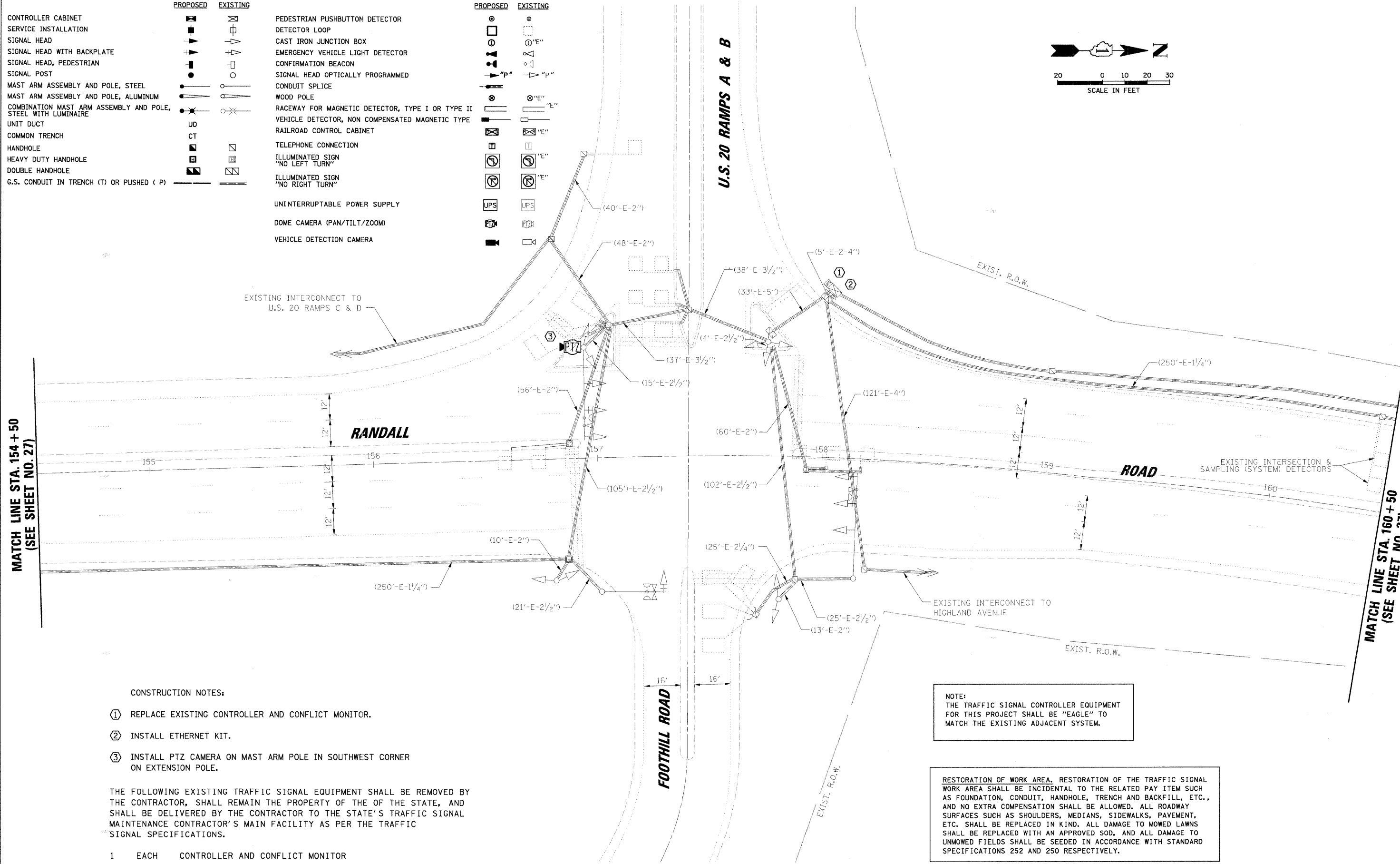

CONSTRUCTION NOTES:

- ① REPLACE EXISTING CONTROLLER AND CONFLICT MONITOR.
- ② INSTALL ETHERNET KIT.
- ③ INSTALL PTZ CAMERA ON MAST ARM POLE IN SOUTHWEST CORNER ON EXTENSION POLE.

THE FOLLOWING EXISTING TRAFFIC SIGNAL EQUIPMENT SHALL BE REMOVED BY THE CONTRACTOR, SHALL REMAIN THE PROPERTY OF THE OF THE STATE, AND SHALL BE DELIVERED BY THE CONTRACTOR TO THE STATE'S TRAFFIC SIGNAL MAINTENANCE CONTRACTOR'S MAIN FACILITY AS PER THE TRAFFIC SIGNAL SPECIFICATIONS.

- 1 EACH CONTROLLER AND CONFLICT MONITOR

NOTE:
THE TRAFFIC SIGNAL CONTROLLER EQUIPMENT FOR THIS PROJECT SHALL BE "EAGLE" TO MATCH THE EXISTING ADJACENT SYSTEM.

RESTORATION OF WORK AREA. RESTORATION OF THE TRAFFIC SIGNAL WORK AREA SHALL BE INCIDENTAL TO THE RELATED PAY ITEM SUCH AS FOUNDATION, CONDUIT, HANDHOLE, TRENCH AND BACKFILL, ETC., AND NO EXTRA COMPENSATION SHALL BE ALLOWED. ALL ROADWAY SURFACES SUCH AS SHOULDERS, MEDIANS, SIDEWALKS, PAVEMENT, ETC. SHALL BE REPLACED IN KIND. ALL DAMAGE TO MOWED LAWNS SHALL BE REPLACED WITH AN APPROVED SOD, AND ALL DAMAGE TO UNMOWED FIELDS SHALL BE SEED IN ACCORDANCE WITH STANDARD SPECIFICATIONS 252 AND 250 RESPECTIVELY.

FILE NAME =	USER NAME = MWILLIAM
N:\kansascity\0786161\7\offic\1001.20\wb.dgn	

DESIGNED -	REVISD -
DRAWN -	REVISD -
CHECKED -	REVISD -
DATE -	REVISD -

PLOT SCALE = 20'
PLOT DATE = 1/29/2008

DATE -

STATE OF ILLINOIS
DEPARTMENT OF TRANSPORTATION

TRAFFIC SIGNAL MODIFICATION PLAN
RANDALL ROAD AT U.S. 20 RAMPS A & B (FOOTHILL RD.)

SCALE:

F.A.P. RTE. 336	SECTION 06-00346-00-TL	COUNTY KANE	TOTAL SHEETS 69	SHEET NO. 26
FED. ROAD DIST. NO. ILLINOIS FED. AID PROJECT			CONTRACT NO. 63011	

DATE	BY	DATE	BY
DATE	BY	DATE	BY

SURVEYED
 GRADES CHECKED
 B.M. NOTED
 PRODUCE NOTATIONS OK'D

PLAN
 NOTE BOOK NO.
 ALIGNMENT CHECKED
 P.T. OF WAY CHECKED
 LONG FILE NAME

CHRISTOPHER B. BURKE ENGINEERING LTD.
 2515 West Higgins Road, Suite 600
 Elmhurst, Illinois 60120
 (847) 823-0500