

DATE: \_\_\_\_\_ BY: \_\_\_\_\_  
 SURVEYED: \_\_\_\_\_ GRADES CHECKED: \_\_\_\_\_  
 PLAN: \_\_\_\_\_ NOTE BOOK NO.: \_\_\_\_\_  
 SURVEYED: \_\_\_\_\_ GRADES CHECKED: \_\_\_\_\_  
 PROFILE: \_\_\_\_\_ NOTE BOOK NO.: \_\_\_\_\_  
 STRUCTURE NOTATIONS OK'D

**CHRISTOPHER B. BURKE ENGINEERING LTD.**  
 3575 West Higgins Road, Suite 600  
 Chicago, Illinois 60688  
 (847) 823-0500

**TRAFFIC SIGNAL LEGEND**

PROPOSED	EXISTING	PROPOSED	EXISTING

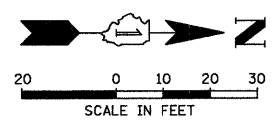

- CONSTRUCTION NOTES:**
- REPLACE EXISTING CONTROLLER AND CONFLICT MONITOR.
  - INSTALL ETHERNET KIT.
  - INSTALL UPS UNIT IN SIDE MOUNTED CABINET ATTACHED TO EXISTING TRAFFIC SIGNAL CABINET.
  - INSTALL PTZ CAMERA ON THE COMBINATION MAST ARM POLE IN THE NORTHWEST CORNER.

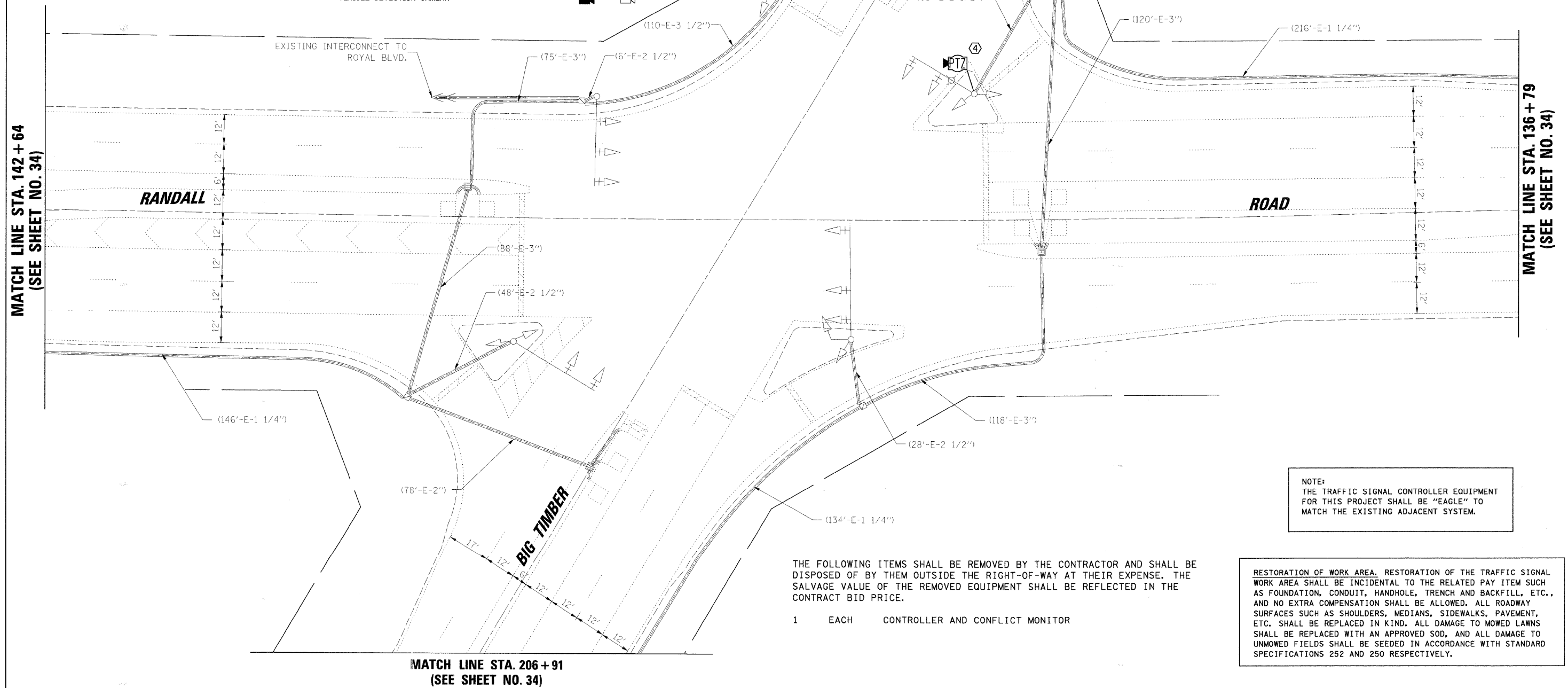

**NOTE:**  
 THE TRAFFIC SIGNAL CONTROLLER EQUIPMENT FOR THIS PROJECT SHALL BE "EAGLE" TO MATCH THE EXISTING ADJACENT SYSTEM.

THE FOLLOWING ITEMS SHALL BE REMOVED BY THE CONTRACTOR AND SHALL BE DISPOSED OF BY THEM OUTSIDE THE RIGHT-OF-WAY AT THEIR EXPENSE. THE SALVAGE VALUE OF THE REMOVED EQUIPMENT SHALL BE REFLECTED IN THE CONTRACT BID PRICE.

- 1 EACH CONTROLLER AND CONFLICT MONITOR

**RESTORATION OF WORK AREA.** RESTORATION OF THE TRAFFIC SIGNAL WORK AREA SHALL BE INCIDENTAL TO THE RELATED PAY ITEM SUCH AS FOUNDATION, CONDUIT, HANDHOLE, TRENCH AND BACKFILL, ETC., AND NO EXTRA COMPENSATION SHALL BE ALLOWED. ALL ROADWAY SURFACES SUCH AS SHOULDERS, MEDIANS, SIDEWALKS, PAVEMENT, ETC. SHALL BE REPLACED IN KIND. ALL DAMAGE TO MOWED LAWNS SHALL BE REPLACED WITH AN APPROVED SOD, AND ALL DAMAGE TO UNMOWED FIELDS SHALL BE SEEDED IN ACCORDANCE WITH STANDARD SPECIFICATIONS 252 AND 250 RESPECTIVELY.

FILE NAME = N:\kane\county\078616\Traffic\MOD1_BigTimber.dwg	USER NAME = M\WILLIAM	DESIGNED -	REVISED -	<b>STATE OF ILLINOIS DEPARTMENT OF TRANSPORTATION</b>	<b>TRAFFIC SIGNAL MODIFICATION PLAN</b> RANDALL ROAD AT BIG TIMBER ROAD	F.A.P. RTE. 336	SECTION 06-00346-00-TL	COUNTY KANE	TOTAL SHEETS 69	SHEET NO. 33
PLOT SCALE = 20'	CHECKED -	REVISED -	CONTRACT NO. 63011							
PLOT DATE = 1/29/2008	DATE -	REVISED -	FED. ROAD DIST. NO. ILLINOIS FED. AID PROJECT							
SCALE:										