

PROFILE SURVEYED \_\_\_\_\_ DATE \_\_\_\_\_  
 GRADES CHECKED \_\_\_\_\_  
 NOTE BOOK NO. \_\_\_\_\_  
 STRUCTURE NOTATIONS CHECKED \_\_\_\_\_  
 PLAN SURVEYED \_\_\_\_\_ DATE \_\_\_\_\_  
 NOTE BOOK NO. \_\_\_\_\_  
 ALIGNMENT CHECKED \_\_\_\_\_  
 RT. OF WAY CHECKED \_\_\_\_\_  
 ROAD FILE NAME \_\_\_\_\_

**CHRISTOPHER B. BURKE ENGINEERING LTD.**  
 315 S. West Higgins Road, Suite 600  
 Bloomington, IL 61810  
 (847) 823-0500

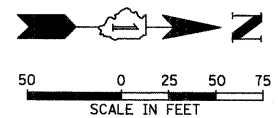
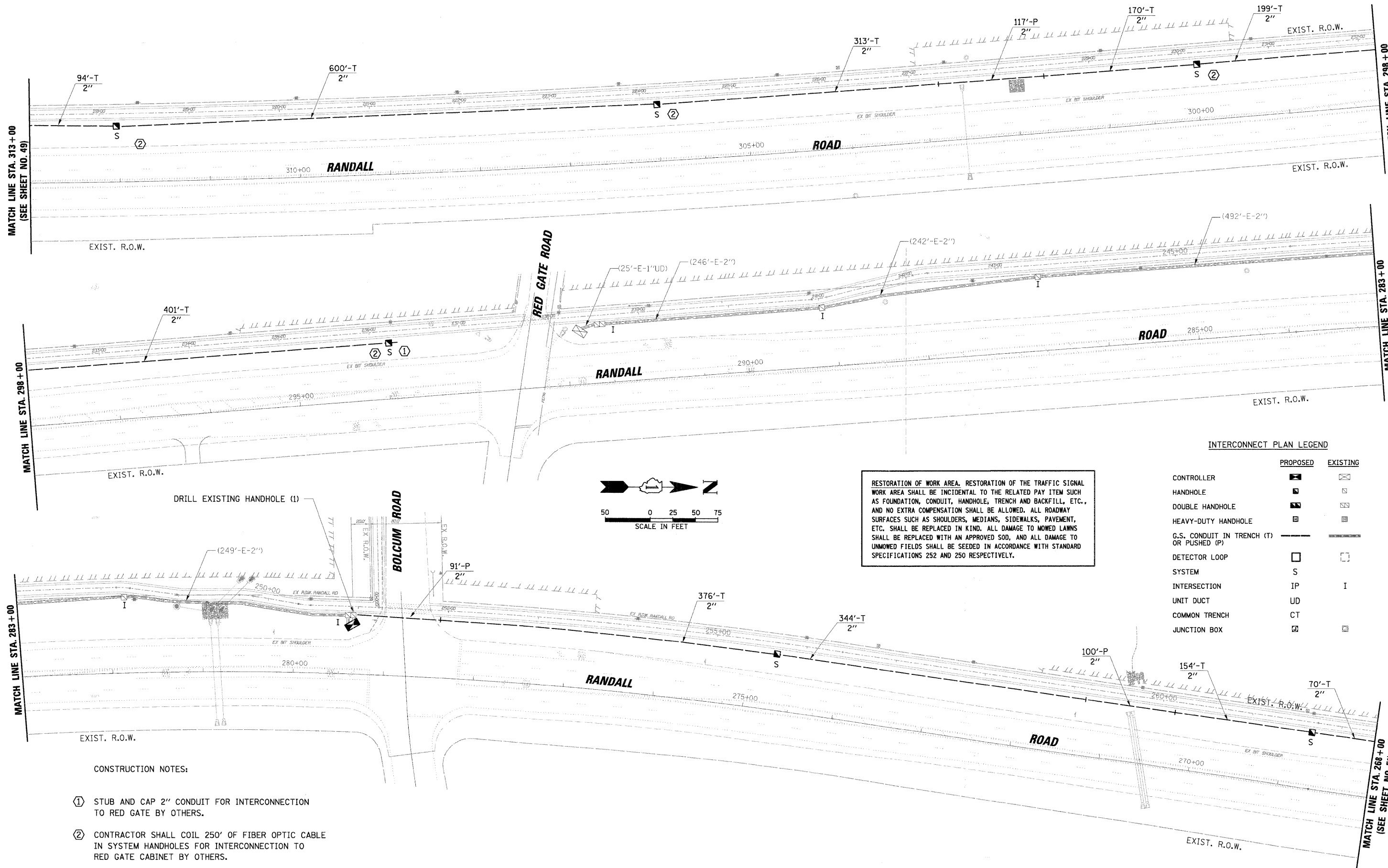

RESTORATION OF WORK AREA, RESTORATION OF THE TRAFFIC SIGNAL WORK AREA SHALL BE INCIDENTAL TO THE RELATED PAY ITEM SUCH AS FOUNDATION, CONDUIT, HANDHOLE, TRENCH AND BACKFILL, ETC., AND NO EXTRA COMPENSATION SHALL BE ALLOWED. ALL ROADWAY SURFACES SUCH AS SHOULDERS, MEDIANS, SIDEWALKS, PAVEMENT, ETC. SHALL BE REPLACED IN KIND. ALL DAMAGE TO MOWED LAWNS SHALL BE REPLACED WITH AN APPROVED SOO, AND ALL DAMAGE TO UNMOWED FIELDS SHALL BE SEEDED IN ACCORDANCE WITH STANDARD SPECIFICATIONS 252 AND 250 RESPECTIVELY.

**INTERCONNECT PLAN LEGEND**

	PROPOSED	EXISTING
CONTROLLER		
HANDHOLE		
DOUBLE HANDHOLE		
HEAVY-DUTY HANDHOLE		
G.S. CONDUIT IN TRENCH (T) OR PUSHED (P)		
DETECTOR LOOP		
SYSTEM	S	
INTERSECTION	IP	I
UNIT DUCT	UD	
COMMON TRENCH	CT	
JUNCTION BOX		

**CONSTRUCTION NOTES:**

- ① STUB AND CAP 2" CONDUIT FOR INTERCONNECTION TO RED GATE BY OTHERS.
- ② CONTRACTOR SHALL COIL 250' OF FIBER OPTIC CABLE IN SYSTEM HANDHOLES FOR INTERCONNECTION TO RED GATE CABINET BY OTHERS.

FILE NAME = N:\kanecounty\078615\Traffic\INT3_078615.dgn	USER NAME = MWILLIAM	DESIGNED -	REVISED -
		DRAWN -	REVISED -
		CHECKED -	REVISED -
		DATE -	REVISED -

**STATE OF ILLINOIS**  
**DEPARTMENT OF TRANSPORTATION**

<b>INTERCONNECT PLAN</b>		F.A.P. RTE. 336	SECTION 06-00346-00-TL	COUNTY KANE	TOTAL SHEETS 69	SHEET NO. 50
RANDALL ROAD RED HAW LANE TO SILVER GLEN ROAD		CONTRACT NO. 63011				
SCALE: 1" = 50'		FED. ROAD DIST. NO. ILLINOIS FED. AID PROJECT				