

F.A.U. RTE.	SECTION	COUNTY	TOTAL SHEETS	SHEET NO.
1248	99-00080-00-BR	LAKE	46	39
STA.	TO STA.			
FED. ROAD DIST. NO.	ILLINOIS	FED. AID PROJECT		

Sheet S-27 of S-29 **63020**

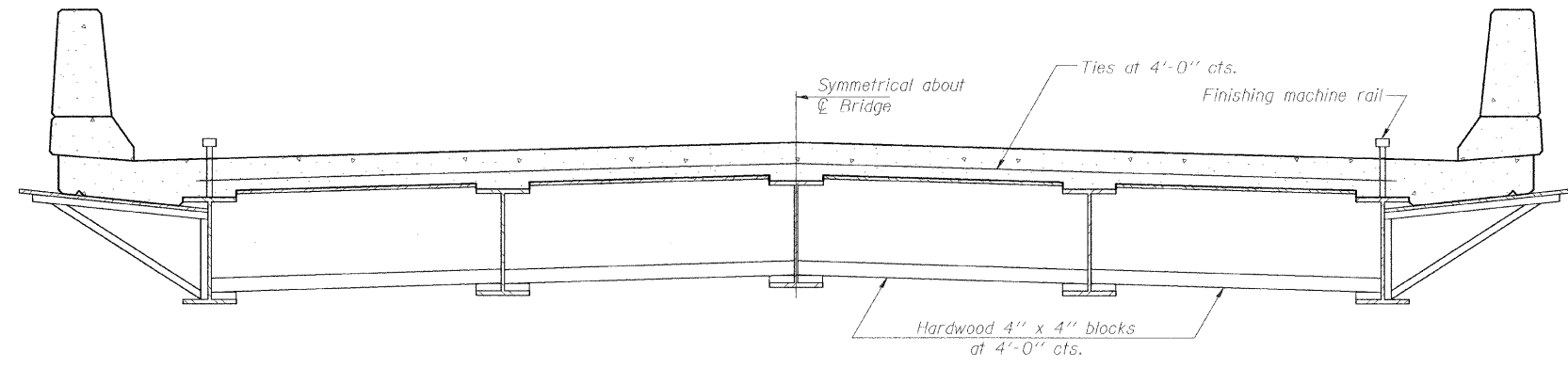

FORM BRACES FOR
STANDARD CONSTRUCTION

When cantilever forming brackets are used, the work shall be done according to Article 503.06, except as modified below and in the details shown on this sheet.
 The finishing machine rails shall be placed on the top flange of the exterior beams.
 The beams or girders, supporting cantilever forming brackets, shall be tied together at 4 foot intervals.
 For Standard construction, or Stage Construction the Hardwood bracing materials shall be placed as shown between webs of beams in each bay.

CANTILEVER FORMING BRACKETS
FOR SUPERSTRUCTURES WITH
W27 BEAMS AND SMALLER

DATE: 2/5/2008 FILENAME: p:\2006\2301-2400\2006.2324-nanderson-old elm design\microstation-final\s-27.dgn

SB-1 11-1-06

WJE *Wiss, Janney, Elstner Associates, Inc.*
 Engineers, Architects, Material Scientists
 330 Pfingsten Road, Northbrook, IL 60062
 (847) 272-7400, Fax: (847) 291-4813
 WJE No. 2006.2324

**THE CITY OF
LAKE FOREST**
 CHARTERED 1861

ILLINOIS DEPARTMENT OF TRANSPORTATION
 BUREAU OF LOCAL ROADS AND STREETS

PROJECT:
OLD ELM ROAD OVER EAST SKOKIE DITCH
 STA. 187+46 LAKE COUNTY
 STRUCTURE NO. 049-6870

TITLE:
CANTILEVER FORMING BRACKET

SCALE: N.T.S. DRAWN BY: IMG
 DATE: JANUARY 2008 CHECKED BY: NSA

△				
△				
△				
△				
△				
△				
REV. NO.	DATE	REVISION RECORD	MADE BY	CHECKED BY