

F.A.P. RTE.	SECTION	COUNTY	TOTAL SHEETS	SHEET NO.
638	136T	HENRY	34	14
STA.	TO STA.			
FED. ROAD DIST. NO.	ILLINOIS		FED. AID PROJECT	

DATE	
BY	
REVIEWED	
DATE	
BY	
PLAN	
NO.	
NOTE BOOK	
NO.	
DATE	
BY	
REVIEWED	
DATE	
BY	
PROFILE	
NO.	
NOTE BOOK	
NO.	

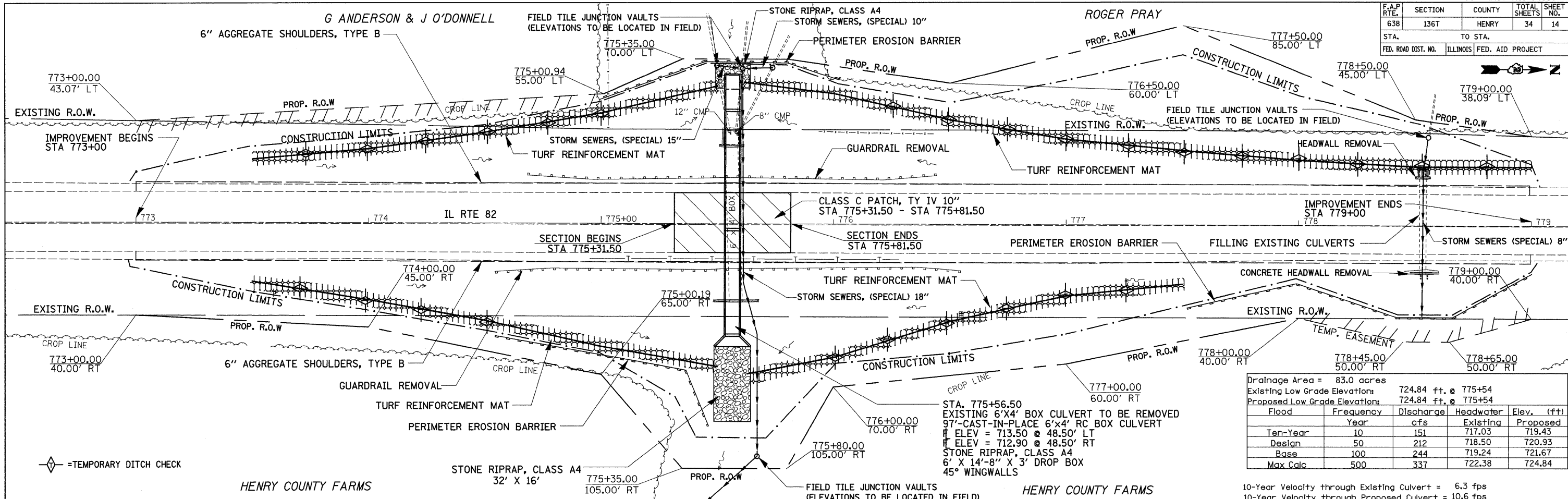

Drainage Area = 83.0 acres
 Existing Low Grade Elevation: 724.84 ft. @ 775+54
 Proposed Low Grade Elevation: 724.84 ft. @ 775+54

Flood Year	Frequency	Discharge cfs	Headwater Existing	Headwater Proposed	Elev. (ft)
Ten-Year	10	151	717.03	719.43	
Design	50	212	718.50	720.93	
Base	100	244	719.24	721.67	
Max Calc	500	337	722.38	724.84	

10-Year Velocity through Existing Culvert = 6.3 fps
 10-Year Velocity through Proposed Culvert = 10.6 fps

DATE	
BY	
REVIEWED	
DATE	
BY	
PROFILE	
NO.	
NOTE BOOK	
NO.	

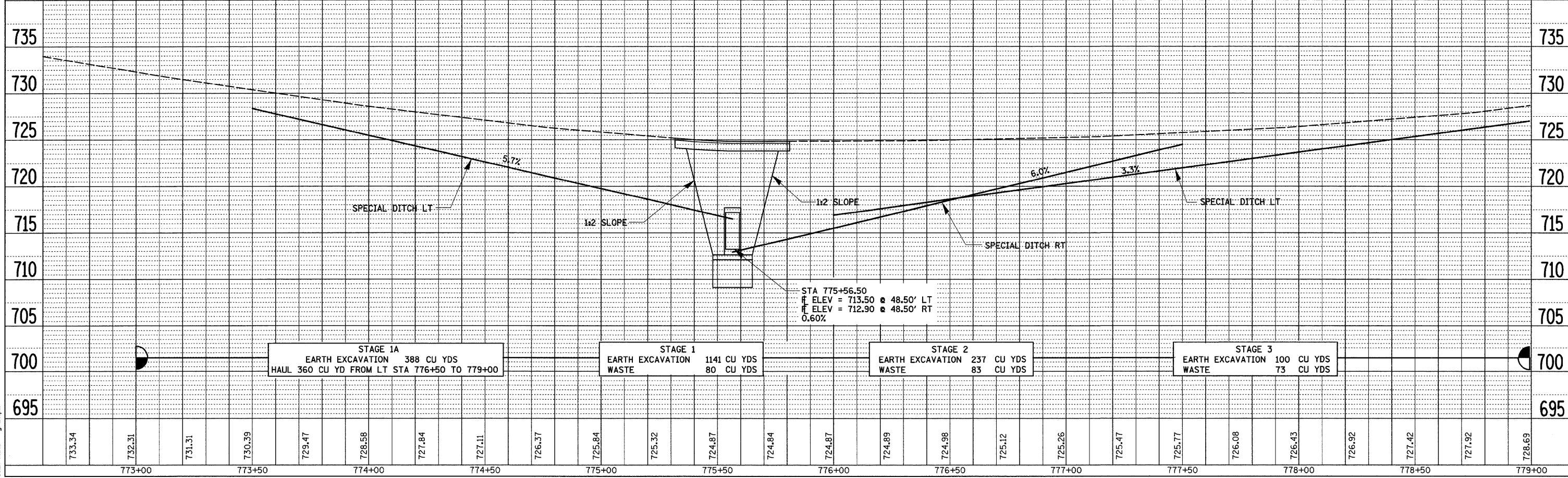

PLOT DATE = Tue Jan 29 11:46:43 2008
 FILE NAME = c:\proje\638\136T\136T136T.dwg
 PLOT SCALE = 2:1 (7/5' / 1")
 USER NAME = gremson