

STATE OF ILLINOIS
DEPARTMENT OF TRANSPORTATION

ROUTE NO.	SECTION	COUNTY	TOTAL SHEETS	SHEET NO.	SHEET NO. 2 4 SHEETS
U.S. 20	6B/M	WINNEBAGO COUNTY	13	4	
FED. ROAD DIST. NO. 7	ILLINOIS	FED. AID PROJECT-			
CONTRACT # 64D74					

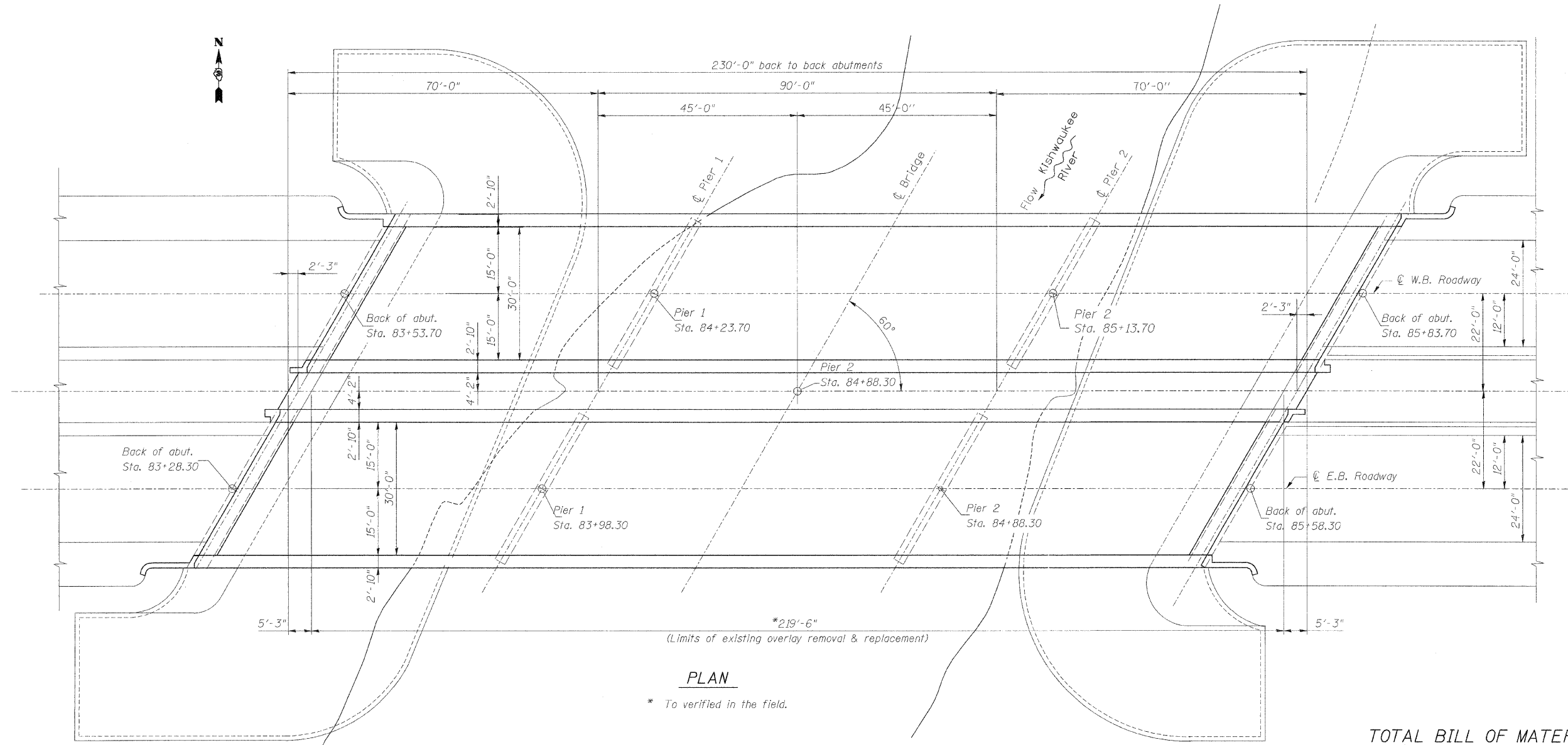

TOTAL BILL OF MATERIAL

ITEM	UNIT	QUANTITY
Bridge Deck Hydrosarcification, 2 1/4"	Sq. Yd.	1,463
Bridge Deck Latex Concrete Overlay, 2 1/4"	Sq. Yd.	1,463
Cleaning And Painting Existing Bearings	Each	24
Deck Slab Repair (Full Depth, Type I)	Sq. Yd.	8
Bridge Deck Grooving	Sq. Yd.	732
Deck Slab Repair (Partial) (For Information Only)	Sq. Yd.	149

Notes:
1. "Cleaning & Painting existing bearing" is only for abutments. There are 24 bearings altogether located at east & west abutments of Str. # 101-0073 & 101-0074.
See Special Provision "Cleaning & Painting Existing Steel Structures"

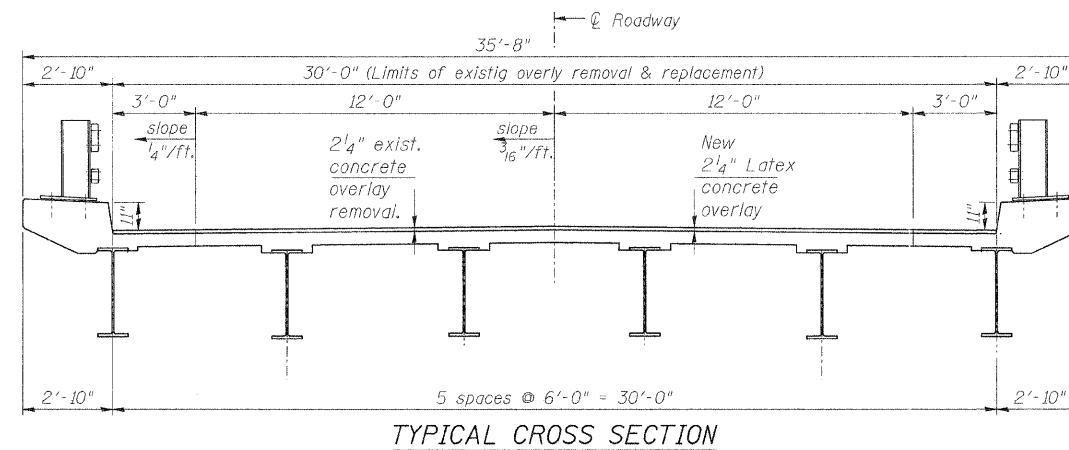
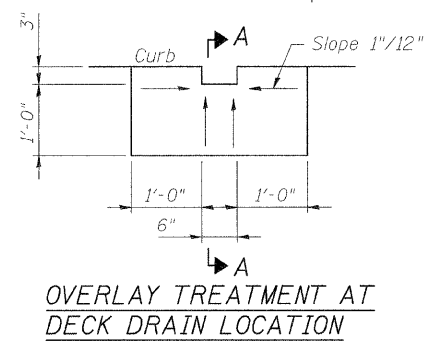

Note: 2 1/4" existing concrete overlay shall be removed and replaced with 2 1/4" Latex concrete overlay.

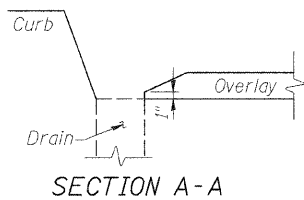

DESIGNED	M.R./M.A.
CHECKED	M.S./H.T.
DRAWN	R.K./M.A.
CHECKED	M.S./H.T./M.R.

EXISTING PLAN & CROSS SECTION
TOTAL BILL OF MATERIAL
US 20 OVER KISHWAUKEE RIVER
FAP ROUTE 525 (US20), SECTION (6B/M)
WINNEBAGO COUNTY
STATION 84+88.30
STRUCTURE NO. 101-0073 & 101-0074

SCALE: NONE DATE: JANUARY, 2008
Soodan Soodan & Associates, Inc.
100 North LaSalle Street, Suite 1800
Chicago, Illinois 60602