

F.A.P. RTE.	SECTION	COUNTY	TOTAL SHEETS	SHEET NO.
326	(111)I-4	GRUNDY	6	1
FED. ROAD DIST. NO. -	ILLINOIS	CONTRACT NO. 66771		

D-93-041-08

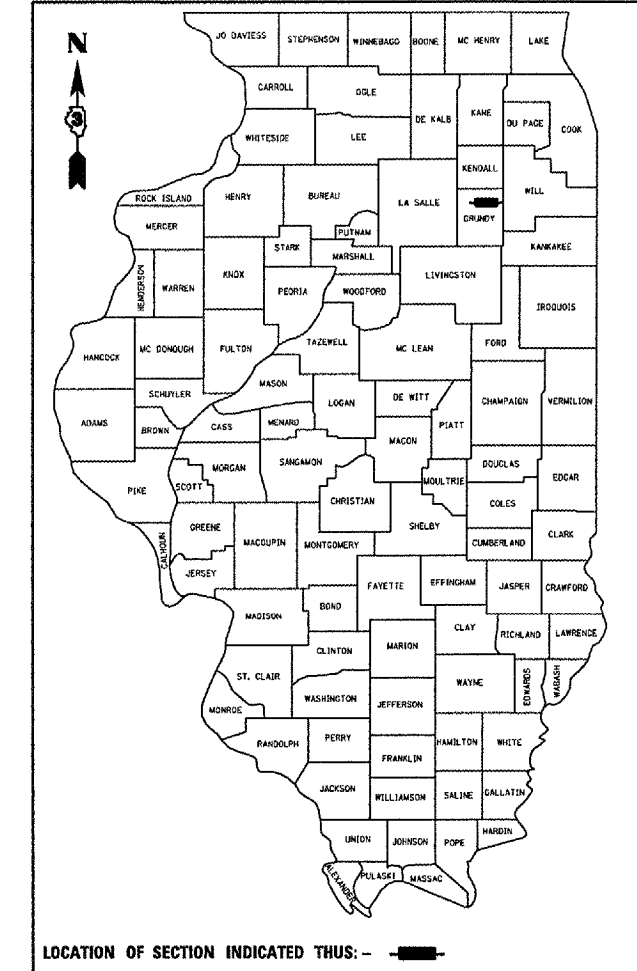

FUNCTIONAL CLASSIFICATION
 URBAN: OTHER PRINCIPAL ARTERIAL
 FAP ROUTE 326 (IL ROUTE 47)
 2005 ADT = 19200
 P.V = 87.0% M.U. = 5.5% S.U. = 7.5%

STATE OF ILLINOIS
 DEPARTMENT OF TRANSPORTATION
 DIVISION OF HIGHWAYS

SUBMITTED 2/15 2008
George Ryan
 DEPUTY DIRECTOR OF HIGHWAYS, REGION ENGINEER

March 21, 2008
Eric E. Harrell
 ENGINEER OF DESIGN AND ENVIRONMENT

March 21, 2008
Christine M. Reed
 DIRECTOR OF HIGHWAYS, CHIEF ENGINEER

**PRINTED BY THE AUTHORITY
 OF THE STATE OF ILLINOIS**

STATE OF ILLINOIS
 DEPARTMENT OF TRANSPORTATION
 DIVISION OF HIGHWAYS

**PROPOSED
 HIGHWAY PLANS**

F.A.P. ROUTE 326 (IL ROUTE 47)
 SECTION (111)I-4

**GRUNDY COUNTY
 WETLAND MAINTENANCE**
 C-93-068-08

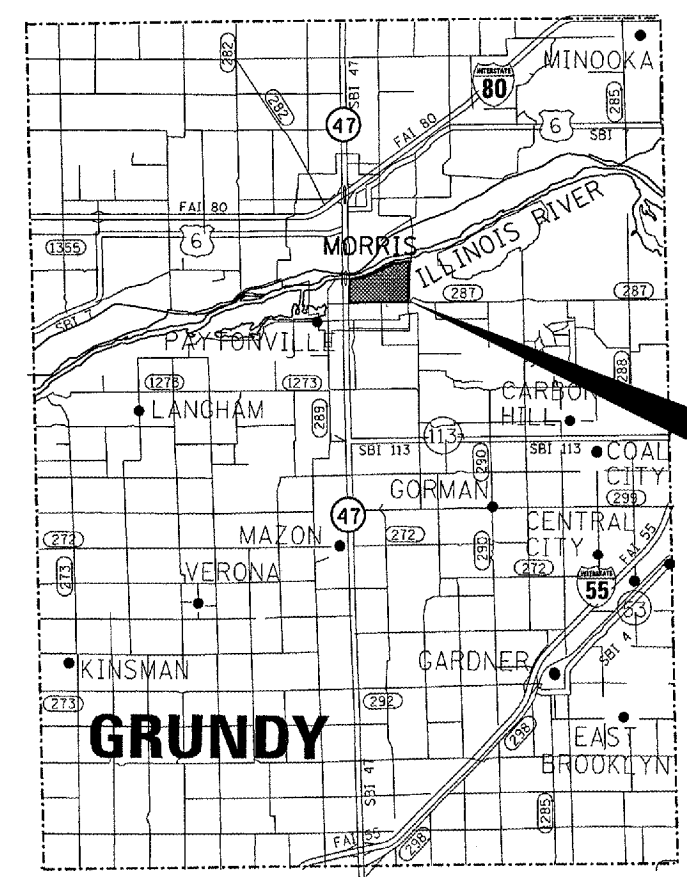

LOCATION MAP
 NOT TO SCALE

INDEX OF SHEETS

1. COVER SHEET
2. GENERAL NOTES
3. SUMMARY OF QUANTITIES
4. SCHEDULES
5. TYPICAL MOWING PATTERN
6. WETLAND MITIGATION SITE MAP

STANDARDS

- 000001-05 STANDARD SYMBOLS, ABBREVIATIONS AND PATTERNS
- 701101-01 OFF-ROAD OPERATIONS MULTILANE,
 4.5 m (15') TO 600 mm (24") FROM
 PAVEMENT EDGE
- 701106-01 OFF-ROAD OPERATIONS, MULTILANE,
 MORE THAN 4.5 m (15') AWAY
- 701901 TRAFFIC CONTROL DEVICES

MICROFILMED _____
 REEL NUMBER _____
 AWARDED _____
 RESIDENT ENGINEER _____
 AS BUILT CHANGES WERE MADE
 ON THE FOLLOWING SHEETS _____

J.U.L.I.E.
 JOINT UTILITY LOCATION INFORMATION FOR EXCAVATION
 1-800-892-0123

DISTRICT 3 NO. (815) 434-6131

**PROJECT ENGINEER: JOE KANNEL
 UNIT CHIEF: RON WOODSHANK**

CONTRACT NO. 66771

GENERAL NOTES

THE CONTRACTOR SHALL BE RESPONSIBLE FOR PROTECTING UTILITY PROPERTY FROM CONSTRUCTION OPERATIONS AS OUTLINED IN ARTICLE 107.31 OF THE STANDARD SPECIFICATIONS. THE "JULIE" NUMBER IS 1-800-892-0123. A MINIMUM OF FORTY-EIGHT (48) HOURS ADVANCE NOTICE IS REQUIRED.

WHERE SECTION OR SUBSECTION MONUMENTS ARE ENCOUNTERED, THE ENGINEER SHALL BE NOTIFIED BEFORE SUCH MONUMENTS ARE REMOVED. THE CONTRACTOR SHALL PROTECT AND CAREFULLY PRESERVE ALL MONUMENTS UNTIL AN AUTHORIZED SURVEYOR OR AGENT HAS WITNESSED OR OTHERWISE REFERENCED THEIR LOCATION. THE CONTRACTOR SHALL BE RESPONSIBLE FOR HAVING AN AUTHORIZED SURVEYOR REESTABLISH ANY SECTION OR SUBSECTION MONUMENTS DESTROYED BY HIS OPERATIONS.

ABANDONED UNDERGROUND UTILITIES THAT CONFLICT WITH CONSTRUCTION SHALL BE DISPOSED OF OUTSIDE THE LIMITS OF THE RIGHT OF WAY ACCORDING TO ARTICLE 202.03 OF THE STANDARD SPECIFICATIONS AND AS DIRECTED BY THE ENGINEER.

ANY REFERENCE TO A STANDARD IN THESE PLANS SHALL BE INTERPRETED TO MEAN THE EDITION AS INDICATED BY THE SUBNUMBER LISTED ON THE INDEX OF SHEETS OR THE COPY OF THE STANDARD INCLUDED IN THESE PLANS.

DATE: 2/11/08

PREPARED BY: Re Paul
DISTRICT STUDIES & PLANS ENGINEER

EXAMINED BY: Herb Jung
DISTRICT CONSTRUCTION ENGINEER

James R. Threadgill III
DISTRICT MATERIALS ENGINEER

James A. Husler
DISTRICT OPERATIONS ENGINEER

FILE NAME =	USER NAME = vrsingerjr	DESIGNED - RON WOODSHANK	REVISED -
c:\projects\wetland restoration fg00\dep\11s.dgn		DRAWN - RON WOODSHANK	REVISED -
	PLOT SCALE = 1/8" = 1'-0"	CHECKED -	REVISED -
	PLOT DATE = Feb 11, 2008 - 11:10:04 AM	DATE -	REVISED -

**STATE OF ILLINOIS
DEPARTMENT OF TRANSPORTATION**

GENERAL NOTES

SCALE: _____ SHEET NO. 1 OF 1 SHEETS

F.A.P. RTE.	SECTION	COUNTY	TOTAL SHEETS	SHEET NO.
326	(1111)-4	GRUNDY	6	2
FED. ROAD DIST. NO. - ILLINOIS			CONTRACT NO. 66771	

SUMMARY OF QUANTITIES

CONSTRUCTION CODE TYPE:

Y003

URBAN
100% STATE
TOTAL
QUANTITY

CODE NO.	ITEM	UNIT	TOTAL QUANTITY
67100100	MOBILIZATION	L SUM	1
A2C010G3	TREE, ASIMINA TRILOBA (PAW PAW), CONTAINER GROWN, 3-GALLON	EACH	107
A2C035G3	TREE, JUGLANS NIGRA (BLACK WALNUT), CONTAINER GROWN, 3-GALLON	EACH	47
A2C040G3	TREE, PLATANUS OCCIDENTALIS (SYCAMORE), CONTAINER GROWN, 3-GALLON	EACH	106
A2C050G3	TREE, QUERCUS BICOLOR (SWAMP WHITE OAK), CONTAINER GROWN, 3-GALLON	EACH	106
A2C056G3	TREE, QUERCUS MACROCARPA (BURR OAK), CONTAINER GROWN, 3-GALLON	EACH	107
A2C060G3	TREE, QUERCUS PALUSTRIS (PIN OAK), CONTAINER GROWN, 3-GALLON	EACH	107
K1003660	MOWING CYCLES	EACH	2

TREE PLANTING SCHEDULE			
LOCATION SITE	TREE, ASIMINA TRILOBA (PAW PAW) CONTAINER GROWN 3 GALLON	TREE, JUGLANS NIGRA (BLACK WALNUT) CONTAINER GROWN 3 GALLON	TREE, PLATANUS OCCIDENTALIS (SYCAMORE) CONTAINER GROWN 3 GALLON
	EACH	EACH	EACH
D	3	2	2
E	15	10	15
F	7	5	7
H	25	25	25
J	9	5	9
K	48		48
TOTAL	107	47	106

TREE PLANTING SCHEDULE			
LOCATION SITE	TREE, QUERCUS BICOLOR (SWAMP WHITE OAK) CONTAINER GROWN 3 GALLON	TREE, QUERCUS MACROCARPA (BUR OAK) CONTAINER GROWN 3 GALLON	TREE, QUERCUS PALUSTRIS (PIN OAK) CONTAINER GROWN 3 GALLON
	EACH	EACH	EACH
D	2	3	3
E	15	15	15
F	7	7	7
H	25	25	25
J	9	9	9
K	48	48	48
TOTAL	106	107	107

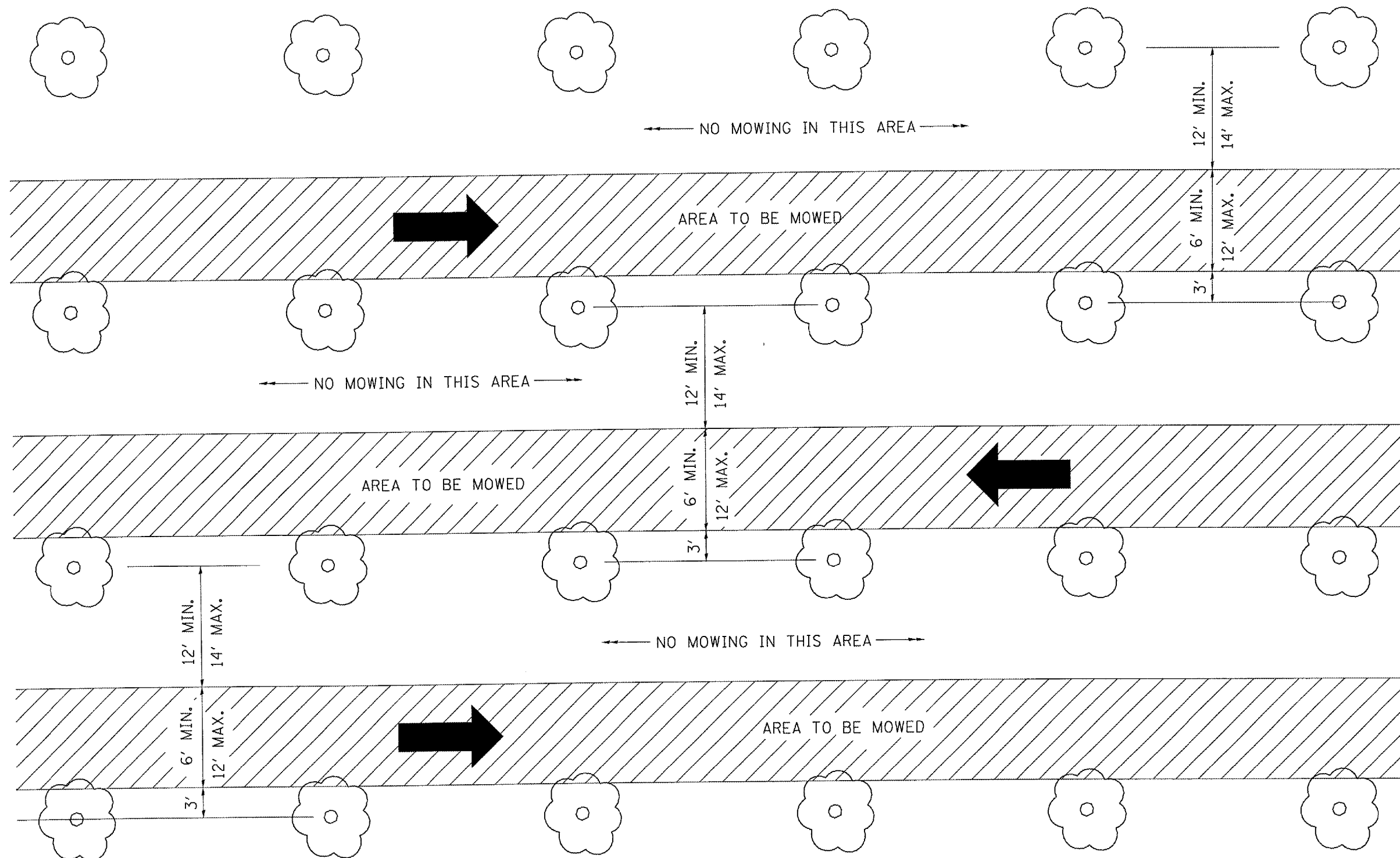



NOTE: VEGETATION SHALL BE MOWED IN A NORTH/SOUTH OR EAST/WEST PATTERN. AREAS SHALL BE MOWED IN "ONE" DIRECTION ONLY AND MOWED PATHS SHALL BE PARALLEL.

CROSS MOWING WILL NOT BE PERMITTED.

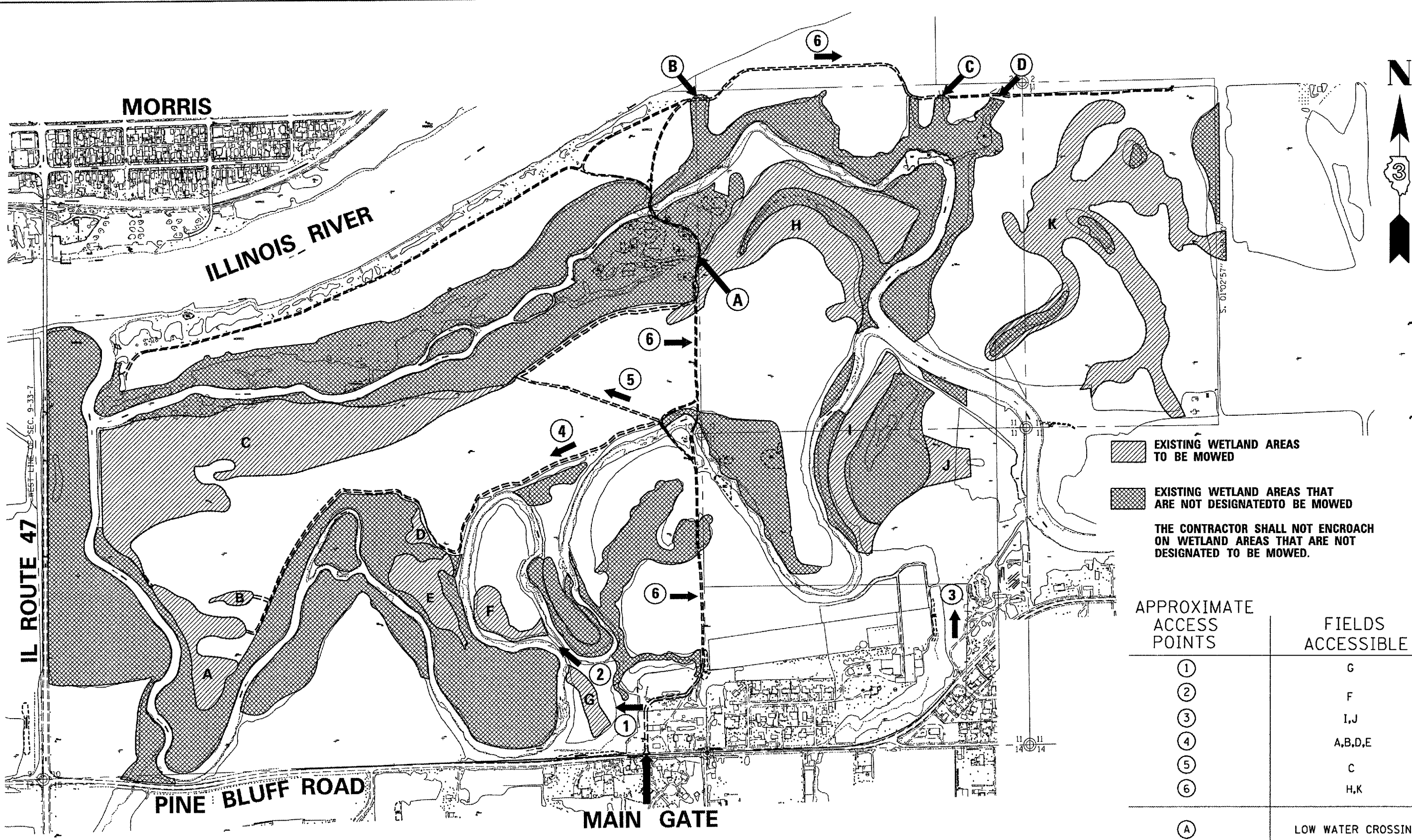
FILE NAME =	USER NAME = woodshankr1	DESIGNED - RON WOODSHANK	REVISED -	STATE OF ILLINOIS DEPARTMENT OF TRANSPORTATION	TYPICAL MOWING PATTERN	F.A.P. RTE.	SECTION	COUNTY	TOTAL SHEETS	SHEET NO.
c:\projects\wetland restoration fy08\de	all.dgn	DRAWN - RON WOODSHANK	REVISED -			326	(1111)-4	GRUNDY	6	5
PLLOT SCALE = 1/8" = 1' / IN.	CHECKED -	REVISED -	REVISED -			CONTRACT NO. 66771				
PLLOT DATE = Feb 13, 2008 - 06:57:51 AM	DATE -	REVISED -	REVISED -			FED. ROAD DIST. NO. - ILLINOIS				



 EXISTING WETLAND AREAS TO BE MOWED
 EXISTING WETLAND AREAS THAT ARE NOT DESIGNATED TO BE MOWED
 THE CONTRACTOR SHALL NOT ENCROACH ON WETLAND AREAS THAT ARE NOT DESIGNATED TO BE MOWED.

APPROXIMATE ACCESS POINTS	FIELDS ACCESSIBLE
①	G
②	F
③	I, J
④	A, B, D, E
⑤	C
⑥	H, K
A	LOW WATER CROSSING
B	LOW WATER CROSSING
C	LOW WATER CROSSING
D	LOW WATER CROSSING

NOTES:
 1. ACCESS POINTS ARE APPROXIMATE. FIELD CONDITIONS WILL DETERMINE EXACT LOCATIONS.

LEGEND
 ===== EXISTING ACCESS LANES