

F.A.P. RTE.	SECTION	COUNTY	TOTAL SHEETS	SHEET NO.
318	(218-11), (20811-1)	PUTNAM	25	9
STA. *		TO STA. *		
FED. ROAD DIST. NO. 4		ILLINOIS FED. AID PROJECT		
* 078-0003 @ Sta. 126+97.50				

B.M. - USC&GS T232, disk on top of North abutment of RR. structure,
West of track, Sta. 113+50 Rt. Elev. 473.592
Structure rehabilitated and widened to 43'-2" O. to O. of deck in 1989.

T14N- R10E- 4th P.M.
SEC. 18

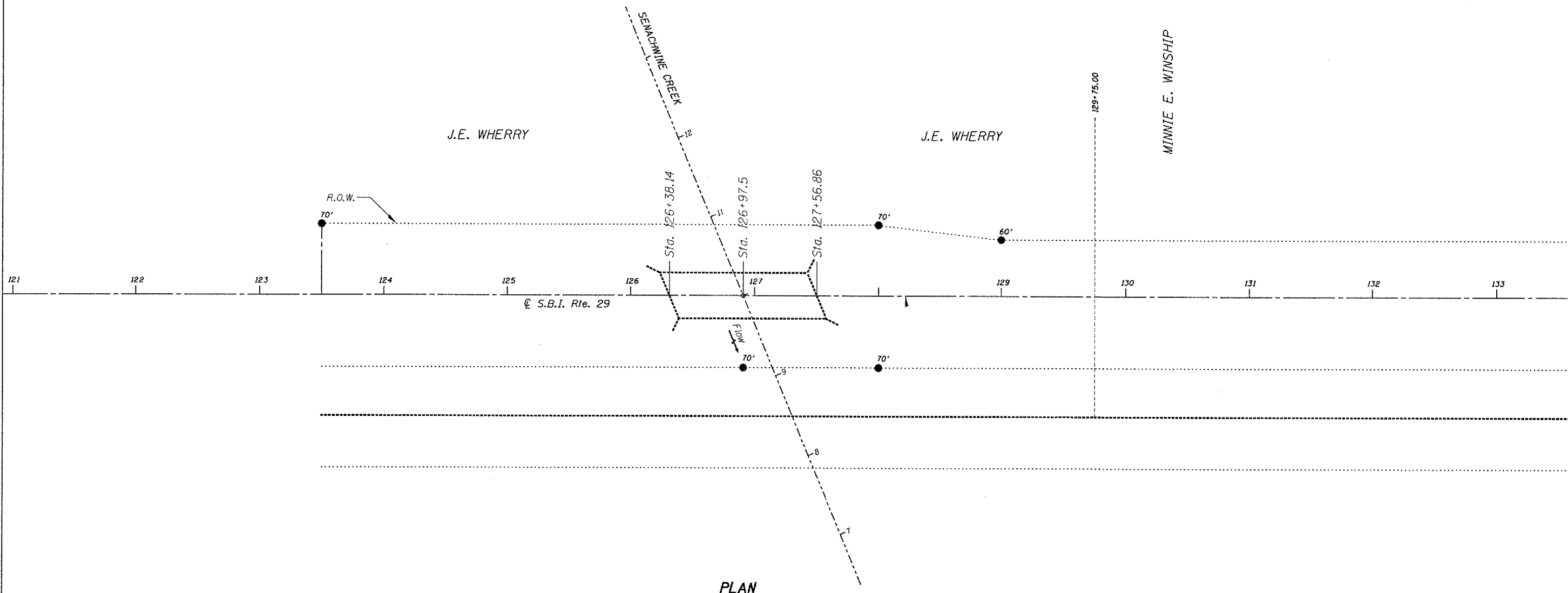

PLOT DATE : #DATE#
 FILE NAME : #FILE#
 PLOT SCALE : #SCALE#
 REFERENCE : #REF#

SN.078-0003, IL.29
over Senachwine Crk.

REVISIONS	
NAME	DATE

ILLINOIS DEPARTMENT OF TRANSPORTATION

GENERAL LAYOUT

SCALE: VERT.
HORIZ.
DATE 01-30-2008

DRAWN BY CEJ
CHECKED BY