

F.A.P. RTE.	SECTION	COUNTY	TOTAL SHEETS	SHEET NO.
318	(218-11,20BRI-1)	PUTNAM	25	10
STA. *		TO STA. *		
FED. ROAD DIST. NO. 4		ILLINOIS FED. AID PROJECT		
• 078-0003 @ Sta. 126+97.50				

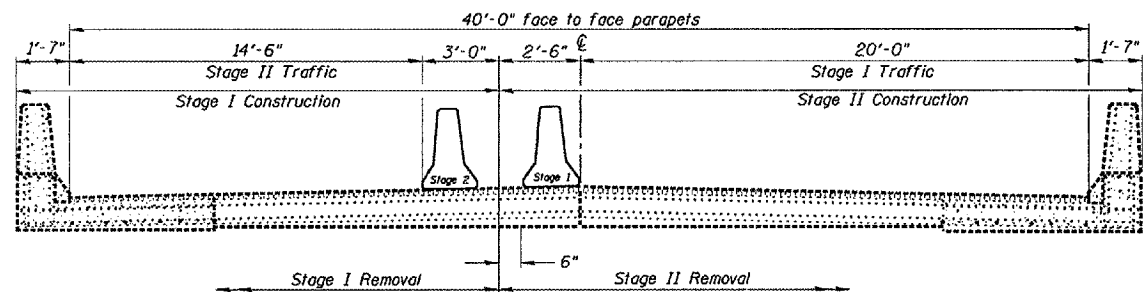

CROSS SECTION
(Looking North)

SN.078-0003 SIGNING

LOCATION	SIGN -A-	SIGN -B-
IL.18/IL.29	2 EA.	NA
I-180/IL.29	1 EA.	
IL.71/IL.29	1 EA.	

CONTRACTOR PROVIDED
IDOT PROVIDED

MAX. WIDTH
13'-0"
X MILES

SIGN -A-
IL.29

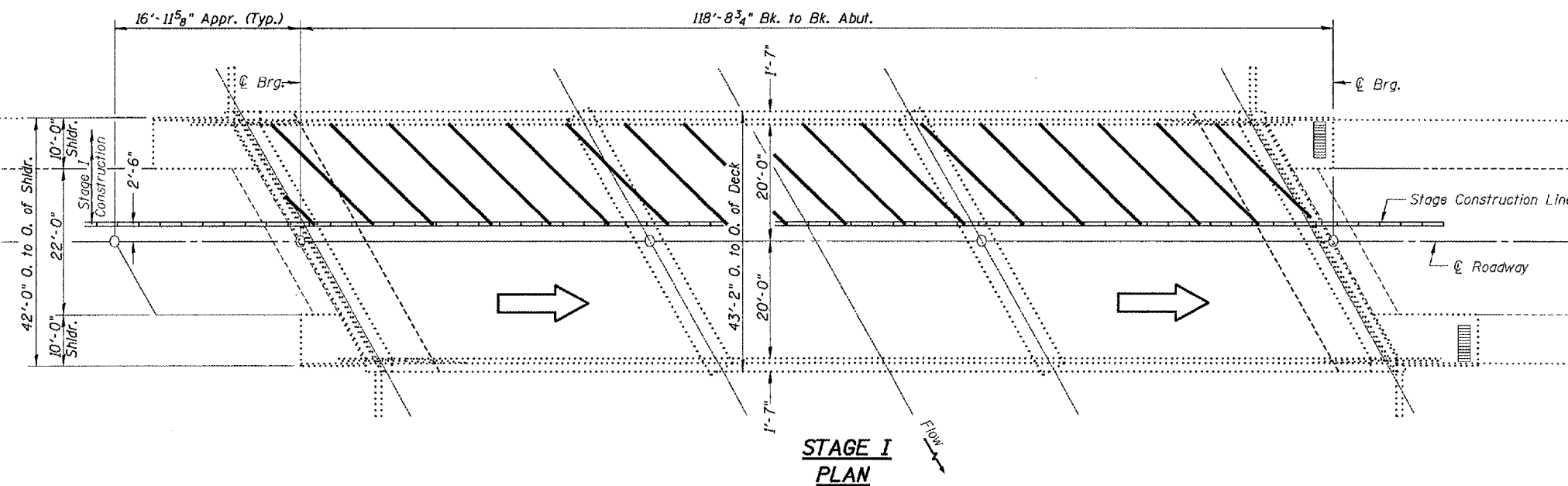

STAGE I PLAN

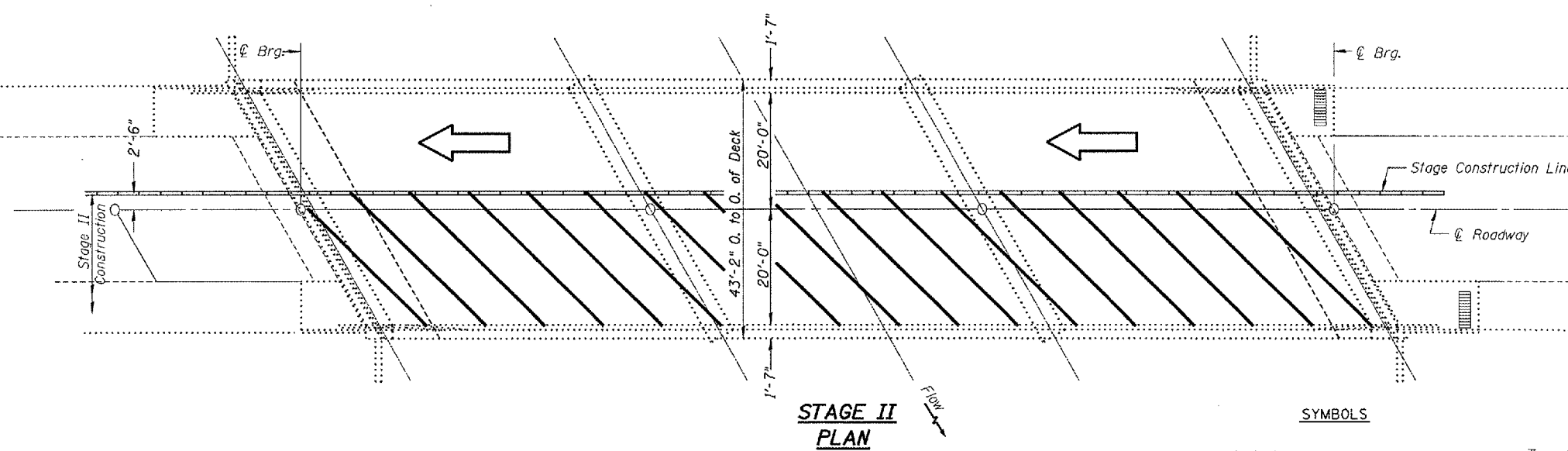

STAGE II PLAN

- SYMBOLS**
- Work Area
 - Temporary Concrete Barrier
 - Type C Mono-directional Reflector
 - Temporary Concrete Barrier

REVISIONS	
NAME	DATE

SN.078-0003, IL.29
over Senachwine Crk.

ILLINOIS DEPARTMENT OF TRANSPORTATION

TRAFFIC CONTROL

SCALE: VERT. DRAWN BY CEJ
HORIZ. CHECKED BY
DATE 11-27-2007

NOTES

Refer to Highway Standards 701321/701326 for exact placement of traffic management devices and other clarifications as construction staging symbols and dimensioning were duplicated off of these. Two Changeable Message Signs shall be placed at selected locations for each structure one week in advance of work starting. See Special Provisions for additional Traffic Control signing details.

DATE: 11/27/07
 DRAWN BY: CEJ
 CHECKED BY: [Blank]
 SCALE: AS SHOWN
 REFERENCE: [Blank]