

F.A.P. RTE.	SECTION	COUNTY	TOTAL SHEETS	SHEET NO.
318	(218-111,208R1-1	PLUTNAM	25	14
STA. *		TO STA. *		
FED. ROAD DIST. NO. 4		ILLINOIS FED. AID PROJECT		
* 078-0005 @ Sta. 133+17.70				

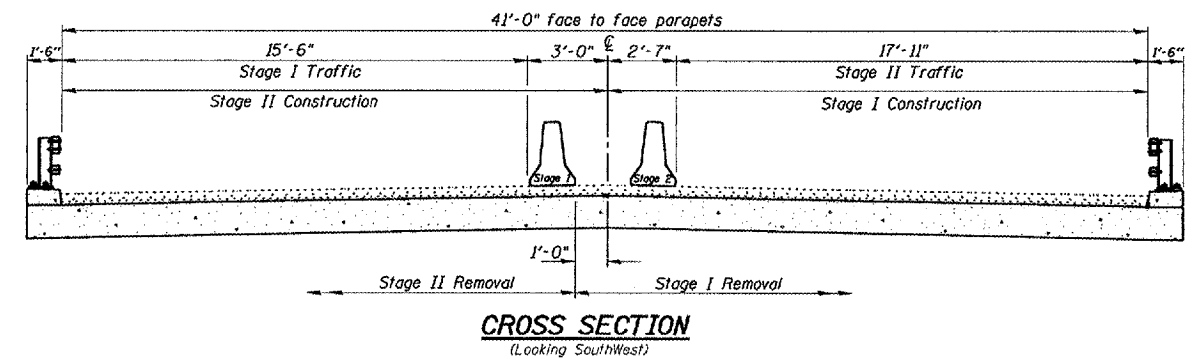

SN.078-0005 SIGNING

LOCATION	SIGN -A-	SIGN -B-
IL.18/IL.29	2 EA.	NA
I-180/IL.29	1 EA.	
IL.71/IL.29	1 EA.	

CONTRACTOR PROVIDED
IDOT PROVIDED

MAX. WIDTH
14'-0"
X MILES

SIGN -A-
IL.29

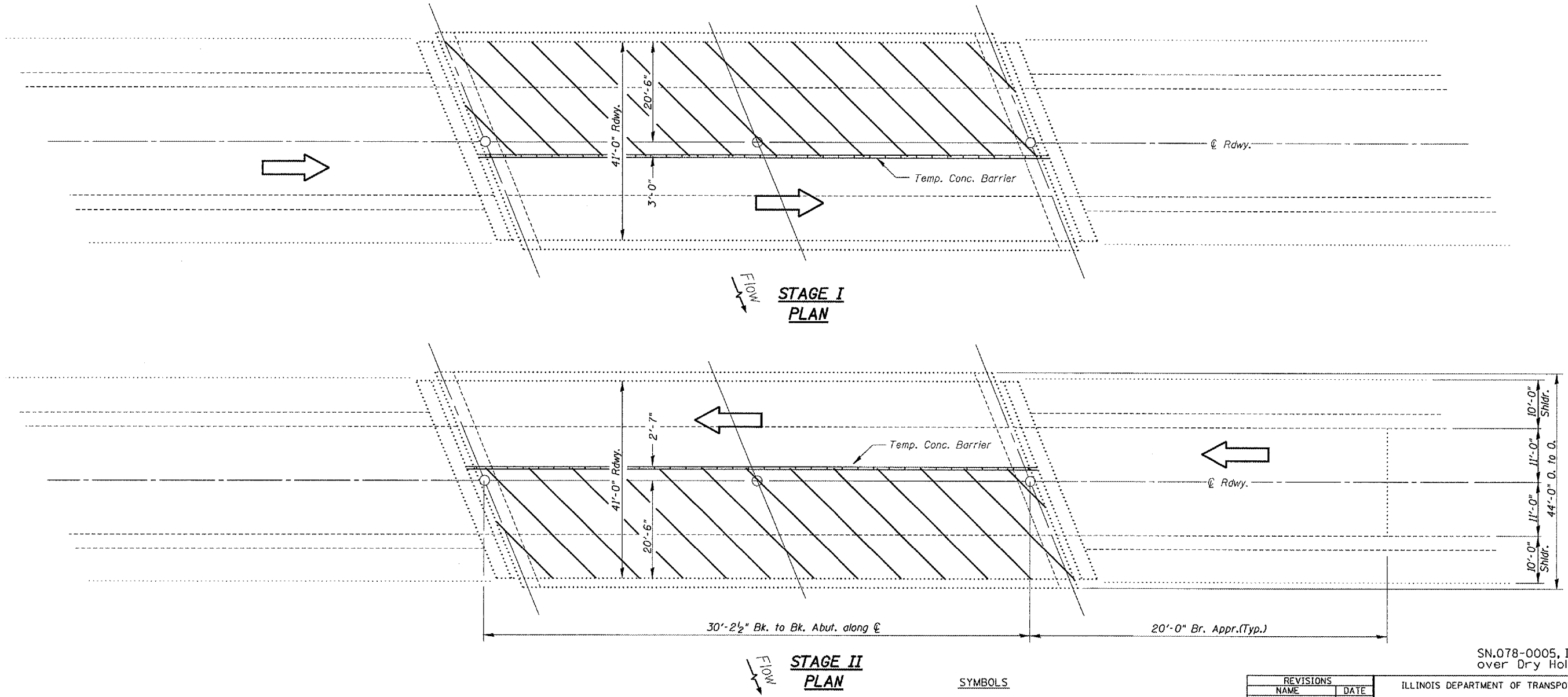

NOTES
Refer to Highway Standards 701321/701326 for exact placement of traffic management devices and other clarifications as construction staging symbols and dimensioning were duplicated off of these. Two Changeable Message Signs shall be placed at selected locations for each structure one week in advance of work starting. See Special Provisions for additional Traffic Control signing details.

SYMBOLS

- Work Area
- Temporary Concrete Barrier
- Type C Mono-directional Reflector
- Temporary Concrete Barrier

REVISIONS	
NAME	DATE

ILLINOIS DEPARTMENT OF TRANSPORTATION

TRAFFIC CONTROL

SCALE: VERT. _____
HORIZ. _____
DATE 12-20-2007

DRAWN BY CEJ
CHECKED BY _____

PLOT DATE = 04/01/08
 FILE NAME = #ELES\GEN\DRFT\STD\PLANS\SN.078-0005\SN.078-0005\68713-1-20\over_SenachuneCrk_IL.Rvt.Trb.dgn
 REFERENCE = #REF#