

PLAN	SURVEYED	DATE
	PLOTTED	
	CHECKED	
	BY	
	NO.	

PROFILE	SURVEYED	DATE
	PLOTTED	
	CHECKED	
	BY	
	NO.	

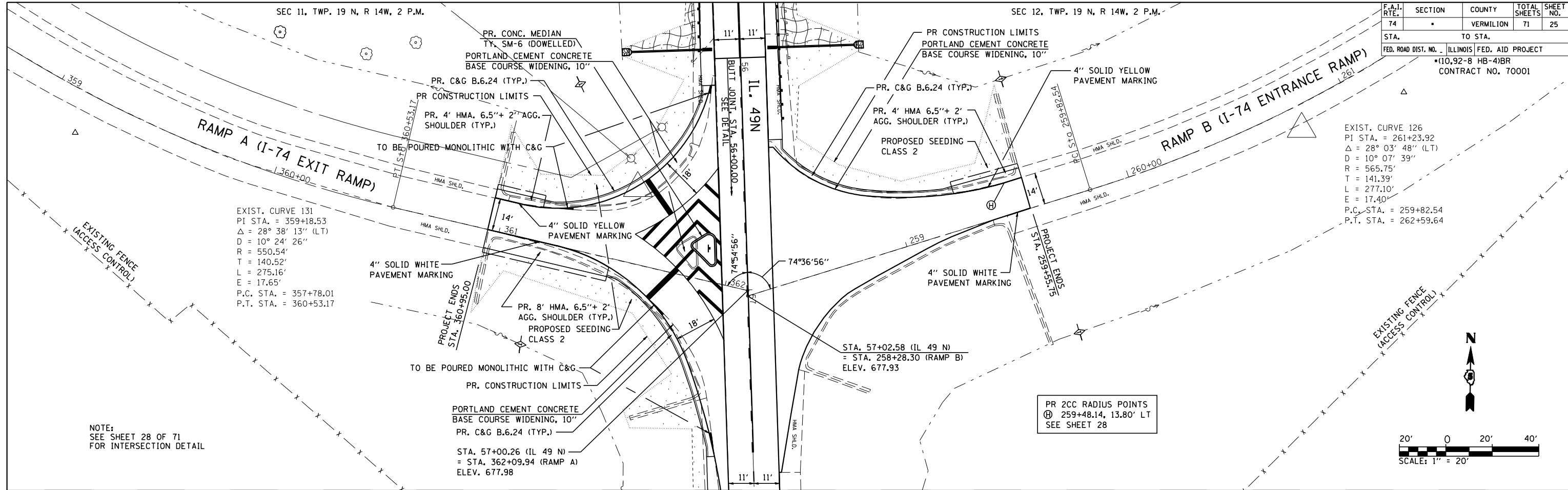

F.A.I. RTE.	SECTION	COUNTY	TOTAL SHEETS	SHEET NO.
74		VERMILION	71	25
STA.	TO STA.			
FED. ROAD DIST. NO. ILLINOIS FED. AID PROJECT				
•(10,92-8 HB-4)BR CONTRACT NO. 70001				

EXIST. CURVE 126
 PI STA. = 261+23.92
 $\Delta = 28^\circ 03' 48''$ (LT)
 $D = 10^\circ 07' 39''$
 $R = 565.75'$
 $T = 141.39'$
 $L = 277.10'$
 $E = 17.40'$
 P.C. STA. = 259+82.54
 P.T. STA. = 262+59.64

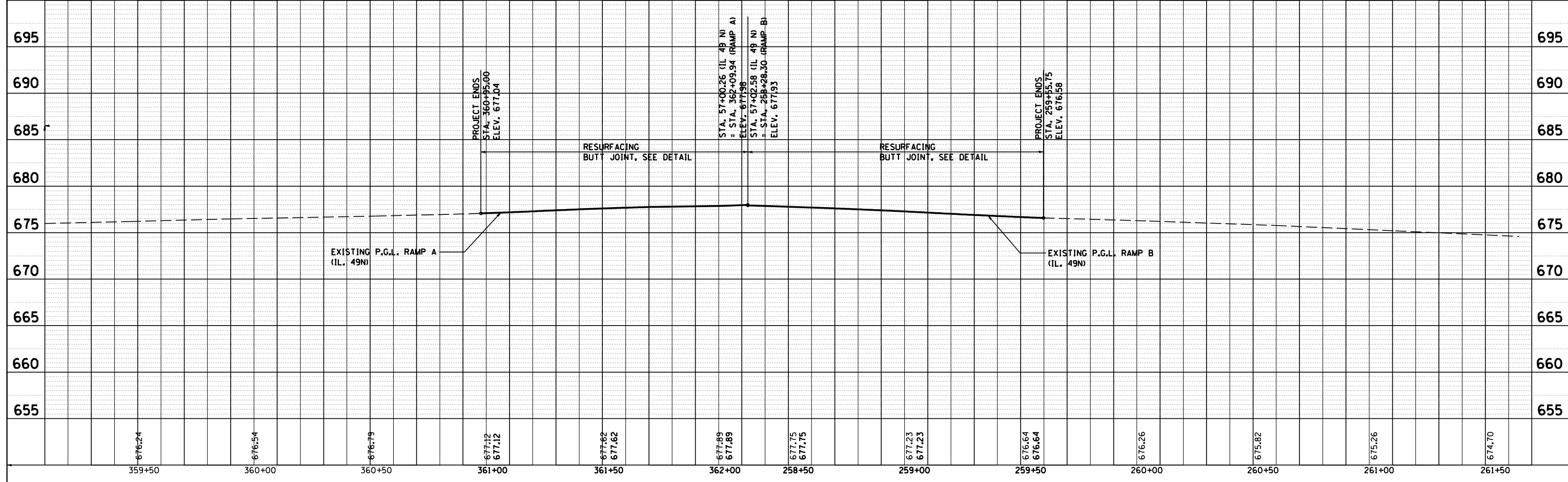
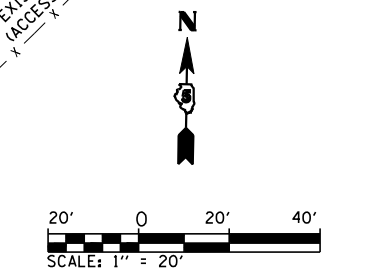

IL 49N RAMPS A & B