

EXISTING STRUCTURE TYPICAL SECTION

S.N. 074-0008

F. A. S. 1517 (US 150)

STATION	TO	STATION
4+89.42	5+60.59	5+60.59

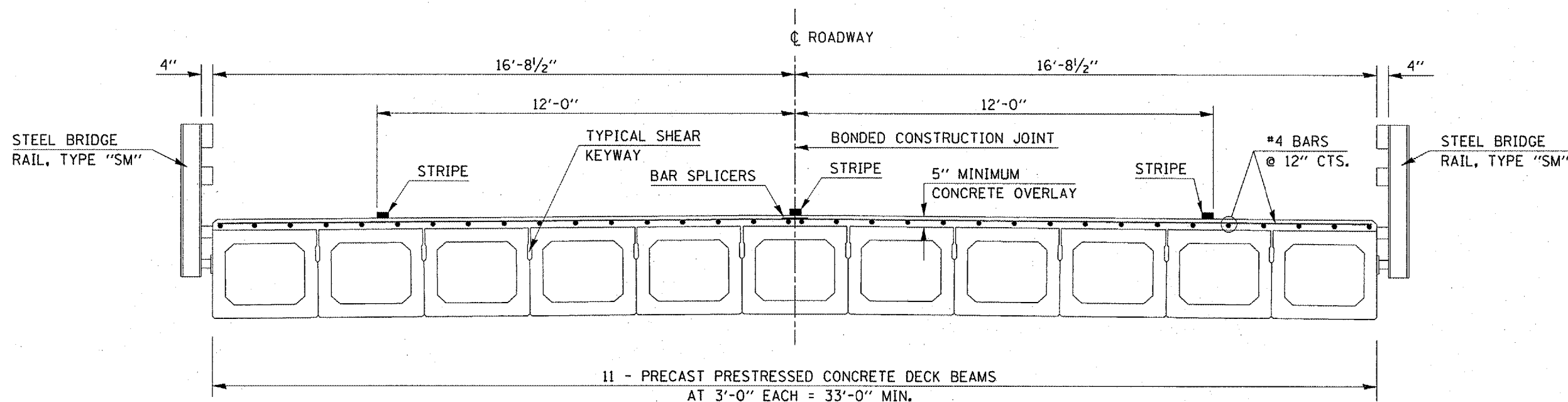

PROPOSED STRUCTURE TYPICAL SECTION AND STAGE CONSTRUCTION DETAILS

S. N. 074-0008 F. A. S. 1517 (US 150)

STATION	TO	STATION
4+89.42	5+60.59	5+60.59

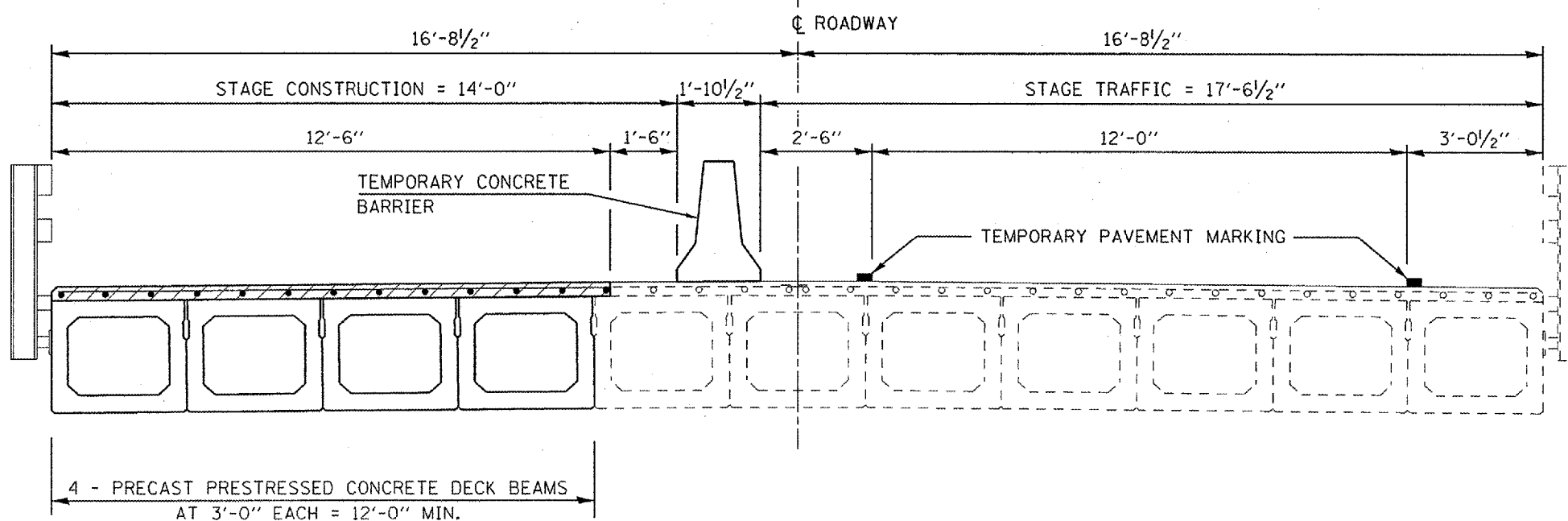

FILE NAME = c:\projects\4570699\70699plens.dgn

USER NAME = collierbw

DESIGNED - RTB

REVISED -

DRAWN - JRP

REVISED -

PLOT SCALE = 100.0000' / 1"

CHECKED -

REVISED -

PLOT DATE = 2/6/2008

DATE - 12-19-2007

REVISED -

**STATE OF ILLINOIS
DEPARTMENT OF TRANSPORTATION**

**EXISTING AND PROPOSED STRUCTURE TYPICAL SECTIONS
AND STAGE CONSTRUCTION DETAILS**

SCALE: NONE SHEET NO. 1 OF 1 SHEETS STA. TO STA.

F.A.S. RTE.	SECTION	COUNTY	TOTAL SHEETS	SHEET NO.
1517	D5 BEAM REPLACE 2008-2	PIATT	18	6
FED. ROAD DIST. NO. [ILLINOIS] FED. AID PROJECT			CONTRACT NO. 70699	