

F.A.I. RTE.	SECTION	COUNTY	TOTAL SHEETS	SHEET NO.
55	(84-2B-1) I-1	SANGAMON	31	1
FED. ROAD DIST. NO.		ILLINOIS	FED. AID PROJECT	
CONTRACT NO. 72349				

STATE OF ILLINOIS
DEPARTMENT OF TRANSPORTATION
DIVISION OF HIGHWAYS

PLANS FOR PROPOSED FEDERAL AID HIGHWAY

INDEX OF SHEETS

- 1 COVER SHEET
- 2 GENERAL NOTES & HIGHWAY STANDARDS
- 3 SUMMARY OF QUANTITIES
- 4 EXISTING TYPICAL SECTIONS
- 5-6 PROPOSED TYPICAL SECTIONS
- 7 SCHEDULE OF QUANTITIES
- 8 MAINTENANCE OF TRAFFIC
- 9 PLAN AND PROFILE SHEET
- 10-23 BRIDGE PLANS
- 24 ROADWAY DETAILS
- 25-31 CROSS SECTIONS

FOR SUMMARY OF QUANTITIES SEE SHEET 3

ADT 509 (2003)
MU 1% - SU 5%

SECTION (84-2B-1) I-1
ENDS STA. 38 + 59.00

S.N. 084-0025
STA. 36 + 16.64
150'-1 1/2" BK. TO BK. ABUT.
31'-9" STRUCTURE WIDTH
SKEW 7 34' 46" LT. FWD.

SECTION (84-2B-1) I-1
BEGINS STA. 32 + 40.00

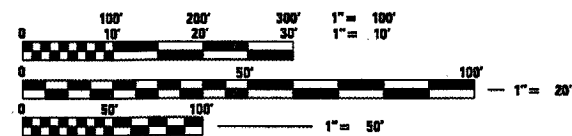
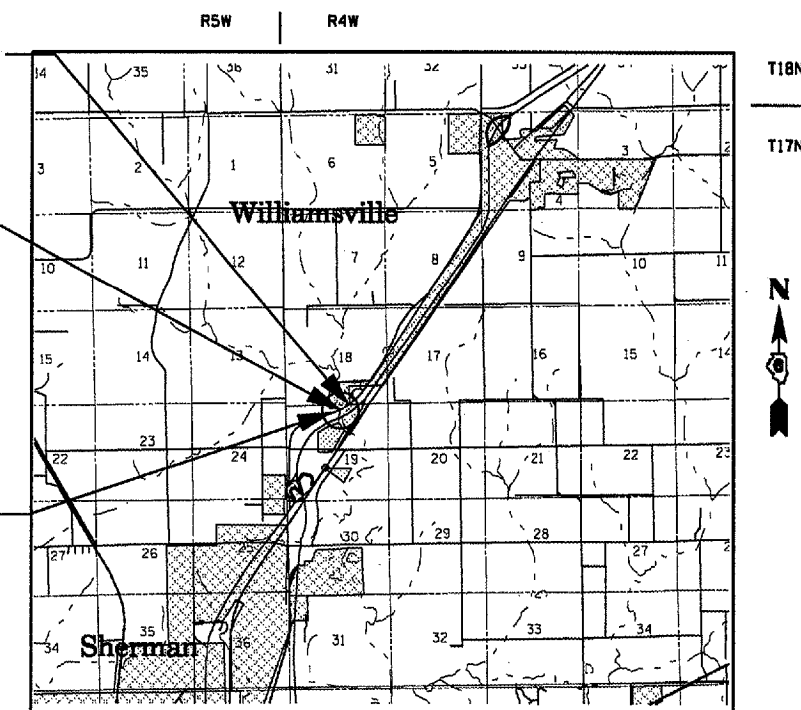

SCALES
 PLAN 1" = 50'
 PROFILE HORIZ. 1" = 50'
 PROFILE VERT. 1" = 5'
 CROSS SECTIONS 1" = 10'
 1" = 5'

FULL SIZE PLANS HAVE BEEN PREPARED USING STANDARD ENGINEERING SCALES, REDUCED SIZED PLANS WILL NOT CONFORM TO STANDARD SCALES, IN MAKING MEASUREMENTS ON REDUCED PLANS, THE ABOVE SCALES MAY BE USED.

FOR UNDERGROUND UTILITY LOCATIONS CALL
J.U.L.I.E. TOLL FREE
1-800-892-0123
WILLIAMSVILLE TOWNSHIP

CONTRACT NO. 72349

LOCATION MAP
GROSS AND NET LENGTH OF PROJECT = 0.117 MILES

SEAL

D-96-521-01

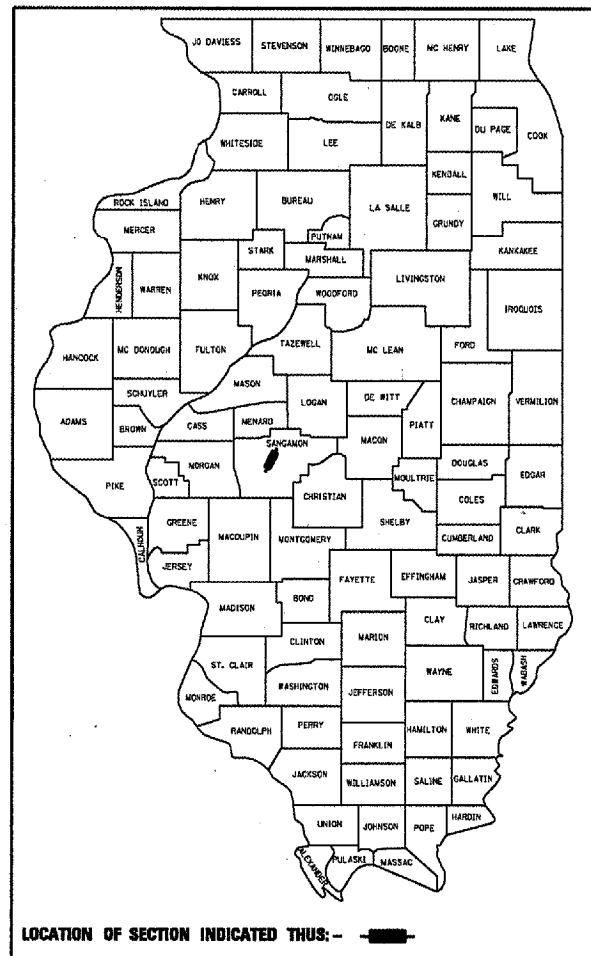

STATE OF ILLINOIS
DEPARTMENT OF TRANSPORTATION
DIVISION OF HIGHWAYS

SUBMITTED *Feb. 21, 20 08*
Christina M. Reed
DEPUTY DIRECTOR OF HIGHWAYS

March 21, 20 08
Eric E. Harm
ENGINEER OF DESIGN AND ENVIRONMENT

March 21, 20 08
Christina M. Reed
DIRECTOR, DIVISION OF HIGHWAYS

PROJECT ENGINEER: SAL MADONIA (217) 782-4761
SQUAD LEADER: MARCUS BRUCE (217) 524-0946