

F.A.P. RTE.	SECTION	COUNTY	TOTAL SHEETS	SHEET NO.
745	(108BR)I-1	PIKE	7	1
FED. ROAD DIST. NO. _____		ILLINOIS	CONTRACT NO. 72B57	

FOR INDEX OF SHEETS, SEE SHEET NO. 2

STATE OF ILLINOIS  
DEPARTMENT OF TRANSPORTATION  
DIVISION OF HIGHWAYS

**PROPOSED  
HIGHWAY PLANS**

FAP ROUTE 745 (IL 104)  
SECTION (108BR)I-1

PIKE COUNTY  
BEAM REPLACEMENT  
C-96-013-08

**STANDARDS**

- 000001-05
- 001001-01
- 001006
- 630007-07
- 631031-06
- 701006-02
- 701901
- BLR21-7
- BLR22-5

**BROWER CREEK  
SN 075-0029  
STA 1721+25  
EXISTING SINGLE  
SPAN 54'-3" BK TO  
BK - REPLACE PPC  
DECK BEAM Nos.  
3,4,5,6,7 & 11**

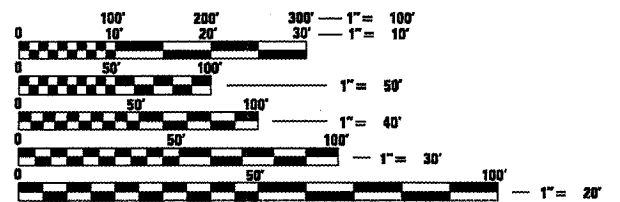

FULL SIZE PLANS HAVE BEEN PREPARED USING STANDARD ENGINEERING SCALES. REDUCED SIZED PLANS WILL NOT CONFORM TO STANDARD SCALES. IN MAKING MEASUREMENTS ON REDUCED PLANS, THE ABOVE SCALES MAY BE USED.

J.U.L.I.E.  
JOINT UTILITY LOCATION INFORMATION FOR EXCAVATION  
1-800-892-0123  
OR 811

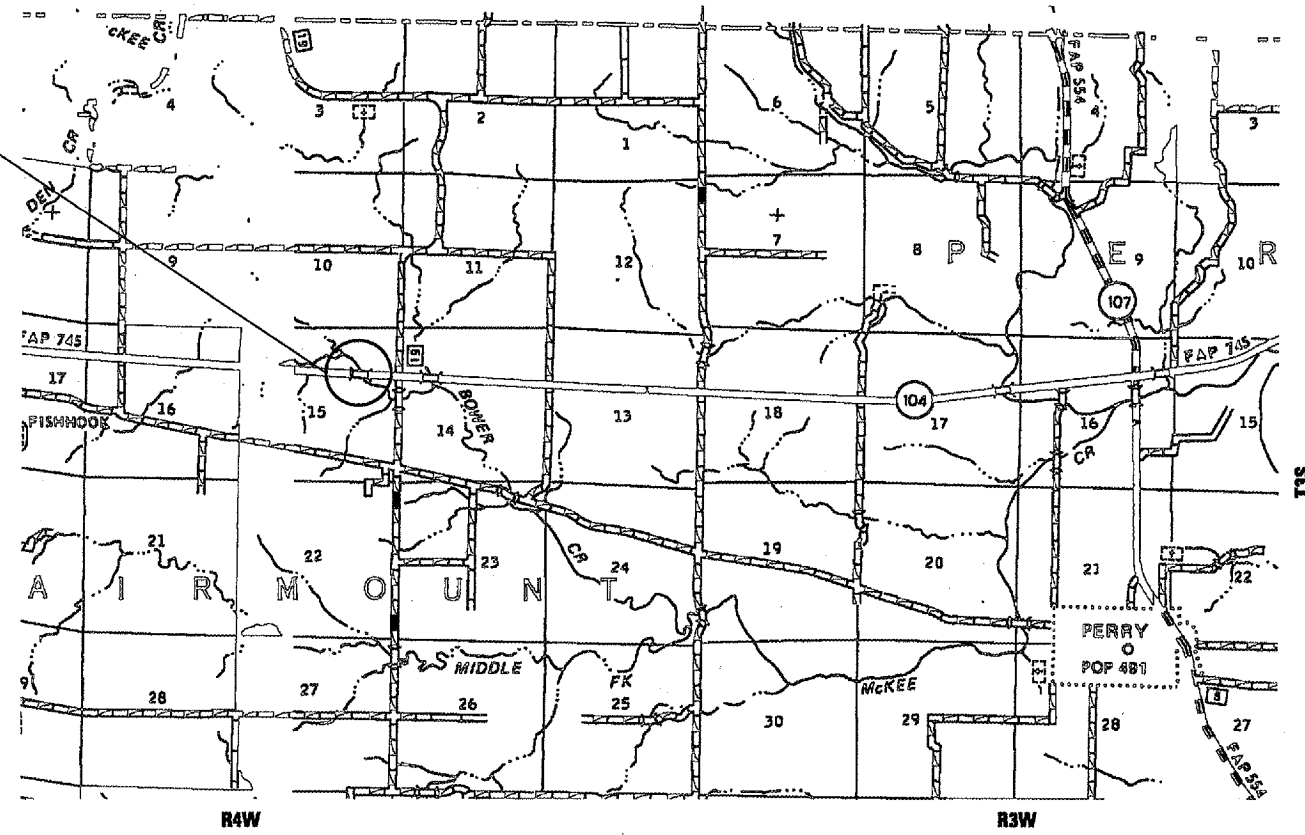

ADT = 650 (2005)  
% PV = 80.8 (525)  
% SU = 10 (65)  
% MU = 9.2 (60)

PROJECT LENGTH = 120 FT = 0.02 MILES

CONTRACT NO. 72B57

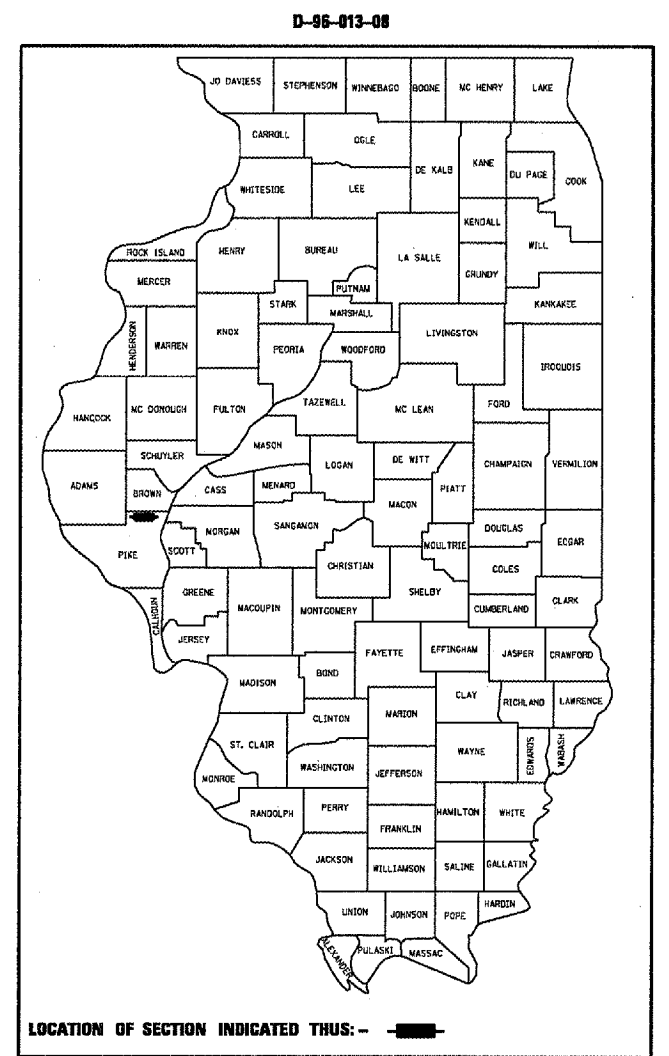

STATE OF ILLINOIS  
DEPARTMENT OF TRANSPORTATION  
DIVISION OF HIGHWAYS

SUBMITTED FEB 8 2008  
*[Signature]*  
DEPUTY DIRECTOR OF HIGHWAYS, REGION ENGINEER

March 21, 2008  
Eric E. Harn/PE  
ENGINEER OF DESIGN AND ENVIRONMENT

March 21, 2008  
Christine M. Reed/PE  
DIRECTOR OF HIGHWAYS, CHIEF ENGINEER

**PRINTED BY THE AUTHORITY  
OF THE STATE OF ILLINOIS**

PROJECT ENGINEER: JOHN NEGANGARD (217) 782 6990  
SQUAD LEADER: MARK DUST (217) 785 0597