

FAP ROUTE	SECTION	COUNTY	TOTAL SHEETS	SHEET NO.
592	121-1R, 121HV8	ST. CLAIR	239	83
STA. 5011+00		TO STA. 5025+00		
PAVEMENT REMOVAL SHEETS				

PLAN	DATE
SURVEYED	
DESIGNED	
ALIGNED	
CHECKED	
BY	
NO.	
PAID FILE NAME	

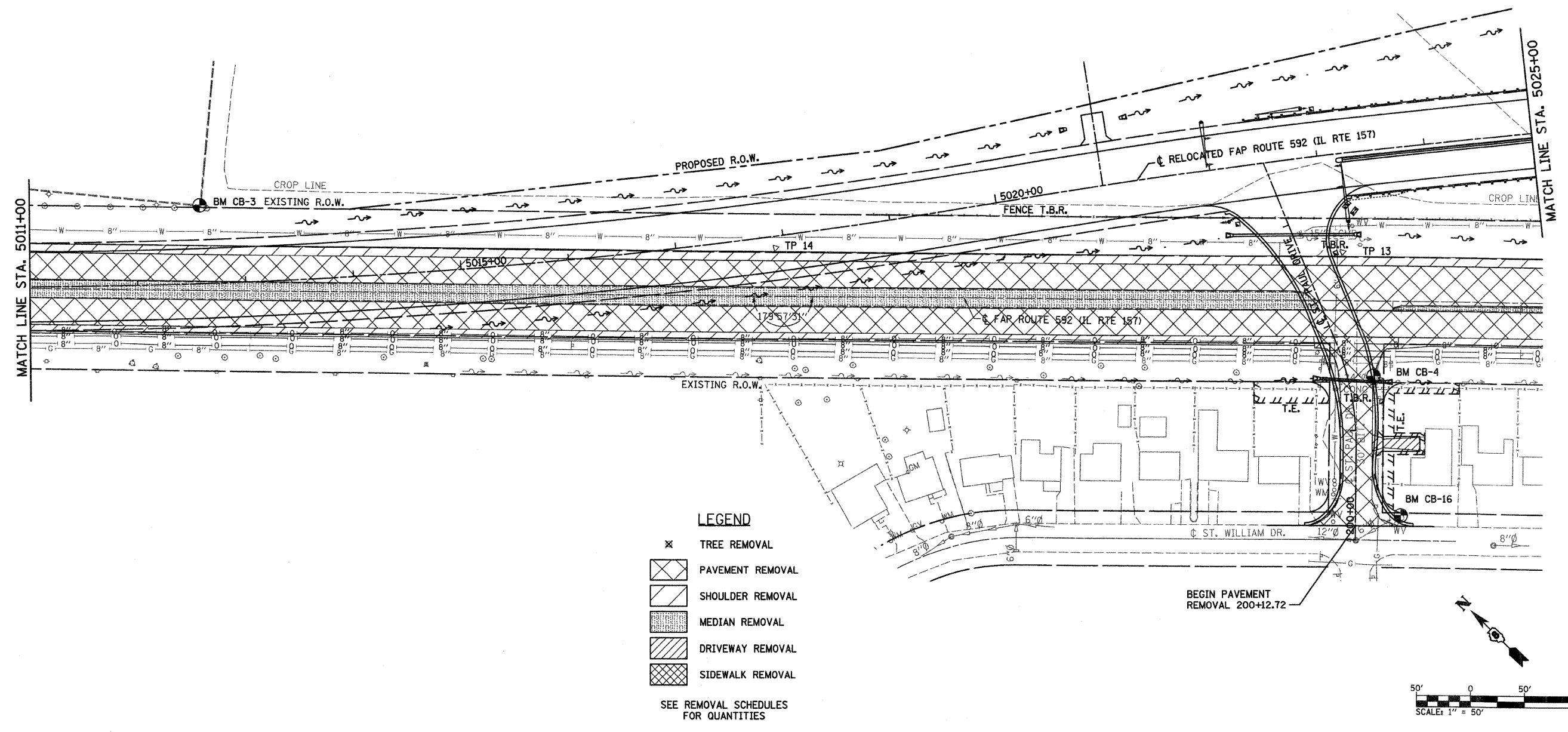

LEGEND

- ✕ TREE REMOVAL
- [Diagonal Hatching] PAVEMENT REMOVAL
- [Diagonal Hatching] SHOULDER REMOVAL
- [Stippled] MEDIAN REMOVAL
- [Horizontal Hatching] DRIVEWAY REMOVAL
- [Cross-hatching] SIDEWALK REMOVAL

SEE REMOVAL SCHEDULES FOR QUANTITIES

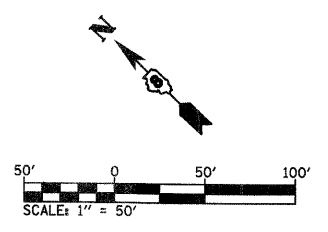

PLOT DATE = 03/22/2007
 FILE NAME = H:\P\31815\Microstation\Design\emp1801.dgn
 USER NAME = MUSERA