

F.A.P. RTE.	SECTION	COUNTY	TOTAL SHEETS	SHEET NO.
592	121-1R, 121HVB	ST. CLAIR	239	129
TRAFFIC SIGNALS - ST. PAUL DRIVE				
FED. ROAD DIST. NO.	ILLINOIS	FED. AID PROJECT		

**TRAFFIC SIGNAL LEGEND**

- PROPOSED SIGNAL HEAD WITH BACKPLATE (SEE HIGHWAY STANDARD 880006)
- PROPOSED SIGNAL HEAD (SEE HIGHWAY STANDARD 880006)
- PROPOSED HANDHOLE (SEE HIGHWAY STANDARD 814001)
- PROPOSED DOUBLE HANDHOLE (SEE HIGHWAY STANDARD 814006)
- PROPOSED DETECTOR LOOP (SEE HIGHWAY STANDARDS 886001 & 886006)
- PROPOSED CONDUIT: "T" TRENCH, "P" PUSHED, SIZE SPECIFIED
- PVCC POLYVINYL CHLORIDE CONDUIT
- GSC GALVANIZED STEEL CONDUIT
- PROPOSED SIGN
- PROPOSED MAST ARM (LENGTH SPECIFIED) (SEE HIGHWAY STANDARD 877001 & 878001)
- SERVICE POLE (SEE HIGHWAY STANDARD 805001)
- PROPOSED CONTROLLER

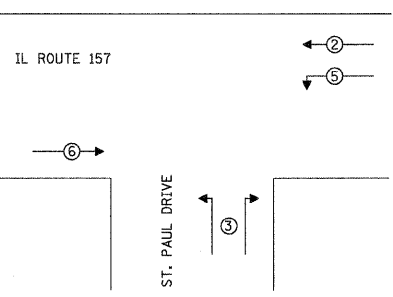
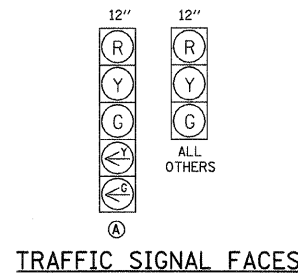

**SEQUENCE OF OPERATIONS**

FULL-ACTUATED CONTROLLER AND 8 PHASES, IN TYPE IV CABINET								
PHASE #	1	2	3	4	5	6	7	8
MOVEMENT	NOT USED	←	↕	NOT USED	↕	→	NOT USED	NOT USED
CONCURRENT MOVEMENT PERMITTED	NONE	5 OR 6	NONE	NONE	2	2	NONE	NONE

**PHASE DESIGNATION DIAGRAM**

**INTERCONNECT DETAIL (NOT TO SCALE)**

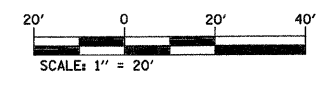
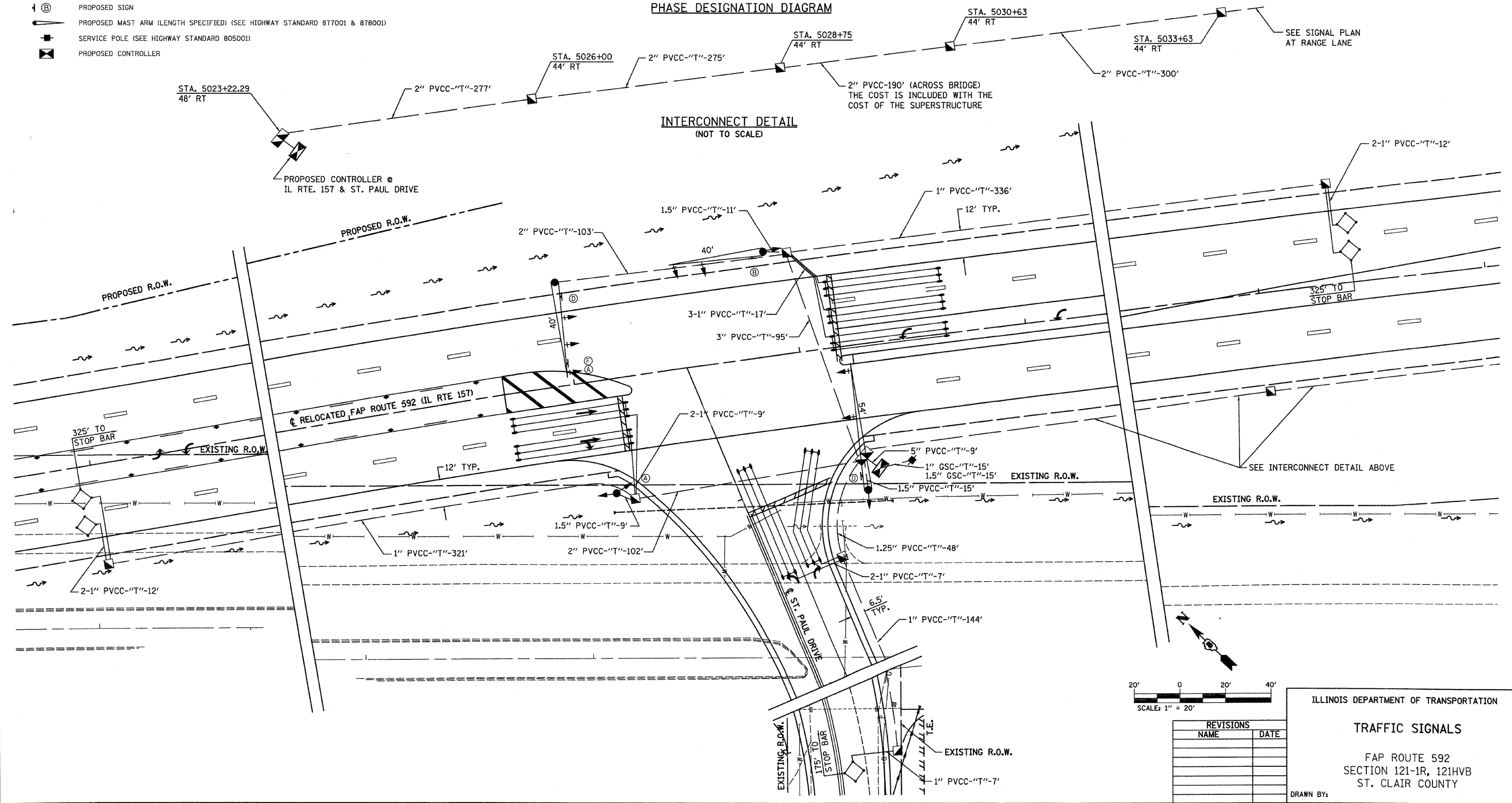

REVISIONS	
NAME	DATE

ILLINOIS DEPARTMENT OF TRANSPORTATION

**TRAFFIC SIGNALS**

FAP ROUTE 592  
SECTION 121-1R, 121HVB  
ST. CLAIR COUNTY

DRAWN BY:

PLOT DATE = 8/3/21/2007  
 FILE NAME = H:\P\2105\Microstation\Drawings\Sign\10610.dgn  
 PLOT SCALE = 20.0000 / IN.  
 USER NAME = PUSHER