

F.A.I. RTE.	SECTION	COUNTY	TOTAL SHEETS	SHEET NO.
270	60-1,2,3,4,5I	MADISON	46	16
STA. 337+72		TO STA. 367+00		
FED. ROAD DIST. NO. 1		ILLINOIS FED. AID PROJECT		

EXIST. CURVE C3
 PI STA. = 340+84.62
 $\Delta = 9^\circ 23' 00''$ (LT)
 $D = 1^\circ 30' 00''$
 $R = 3,819.72'$
 $T = 313.48'$
 $L = 625.56'$
 $E = 12.84'$
 $\theta = \text{-----}$
 $T.R. = \text{-----}$
 $S.E. RUN = \text{-----}$
 $P.C. STA. = 337+71.14$
 $P.T. STA. = 343+96.69$

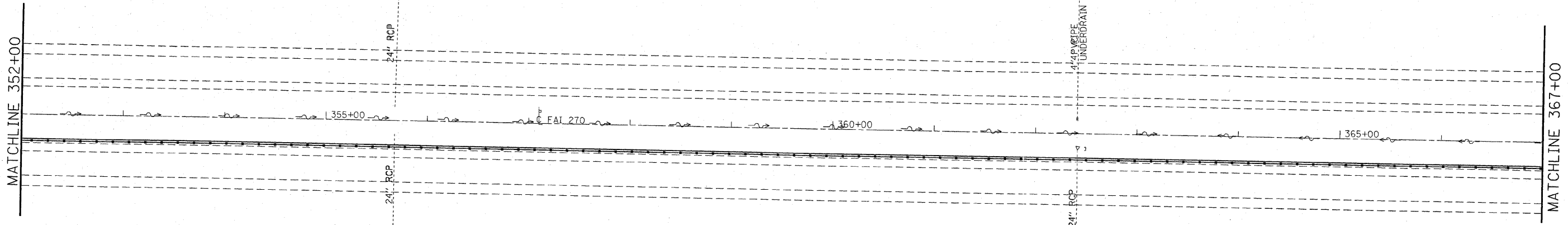
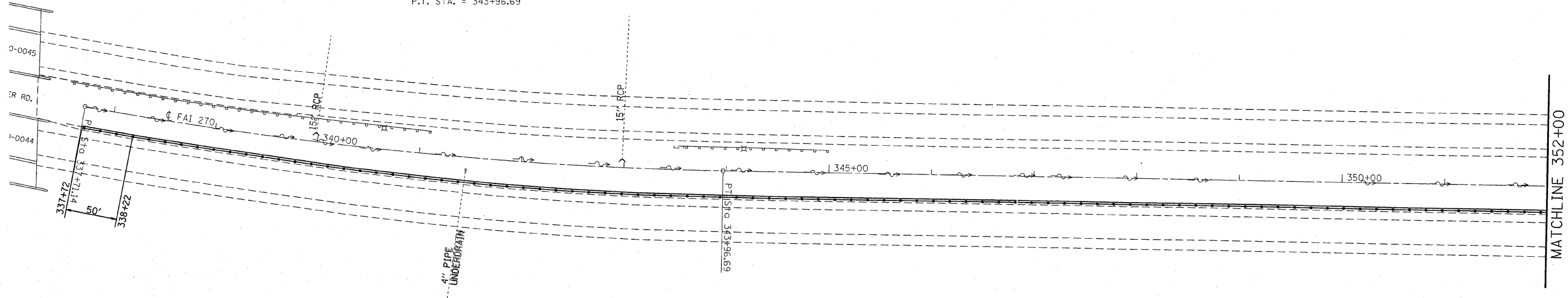

PLOT DATE = 12/12/2007
 FILE NAME = c:\p\projects\76b17\76b17.dwg
 SCALE = 5000000 / IN
 REFERENCE = 76B17

REVISIONS	
NAME	DATE

ILLINOIS DEPARTMENT OF TRANSPORTATION
PLAN VIEW
AREA #2
 FAI RTE 270
 SECTION 69-1,2,3,4,5I
 MADISON COUNTY

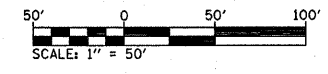

SCALE: VERT. _____
 HORIZ. _____
 DATE _____ DRAWN BY _____
 CHECKED BY _____