

F.A.I. RTE.	SECTION	COUNTY	TOTAL SHEETS	SHEET NO.
270	60-(1,2,3,4,5)I	MADISON	46	40
STA. 670+00 TO STA. 700+00				
FED. ROAD DIST. NO. _ ILLINOIS FED. AID PROJECT				

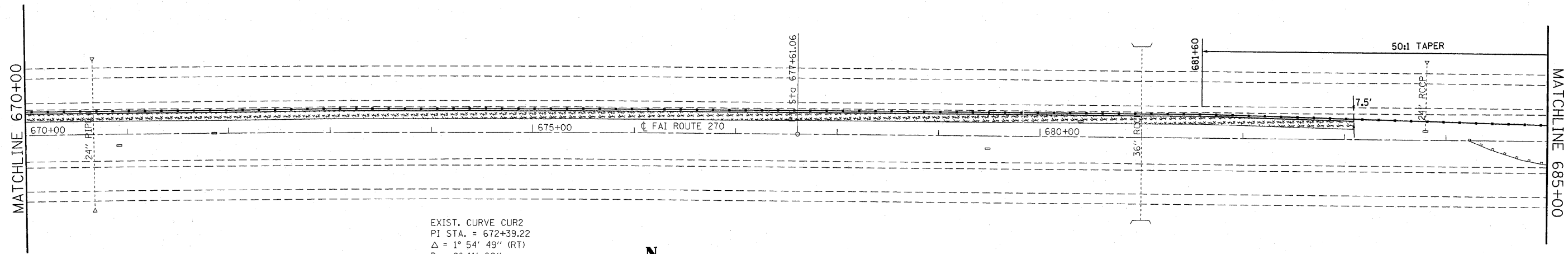

EXIST. CURVE CUR2  
 PI STA. = 672+39.22  
 $\Delta = 1^\circ 54' 49''$  (RT)  
 $D = 0^\circ 11' 00''$   
 $R = 31,252.24'$   
 $T = 521.94'$   
 $L = 1,043.79'$   
 $E = 4.36'$   
 $e =$  -----  
 $T.R. =$  -----  
 $S.E. RUN =$  -----  
 $P.C. STA. = 667+17.28$   
 $P.T. STA. = 677+61.06$

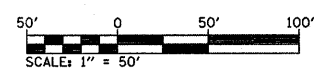
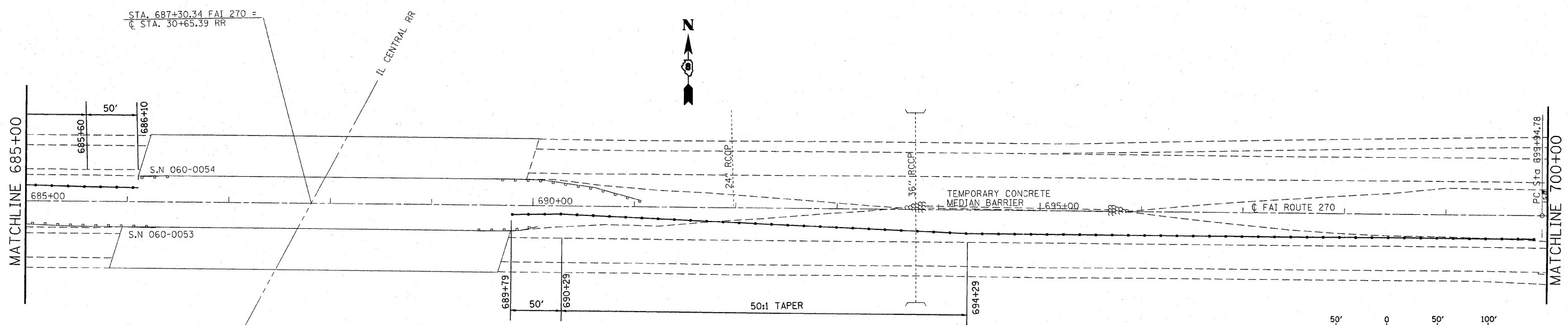

- INLET AND PIPE PROTECTION
- MULCH

REVISIONS	
NAME	DATE

ILLINOIS DEPARTMENT OF TRANSPORTATION  
**EROSION CONTROL PLAN**  
**AREA #3**  
 FAI RTE 270  
 SECTION 60-(1,2,3,4,5)I  
 MADISON COUNTY

SCALE: VERT. \_\_\_\_\_  
 HORIZ. \_\_\_\_\_  
 DATE \_\_\_\_\_

DRAWN BY \_\_\_\_\_  
 CHECKED BY \_\_\_\_\_

PLOT DATE = 12/12/2007  
 FILE NAME = c:\projects\ed092876\plan\erpl062876.dgn  
 PLOT SCALE = 50.0000' / IN.  
 REFERENCE = #REF\*