

F.A.I. RTE.	SECTION	COUNTY	TOTAL SHEETS	SHEET NO.
270	60-(1,2,3,4,5)I	MADISON	46	42
STA. 730+00		TO STA. 760+00		
FED. ROAD DIST. NO. 1		ILLINOIS FED. AID PROJECT		

EXIST. CURVE CUR4  
 PI STA. = 738+58.88  
 $\Delta = 17^\circ 42' 05''$  (LT)  
 $D = 0^\circ 28' 40''$   
 $R = 11,992.14'$   
 $T = 1,867.35'$   
 $L = 3,704.94'$   
 $E = 144.52'$   
 $\theta = \text{-----}$   
 $T.R. = \text{-----}$   
 $S.E. \text{ RUN} = \text{-----}$   
 $P.C. \text{ STA.} = 719+91.53$   
 $P.T. \text{ STA.} = 756+96.47$

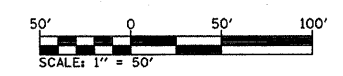
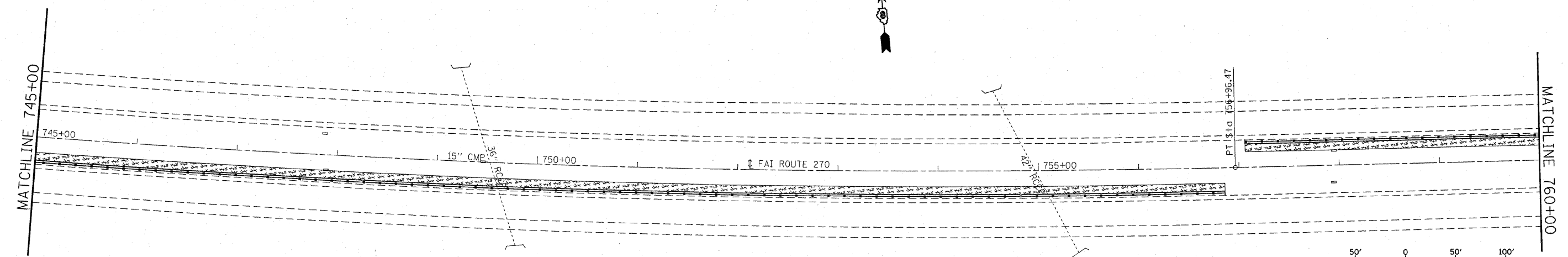
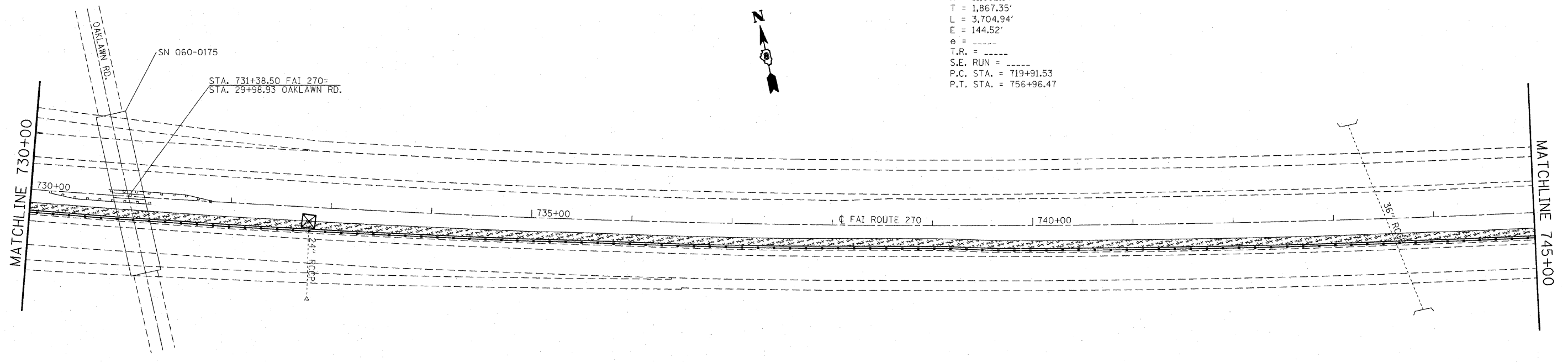

- INLET AND PIPE PROTECTION
- MULCH

REVISIONS	
NAME	DATE

ILLINOIS DEPARTMENT OF TRANSPORTATION  
**EROSION CONTROL PLAN**  
**AREA #3**  
 FAI RTE 270  
 SECTION 60-(1,2,3,4,5)I  
 MADISON COUNTY

SCALE: VERT. \_\_\_\_\_  
 HORIZ. \_\_\_\_\_

DRAWN BY \_\_\_\_\_  
 CHECKED BY \_\_\_\_\_

PLOT DATE = 12/12/2007  
 FILE NAME = c:\projects\eroc\76b17\plan\eroc\927b.dgn  
 PLOT SCALE = 50.0000' / IN.  
 REFERENCE = #REF#