

F.A.I. RTE.	SECTION	COUNTY	TOTAL SHEETS	SHEET NO.
.	**	***	22	21
STA.		TO STA.		
FED. ROAD DIST. NO.		ILLINOIS	FED. AID PROJECT	

- FAS 1909 & FAP 322
- D9 PAVEMENT PRESERVATION FY08
- JACKSON AND UNION COUNTIES

PAVEMENT MARKING DETAIL
 FAP 322 (US 51) AT LOCATION 2
 STA. 365+98 TO STA. 378+65

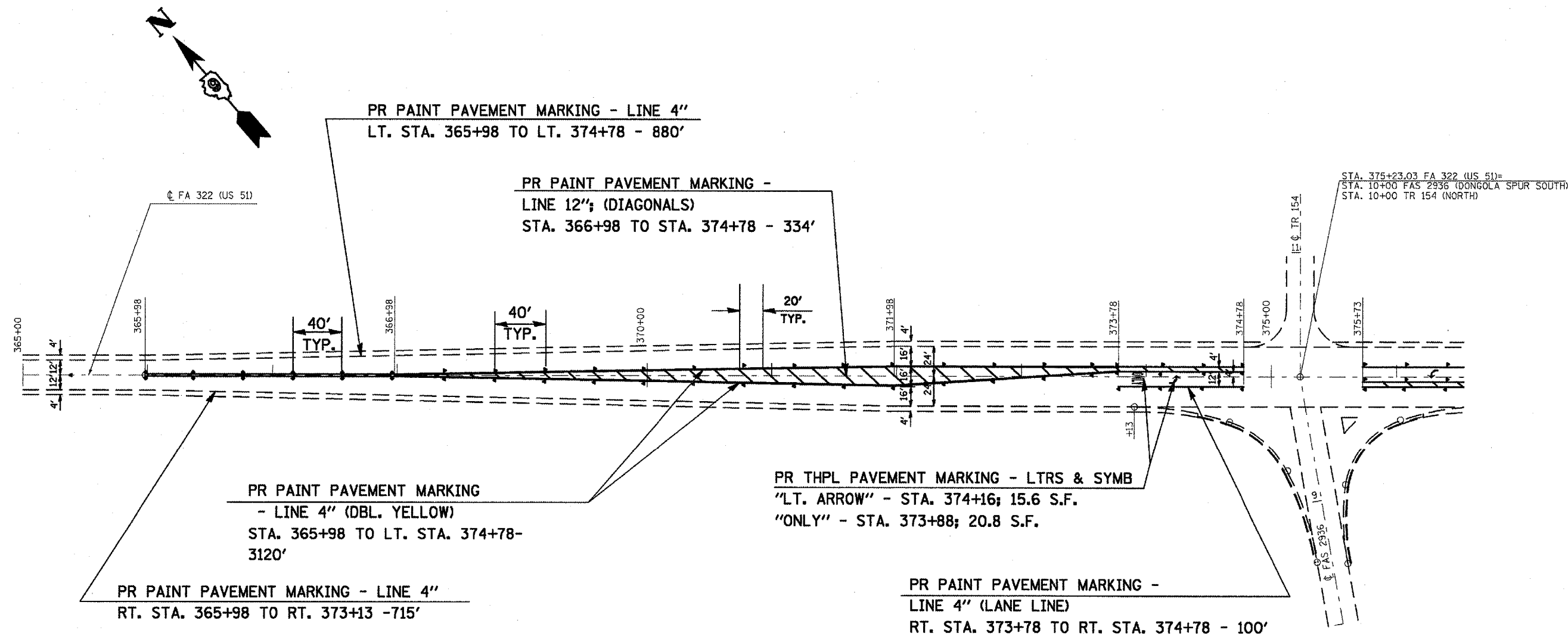

PR THPL PAVEMENT MARKING - LTRS & SYMB
 "LT. ARROW" - STA. 374+16; 15.6 S.F.
 "ONLY" - STA. 373+88; 20.8 S.F.

NOTES:
 FOR RAISED REFLECTIVE PAVEMENT MARKERS,
 SEE SCHEDULE ON SHEET 14.
 FOR PAVEMENT MARKING BEFORE STATION 365+98,
 SEE SCHEDULE ON SHT. 12.

PLT DATE = 1/24/2008
 PLT NAME = J. J. JONES
 PLT SCALE = 1/4" = 10'-0"
 USER NAME = jones