

F.A.P. RTE.	SECTION	COUNTY	TOTAL SHEETS	SHEET NO.
2794	06-00109-00-WR	COOK	24	11
STA. 115+00		TO STA. 130+00		
FED. ROAD DIST. NO.		ILLINOIS FED. AID PROJECT		

LEGEND

- PROPOSED BUTT JOINT (HOT-MIX ASPHALT REMOVAL - BUTT JOINT)
- PROPOSED PAVEMENT RESURFACING (HOT-MIX ASPHALT SURFACE REMOVAL, 4" HOT-MIX ASPHALT SURFACE COURSE, MIX D, N70 HOT-MIX ASPHALT BINDER COURSE, IL-19, N70)
- PROPOSED PCC DRIVEWAY (DRIVEWAY PAVEMENT REMOVAL PCC DRIVEWAY PAVEMENT, 8")

LEGEND (CONTINUATION)

- PROPOSED PAVEMENT WIDENING (HOT-MIX ASPHALT SURFACE COURSE, MIX D, N70 HOT-MIX ASPHALT BINDER COURSE, IL-19, N70 HOT-MIX ASPHALT BASE COURSE SUB-BASE GRANULAR MATERIAL, TYPE B COMBINATION CONC. CURB & GUTTER, TYPE B-6.12)
- SIDEWALK REMOVAL
- AcB CATCH BASIN TO BE ADJUSTED
- Amh SANITARY/STORM MANHOLE TO BE ADJUSTED
- Avv VALVE VAULT TO BE ADJUSTED
- HC HANDICAP ACCESSIBLE RAMP WITH DETECTABLE WARNINGS

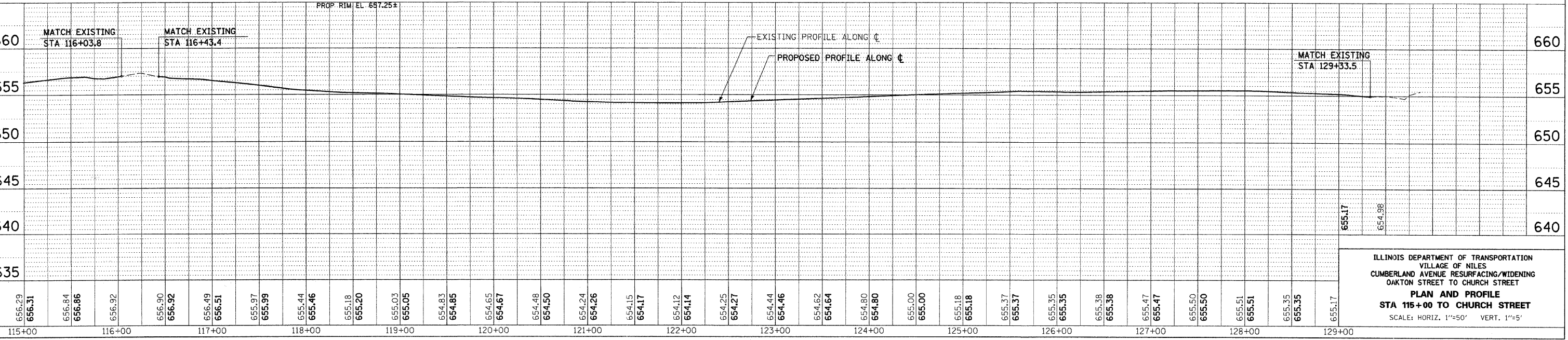
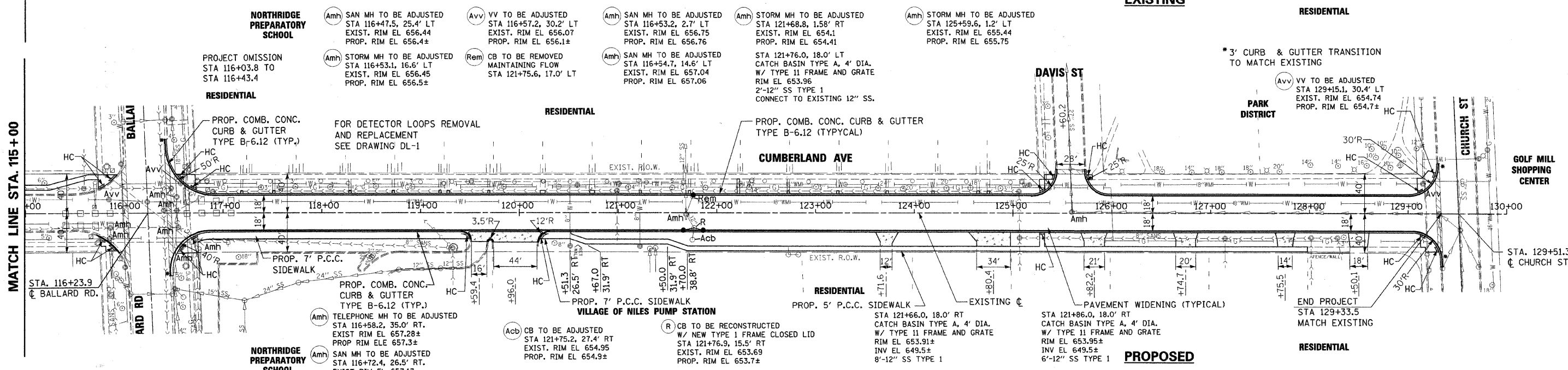
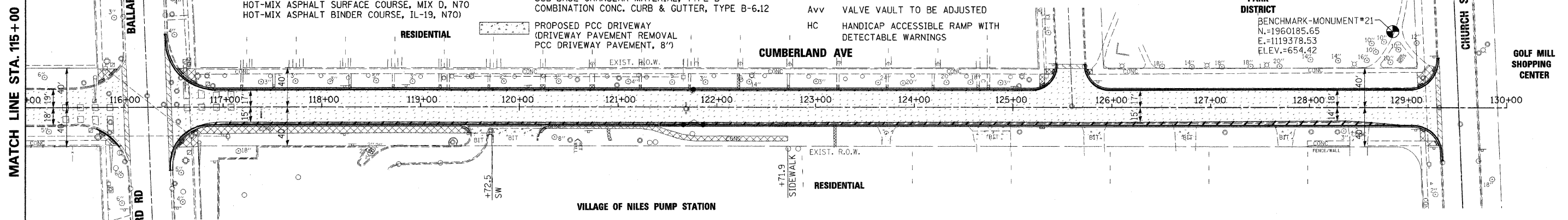

ILLINOIS DEPARTMENT OF TRANSPORTATION
 VILLAGE OF NILES
 CUMBERLAND AVENUE RESURFACING/WIDENING
 OAKTON STREET TO CHURCH STREET
PLAN AND PROFILE
 STA 115+00 TO CHURCH STREET
 SCALE: HORIZ. 1"=50' VERT. 1"=5'

DATE: _____
 BY: _____
 SURVEYED: _____
 PLAN: _____
 CHECKED: _____
 DATE: _____

DATE: _____
 BY: _____
 SURVEYED: _____
 PROFILE: _____
 CHECKED: _____
 DATE: _____

PLOT DATE: 1/29/2008
 FILE NAME: #66835
 PLOT SCALE: #SCALE#
 USER NAME: #USER#