

STATE OF ILLINOIS
DEPARTMENT OF TRANSPORTATION
DIVISION OF HIGHWAYS

**PLANS FOR
PROPOSED FEDERAL
AID HIGHWAY**

FAU ROUTE 2793 (CUMBERLAND AVENUE)
OAKTON STREET TO CHURCH STREET
PAVEMENT RESURFACING AND WIDENING
SECTION 06-00109-00-WR
PROJECT M-8003(824)
JOB C-91-319-07
VILLAGE OF NILES
COOK COUNTY

FOR INDEX OF SHEETS, SEE SHEET NO. 2



LOCATION OF SECTION INDICATED THUS: - [black rectangle] -



TRAFFIC DATA:
2006 ADT = 9,540
2030 ADT = 11,800

SPEED LIMIT = 30 MPH

DESIGN DESIGNATION:
1350 (30) MINOR ARTERIAL



FINAL

STATE OF ILLINOIS
DEPARTMENT OF TRANSPORTATION
DIVISION OF HIGHWAYS

APPROVED [Signature] 01/18 2008
DIRECTOR OF PUBLIC WORKS

PASSED [Signature] FEBRUARY 6, 2008 2008
DISTRICT I ENGINEER LOCAL ROADS & STREETS

RELEASING FOR BID [Signature] FEBRUARY 6, 2008 2008
BASED ON LIMITED REVIEW DEPUTY DIRECTOR OF HIGHWAYS, REGION I ENGINEER

APPROVED [Signature] 01/16 2008
ALAN R. SWANSON, McDONOUGH ASSOCIATES INC.

**PRINTED BY THE AUTHORITY
OF THE STATE OF ILLINOIS**

**PROJECT LOCATED IN
VILLAGE OF NILES**

PROJECT ENDS
STA. 129+33.5

PROJECT OMISSION
BALLARD ROAD
STA. 116+03.8 TO STA. 116+43.4

PROJECT OMISSION
DEMPSTER STREET
STA. 102+68.4 TO STA. 103+26.6

PROJECT BEGINS
STA. 50+23

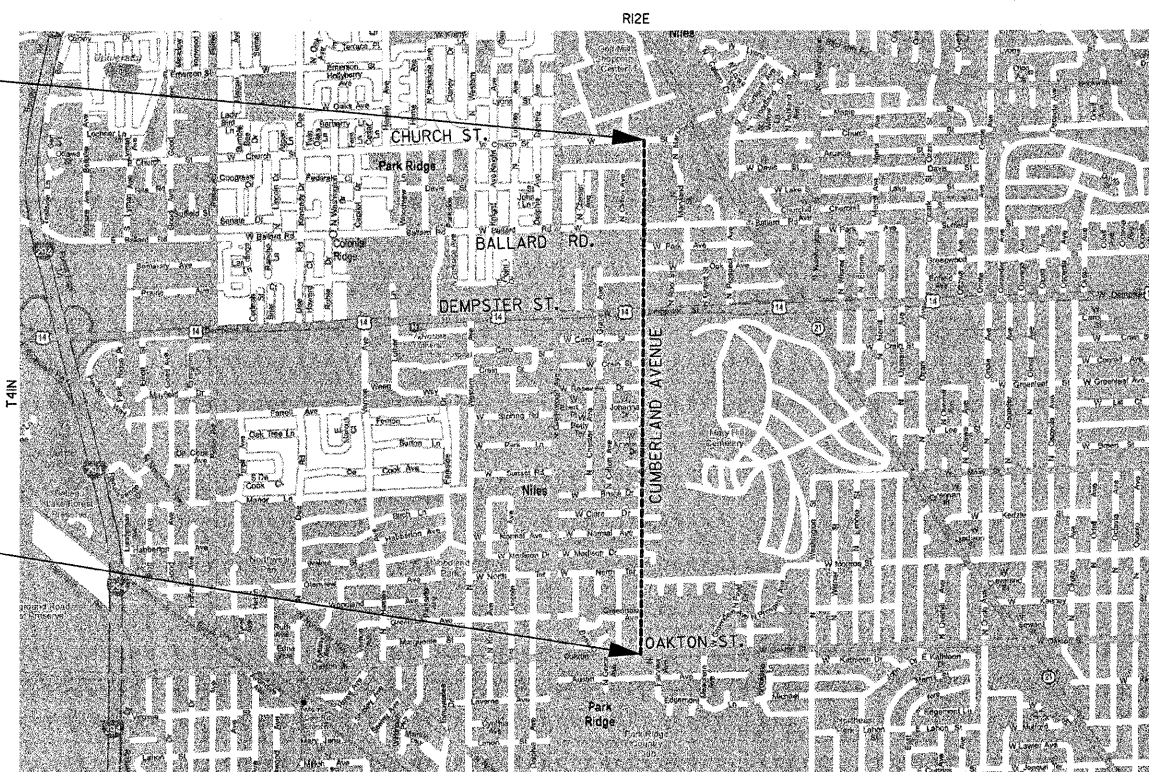

LOCATION MAP SCALE: NTS

GROSS LENGTH OF PROJECT = 7,910.5 FEET (1.498 MILES)
NET LENGTH OF PROJECT = 7,812.7 FEET (1.480 MILES)

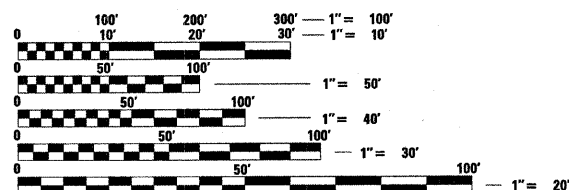

FULL SIZE PLANS HAVE BEEN PREPARED USING STANDARD ENGINEERING SCALES. REDUCED SIZED PLANS WILL NOT CONFORM TO STANDARD SCALES. IN MAKING MEASUREMENTS ON REDUCED PLANS, THE ABOVE SCALES MAY BE USED.

J.U.L.I.E.
JOINT UTILITY LOCATION INFORMATION FOR EXCAVATION
1-800-892-0123

CONTRACT NO. 83998

F.A.P. RTE.	SECTION	COUNTY	TOTAL SHEETS	SHEET NO.
2793	06-00109-00-WR	COOK	24	2
STA.		TO STA.		
FED. ROAD DIST. NO.		ILLINOIS	FED. AID PROJECT	

INDEX OF SHEETS

SHEET NO.	DESCRIPTION
1	TITLE SHEET
2	INDEX OF SHEETS, HIGHWAY STANDARDS AND GENERAL NOTES
3	SUMMARY OF QUANTITIES
4-5	TYPICAL SECTIONS
6-11	PLAN AND PROFILE SHEETS
12	SUGGESTED STAGES OF CONSTRUCTION AND TRAFFIC CONTROL
13-15	PAVEMENT MARKING DETAILS
16	LANDSCAPING AND EROSION CONTROL DETAILS
17	DETECTOR LOOPS REMOVAL AND REPLACEMENT
<u>DISTRICT DETAILS</u>	
18	DRIVEWAY DETAILS DISTANCE BETWEEN ROW AND FENCE OF CURB >15' (BD01)
19	DRIVEWAY DETAILS DISTANCE BETWEEN ROW AND FENCE OF CURB <15' (BD02)
20	FRAMES AND LIDS ADJUSTMENT WITH MILLING, FRAMES AND LIDS ADJUSTMENT WITHOUT MILLING (BD08)
21	CURB OR CURB AND GUTTER REMOVAL AND REPLACEMENT (BD24)
22	BUTT JOINTS AND HMA TAPER (BD32)
23	TRAFFIC CONTROL AND PROTECTION FOR SIDE ROADS, INTERSECTIONS AND DRIVEWAYS (TC10)
24	DISTRICT ONE TYPICAL PAVEMENT MARKINGS (TC13)

STATE STANDARDS

000001-05	STANDARD SYMBOLS, ABBREVIATIONS AND PATTERNS (8 SHEETS)
424001-05	CURB RAMPS FOR SIDEWALKS (2 SHEETS)
442201-03	CLASS C AND D PATCHES
602001	CATCH BASIN TYPE A
604001-02	FRAME AND LIDS TYPE 1
604051-02	FRAME AND GRATE TYPE 11
606001-03	CONCRETE CURB TYPE B AND COMBINATION CURB AND GUTTER (2 SHEETS)
701311-02	LANE CLOSURE 2L, 2W MOVING OPERATIONS-DAY ONLY
701501-04	URBAN LANE CLOSURE, 2L, 2W, UNDIVIDED
701701-05	URBAN LANE CLOSURE, MULTILANE INTERSECTION
701801-03	LANE CLOSURE MULTILANE 1W OR 2W CROSSWALK OR SIDEWALK CLOSURE
701901	TRAFFIC CONTROL DEVICES (3 SHEETS)
720011	METAL POSTS FOR SIGN, MARKERS & DELINEATORS
729001	APPLICATIONS OF TYPES A & B METAL POSTS (FOR SIGNS & MARKERS)
780001-01	TYPICAL PAVEMENT MARKINGS (2 SHEETS)

GENERAL NOTES

SPECIFICATIONS, STANDARDS AND SPECIAL PROVISIONS

- ALL CONSTRUCTION SHALL BE DONE IN ACCORDANCE WITH THE FOLLOWING STATE OF ILLINOIS STANDARD SPECIFICATIONS: THE "STANDARD SPECIFICATIONS FOR ROAD AND BRIDGE CONSTRUCTION" ADOPTED JANUARY 1, 2007 (REFERRED TO AS THE "STANDARD SPECIFICATIONS"), "STANDARD SPECIFICATIONS FOR WATER & SEWER MAIN CONSTRUCTION IN ILLINOIS" THE LATEST EDITION, THE "ILLINOIS MANUAL ON UNIFORM TRAFFIC CONTROL DEVICES FOR STREETS AND HIGHWAYS" THE LATEST EDITION OF "STANDARD SPECIFICATIONS FOR TRAFFIC ITEMS", THE LATEST EDITION OF THE "SUPPLEMENTAL SPECIFICATIONS AND RECURRING SPECIAL PROVISIONS", AND THE DETAILS IN THE SPECIAL PROVISIONS INCLUDED IN THE CONTRACT DOCUMENTS.
- ANY REFERENCES TO STANDARDS THROUGHOUT THE PLANS OR SPECIAL PROVISIONS SHALL BE INTERPRETED AS THE LATEST STANDARD OF THE DEPARTMENT.
- ALL TRAFFIC CONTROL AND OTHER ADVISORY SIGNS NEEDED FOR CONSTRUCTION ARE TO BE FURNISHED BY THE CONTRACTOR IN ACCORDANCE WITH ARTICLE 107.14 OF THE STANDARD SPECIFICATIONS.

UTILITIES

4. THE CONTRACTOR SHALL BE RESPONSIBLE FOR CONTACTING THE OWNERS OF ALL UTILITIES PRIOR TO CONSTRUCTION TO DETERMINE THE LOCATION OF ALL UTILITY EQUIPMENT. THE CONTRACTOR SHALL COOPERATE WITH ALL UTILITY OWNERS AS PROVIDED FOR IN THE STANDARD SPECIFICATIONS IF UTILITY RELOCATION, ADJUSTMENT OR PROTECTION IS NECESSARY.

5. THE LOCATION ON THE PLANS OF EXISTING DRAINAGE STRUCTURES, STORM SEWERS, WATER MAINS, SANITARY SEWERS, AND ANY OTHER PUBLIC AND PRIVATE UTILITIES IS APPROXIMATE AND THEIR EXACT LOCATION IS TO BE DETERMINED IN THE FIELD BY THE CONTRACTOR AS INCLUDED IN THE CONTRACT.

6. THE CONTRACTOR SHALL BE RESPONSIBLE FOR THE PROTECTION OF ALL UNDERGROUND OR SURFACE UTILITIES EVEN THOUGH THEY MAY NOT BE SHOWN ON THE PLANS. ANY UTILITY THAT IS DAMAGED DURING CONSTRUCTION SHALL BE REPAIRED OR REPLACED TO THE SATISFACTION OF THE OWNER. THIS WORK SHALL BE AT THE CONTRACTOR'S EXPENSE.

STAKING

7. THE CONTRACTOR SHALL PROTECT AND CAREFULLY PRESERVE ALL SECTION OR SUBSECTION MONUMENTS, PROPERTY CORNERS AND REFERENCE MARKERS UNTIL THE OWNER, HIS AGENT OR A PROFESSIONAL LAND SURVEYOR HAS WITNESSED OR OTHERWISE REFERENCED THEIR LOCATIONS.

8. ALL RADII FOR PROPOSED CURB AND GUTTER ARE TO THE EDGE OF THE PAVEMENT, UNLESS OTHERWISE NOTED.

9. UNLESS OTHERWISE NOTED, THE OFFSETS TO MANHOLES ARE TO THE CENTER OF THE STRUCTURE, OFFSETS TO CATCH BASINS AND INLETS ARE TO THE EDGE OF THE PAVEMENT.

10. ALL ELEVATIONS ARE U.S.G.S. DATUM.

SEWERS AND WATER MAINS

11. WHENEVER ANY LOOSE MATERIAL IS DEPOSITED IN THE FLOW LINE OF DRAINAGE STRUCTURES SUCH THAT THE NATURAL FLOW OF WATER IS OBSTRUCTED, THE MATERIAL SHALL BE REMOVED AT THE CLOSE OF EACH WORKING DAY. PRIOR TO ACCEPTANCE OF THE IMPROVEMENT, ALL DRAINAGE STRUCTURES SHALL BE FREE OF DIRT AND DEBRIS. THIS WORK WILL NOT BE PAID FOR SEPARATELY, BUT SHALL BE INCLUDED IN THE CONTRACT.

12. WHEN EXISTING DRAINAGE FACILITIES ARE DISTURBED, THE CONTRACTOR SHALL PROVIDE AND MAINTAIN IN AN OPERATING CONDITION TEMPORARY OUTLETS AND CONNECTIONS FOR ALL DRAINS, SEWERS AND CATCH BASINS. THIS WORK WILL NOT BE PAID FOR SEPARATELY, BUT SHALL BE INCLUDED IN THE CONTRACT.

13. THE CONTRACTOR SHALL MAINTAIN THE SURFACE DRAINAGE OF THE ROAD DURING CONSTRUCTION OF THIS PROJECT. WHEN EXISTING DRAINAGE FACILITIES ARE DISTURBED, THE CONTRACTOR SHALL PROVIDE AND MAINTAIN TEMPORARY OUTLETS AND CONNECTIONS FOR ALL PRIVATE OR PUBLIC DRAINS, SEWERS INLETS OR CATCH BASINS. HE SHALL PROVIDE FACILITIES TO TAKE IN ALL STORM WATER WHICH WILL BE RECEIVED BY THESE DRAINS AND SEWERS AND DISCHARGE SAME. HE SHALL PROVIDE AND MAINTAIN A TEMPORARY OUTLET, AND BE PREPARED AT ALL TIMES TO DISPOSE OF THE WATER RECEIVED FROM THESE TEMPORARY CONNECTIONS UNTIL SUCH TIME AS THE PERMANENT CONNECTIONS WITH SEWERS ARE BUILT AND IN SERVICE. THIS WORK SHALL NOT BE PAID FOR DIRECTLY, BUT WILL BE CONSIDERED INCLUDED IN THE CONTRACT. UNLESS OTHERWISE NOTED ON PLANS.

BACKFILL

14. STORM SEWERS AND WATER MAINS SHALL BE BACKFILLED IN ACCORDANCE WITH ARTICLE 550.07, METHOD 1 ONLY AND VILLAGE OF NILES SPECIFICATIONS.

P.C. CONCRETE

15. TYPE "A" SIDEWALK RAMPS FOR THE HANDICAPPED SHALL BE INSTALLED AT ALL INTERSECTING STREETS AND DRIVEWAYS PER CURRENT IDOT STANDARD AT LOCATIONS WHERE SIDEWALK IS SHOWN ON PLAN.

MISCELLANEOUS

16. THE CONTRACTOR SHALL PROVIDE ACCESS TO ABUTTING PROPERTY AT ALL TIMES DURING CONSTRUCTION OF THE PROJECT. THIS WORK SHALL BE IN ACCORDANCE WITH APPLICABLE PORTIONS OF SECTION 402 OF THE STANDARD SPECIFICATIONS.

17. IT IS THE CONTRACTOR'S RESPONSIBILITY TO ASCERTAIN EXISTING FIELD CONDITIONS BEFORE BIDDING ON THIS CONTRACT.

18. WHERE NEW WORK MEETS EXISTING FEATURES TO REMAIN, FIELD CHECK ALL DIMENSIONS AND ELEVATIONS BEFORE PROCEEDING WITH CONSTRUCTION. NOTIFY ENGINEER IMMEDIATELY OF ANY DISCREPANCIES.

19. THE CONTRACTOR WILL BE REQUIRED TO COMPLY WITH ALL STATE REGULATIONS REGARDING AIR, WATER AND NOISE POLLUTION. THE CONTRACTOR IS PROHIBITED FROM BURNING ANY MATERIAL WITHIN OR ADJACENT TO THE IMPROVEMENTS.

20. 10' TRANSITIONS SHALL BE USED TO MATCH PROPOSED CURB & GUTTER TO EXISTING CURBS & GUTTERS IN THE FIELD, UNLESS OTHERWISE SHOWN. THE TRANSITIONS SHALL BE PAID FOR AT THE CONTRACT UNIT PRICE FOR THE PROPOSED ITEMS OF WORK SPECIFIED.

21. THE CONTRACTOR SHALL SAW CUT THE EXISTING PAVEMENT AT A FULL DEPTH PRIOR TO PAVEMENT REMOVAL ON SIDE STREETS, DRIVEWAYS AND PROJECT LIMITS AS SHOWN ON PLANS. THE COST OF FULL DEPTH SAW CUT SHALL BE INCLUDED IN THE COST OF VARIOUS ITEMS OF PAVEMENT REMOVAL AND OTHER REMOVAL ITEMS).

22. POROUS GRANULAR EMBANKMENT, SUBGRADE (PGES) HAS BEEN PROVIDED FOR USE AT THE LOCATIONS INDICATED FOR SOILS THAT TEND TO BE UNSUITABLE OR UNSTABLE. THE ACTUAL NEED FOR REMOVAL AND REPLACEMENT WITH PGES WILL BE DETERMINED IN THE FIELD AT THE TIME OF CONSTRUCTION BY THE GEOTECHNICAL ENGINEER. ALL POTENTIALLY UNSTABLE SOILS SHOULD BE TESTED WITH A STATIC CONE PENETROMETER AND TREATED IN ACCORDANCE WITH ARTICLE 301.03 AND THE IDOT SUBGRADE STABILITY MANUAL. IF UNSTABLE AND/OR UNSUITABLE MATERIAL IS NOT ENCOUNTERED, THEN THE QUANTITY SHALL BE DEDUCTED AND NO ADDITIONAL COMPENSATION WILL BE DUE TO THE CONTRACTOR.

REVISIONS	
NAME	DATE

ILLINOIS DEPARTMENT OF TRANSPORTATION
 VILLAGE OF NILES
 CUMBERLAND AVENUE RESURFACING/WIDENING
 OAKTON STREET TO CHURCH STREET

INDEX OF SHEETS, STATE STANDARDS AND GENERAL NOTES

SCALE: VERT. N.T.S.
 HORIZ. N.T.S.

DRAWN BY JTF
 CHECKED BY BA

PLOT DATE = 1/29/2008
 FILE NAME = 8662358
 PLOT SCALE = *SCALE*
 USER NAME = *USER*

F.A.P. RTE.	SECTION	COUNTY	TOTAL SHEETS	SHEET NO.
2794	06-00109-00-WR	COOK	24	6
STA. 49+50		TO STA. 60+00		
FED. ROAD DIST. NO.	ILLINOIS	FED. AID PROJECT		



PLAN	DATE
BY	
REVISIONS	
NO.	
DATE	
BY	
DESCRIPTION	

PROFILE	DATE
BY	
REVISIONS	
NO.	
DATE	
BY	
DESCRIPTION	

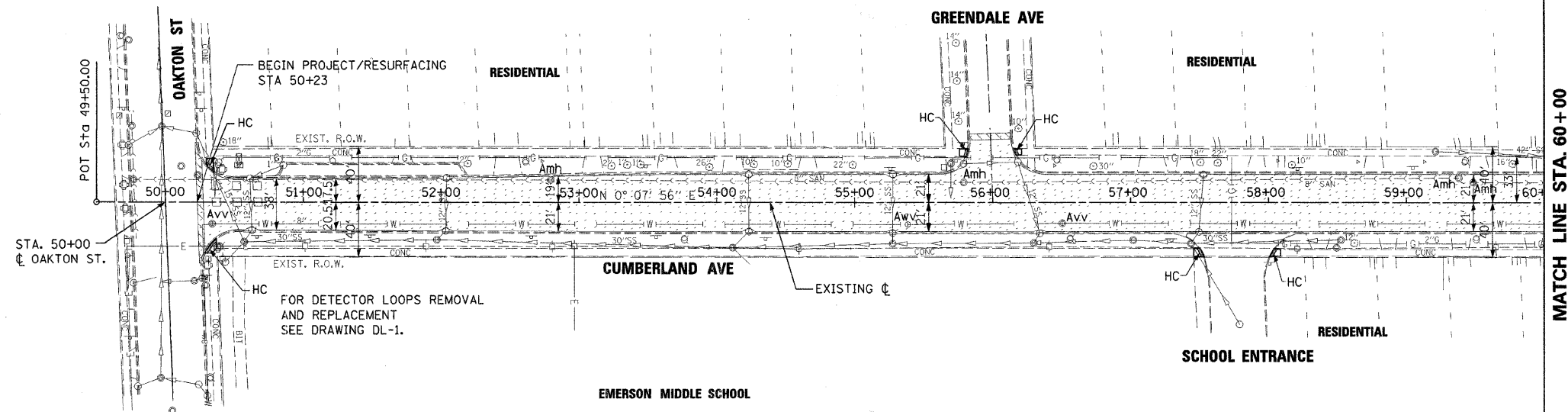

LEGEND

- PROPOSED BUTT JOINT (HOT-MIX ASPHALT REMOVAL - BUTT JOINT)
- PROPOSED PAVEMENT RESURFACING (HOT-MIX ASPHALT SURFACE REMOVAL, 4" HOT-MIX ASPHALT SURFACE COURSE, MIX D, N70 HOT-MIX ASPHALT BINDER COURSE, IL-19, N70)
- PROPOSED PAVEMENT WIDENING (HOT-MIX ASPHALT SURFACE COURSE, MIX D, N70 HOT-MIX ASPHALT BINDER COURSE, IL-19, N70 HOT-MIX ASPHALT BASE COURSE SUB-BASE GRANULAR MATERIAL, TYPE B COMBINATION CONC. CURB & GUTTER, TYPE B-6.12)
- PROPOSED PCC DRIVEWAY (DRIVEWAY PAVEMENT REMOVAL PCC DRIVEWAY PAVEMENT, 8")
- SIDEWALK REMOVAL
- Acb CATCH BASIN TO BE ADJUSTED
- Amh SANITARY/STORM MANHOLE TO BE ADJUSTED
- Avv VALVE VAULT TO BE ADJUSTED
- HC HANDICAP ACCESSIBLE RAMP WITH DETECTABLE WARNINGS

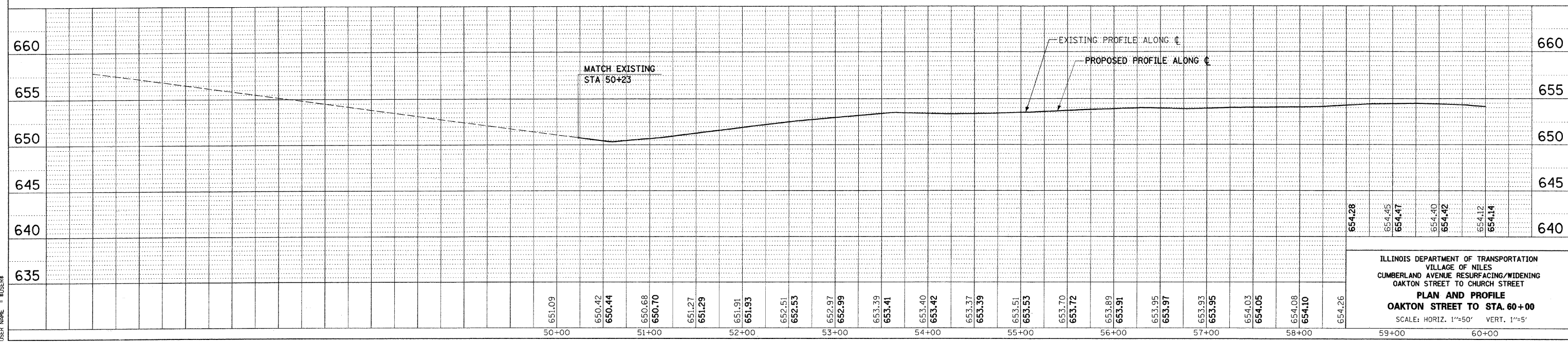

ILLINOIS DEPARTMENT OF TRANSPORTATION
 VILLAGE OF NILES
 CUMBERLAND AVENUE RESURFACING/WIDENING
 OAKTON STREET TO CHURCH STREET
PLAN AND PROFILE
 OAKTON STREET TO STA. 60+00
 SCALE: HORIZ. 1"=50' VERT. 1"=5'

PLOT DATE = 1/24/2008
 FILE NAME = 4866598
 USER NAME = 4150818

F.A.P. RTE.	SECTION	COUNTY	TOTAL SHEETS	SHEET NO.
2794	06-00109-00-WR	COOK	24	7
STA. 60+00		TO STA. 74+00		
FED. ROAD DIST. NO.	ILLINOIS	FED. AID PROJECT		

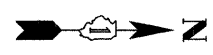

PLAN	REVISIONS	DATE
NO.	BY	
NO.	BY	
NO.	BY	
NO.	BY	

PROFILE	REVISIONS	DATE
NO.	BY	
NO.	BY	
NO.	BY	
NO.	BY	

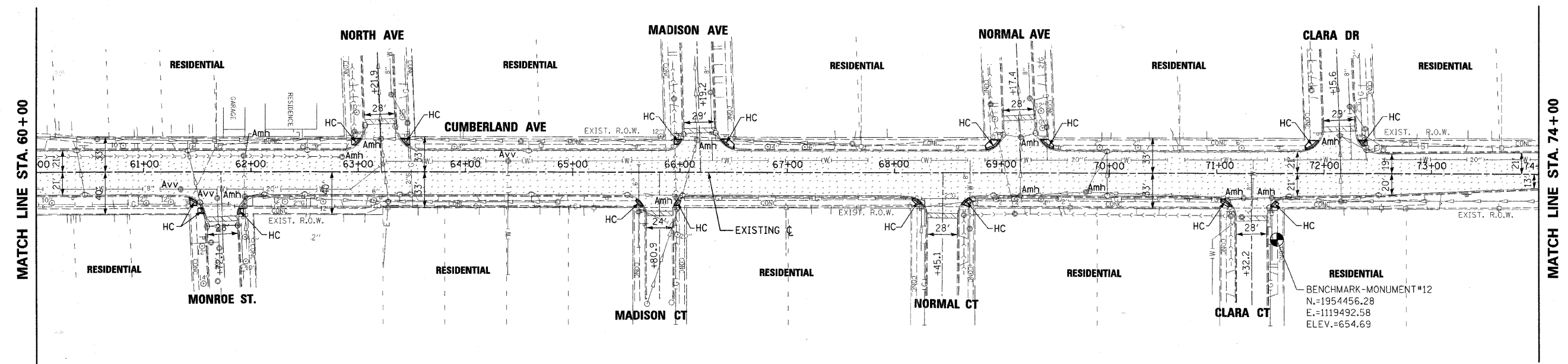

LEGEND

	PROPOSED BUTT JOINT (HOT-MIX ASPHALT REMOVAL - BUTT JOINT)		PROPOSED PCC DRIVEWAY (DRIVEWAY PAVEMENT REMOVAL - PCC DRIVEWAY PAVEMENT, 8")
	PROPOSED PAVEMENT RESURFACING (HOT-MIX ASPHALT SURFACE COURSE, MIX D, N70 HOT-MIX ASPHALT BINDER COURSE, IL-19, N70)		SIDEWALK REMOVAL
	PROPOSED PAVEMENT WIDENING (HOT-MIX ASPHALT SURFACE COURSE, MIX D, N70 HOT-MIX ASPHALT BINDER COURSE, IL-19, N70 HOT-MIX ASPHALT BASE COURSE SUB-BASE GRANULAR MATERIAL, TYPE B COMBINATION CONC. CURB & GUTTER, TYPE B-6.12)	Acb	CATCH BASIN TO BE ADJUSTED
		Amh	SANITARY/STORM MANHOLE TO BE ADJUSTED
		Avv	VALVE VAULT TO BE ADJUSTED
		HC	HANDICAP ACCESSIBLE RAMP WITH DETECTABLE WARNINGS

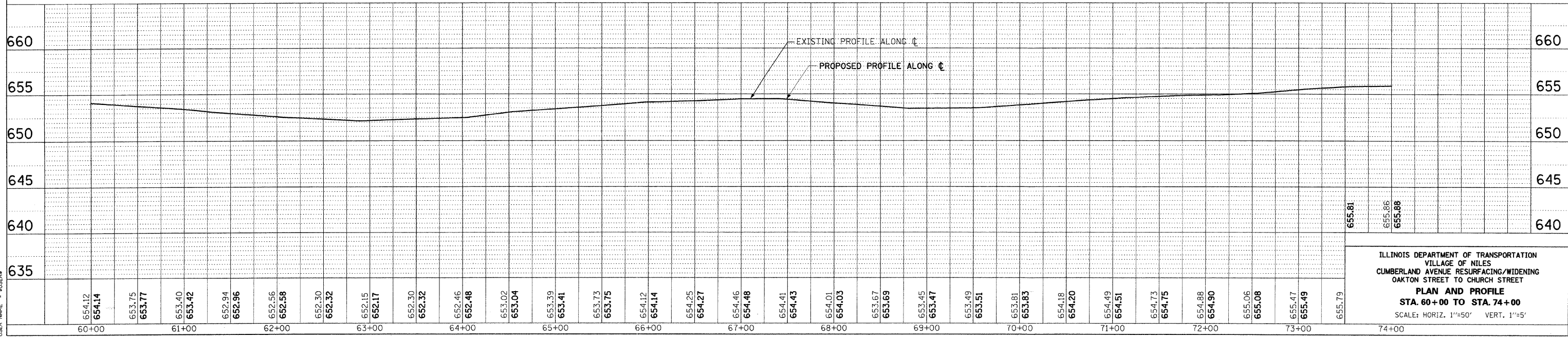

ILLINOIS DEPARTMENT OF TRANSPORTATION
 VILLAGE OF NILES
 CUMBERLAND AVENUE RESURFACING/WIDENING
 OAKTON STREET TO CHURCH STREET
PLAN AND PROFILE
 STA. 60+00 TO STA. 74+00
 SCALE: HORIZ. 1"=50' VERT. 1"=5'

PLOT DATE = 1/29/2008
 PLOT SCALE = AS SHOWN
 USER NAME = #USER#

F.A.P. RTE.	SECTION	COUNTY	TOTAL SHEETS	SHEET NO.
2794	06-00109-00-WR	COOK	24	8
STA. 74+00		TO STA. 87+00		
FED. ROAD DIST. NO.		ILLINOIS	FED. AID PROJECT	

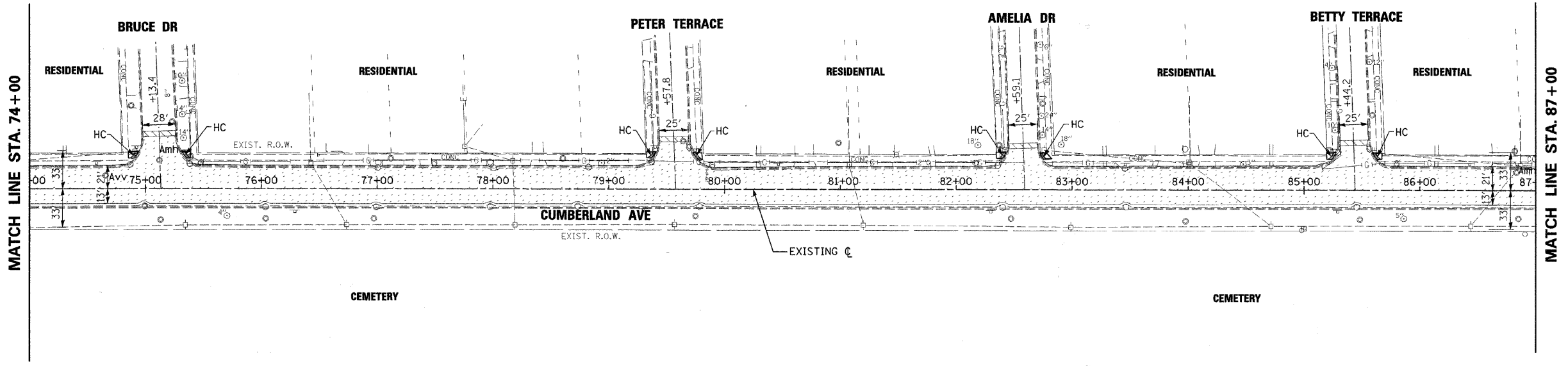
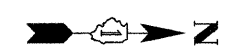

PLAN	SUBMITTED	BY	DATE
NO. _____	_____	_____	_____

PROFILE	SUBMITTED	BY	DATE
NO. _____	_____	_____	_____

LEGEND

- PROPOSED BUTT JOINT (HOT-MIX ASPHALT REMOVAL - BUTT JOINT)
- PROPOSED PCC DRIVEWAY (DRIVEWAY PAVEMENT REMOVAL PCC DRIVEWAY PAVEMENT, 8")
- PROPOSED PAVEMENT RESURFACING (HOT-MIX ASPHALT SURFACE REMOVAL, 4" HOT-MIX ASPHALT SURFACE COURSE, MIX D, N70 HOT-MIX ASPHALT BINDER COURSE, IL-19, N70)
- SIDEWALK REMOVAL
- PROPOSED PAVEMENT WIDENING (HOT-MIX ASPHALT SURFACE COURSE, MIX D, N70 HOT-MIX ASPHALT BINDER COURSE, IL-19, N70 HOT-MIX ASPHALT BASE COURSE SUB-BASE GRANULAR MATERIAL, TYPE B COMBINATION CONC. CURB & GUTTER, TYPE B-6.12)
- Acb CATCH BASIN TO BE ADJUSTED
- Amh SANITARY/STORM MANHOLE TO BE ADJUSTED
- Avv VALVE VAULT TO BE ADJUSTED
- HC HANDICAP ACCESSIBLE RAMP WITH DETECTABLE WARNINGS

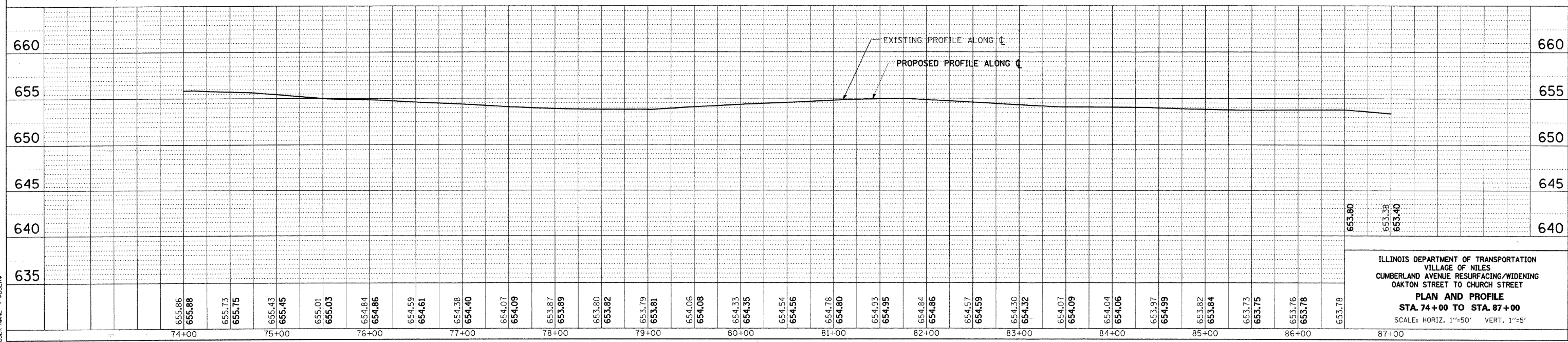

ILLINOIS DEPARTMENT OF TRANSPORTATION
 VILLAGE OF NILES
 CUMBERLAND AVENUE RESURFACING/WIDENING
 OAKTON STREET TO CHURCH STREET
PLAN AND PROFILE
 STA. 74+00 TO STA. 87+00
 SCALE: HORIZ. 1"=50' VERT. 1"=5'

PLOT DATE = 1/29/2008
 PLOT SCALE = 85/3216
 USER NAME = #158R#

F.A.P. RTE.	SECTION	COUNTY	TOTAL SHEETS	SHEET NO.
2793	06-00109-00-WR	COOK	24	12
STA. 115+00		TO STA. 130+00		
FED. ROAD DIST. NO.		ILLINOIS FED. AID PROJECT		

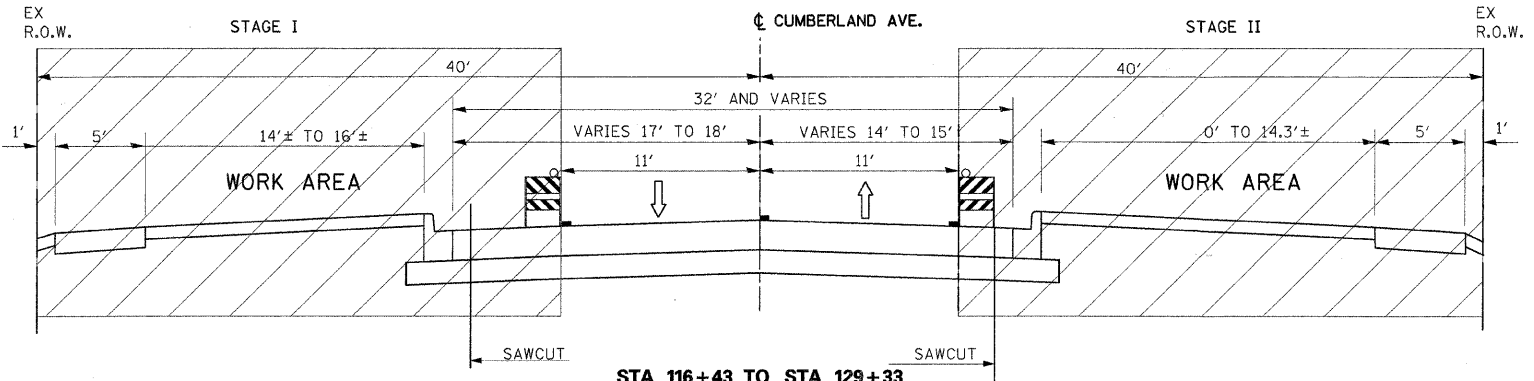
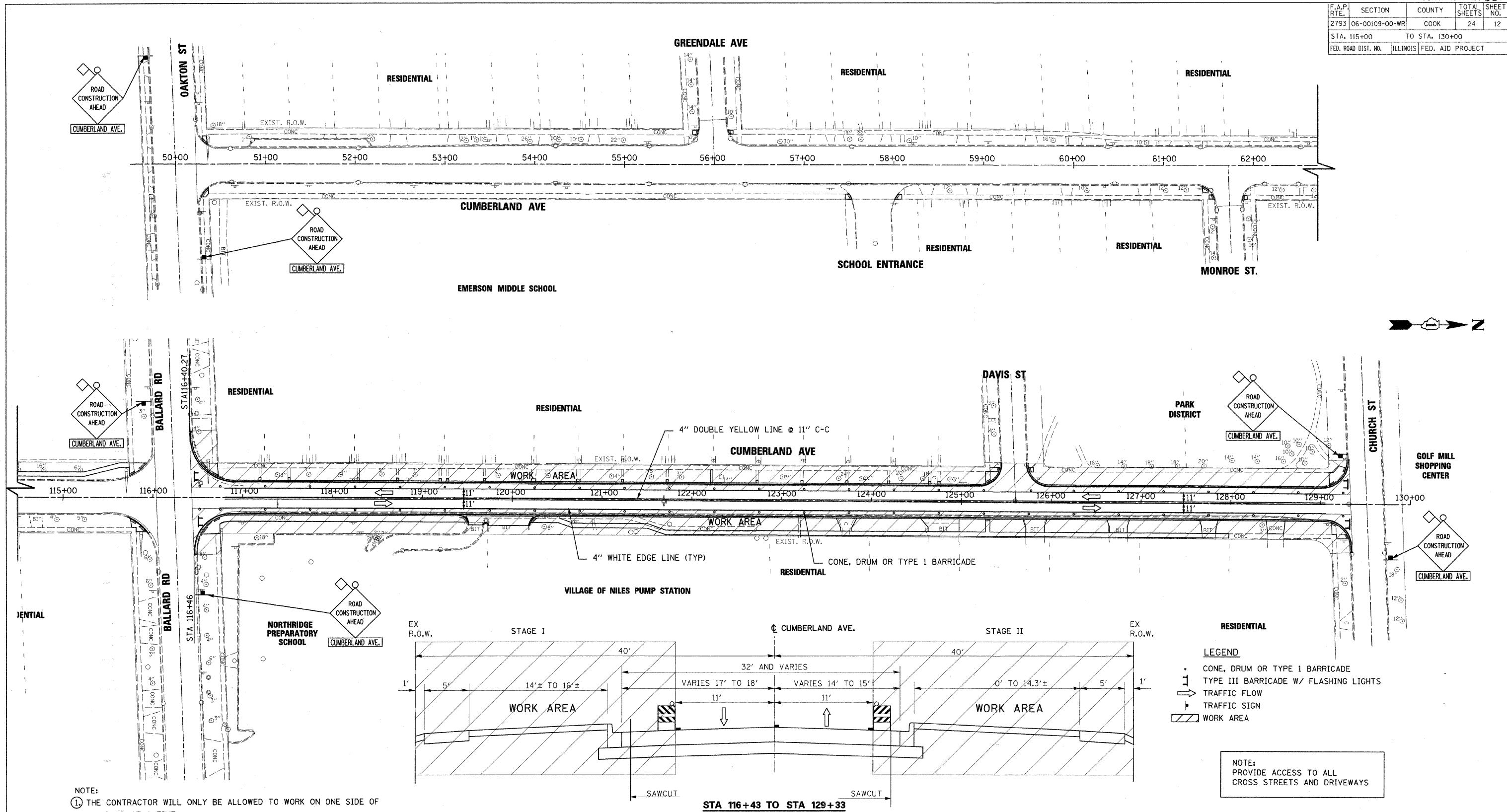

LEGEND

- CONE, DRUM OR TYPE 1 BARRICADE
- ⊥ TYPE III BARRICADE W/ FLASHING LIGHTS
- TRAFFIC FLOW
- ⊥ TRAFFIC SIGN
- ▨ WORK AREA

NOTE:
PROVIDE ACCESS TO ALL CROSS STREETS AND DRIVEWAYS

- NOTE:**
1. THE CONTRACTOR WILL ONLY BE ALLOWED TO WORK ON ONE SIDE OF THE ROAD AT A TIME.
 2. ADDITIONAL SUB-STAGES MAY BE REQUIRED BY THE CONTRACTOR WHERE ENCROACHMENT ON THE PAVEMENT WILL REQUIRE THE CLOSURE OF TRAFFIC TO ONE-WAY/ONE LANE OPERATION. THE CONTRACTOR IS REQUIRED TO PROVIDE A FLAGGER WITH TRAFFIC CONTROL SIGNS ON EACH END, IN ACCORDANCE WITH STANDARD 701501-04. THIS CLOSURE WILL BE PERMITTED BETWEEN THE HOURS OF 9:00 AM AND 3:00 PM. AT ALL OTHER TIMES, A MINIMUM OF ONE LANE OF TRAFFIC IN EACH DIRECTION WILL BE MAINTAINED BY THE CONTRACTOR.

SHIFT TRAFFIC TO MIDDLE LANES
PROVIDE 11' LANE IN EACH DIRECTION
WIDEN ROADWAY AS SHOWN IN TYPICAL SECTIONS

STAGE CONSTRUCTION
BALLARD ROAD TO CHURCH STREET

REVISIONS	
NAME	DATE

ILLINOIS DEPARTMENT OF TRANSPORTATION
VILLAGE OF NILES
CUMBERLAND AVENUE RESURFACING/WIDENING
OAKTON STREET TO CHURCH STREET
MAINTENANCE OF TRAFFIC
BALLARD ROAD TO CHURCH STREET
SCALE: VERT. N.T.S.
HORIZ. N.T.S.
DRAWN BY JTF
CHECKED BY BA
DATE

PLOT DATE = 1/25/2008
FILE NAME = 8080398
SCALE = 1"=40'
USER NAME = JUSEV

F.A.P. RTE.	SECTION	COUNTY	TOTAL SHEETS	SHEET NO.
2793	06-00109-00-WR	COOK	24	13
STA. 49+50		TO STA. 74+00		
FED. ROAD DIST. NO.		ILLINOIS	FED. AID PROJECT	

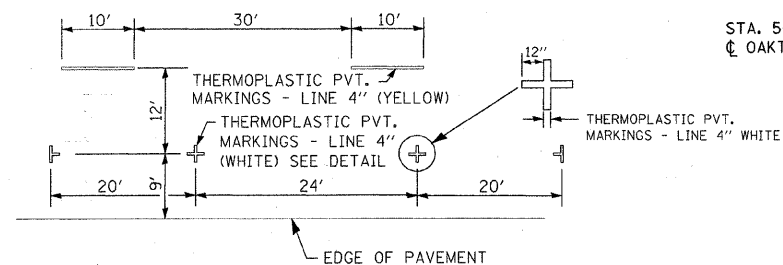
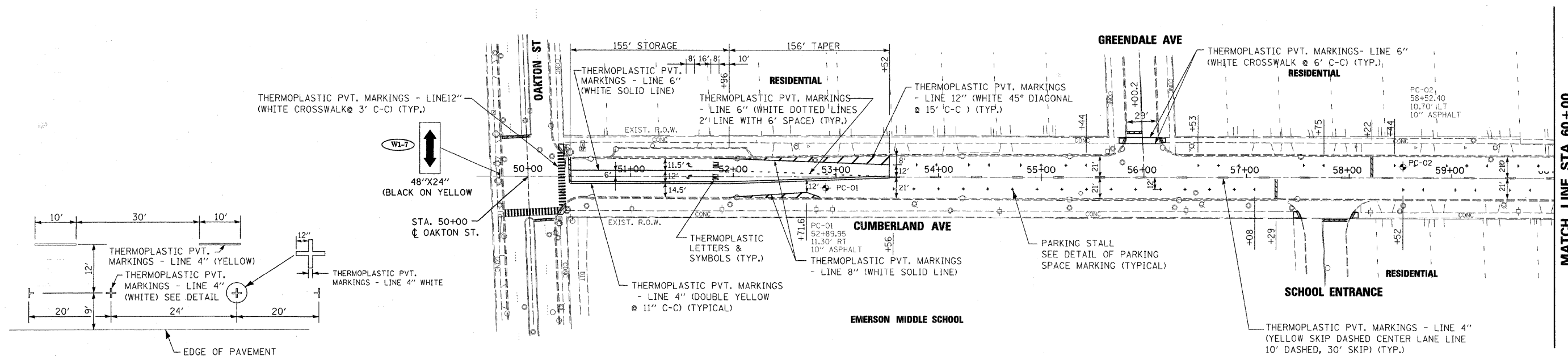

DETAIL OF PARKING SPACE MARKING
(NOT TO SCALE)

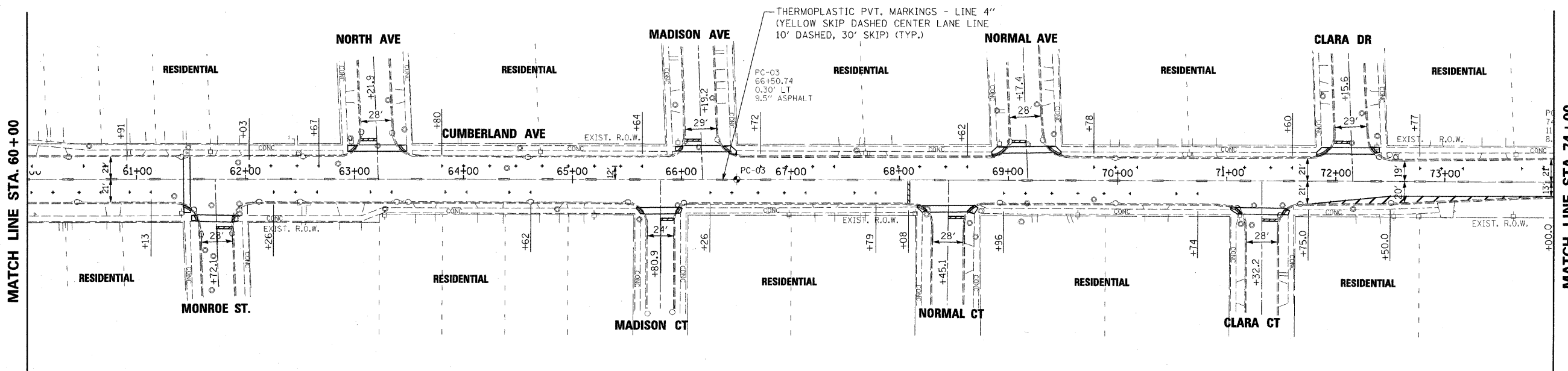

REVISIONS	
NAME	DATE

ILLINOIS DEPARTMENT OF TRANSPORTATION
VILLAGE OF NILES
CUMBERLAND AVENUE RESURFACING/WIDENING
OAKTON STREET TO CHURCH STREET
PAVEMENT MARKINGS
OAKTON STREET TO STA. 74+00
SCALE: VERT. -
HORIZ. 1" = 50'
DATE _____ DRAWN BY JTF
CHECKED BY BA

PLOT DATE = 1/25/2008
FILE NAME = 060308
PLOT SCALE = 1/8"=1'-0"
USER NAME = WISEBN

F.A.P. RTE.	SECTION	COUNTY	TOTAL SHEETS	SHEET NO.
2793	06-00109-00-WR	COOK	24	14
STA. 74+00		TO STA. 102+00		
FED. ROAD DIST. NO.	ILLINOIS	FED. AID PROJECT		

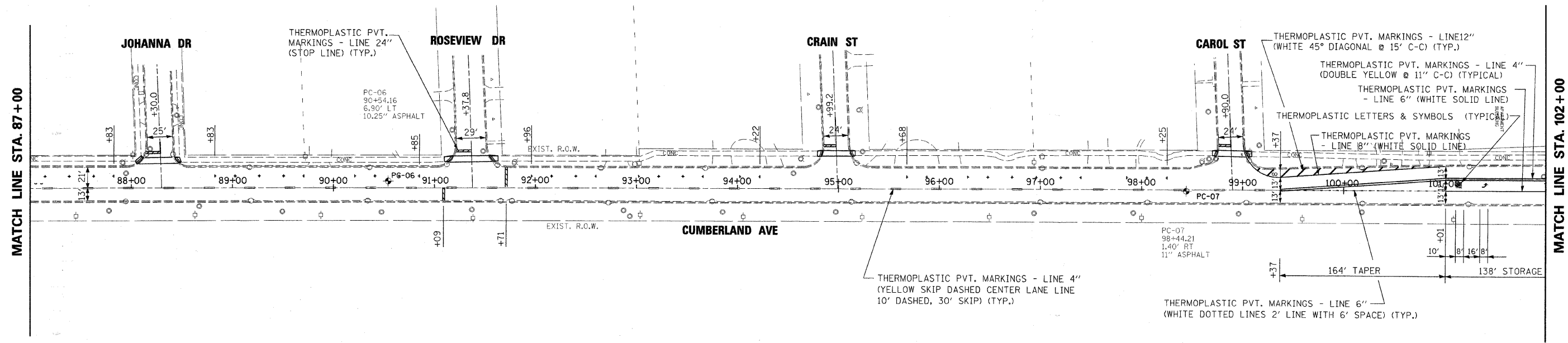
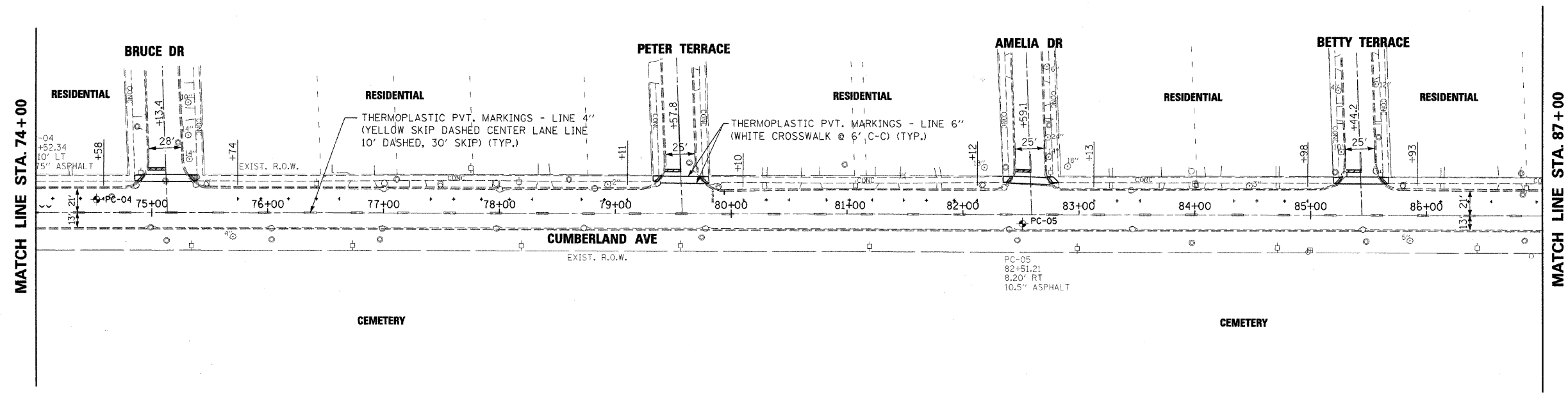
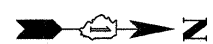

REVISIONS	
NAME	DATE

ILLINOIS DEPARTMENT OF TRANSPORTATION
 VILLAGE OF NILES
 CUMBERLAND AVENUE RESURFACING/WIDENING
 OAKTON STREET TO CHURCH STREET

PAVEMENT MARKINGS
STA. 74+00 TO STA. 102+00

SCALE: VERT. -
 HORIZ. 1" = 50'

DATE _____ DRAWN BY _____
 CHECKED BY _____

PLOT DATE = 1/23/2008
 FILE NAME = 886035*
 PLOT SCALE = 8SCALE*
 USER NAME = 8USER*

F.A.P. RTE.	SECTION	COUNTY	TOTAL SHEETS	SHEET NO.
2793	06-00109-00-WR	COOK	24	15
STA. 102+00		TO STA. 130+00		
FED. ROAD DIST. NO.		ILLINOIS FED. AID PROJECT		

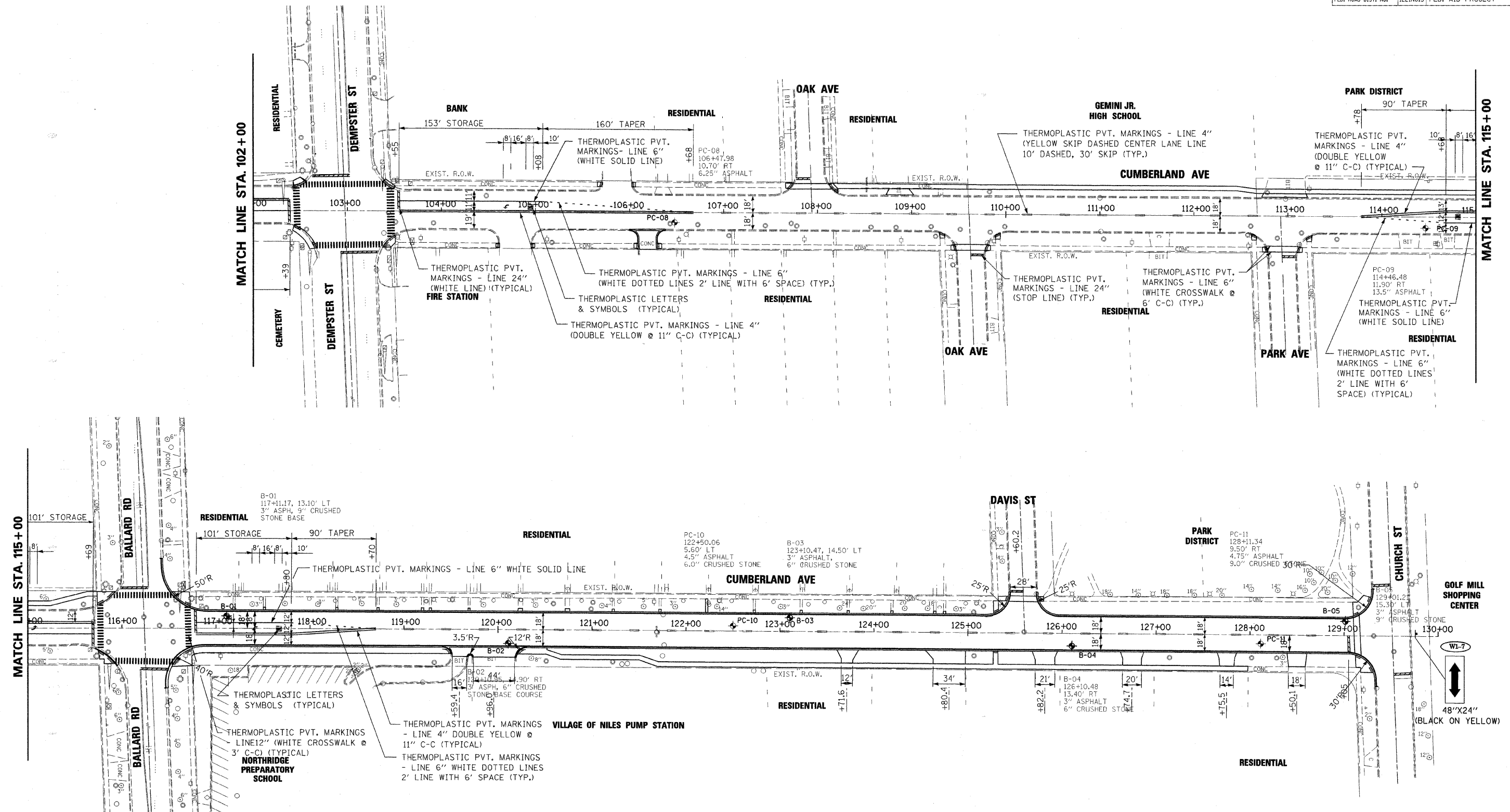
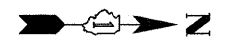

REVISIONS	
NAME	DATE

ILLINOIS DEPARTMENT OF TRANSPORTATION
 VILLAGE OF NILES
 CUMBERLAND AVENUE RESURFACING/WIDENING
 OAKTON STREET TO CHURCH STREET

PAVEMENT MARKINGS
STA. 102+00 TO CHURCH ST.

SCALE: VERT. -
 HORIZ. 1" = 50'

DATE: _____ DRAWN BY JTF
 CHECKED BY BA

PLOT DATE = 1/25/2008
 FILE NAME = 86635#
 PLOT SCALE = 1" = 50'
 USER NAME = JUSERS

F.A.P. RTE.	SECTION	COUNTY	TOTAL SHEETS	SHEET NO.
2793	06-00109-00-WR	COOK	24	16
STA. 102+00		TO STA. 130+00		
FED. ROAD DIST. NO.	ILLINOIS	FED. AID PROJECT		

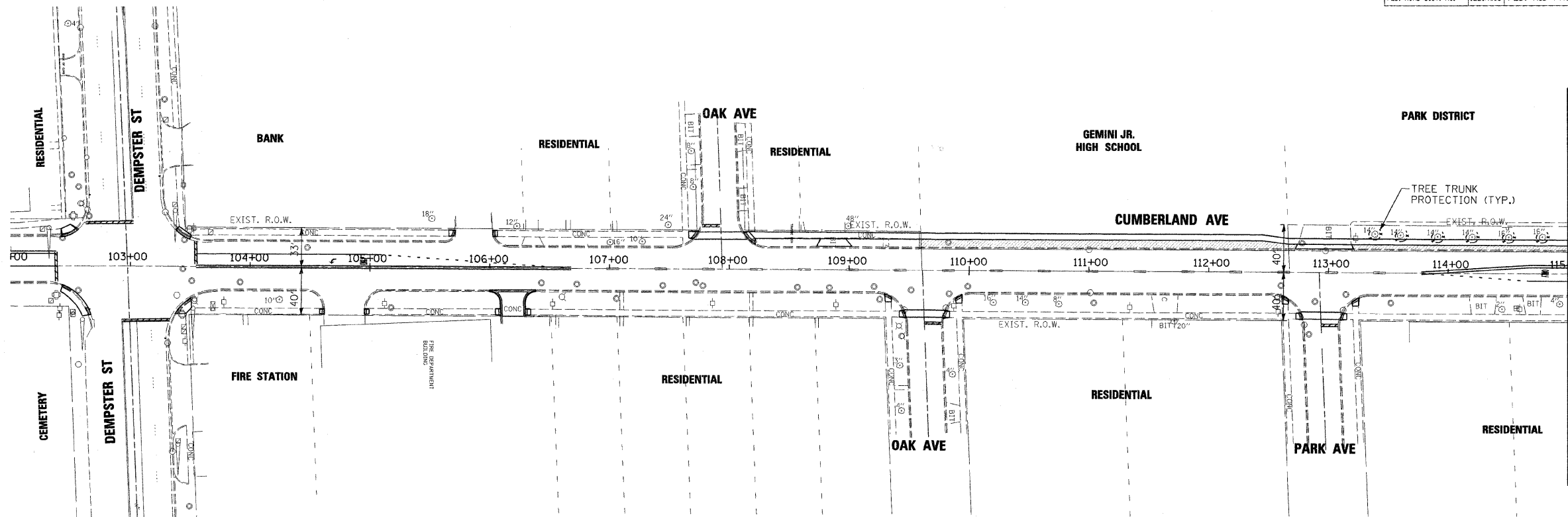

MATCH LINE STA. 115 + 00

- PROPOSED SODDING
- SEDIMENT CONTROL, DRAINAGE STRUCTURE INLET FILTER
- TREE TRUNK PROTECTION

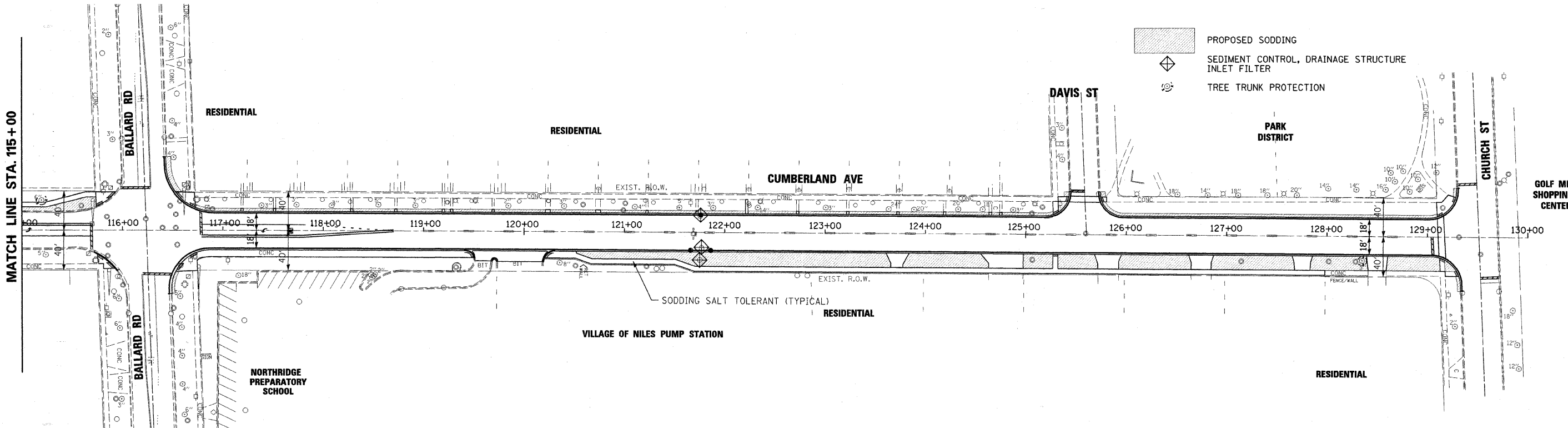

MATCH LINE STA. 115 + 00

REVISIONS	
NAME	DATE

ILLINOIS DEPARTMENT OF TRANSPORTATION
 VILLAGE OF NILES
 CUMBERLAND AVENUE RESURFACING/WIDENING
 OAKTON STREET TO CHURCH STREET

LANDSCAPING PLAN
DEMPSTER STREET TO CHURCH STREET

SCALE: VERT. -
 HORIZ. 1" = 50'

DATE _____ DRAWN BY JTF
 CHECKED BY BA

PLOT DATE = 1/25/2008
 FILE NAME = 866358
 PLOT SCALE = \$SCALE\$
 USER NAME = \$USER\$

F.A.P. RTE.	SECTION	COUNTY	TOTAL SHEETS	SHEET NO.
2793	06-00109-00-WR	COOK	24	17
STA.		TO STA.		
FED. ROAD DIST. NO.		ILLINOIS FED. AID PROJECT		

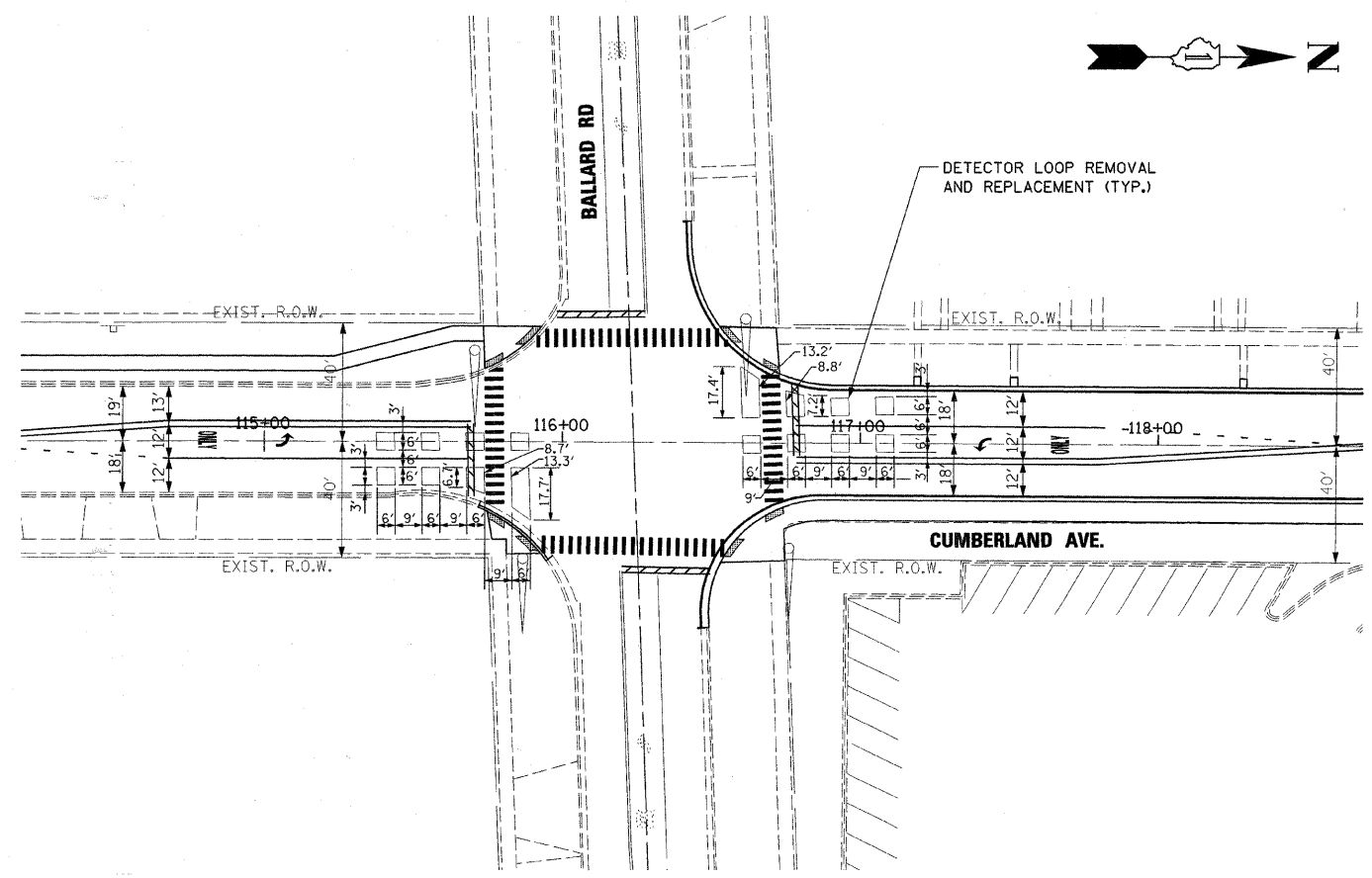
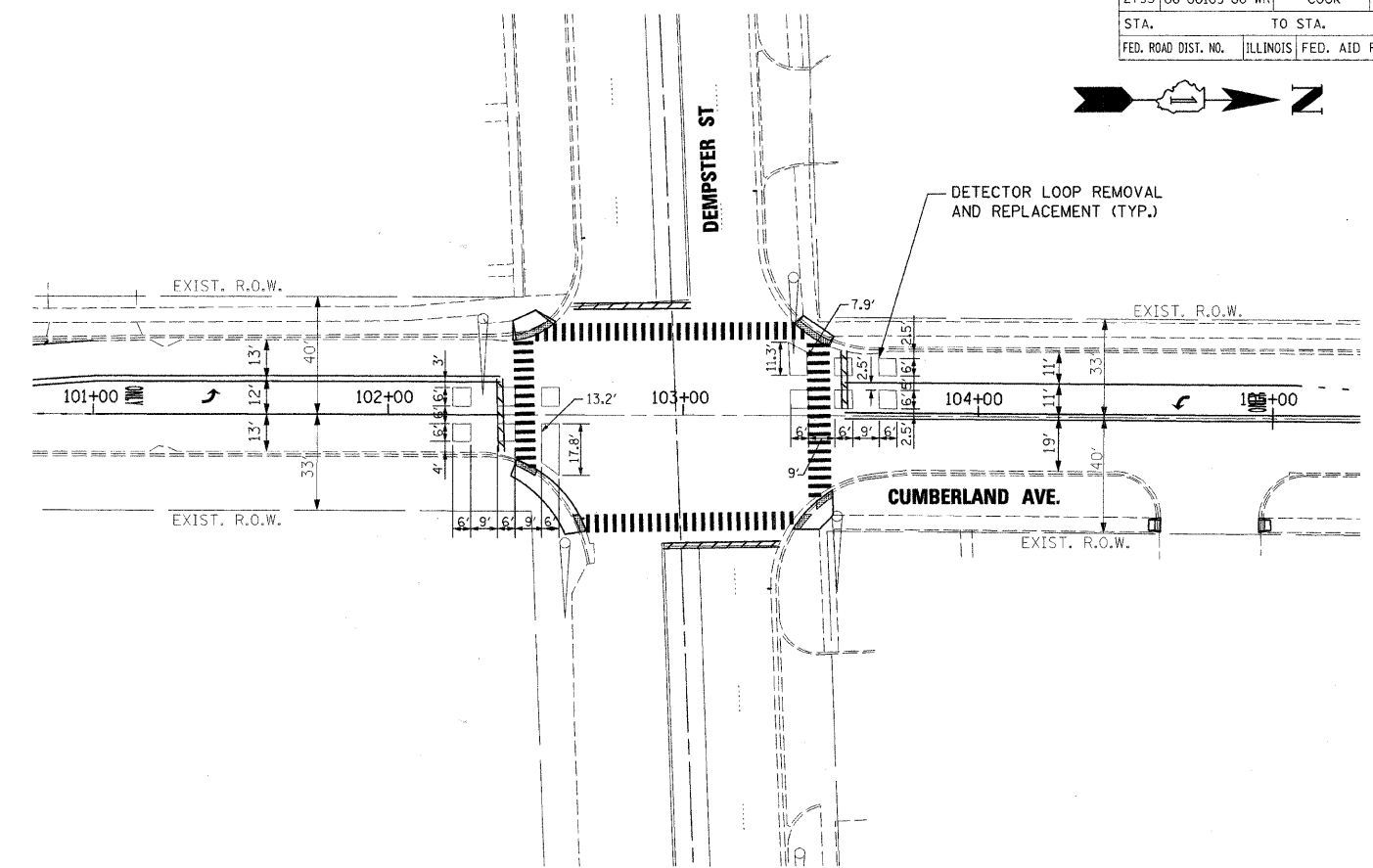
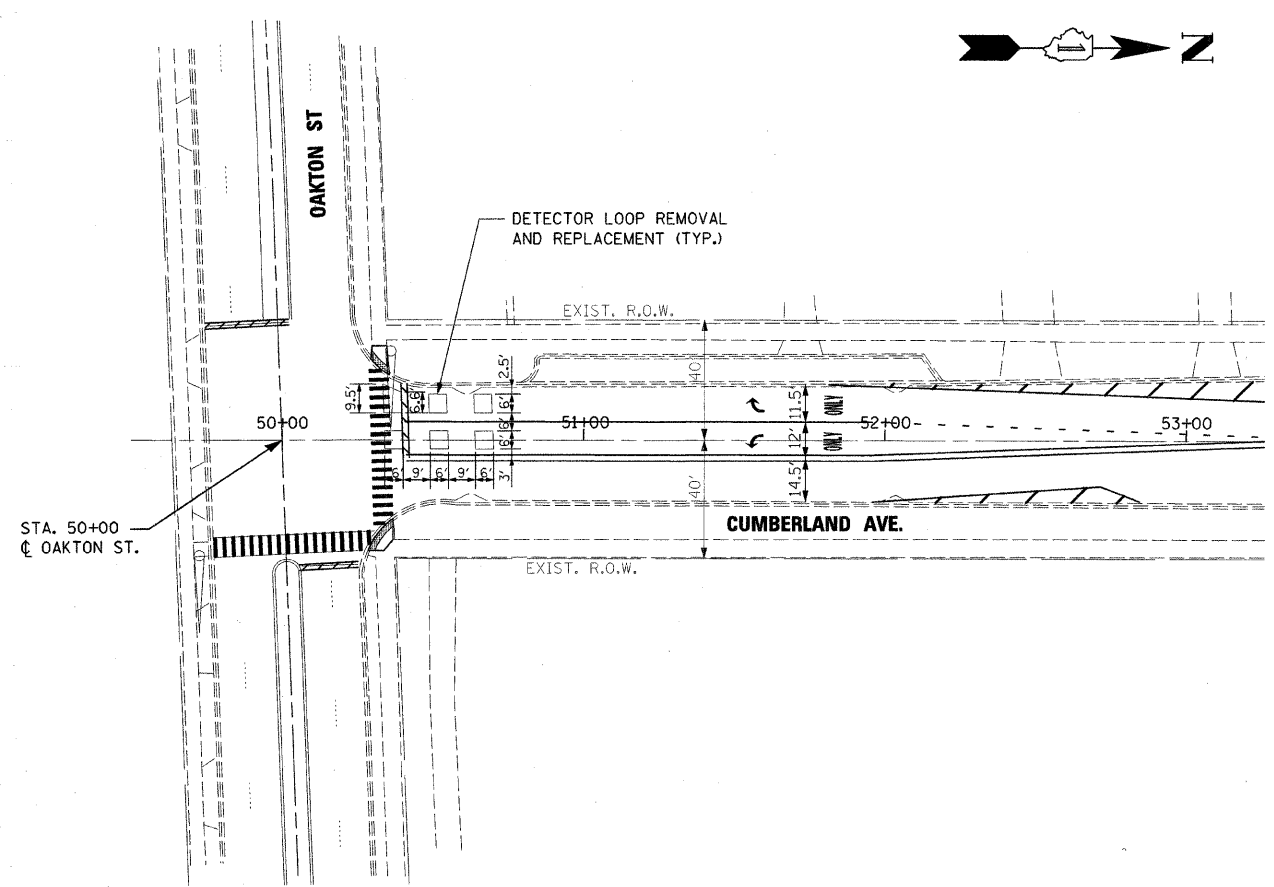

PLOT DATE = 1/29/2008
 FILE NAME = 866835
 PLOT SCALE = 850/85
 USER NAME = WJTB

REVISIONS	
NAME	DATE

ILLINOIS DEPARTMENT OF TRANSPORTATION
 VILLAGE OF NILES
 CUMBERLAND AVENUE RESURFACING/WIDENING
 OAKTON STREET TO CHURCH STREET

**DETECTOR LOOPS
 REMOVAL AND REPLACEMENT**

SCALE: VERT. 1"=30'
 HORIZ. 1"=30'

DATE _____ DRAWN BY JTF
 CHECKED BY BA

F.A. RTE.	SECTION	COUNTY	TOTAL SHEETS	SHEET NO.
2793	06-00109-00-WR	COOK	24	18
STA.		TO STA.		
FED. ROAD DIST. NO. 1		ILLINOIS FED. AID PROJECT		

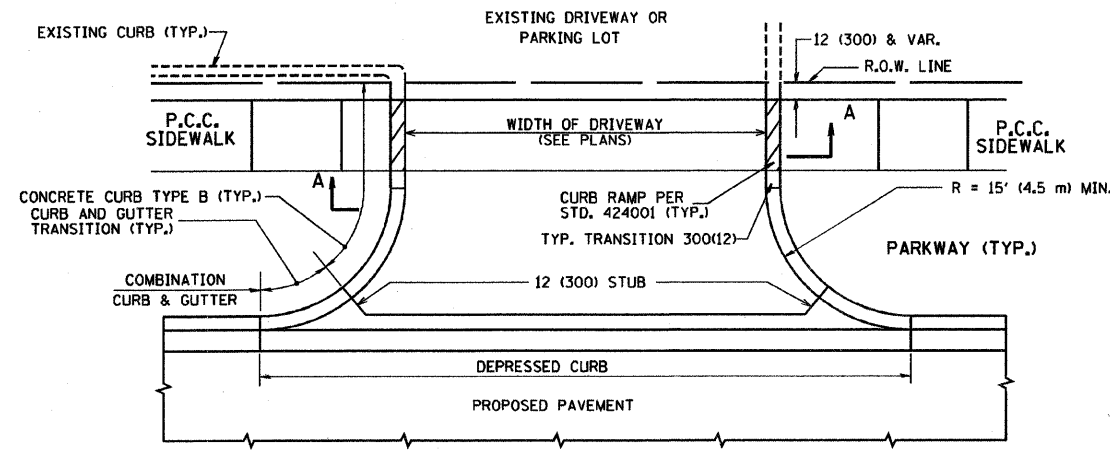

WITH CONCRETE CURB, TYPE B

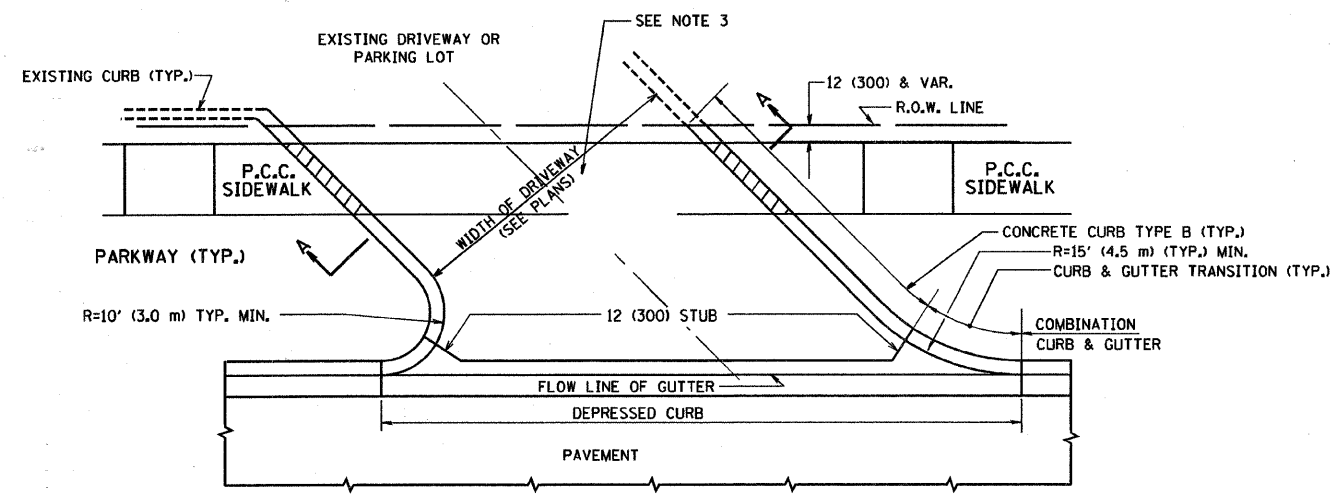

WITH CONCRETE CURB, TYPE B

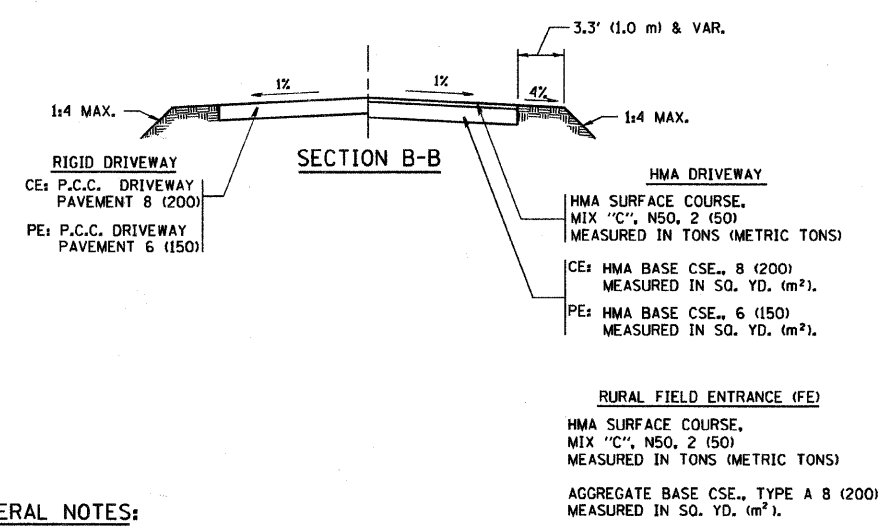
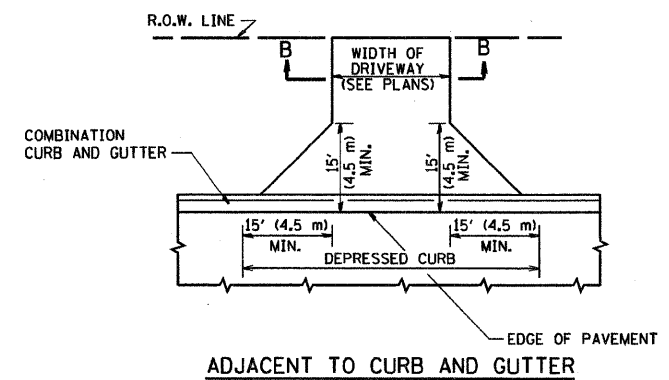
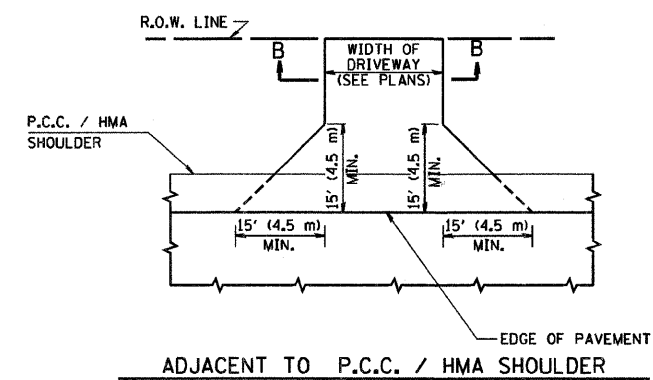

GENERAL NOTES:

DRIVEWAY SLOPES, LOCATIONS, & GEOMETRIC LAYOUT SHALL BE IN ACCORDANCE WITH THE LATEST EDITION OF THE "HANDBOOK FOR POLICY ON PERMITS FOR ACCESS DRIVEWAYS TO STATE HIGHWAYS". FOR FURTHER LAYOUT REQUIREMENTS, REFER TO ILLUSTRATIONS IN THE PERMIT HANDBOOK. DRIVEWAYS SHALL BE REPLACED IN KIND, UNLESS OTHERWISE NOTED ON THE PLANS.

COMMERCIAL DRIVEWAYS SHALL BE CONSTRUCTED WITH CONCRETE CURB, TYPE B RETURNS EXCEPT WHEN THE SIDEWALK EDGE IS 4 FEET (1.2 METERS) OR LESS FROM THE BACK OF CURB, CONSTRUCT A FLARE DRIVEWAY WITHOUT CURB.

THE RESIDENT ENGINEER SHALL CONTACT THE TRAFFIC PERMIT OFFICE AT 847/ 705-4131 FOR ANY QUESTIONS ON DRIVEWAYS SHOWN IN THE PLANS; SPECIFICALLY IN REFERENCE TO ADDITIONAL AND/OR RELOCATION/REMOVAL OF A DRIVEWAY.

COMBINATION CONCRETE CURB & GUTTER SHALL BE MEASURED STRAIGHT ACROSS THE DRIVEWAY. NO ADDITIONAL COMPENSATION WILL BE ALLOWED FOR THE CURB & GUTTER TRANSITION.

1 (25) PREFORMED EXPANSION JOINT FILLER WILL NOT BE PAID SEPARATELY, BUT SHALL BE CONSIDERED INCLUDED IN THE COST OF THE P.C.C. DRIVEWAY PAVEMENT OR P.C.C. SIDEWALK.

WHEN THE P.C.C. SIDEWALK EXTENDS THROUGH THE DRIVEWAY, THE THICKNESS OF THE SIDEWALK IN THE DRIVEWAY AREA SHALL BE THE SAME AS THE DRIVEWAY THICKNESS. SIDEWALK WILL BE PAID FOR AS P.C.C. SIDEWALK OF THE THICKNESS SPECIFIED. SIDEWALK CROSS SLOPE THRU DRIVEWAY AREA TO BE A MAXIMUM OF 1:50.

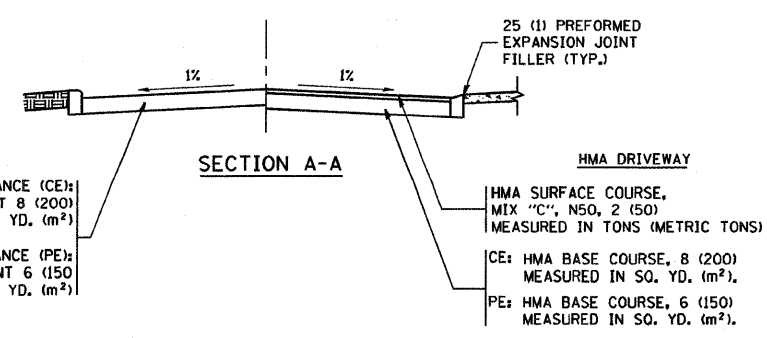

RIGID DRIVEWAY
 COMMERCIAL ENTRANCE (CE):
 P.C.C. DRIVEWAY PAVEMENT 8 (200)
 MEASURED IN SQ. YD. (m²)
 NON-COMMERCIAL ENTRANCE (PE):
 P.C.C. DRIVEWAY PAVEMENT 6 (150)
 MEASURED IN SQ. YD. (m²)

HMA DRIVEWAY
 HMA SURFACE COURSE,
 MIX "C", N50, 2 (50)
 MEASURED IN TONS (METRIC TONS)
 CE: HMA BASE COURSE, 8 (200)
 MEASURED IN SQ. YD. (m²),
 PE: HMA BASE COURSE, 6 (150)
 MEASURED IN SQ. YD. (m²)

REVISIONS	
NAME	DATE
R. SHAH	11-04-95
J. POLLASTRINI	08-12-96
J. POLLASTRINI	12-14-96
A. ABBAS	03-21-97
T. HOLTZ	04-08-97
M. GOMEZ	04-06-01
P. LOFLEUR	04-15-03
R. BORO	01-01-07

ALL DIMENSIONS ARE IN INCHES (MILLIMETERS) UNLESS OTHERWISE NOTED

ILLINOIS DEPARTMENT OF TRANSPORTATION
DRIVEWAY DETAILS
 DISTANCE BETWEEN R.O.W. AND FACE OF CURB & EDGE OF SHOULDER >= 15' (4.5 m)

SCALE: VERT. NONE
 HORIZ.
 DRAWN BY
 CHECKED BY

PLOT DATE = 4/11/2007
 FILE NAME = c:\projects\driveway\driveway.dgn
 PLOT SCALE = 4:1
 USER NAME = driveway.dgn

F.A.P. RTE.	SECTION	COUNTY	TOTAL SHEETS	SHEET NO.
2793	06-00109-00-WR	COOK	24	19
STA. TO STA.		FED. ROAD DIST. NO. 1 ILLINOIS FED. AID PROJECT		

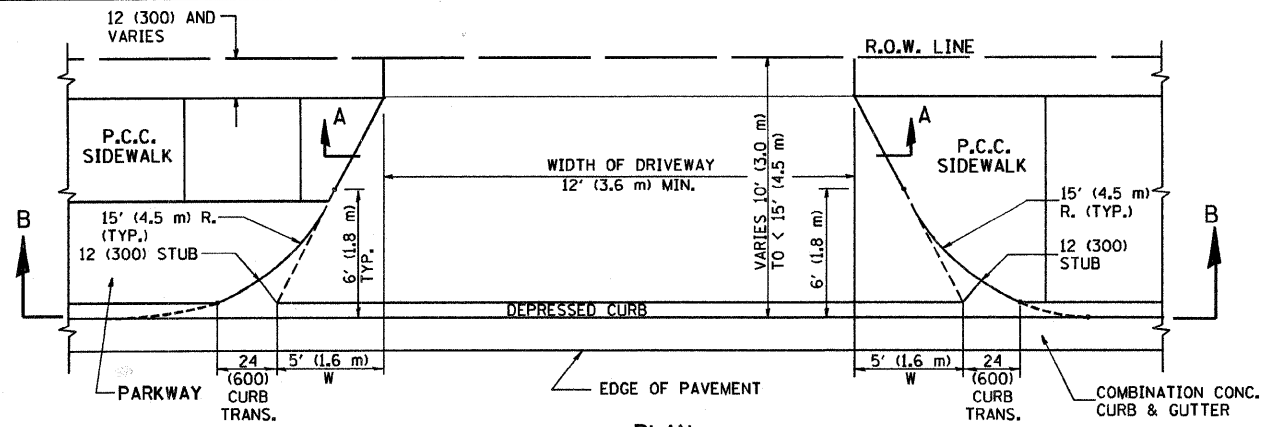

PLAN
10' (3.0 m) TO < 15' (4.5 m)

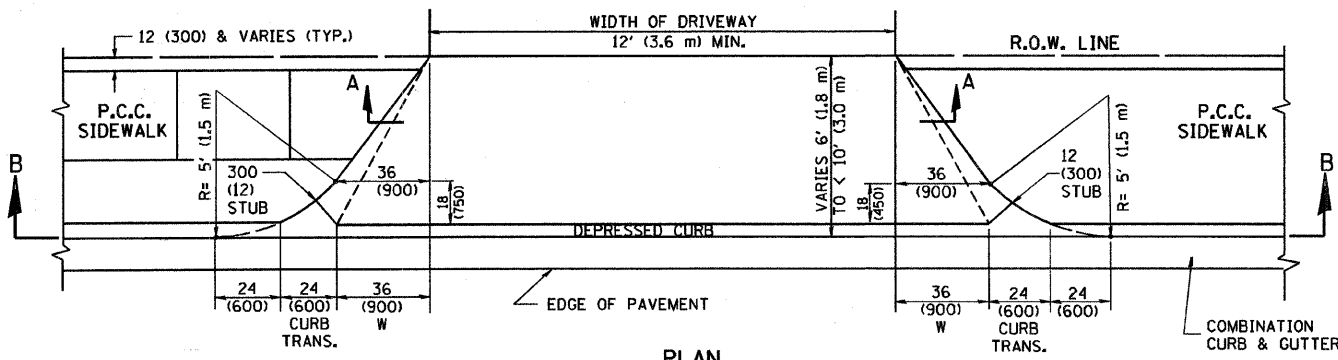

PLAN
6' (1.8 m) TO < 10' (3.0 m)

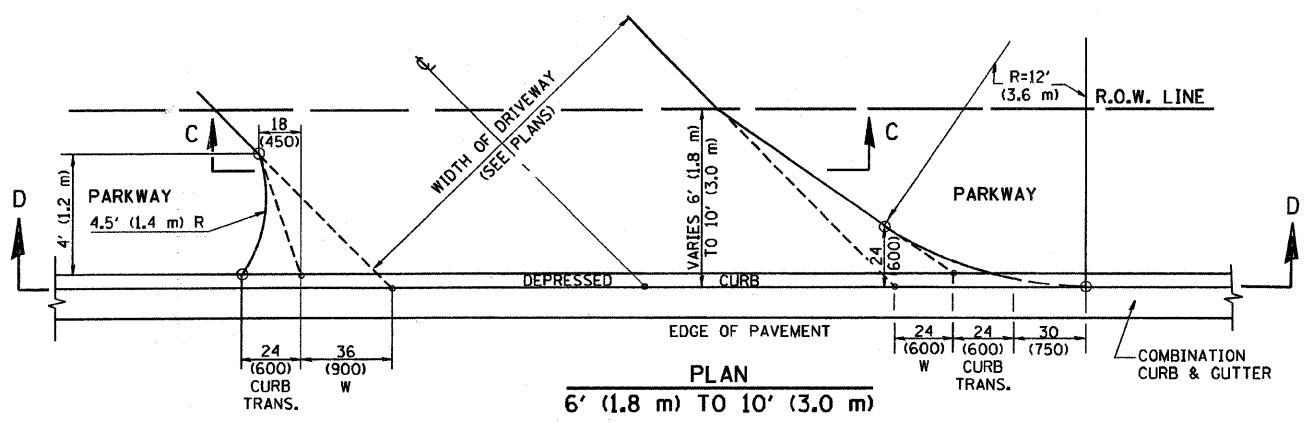

PLAN
6' (1.8 m) TO 10' (3.0 m)

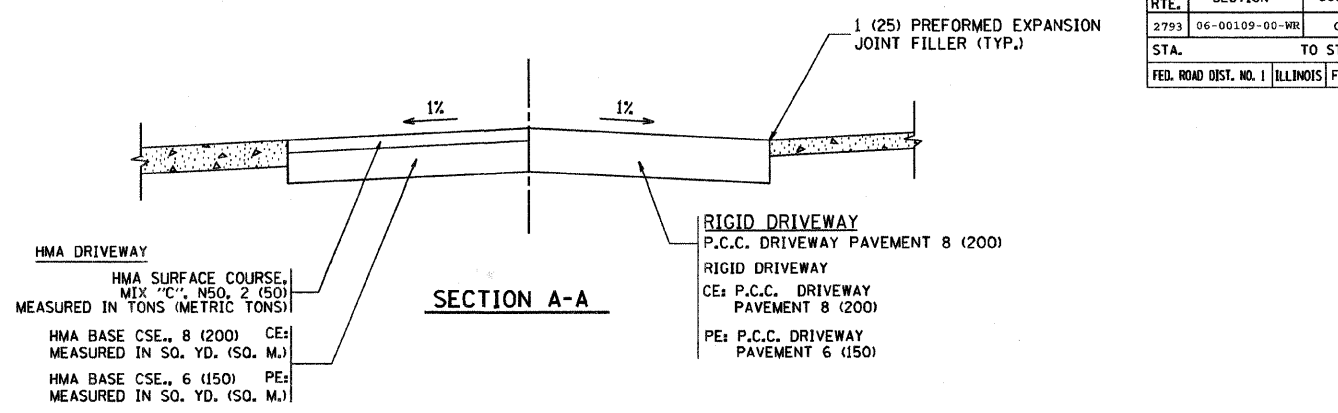

SECTION A-A

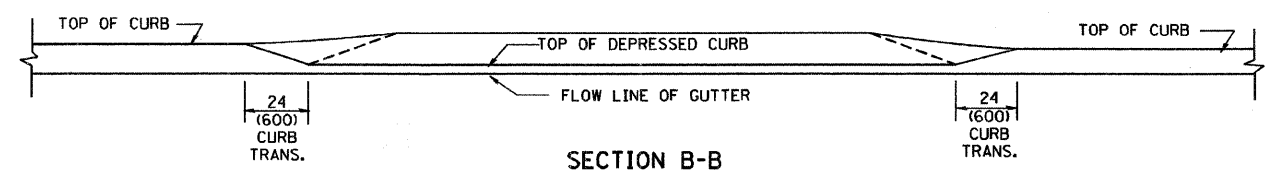

SECTION B-B

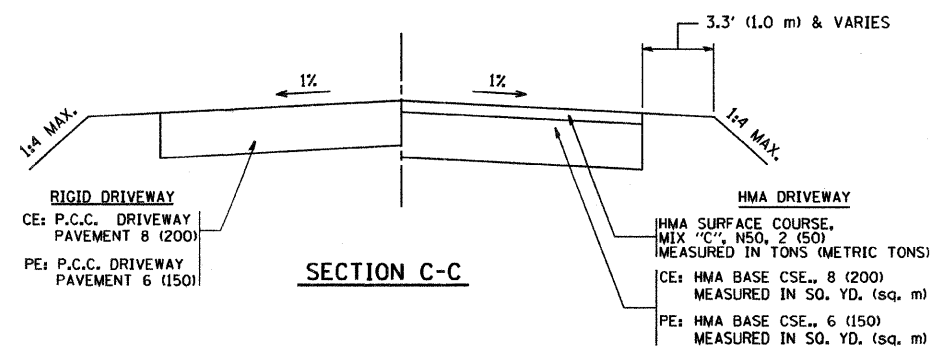

SECTION C-C

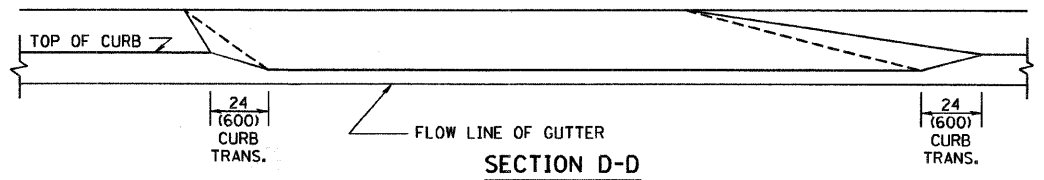

SECTION D-D

GENERAL NOTES

DRIVEWAY SLOPES, LOCATIONS, & GEOMETRIC LAYOUT SHALL BE IN ACCORDANCE WITH THE LATEST EDITION OF THE "HANDBOOK FOR POLICY ON PERMITS FOR ACCESS DRIVEWAYS TO STATE HIGHWAYS". FOR FURTHER LAYOUT REQUIREMENTS, REFER TO ILLUSTRATION 10 IN THE PERMIT HANDBOOK. WHERE SIDEWALKS EXIST, DRIVEWAYS SHALL BE REPLACED WITH RIGID PAVEMENT. WHERE NO SIDEWALKS EXIST, DRIVEWAYS SHALL BE REPLACED IN KIND. SIDEWALK CROSS SLOPE THRU DRIVEWAY AREA TO BE A MAXIMUM OF 1:50.

WHEN THE DISTANCE BETWEEN R.O.W. AND THE BACK OF CURB IS EQUAL TO OR LESS THAN 8' (2.4 m), THE P.C.C. SIDEWALK SHALL EXTEND TO THE BACK OF CURB.

THE RESIDENT ENGINEER SHALL CONTACT THE TRAFFIC PERMIT OFFICE AT 847/705-4131 FOR ANY QUESTIONS ON DRIVEWAYS SHOWN IN THE PLANS; SPECIFICALLY IN REFERENCE TO ADDITIONAL AND/OR RELOCATION/REMOVAL OF A DRIVEWAY.

COMBINATION CONCRETE CURB & GUTTER SHALL BE MEASURED STRAIGHT ACROSS THE DRIVEWAY. NO ADDITIONAL COMPENSATION WILL BE ALLOWED FOR THE CURB & GUTTER TRANSITION.

THE 1 (25) PREFORMED EXPANSION JOINT FILLER WILL NOT BE PAID SEPARATELY, BUT SHALL BE CONSIDERED INCLUDED IN THE COST OF THE P.C.C. DRIVEWAY PAVEMENT OR P.C.C. SIDEWALK.

"W" VARIES FROM 36 (900) TO 5' (1.5 m) PROPORTIONAL TO THE LENGTH (L), FROM 6' (1.8 m) TO 10' (3 m).

ALL DIMENSIONS ARE IN INCHES (MILLIMETERS) UNLESS OTHERWISE NOTED.

REVISIONS	
NAME	DATE
R. SHAH	11/06/95
J. POLLASTRINI	08/12/96
J. POLLASTRINI	12/14/96
A. ABBAS	03/21/97
T. HOLTZ	04/08/97
M. GOMEZ	04/06/01
P. LOFLEUR	04/15/03
R. BORO	01/01/07

ILLINOIS DEPARTMENT OF TRANSPORTATION
DRIVEWAY DETAILS
DISTANCE BETWEEN ROW AND FACE OF CURB < 15' (4.5 m)

SCALE: VERT. NONE
HORIZ. DRAWN BY
CHECKED BY

PLOT DATE = 3/15/2007
FILE NAME = K:\diststd\bd02.dgn
PLOT SCALE = 50.000000 - 1/16"
USER NAME = bbarford

F.A.P. RTE.	SECTION	COUNTY	TOTAL SHEETS	SHEET NO.
2793	06-00109-00-NR	COOK	24	20
STA.		TO STA.		
FED. ROAD DIST. NO. 1		ILLINOIS FED. AID PROJECT		

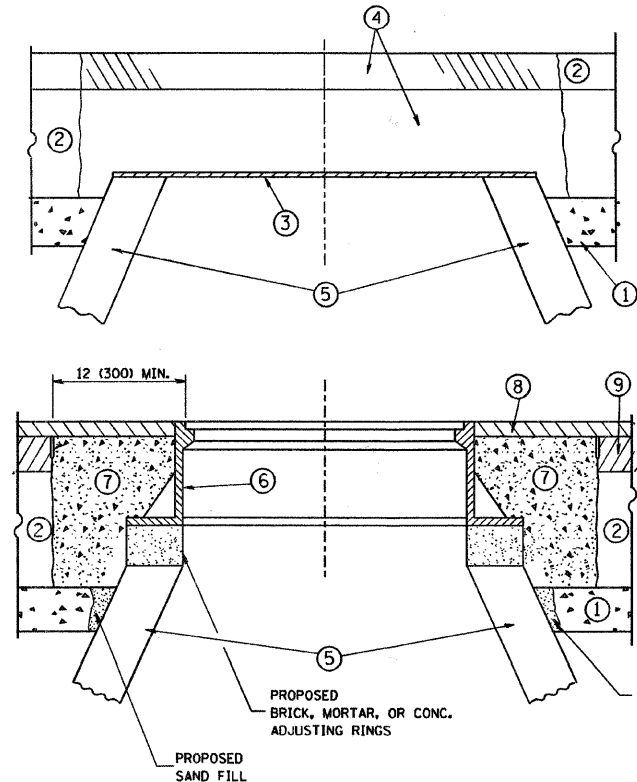

CONSTRUCTION PROCEDURES

STAGE 1 (BEFORE PAVEMENT MILLING)

- A) REMOVE A MINIMUM OF 12 (300) OF THE PAVEMENT FROM AROUND THE STRUCTURE.
- B) REMOVE THE EXISTING FRAME AND LID FROM THE STRUCTURE.
- C) COVER THE STRUCTURE OPENING WITH A 36 (900) DIAMETER METAL PLATE.
- D) BACKFILL WITH CRUSHED STONE AND A MINIMUM 1 1/2 (40) THICK HMA SURFACE MIX APPROVED BY THE ENGINEER.

STAGE 2 (AFTER PAVEMENT MILLING)

- A) REMOVE THE HMA SURFACE MIX AND CRUSHED STONE.
- B) INSTALL THE FRAME AND LID, ADJUST THE FRAME TO ITS FINAL SURFACE ELEVATION.
- C) THE SURROUNDING SPACE SHALL BE FILLED WITH CLASS SI CONCRETE, OR HMA SURFACE COURSE OR HMA BINDER COURSE TO THE ELEVATION OF THE SURFACE OF THE EXISTING BASE COURSE OR THE BINDER COURSE.

THE PROCEDURE EXPLAINED ABOVE SHALL CONFORM TO THE APPLICABLE PORTIONS OF SECTIONS 353, 406, 602, AND 603 OF THE STANDARD SPECIFICATIONS.

LEGEND

- ① SUB-BASE GRANULAR MATERIAL
- ② EXISTING PAVEMENT
- ③ 36 (900) DIAMETER METAL PLATE
- ④ PROPOSED CRUSHED STONE AND HMA SURFACE MIX
- ⑤ EXISTING STRUCTURE
- ⑥ FRAME AND LID (SEE NOTES)
- ⑦ CLASS SI CONCRETE, HMA SURFACE COURSE OR HMA BINDER COURSE
- ⑧ PROPOSED HMA SURFACE COURSE
- ⑨ PROPOSED HMA BINDER COURSE

LOCATION OF STRUCTURES:

THE CONTRACTOR WILL BE REQUIRED TO KEEP A RECORD OF THE LOCATIONS OF THE BURIED STRUCTURES ACCORDING TO THE STATION AND DISTANCE LEFT OR RIGHT OF THE CENTERLINE OF PAVEMENT. UPON COMPLETION OF THE WORK, THE CONTRACTOR WILL DELIVER THE RECORD TO THE ENGINEER.

BASIS OF PAYMENT: THIS WORK WILL BE PAID FOR AT THE CONTRACT UNIT PRICE PER EACH FOR "FRAMES AND LIDS TO BE ADJUSTED, SPECIAL"
NEW FRAMES AND LIDS, WHEN SPECIFIED, WILL BE PAID FOR SEPARATELY.

NOTES:

EXISTING BROKEN FRAMES AND LIDS SHALL BE REMOVED AND DISPOSED OF BY THE CONTRACTOR AND SHALL BE REPLACED AS DIRECTED BY THE ENGINEER. REPLACEMENT FRAMES AND LIDS WILL BE PAID FOR IN ACCORDANCE WITH ARTICLE 109.04 OF THE STANDARD SPECIFICATIONS UNLESS A SEPARATE PAY ITEM HAS BEEN PROVIDED.

IF THE EXISTING LIDS ARE OPEN, THE FRAME WILL BE ADJUSTED TO THE ELEVATION OF THE MILLED PAVEMENT SURFACE PRIOR TO THE MILLING OPERATION. THE FRAME WILL NOT BE REMOVED AND COVERED BY THE METAL PLATE.

CITY OF CHICAGO CASTINGS ARE THE PROPERTY OF THE CITY AND THE CONTRACTOR SHALL NOTIFY THE CITY FOR REMOVAL AND DISPOSITION OF THE CASTINGS.

THE METAL PLATE USED TO COVER THE STRUCTURE SHALL REMAIN THE PROPERTY OF THE CONTRACTOR.

WHEN STRUCTURES ARE TO BE ADJUSTED OR RECONSTRUCTED, THE LOWERING AND RAISING OF THE FRAMES AND LIDS WILL NOT BE PAID FOR SEPARATELY BUT WILL BE INCLUDED IN THE COST OF THE CORRESPONDING PAY ITEM.

DETAILS FOR FRAMES AND LIDS ADJUSTMENT WITH MILLING

ALL DIMENSIONS ARE IN INCHES (MILLIMETERS) UNLESS OTHERWISE SHOWN

REVISIONS	
NAME	DATE
R. SHAH	10/25/94
R. SHAH	01/30/95
R. SHAH	03/10/95
A. ABBAS	03/21/97
R. WIEDEMAN	05/14/04
R. BORO	01/01/07

**ILLINOIS DEPARTMENT OF TRANSPORTATION
DETAILS FOR
FRAMES AND LIDS ADJUSTMENT
WITH MILLING**

SCALE: VERT. NONE
HORIZ.

DRAWN BY
CHECKED BY

PLOT DATE: 3/5/2007
FILE NAME: K:\data\bd600.dgn
PLOT SCALE: 50/8000 / IN.
USER NAME: bbornd

F.A. RTE.	SECTION	COUNTY	TOTAL SHEETS	SHEET NO.
2793	06-00109-00-WR	COOK	24	21
STA.		TO STA.		
FED. ROAD DIST. NO. 1		ILLINOIS	FED. AID PROJECT	

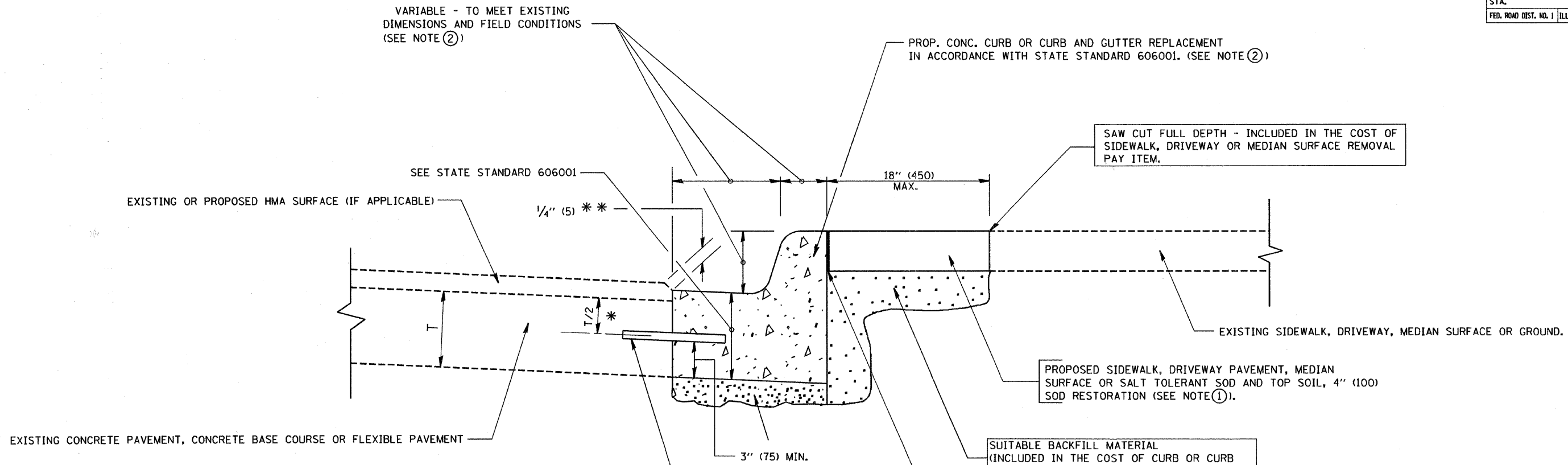

- * 3" (75) MINIMUM FROM TOP AND BOTTOM OF THE CONCRETE PAVEMENT OR BASE COURSE.
- * * IF THE FINAL SURFACE OF THE PAVEMENT IS CONCRETE, THE GUTTER IS TO BE FLUSH WITH THE PAVEMENT.

NOTE: ① SIDEWALK, DRIVEWAY PAVEMENT OR MEDIAN SURFACE SHALL BE SIMILAR TO THE MATERIAL BEING REMOVED AND WILL BE PAID FOR SEPARATELY.

SALT TOLERANT SOD AND TOP SOIL, 4" (100) RESTORATION WILL NOT BE PAID FOR SEPARATELY, BUT SHALL BE INCLUDED IN THE COST OF CURB OR CURB AND GUTTER REMOVAL AND REPLACEMENT.

- ② CURB OR CURB AND GUTTER REPLACEMENT SHALL MATCH THE SHAPE OF THE EXISTING CURB OR CURB AND GUTTER UNLESS OTHERWISE SPECIFIED.
- ③ FOR CURB OR CURB AND GUTTER REMOVAL AND REPLACEMENT ADJACENT TO FLEXIBLE PAVEMENT DELETE EPOXY COATED TIE BARS.
- ④ LONGITUDINAL BARS, IF ENCOUNTERED IN THE EXISTING CURB OR CURB AND GUTTER, ARE NOT TO BE REPLACED. CUTTING AND REMOVING LONGITUDINAL BARS SHALL BE INCLUDED IN THE COST OF CURB OR CURB AND GUTTER REMOVAL AND REPLACEMENT.
- ⑤ THE COST OF HMA SURFACE REMOVAL IN THE EXISTING GUTTER FLAG SHALL BE INCLUDED IN THE COST OF THE CURB AND GUTTER REMOVAL AND REPLACEMENT.
- ⑥ THE REMOVAL AND REPLACEMENT OF THE EXISTING CURB OR CURB AND GUTTER SHALL BE DONE IN ACCORDANCE WITH THE APPLICABLE PORTIONS OF SECTION 440 AND 606 OF THE STANDARD SPECIFICATIONS.
- ⑦ THE LOCATIONS OF REMOVAL AND REPLACEMENT OF EXISTING CURB OR CURB AND GUTTER SHALL BE DETERMINED BY THE RESIDENT ENGINEER AT THE TIME OF CONSTRUCTION.

UNSUITABLE SUB-BASE MATERIAL TO BE REMOVED, IF DIRECTED BY THE ENGINEER, SHALL BE REPLACED WITH EITHER SUB-BASE GRANULAR MATERIAL, TYPE B OR ADDITIONAL THICKNESS OF CONCRETE.

REMOVAL AND REPLACEMENT 4" (100) OR LESS IS INCLUDED IN THE COST OF CURB OR CURB AND GUTTER REMOVAL AND REPLACEMENT.

REMOVAL AND REPLACEMENT IN EXCESS OF 4" (100) WILL BE PAID FOR IN ACCORDANCE WITH ARTICLE 109.04 OF THE STANDARD SPECIFICATIONS.

PROPOSED #6 (20) EPOXY COATED TIE BARS 24" (600) LONG AT 24" (600) CENTERS WILL NOT BE PAID FOR SEPARATELY. DELETE EPOXY COATED TIE BARS IF EXISTING TIE BARS ARE USUABLE AS DETERMINED BY THE ENGINEER. (SEE NOTE ③).

BASIS OF PAYMENT:
THIS WORK WILL BE PAID FOR AT THE CONTRACT UNIT PRICE PER FOOT (METER) FOR "CURB REMOVAL AND REPLACEMENT" OR "COMBINATION CONCRETE CURB AND GUTTER REMOVAL AND REPLACEMENT".

ALL DIMENSIONS ARE IN INCHES (MILLIMETERS) UNLESS OTHERWISE SHOWN.

REVISIONS	
NAME	DATE
A. HOUSEH	03/11/94
R. SHAH	02/24/96
R. SHAH	03/02/96
R. SHAH	08/19/96
R. SHAH	09/12/96
R. SHAH	09/19/96
R. SHAH	10/03/96
A. ABBAS	03/21/97
M. GOMEZ	01/22/01
R. BORO	01/01/07

ILLINOIS DEPARTMENT OF TRANSPORTATION
CURB OR CURB AND GUTTER REMOVAL AND REPLACEMENT

SCALE: VERT. NONE
HORIZ. DRAWN BY
CHECKED BY

CURB OR CURB AND GUTTER REMOVAL AND REPLACEMENT

PLOT DATE = 3/6/2007
FILE NAME = K:\databases\bd6006.dgn
PLOT SCALE = 80.000 / IN.
USER NAME = bborod

F.A.P. RTE.	SECTION	COUNTY	TOTAL SHEETS	SHEET NO.
2793	06-00109-00-WR	COOK	24	22
STA.		TO STA.		
FED. ROAD DIST. NO. 1		ILLINOIS		FED. AID PROJECT

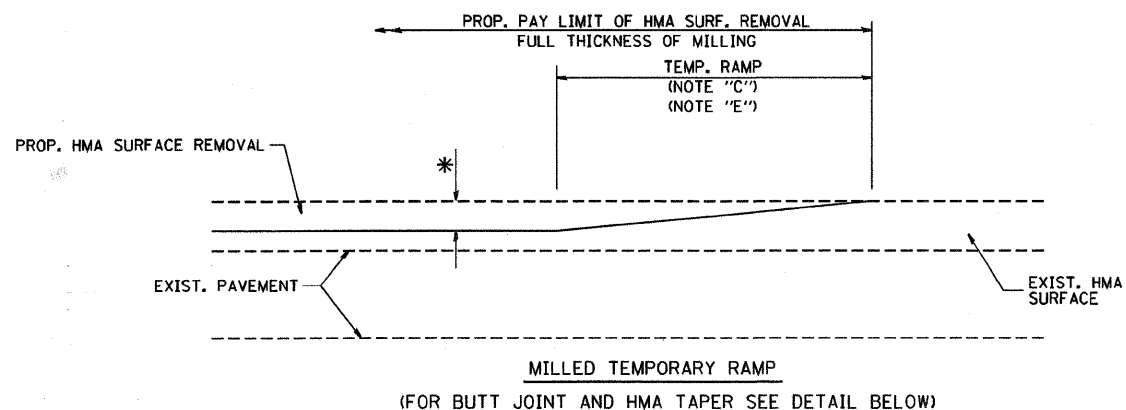

OPTION 1

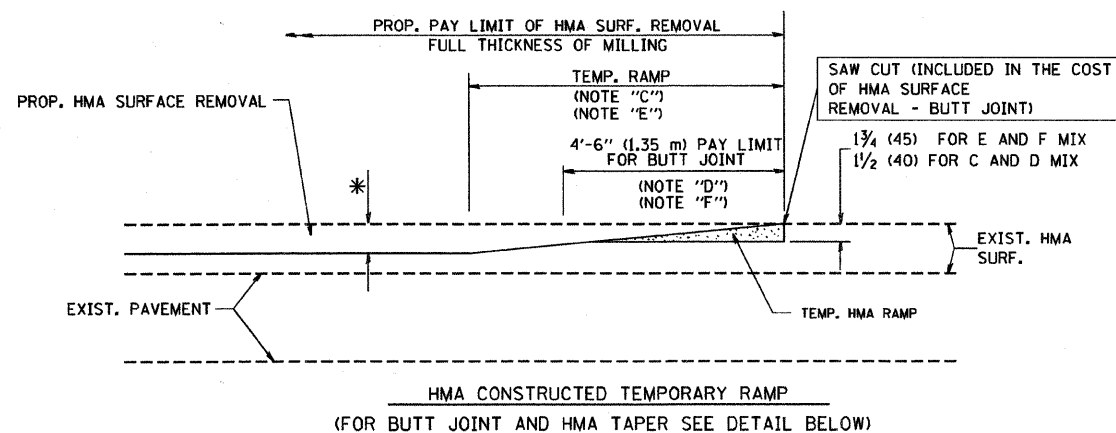

OPTION 2
TYPICAL TEMPORARY RAMP

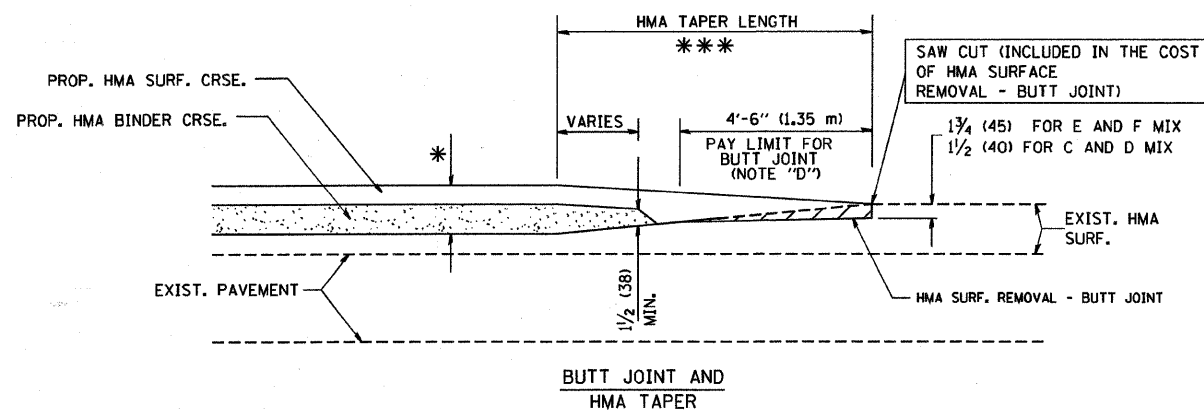

TYPICAL BUTT JOINT AND HMA TAPER FOR MILLING AND RESURFACING

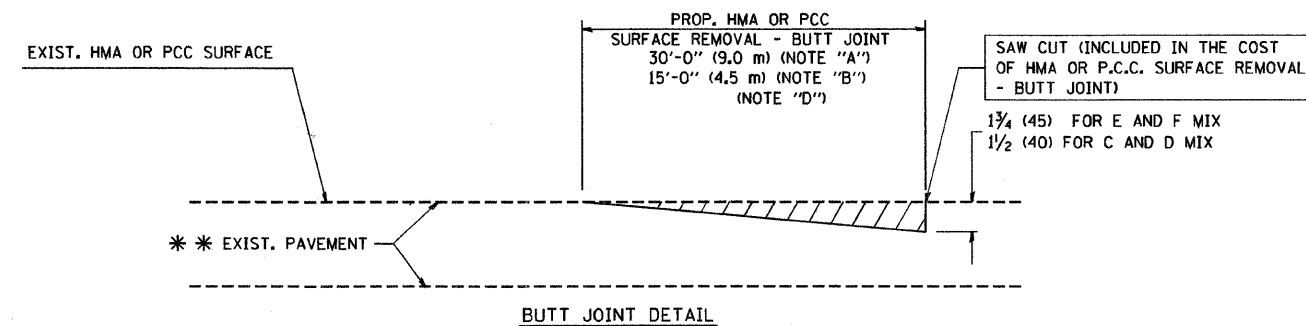

BUTT JOINT DETAIL

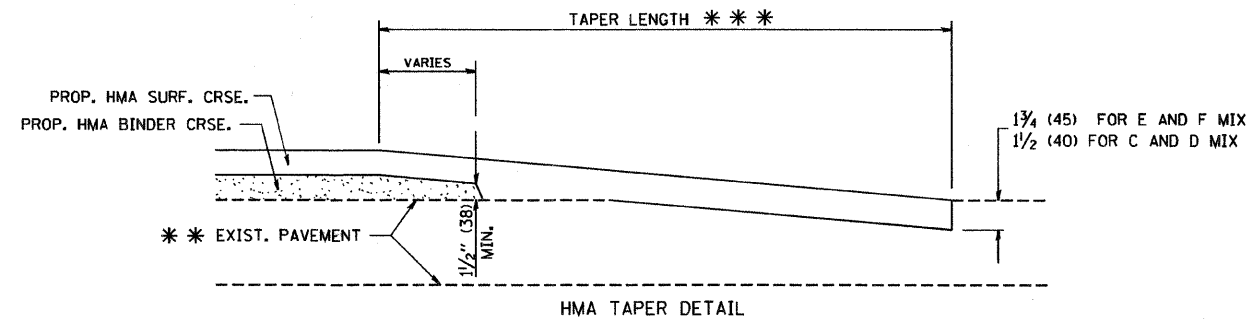

HMA TAPER DETAIL

TYPICAL BUTT JOINT AND HMA TAPER FOR RESURFACING ONLY

*** PC CONCRETE, HMA OR HMA RESURFACED PAVEMENT.

NOTES

- A: MAINLINE ROADWAYS AND MAJOR SIDE ROADS.
 - B: MINOR SIDE ROADS.
 - C: THE TEMP. RAMP SHALL BE CONSTRUCTED IMMEDIATELY UPON REMOVAL OF THE EXISTING HMA SURFACE.
 - D: THE BUTT JOINT SHALL BE CONSTRUCTED IMMEDIATELY PRIOR TO PLACING THE PROPOSED HMA COURSES.
 - E: TAPER THE TEMP. RAMP AT A RATE OF 3'-0" (900 mm) PER 1 INCH (25 mm) OF MILLING THICKNESS.
 - F: INSTALLATION AND REMOVAL OF THE 4'-6" (1.35 m) TEMP. RAMP IS INCLUDED IN COST OF HMA SURFACE REMOVAL - BUTT JOINT
 - G: SEE ARTICLE 406.08 AND 406.14 OF THE STANDARD SPECIFICATIONS FOR "HMA AND/OR PCC SURFACE REMOVAL, BUTT JOINT".
- * SEE TYPICAL SECTIONS FOR MILLING THICKNESS.
- *** 20'-0" (6.1 m) PER 1 (25) RESURFACING (NOTE "A")
10'-0" (3.0 m) PER 1 (25) RESURFACING (NOTE "B")

ALL DIMENSIONS ARE IN INCHES (MILLIMETERS) UNLESS OTHERWISE SHOWN.

BASIS OF PAYMENT:

THE BUTT JOINT WILL BE PAID FOR AT THE CONTRACT UNIT PRICE PER SQUARE YARD (SQUARE METER) FOR "HOT-MIX ASPHALT SURFACE REMOVAL - BUTT JOINT" OR FOR "PORTLAND CEMENT CONCRETE SURFACE REMOVAL - BUTT JOINT".

REVISIONS	
NAME	DATE
M. DE YONG	6-13-90
M. DE YONG	7-3-90
M. DE YONG	3-27-92
R. SHAH	09/09/94
R. SHAH	10/25/94
A. ABBAS	03/21/97
M. GOMEZ	04/06/01
R. BORO	01/01/07

ILLINOIS DEPARTMENT OF TRANSPORTATION

BUTT JOINT AND HMA TAPER DETAILS

SCALE: VERT. NONE
HORIZ.

DRAWN BY
CHECKED BY

F.A.P. RTE.	SECTION	COUNTY	TOTAL SHEETS	SHEET NO.
2793	06-00109-00-WR	COOK	24	23
STA.		TO STA.		
FED. ROAD DIST. NO.	ILLINOIS	FED. AID PROJECT		

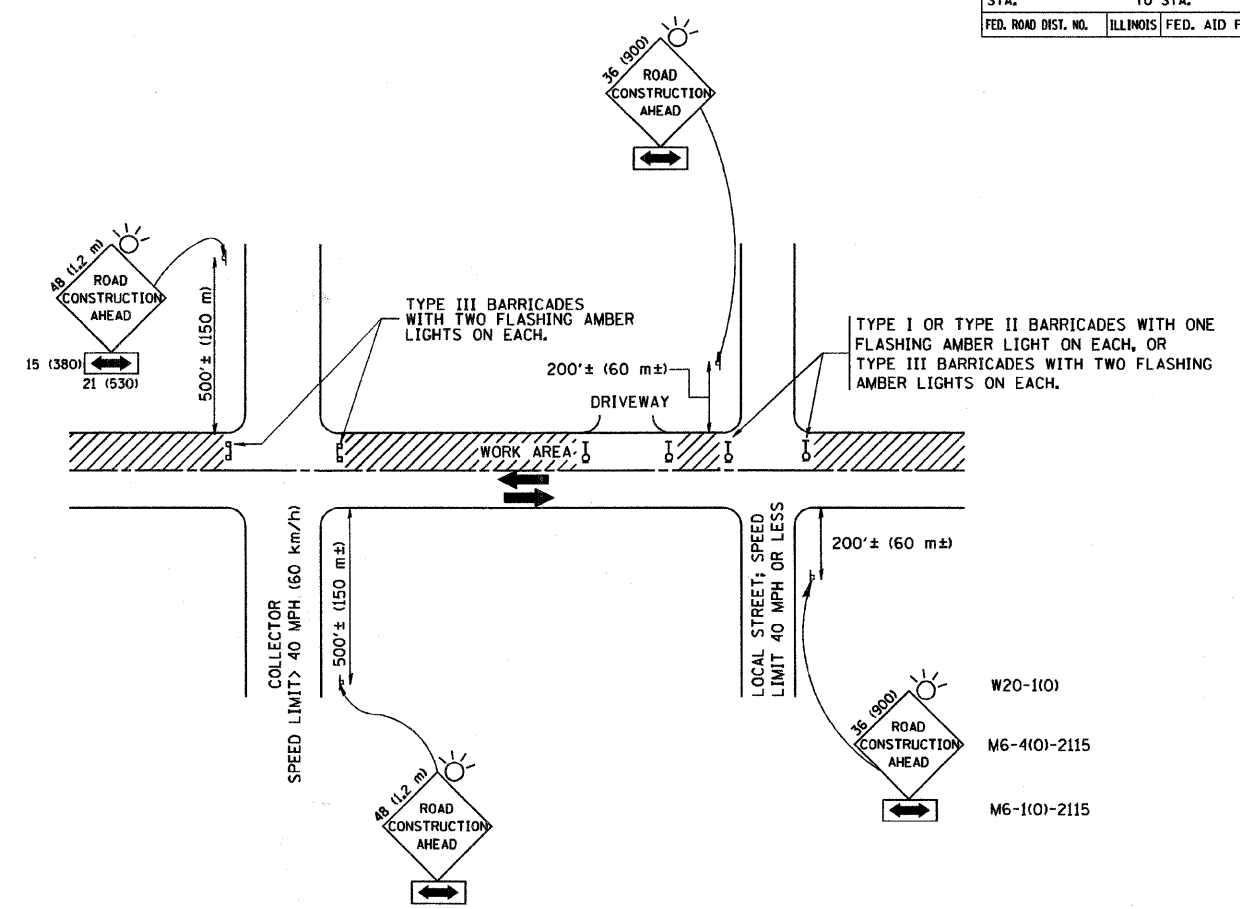

TRAFFIC CONTROL AND PROTECTION FOR SIDE ROADS, INTERSECTIONS, AND DRIVEWAYS

NOTES:

- A. FOR NO LANE RESTRICTION ON THE SIDE ROAD OR DRIVEWAYS**
- SIDE ROAD WITH A SPEED LIMIT OF 40 MPH (60 km/h) OR LESS AS SHOWN ON THE DRAWING AND AS DIRECTED BY THE ENGINEER:
 - ONE ROAD CONSTRUCTION AHEAD SIGN 36 x 36 (900x900) WITH A FLASHER AND FLAG MOUNTED ON IT APPROXIMATELY 200' (60 m) IN ADVANCE OF THE MAIN ROUTE.
 - THE CLOSED PORTION OF THE MAIN ROUTE SHALL BE PROTECTED BY BLOCKING WITH TYPE I, TYPE II OR TYPE III BARRICADES, 1/3 OF THE CROSS SECTION OF THE CLOSED PORTION.
 - SIDE ROAD WITH A SPEED LIMIT GREATER THAN 40 MPH (60 km/h) AS SHOWN ON THE DRAWING AND AS DIRECTED BY THE ENGINEER:
 - ONE ROAD CONSTRUCTION AHEAD SIGN 48 x 48 (1.2 m x 1.2 m) WITH A FLASHER MOUNTED ON IT APPROXIMATELY 500' (150 m) IN ADVANCE OF THE MAIN ROUTE.
 - THE CLOSED PORTION OF THE MAIN ROUTE SHALL BE PROTECTED BY BLOCKING WITH TYPE III BARRICADES, 1/2 OF THE CROSS SECTION OF THE CLOSED PORTION.
 - WHEN THE SIDE ROAD LIES BETWEEN THE BEGINNING OF THE MAINLINE SIGNING AND THE WORK ZONE, A SINGLE HEADED ARROW (M6-1) SHALL BE USED IN LIEU OF THE DOUBLE HEADED ARROW (M6-4).
- B. FOR A LANE CLOSURE ON A SIDE ROAD OR DRIVEWAY:**
- USE APPLICABLE PORTIONS OF THE TYPICAL APPLICATION OF TRAFFIC CONTROL DEVICES (STD. 70150L, STD. 701606 OR THE APPROPRIATE STANDARD). THE SPACING OF SIGNS AND BARRICADES SHALL BE ADJUSTED FOR FIELD CONDITIONS AS DIRECTED BY THE ENGINEER. THE DIRECTIONAL ARROW SHALL BE COVERED OR REMOVED WHEN NO LONGER CONSISTENT WITH THE SIDE ROAD LANE CLOSURE.
- C. ADVANCE WARNING SIGNS ARE TO BE OMITTED ON DRIVEWAY UNLESS OTHERWISE NOTED.**
- D. THE TRAFFIC CONTROL AND PROTECTION FOR SIDE ROADS, INTERSECTIONS, AND DRIVEWAYS SHALL BE INCIDENTAL TO THE COST OF SPECIFIED TRAFFIC CONTROL STANDARDS OR ITEMS.**

All dimensions are in millimeters (inches) unless otherwise shown.

REVISIONS	
NAME	DATE
LHA	6/89
T. RAMMACHER	09/08/94
J. OBERLE	10/18/95
A. HOUSEH	03/06/96
A. HOUSEH	10/15/96
T. RAMMACHER	01/06/00

ILLINOIS DEPARTMENT OF TRANSPORTATION
 TRAFFIC CONTROL AND PROTECTION
 FOR
 SIDE ROADS, INTERSECTIONS, AND
 DRIVEWAYS

SCALE: NONE
 DRAWN BY
 CHECKED BY

PLOT DATE = 3/6/2007
 FILE NAME = K:\detroit\tdc\tdc.dgn
 PLOT SCALE = 800000 / 1 IN.
 USER NAME = dboward

F.A.P. RTE.	SECTION	COUNTY	TOTAL SHEET NO.	SHEET NO.
2793	06-00109-00-WR	COOK	24	24
STA.		TO STA.		
FED. ROAD DIST. NO.		ILLINOIS FED. AID PROJECT		

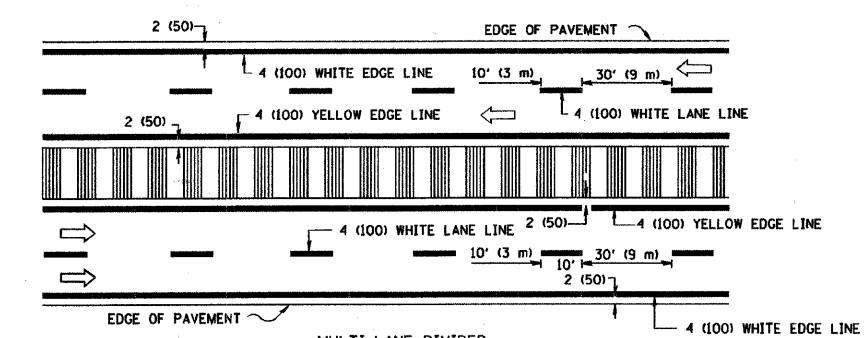
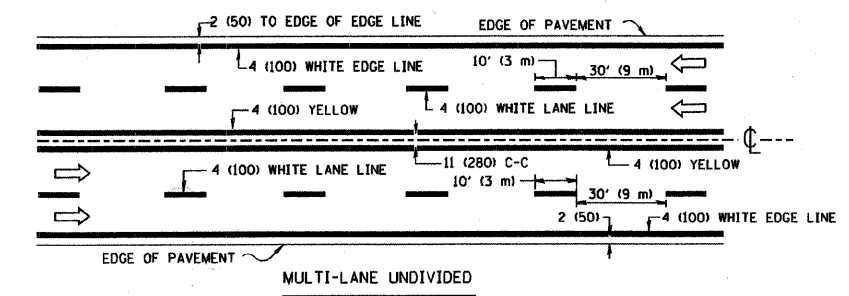
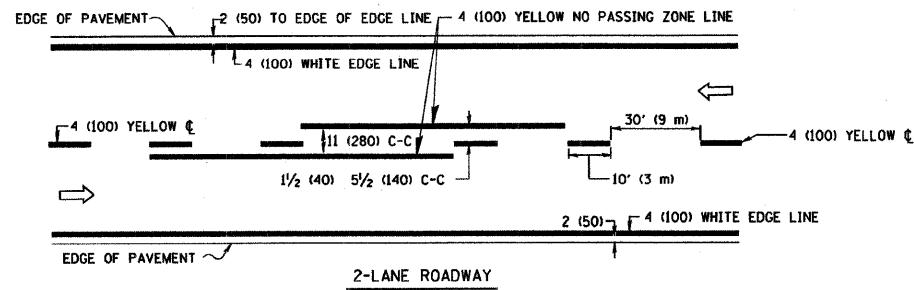

NOTE: MEDIANS WITH BARRIER CURB DO NOT REQUIRE AN EDGE LINE

TYPICAL LANE AND EDGE LINE MARKING

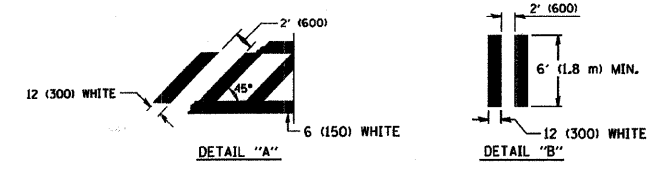
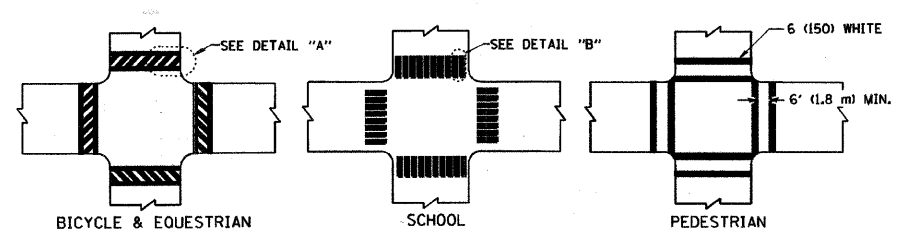

TYPICAL CROSSWALK MARKING

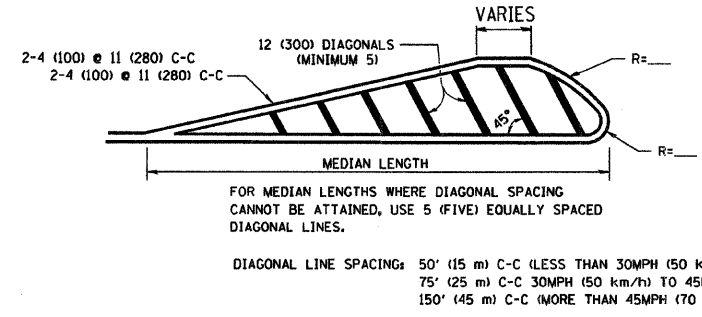
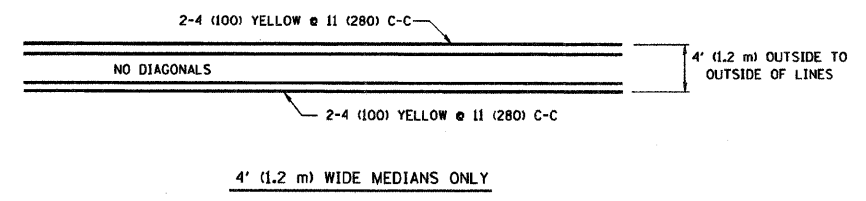

MEDIANS OVER 4' (1.2 m) WIDE

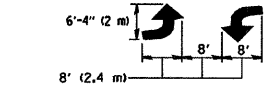
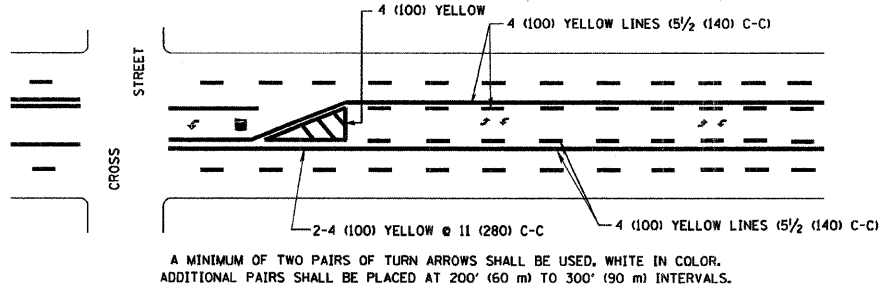

MEDIAN WITH TWO-WAY LEFT TURN LANE

TYPICAL PAINTED MEDIAN MARKING

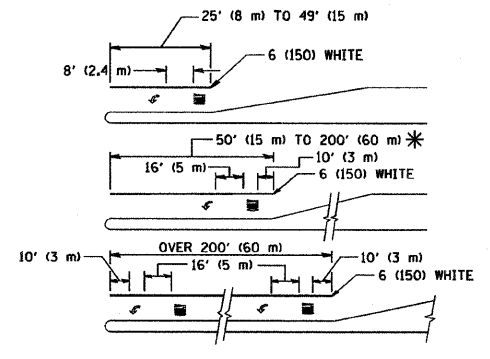

FULL SIZE LETTERS 8' (2.4 m) AND ARROWS SHALL BE USED.
AREA = 15.6 SQ. FT. (1.5 m²) ONLY AREA = 20.8 SQ. FT. (1.9 m²)

* TURN LANES IN EXCESS OF 400' (120 m) IN LENGTH MAY HAVE AN ADDITIONAL SET OF ARROW - "ONLY" INSTALLED MIDWAY BETWEEN THE OTHER TWO SETS OF ARROW - "ONLY".

TYPICAL LEFT (OR RIGHT) TURN LANE

TYPICAL TURN LANE MARKING

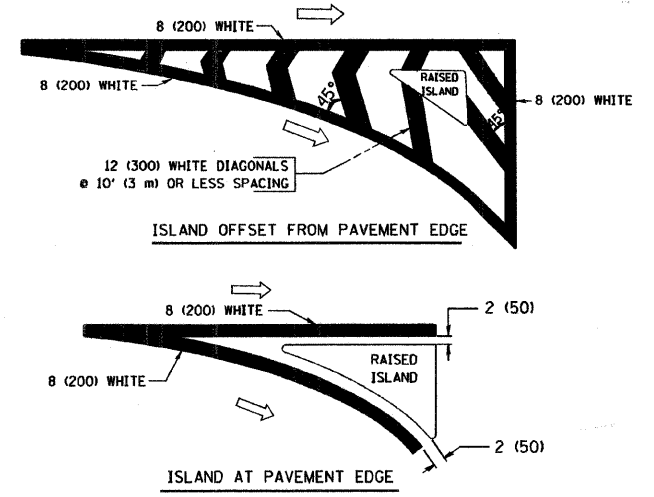

TYPICAL ISLAND MARKING

TYPE OF MARKING	WIDTH OF LINE	PATTERN	COLOR	SPACING / REMARKS
CENTERLINE ON 2 LANE PAVEMENT	4 (100)	SKIP-DASH	YELLOW	10' (3 m) LINE WITH 30' (9 m) SPACE
CENTERLINE ON MULTI-LANE UNDIVIDED PAVEMENT	2 @ 4 (100)	SOLID	YELLOW	11 (280) C-C
NO PASSING ZONE LINES: FOR ONE DIRECTION FOR BOTH DIRECTIONS	4 (100) 2 @ 4 (100)	SOLID SOLID	YELLOW YELLOW	5 1/2 (140) C-C FROM SKIP-DASH CENTERLINE 11 (280) C-C OMIT SKIP-DASH CENTERLINE BETWEEN
LANE LINES	4 (100) 5 (125) ON FREEWAYS	SKIP-DASH SKIP-DASH	WHITE WHITE	10' (3 m) LINE WITH 30' (9 m) SPACE
DOTTED LINES (EXTENSIONS OF CENTER, LANE OR TURN LANE MARKINGS)	SAME AS LINE BEING EXTENDED	SKIP-DASH	SAME AS LINE BEING EXTENDED	2' (600) LINE WITH 6' (1.8 m) SPACE
EDGE LINES	4 (100)	SOLID	YELLOW-LEFT WHITE-RIGHT	OUTLINE MOUNTABLE MEDIANS IN YELLOW; EDGE LINES ARE NOT USED NEXT TO BARRIER CURB
TURN LANE MARKINGS	6 (150) LINE; FULL SIZE LETTERS & SYMBOLS (8' (2.4m))	SOLID	WHITE	SEE TYPICAL TURN LANE MARKING DETAIL
TWO WAY LEFT TURN MARKING	2 @ 4 (100) EACH DIRECTION 8' (2.4m) LEFT ARROW	SKIP-DASH AND SOLID IN PAIRS	YELLOW WHITE	10' (3 m) LINE WITH 30' (9 m) SPACE FOR SKIP-DASH; 5 1/2 (140) C-C BETWEEN SOLID LINE AND SKIP-DASH LINE SEE TYPICAL TWO-WAY LEFT TURN MARKING DETAIL
CROSSWALK LINES (PEDESTRIAN) A. DIAGONALS (BIKE & EQUESTRIAN) B. LONGITUDINAL BARS (SCHOOL)	2 @ 6 (150) 12 (300) @ 45° 12 (300) @ 90°	SOLID SOLID SOLID	WHITE WHITE WHITE	NOT LESS THAN 6' (1.8 m) APART 2' (600) APART SEE TYPICAL CROSSWALK MARKING DETAILS.
STOP LINES	24 (600)	SOLID	WHITE	PLACE 4' (1.2 m) IN ADVANCE OF AND PARALLEL TO CROSSWALK, IF PRESENT. OTHERWISE, PLACE AT DESIRED STOPPING POINT, PARALLEL TO CROSSROAD CENTERLINE, WHERE POSSIBLE
PAINTED MEDIANS	2 @ 4 (100) WITH 12 (300) DIAGONALS @ 45° NO DIAGONALS USED FOR 4' (1.2 m) WIDE MEDIANS	SOLID	YELLOW; TWO WAY TRAFFIC WHITE; ONE WAY TRAFFIC	11 (280) C-C FOR THE DOUBLE LINE SEE TYPICAL PAINTED MEDIAN MARKING.
GORE MARKING AND CHANNELIZING LINES	8 (200) WITH 12 (300) DIAGONALS @ 45°	SOLID	WHITE	DIAGONALS: 15' (4.5 m) C-C (LESS THAN 30MPH (50 km/h)) 20' (6 m) C-C 30MPH (50 km/h) TO 45MPH (70 km/h) 30' (9 m) C-C (OVER 45MPH (70 km/h))
RAILROAD CROSSING	24 (600) TRANSVERSE LINES; "RR" IS 6' (1.8 m) LETTERS; 16 (400) LINE FOR "X"	SOLID	WHITE	SEE STATE STANDARD 780001 AREA OF: "R"=3.6 SQ. FT. (0.33 m ²) EACH "X"=54.0 SQ. FT. (5.0 m ²)
SHOULDER DIAGONALS	12 (300) @ 45°	SOLID	WHITE - RIGHT YELLOW - LEFT	50' (15 m) C-C (LESS THAN 30MPH (50 km/h)) 75' (25 m) C-C (30 MPH (50 km/h) TO 45MPH (70 km/h)) 150' (45 m) C-C (OVER 45MPH (70 km/h))

FOR FURTHER DETAILS ON PAVEMENT MARKING REFER TO STANDARD SPECIFICATIONS FOR ROAD AND BRIDGE CONSTRUCTION AND STATE STANDARD 780001.

All dimensions are in inches (millimeters) unless otherwise shown.

REVISIONS	
NAME	DATE
EVERS	03-19-90
T. RAMMACHER	10-27-94
ALEX HOUSEH	10-09-96
ALEX HOUSEH	10-17-96
T. RAMMACHER	01-06-00

ILLINOIS DEPARTMENT OF TRANSPORTATION
DISTRICT ONE
TYPICAL PAVEMENT MARKINGS

SCALE: NONE

DRAWN BY CADD
CHECKED BY