

ROUTE NO.	SECTION	COUNTY	TOTAL SHEETS	SHEET NO.
CH 11	*	EDGAR	160	26
FED. ROAD DIST. NO. 5		ILLINOIS	PROJECT	

\* 05-00092-01-PV

**CONSTRUCTION STAGING AND MAINTENANCE OF TRAFFIC**

**STAGE 1:**

**SEQUENCE OF CONSTRUCTION:**

1. CLOSE CH 8 TO THROUGH TRAFFIC UTILIZING BLR 22-4. CLOSE CH 11 AT THE INTERSECTION WITH CH 8 UTILIZING BLR 22-4.
2. CONSTRUCT TEMPORARY ACCESS TO RESIDENCE AT STA 296+00. MAINTAIN ACCESS THROUGHOUT STAGE 1.
3. CONSTRUCT CH 8 FROM STA 296+00 TO STA 314+75. CONSTRUCT CH 11 FROM STA 7+50 TO STA 10+00.13 AND FROM STA 10+24.13 TO STA 11+50. PLACE EXCESS EXCAVATION ALONG SHILOH ROAD STA 11+50 TO STA 46+00 IN LIEU OF STOCKPILING EXCAVATED MATERIAL.
4. CONSTRUCT HOT MIX ASPHALT BINDER COURSE PRIOR TO END OF STAGE 1.
5. REMOVE TYPE 3 BARRICADES ON CH 8 PRIOR TO OPENING TO THROUGH TRAFFIC.

**MAINTENANCE OF TRAFFIC:**

1. MAINTAIN TRAFFIC ON SURROUNDING ROADWAY NETWORK.
2. MAINTAIN ACCESS TO PROPERTIES WITHIN THE WORK ZONE WITH AGGREGATE BASE COURSE TYPE B PER TON. AN ESTIMATED QUANTITY IS PROVIDED IN THE PLANS.

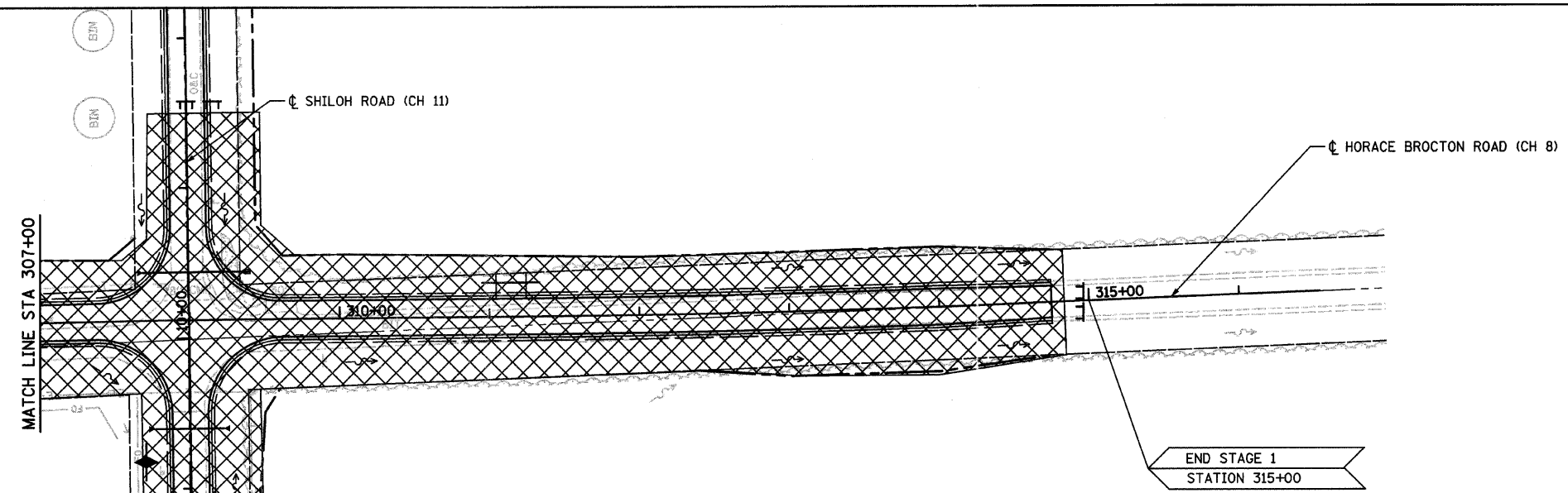
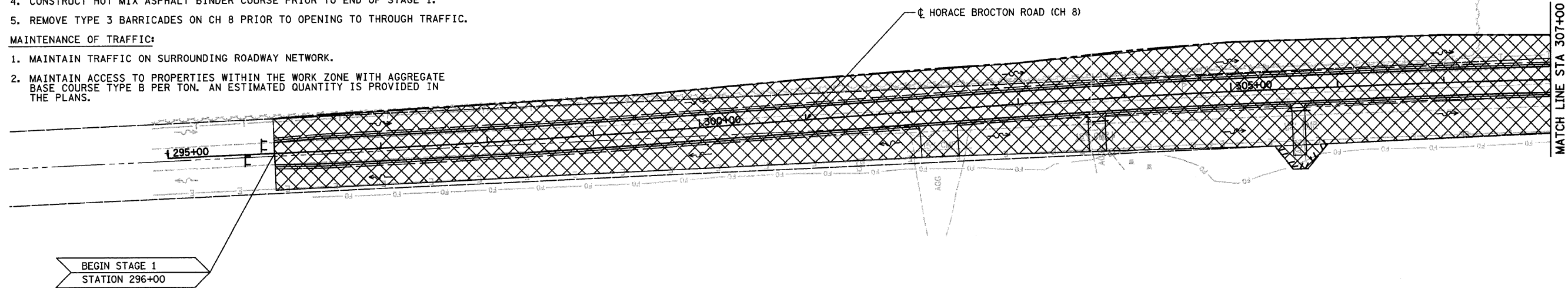

**LEGEND**

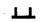
-  WORK ZONE
-  TYPE III BARRICADE

REVISIONS			TRAFFIC CONTROL AND STAGING	
No.	DATE	INITIALS	SHILOH ROAD (CH 11) EDGAR COUNTY, ILLINOIS	
1			DRAWN BY DATE DLB 6/07	
2			CHECKED BY DATE CAS 6/07	
3			BOOK NUMBER 469	
4			PROJECT No. 5245	
5			SHEET No.	
6			HOMER L. CHASTAIN & ASSOCIATES, LLP CONSULTING ENGINEERS 184-001297	
7			DECATUR CHICAGO (317) 429-8544 (773) 714-0050	
8			ROCKFORD (815) 489-0850	
9				
10				