

ROUTE NO.	SECTION	COUNTY	TOTAL SHEETS	SHEET NO.
CH 11	*	EDGAR	160	27

FED. ROAD DIST. NO. 5 ILLINOIS PROJECT

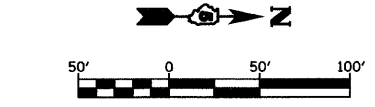

CONSTRUCTION STAGING AND MAINTENANCE OF TRAFFIC

STAGE 2:

SEQUENCE OF CONSTRUCTION:

1. CLOSE CH 11 TO THROUGH TRAFFIC NORTH OF THE INTERSECTION WITH CH 8 UTILIZING BLR 22-4.
2. CONSTRUCT CH 11 FROM STA 11+50 TO STA 136+00.
3. CONSTRUCT INTERSECTIONS WITH 1800TH ROAD AND 1900TH ROAD.
4. GRADE PROPOSED DITCHES FROM STA 136+00 TO STA 139+00.
5. CONSTRUCT HOT MIX ASPHALT BINDER COURSE PRIOR TO END OF STAGE 2.
6. UPON COMPLETION OF THE HOT MIX ASPHALT BINDER COURSE THE HOT MIX ASPHALT SURFACE COURSE SHALL BE CONSTRUCTED.

MAINTENANCE OF TRAFFIC:

1. MAINTAIN TRAFFIC ON CH 8 AND CH 11 SOUTH OF THE INTERSECTION WITH CH 8.
2. MAINTAIN TRAFFIC ON CH 11 NORTH OF THE INTERSECTION WITH CH 8 BY PROVIDING ACCESS TO LOCAL PROPERTY OWNERS.
3. MAINTAIN ACCESS TO PROPERTIES WITHIN THE WORK ZONE WITH AGGREGATE BASE COURSE TYPE B PER TON. AN ESTIMATED QUANTITY IS PROVIDED IN THE PLANS.
4. MAINTAIN TRAFFIC ON CH 11 FROM STA 136+00 TO STA 145+00 UTILIZING THE APPLICABLE PORTIONS OF HIGHWAY STANDARD 701006.
5. MAINTAIN TRAFFIC ON CH 8 AND CH 11 DURING THE CONSTRUCTION OF THE HOT MIX ASPHALT SURFACE COURSE BY UTILIZING THE APPLICABLE PORTIONS OF HIGHWAY STANDARD 701201.

LOGAN CUPPY ESTATE

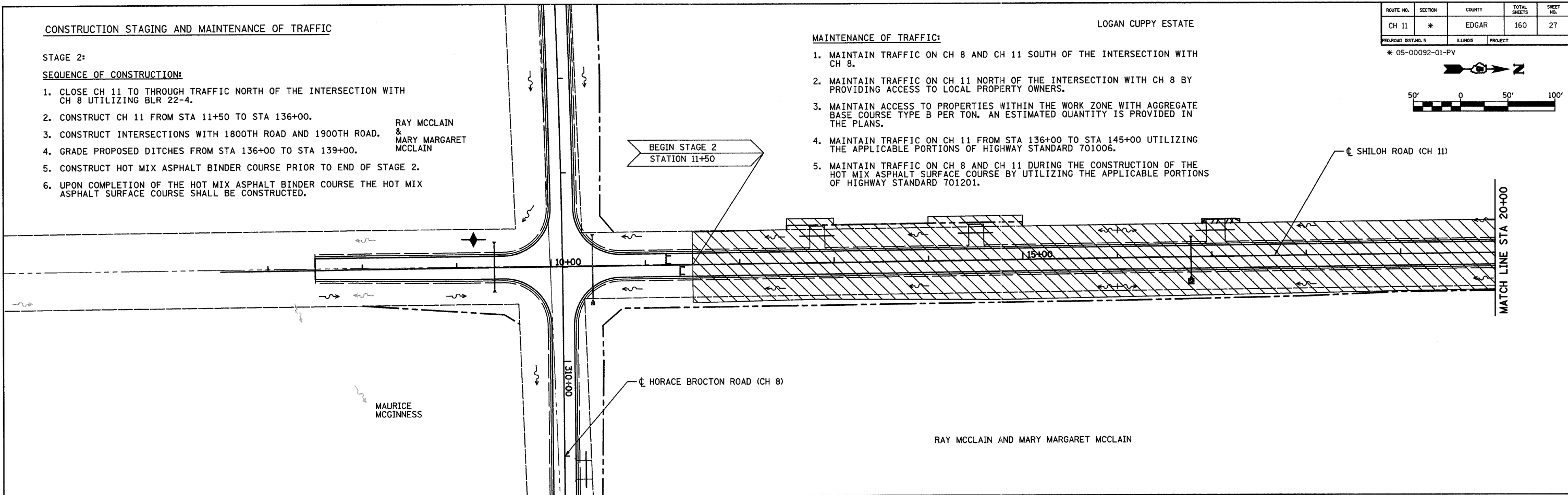

LOGAN CUPPY ESTATE

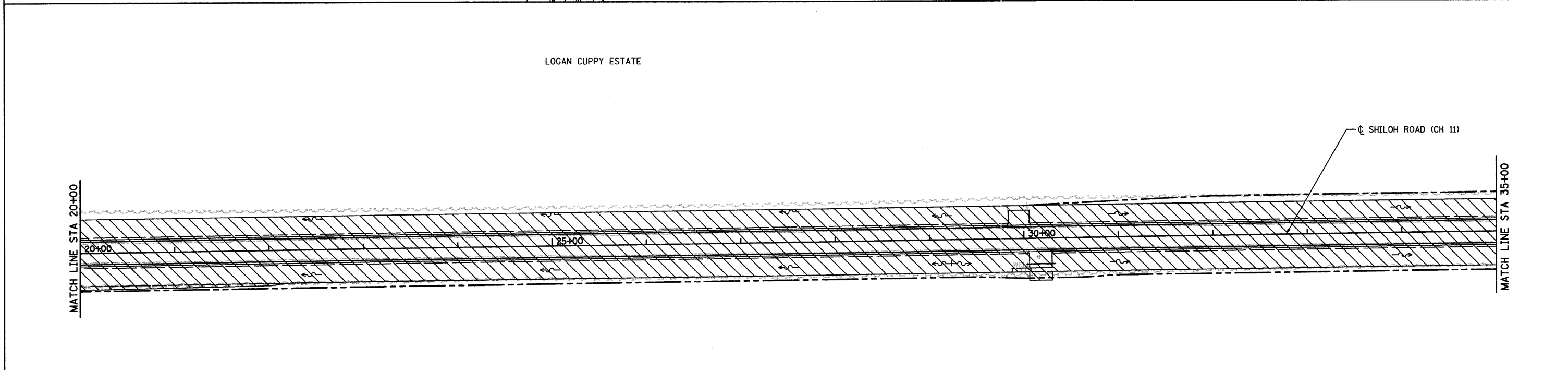

RAY MCCLAIN AND MARY MARGARET MCCLAIN

LEGEND

WORK ZONE

TYPE III BARRICADE

TRAFFIC CONTROL AND STAGING

NO.	DATE	INITIALS
1		
2		
3		
4		
5		
6		
7		
8		
9		
10		

SHILOH ROAD (CH 11)
EDGAR COUNTY, ILLINOIS

HOMER L. CHASTAIN & ASSOCIATES, LLP
CONSULTING ENGINEERS
184-001297

DECATUR CHICAGO
(317) 422-8544 (773) 714-0050

ROCKFORD
(815) 489-0050

DRAWN BY DLB	DATE 6/07
CHECKED BY CAS	DATE 6/07
BOOK NUMBER 469	PROJECT NO. 5245
SHEET NO.	