

ROUTE NO.	SECTION	COUNTY	TOTAL SHEETS	SHEET NO.
FAS 683	*	EDGAR	160	61
STA. 16+78.00		TO STA. 17+00.00		
FED. RD. DIST. NO. 7		ILLINOIS		PROJECT
*05-00092-01-PV				

FINAL SURVEYED  
 NOTEBOOK GRADES CHECKED  
 RT. OF WAY CHECKED  
 NO. \_\_\_\_\_

ORIGINAL SURVEYED  
 NOTEBOOK GRADES CHECKED  
 RT. OF WAY CHECKED  
 NO. \_\_\_\_\_

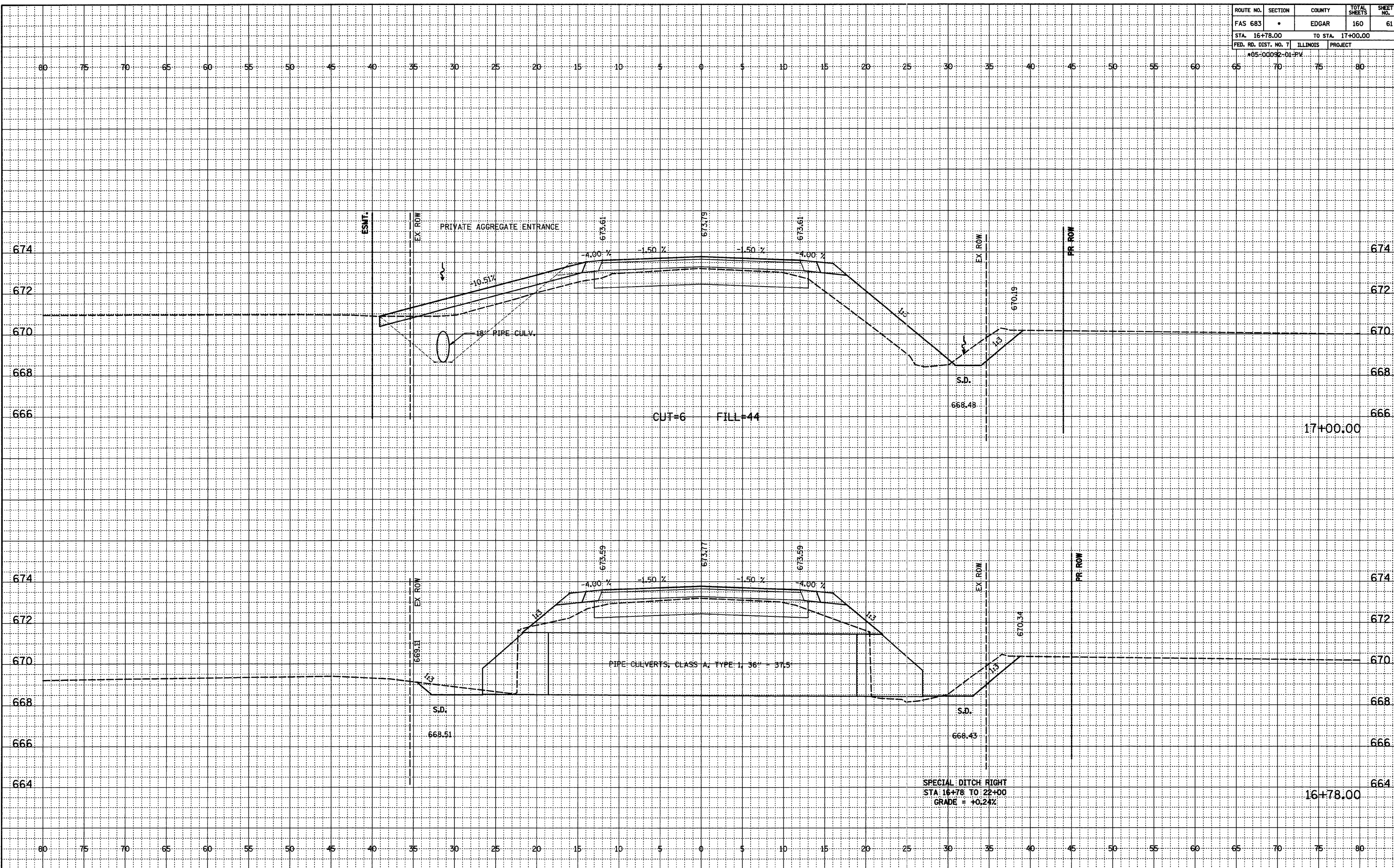

SPECIAL DITCH RIGHT  
 STA 16+78 TO 22+00  
 GRADE = +0.24%