

ROUTE NO.	SECTION	COUNTY	TOTAL SHEETS	SHEET NO.
FAS 683	*	EDGAR	160	68
STA. 29+00.00		TO STA. 29+95.00		
FED. RD. DIST. NO. 7		ILLINOIS PROJECT		
*05-00092-01-PV				

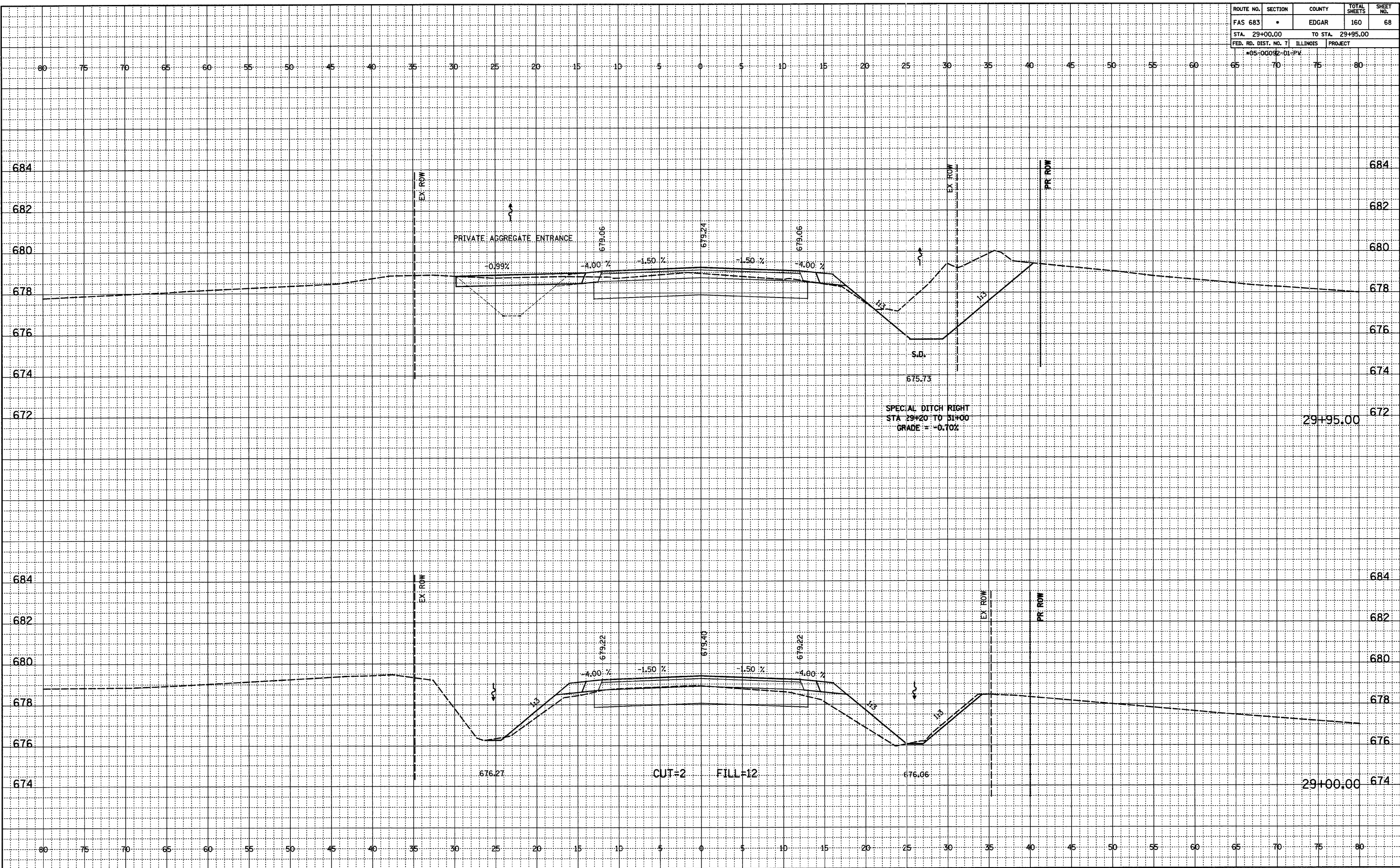

FINAL SURVEYED  
 NOTEBOOK ALIGNED CHECKED  
 RT. OF WAY CHECKED  
 NO. \_\_\_\_\_

ORIGINAL SURVEYED  
 NOTEBOOK GRADES CHECKED  
 B.M.'S NOTED  
 STRUCTURE NOTATIONS OK'D  
 NO. \_\_\_\_\_