

ROUTE NO.	SECTION	COUNTY	TOTAL SHEETS	SHEET NO.
FAS 683	*	EDGAR	160	94
STA. 71+00.00		TO STA. 72+00.00		
FED. RD. DIST. NO. 7		ILLINOIS PROJECT		
*05-00092-01-PV				

FINAL SURVEYED  
NOTEBOOK ALIGNED CHECKED  
NO. RT. OF WAY CHECKED

ORIGINAL SURVEYED  
NOTEBOOK GRADES CHECKED  
NO. B.M.'S NOTED  
STRUCTURE NOTATIONS OK'D

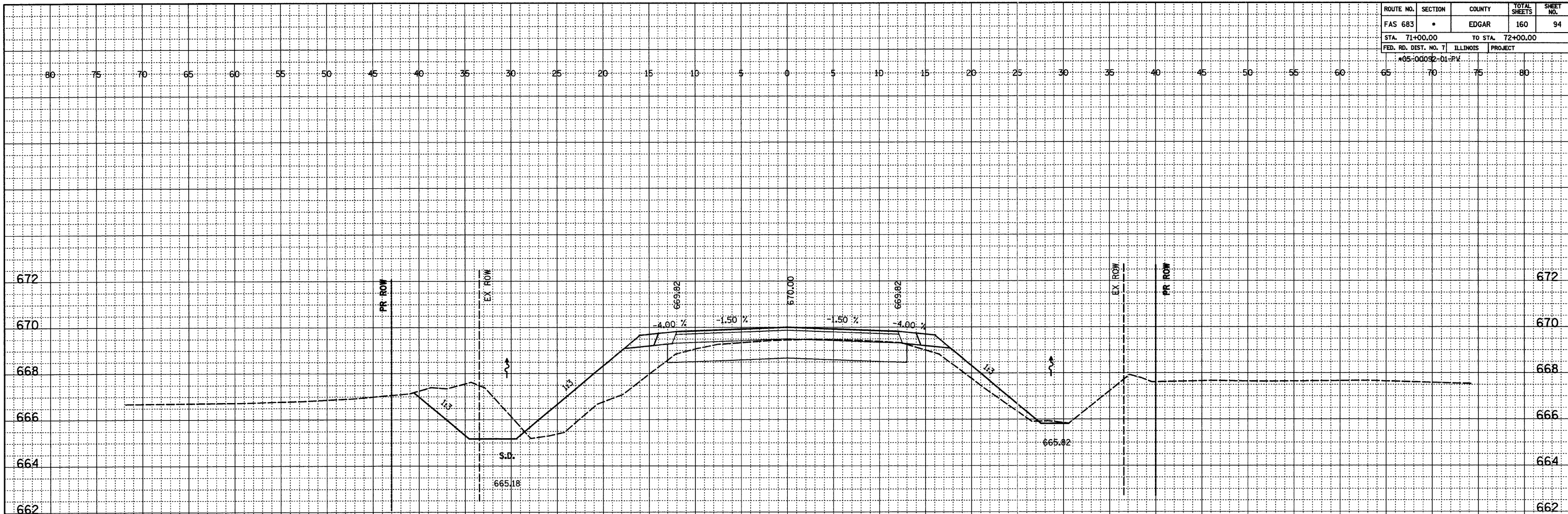

SPECIAL DITCH LEFT  
STA 72+00 TO 75+00  
GRADE = -0.41%

CUT=17 FILL=28

72+00.00

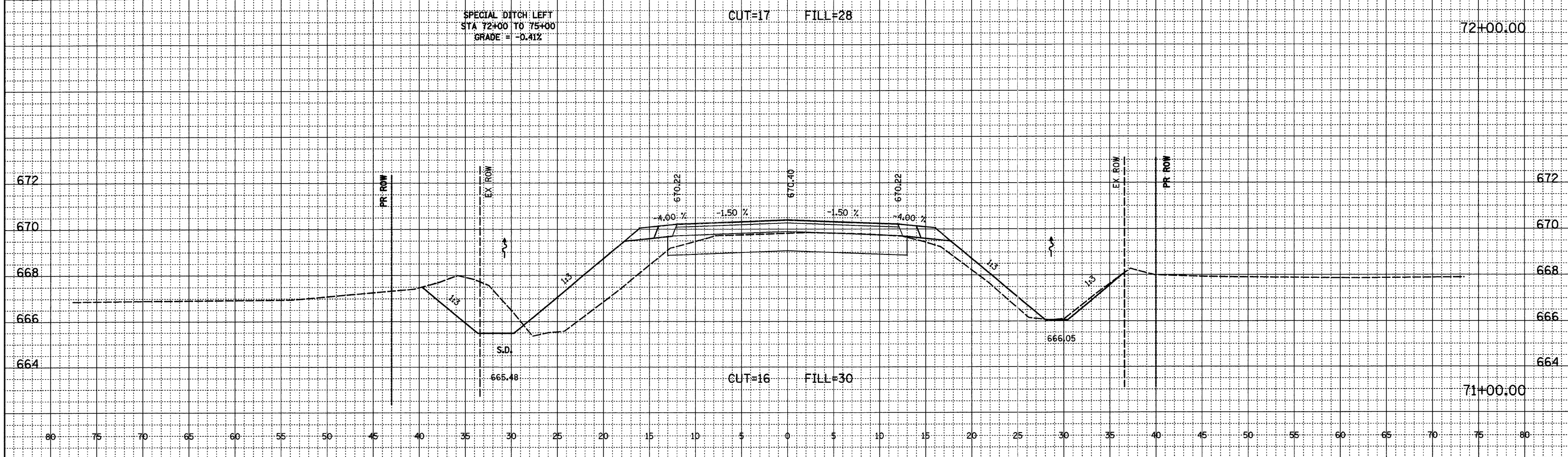

CUT=16 FILL=30

71+00.00