

STATE OF ILLINOIS
DEPARTMENT OF TRANSPORTATION
DIVISION OF HIGHWAYS
**PLANS FOR PROPOSED
ENHANCEMENTS**

INDEX OF SHEETS

SHEET NO.	DESCRIPTION
1	COVER SHEET
2	HIGHWAY STANDARDS, AND GENERAL NOTES
3	SUMMARY OF QUANTITIES
4	GENERAL PLAN AND ELEVATION
5	STRUCTURE DETAILS
6	RAILING DETAILS
7	MASONRY DETAILS
8	PLANTING PLAN
9	PLANTING DETAILS
10	MATERIALS PLAN
11	LARGE COLUMN DETAILS
12	SMALL COLUMN DETAILS
13 TO 15	COLUMN DETAILS
16	LIGHTING PLAN
17 TO 18	LIGHTING DETAILS
19	LIGHTING SCHEDULE
20 TO 21	SOIL BORINGS

PLAN 1 INCH = 20 FEET
 PROFILE HORIZ. 1 INCH = 20 FEET
 PROFILE VERT. 1 INCH = 5 FEET
 CROSS SECTIONS HORIZ. 1 INCH = 10 FEET
 CROSS SECTIONS VERT. 1 INCH = 5 FEET

**CITY OF CHAMPAIGN
CHAMPAIGN COUNTY, ILLINOIS
SECTION NO. 00-00374-03-LS
PROJECT NO. TE-00D5(85)
JOB NO. C-95-327-07
CITY PROJECT NO. 22-0000-07900-0377**

CURTIS ROAD BRIDGE ENHANCEMENT

R 8 E

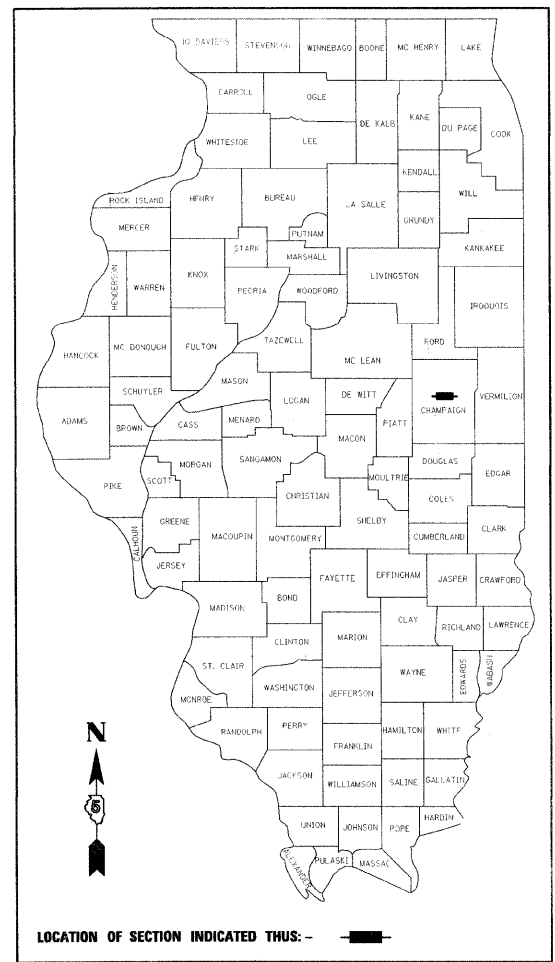

ILLINOIS HIGHWAY STANDARD DRAWINGS
(SEE SHEET NO. 2)

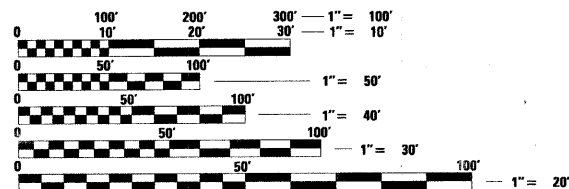

FULL SIZE PLANS HAVE BEEN PREPARED USING STANDARD ENGINEERING SCALES. REDUCED SIZED PLANS WILL NOT CONFORM TO STANDARD SCALES. IN MAKING MEASUREMENTS ON REDUCED PLANS, THE ABOVE SCALES MAY BE USED.

J.U.L.I.E.
JOINT UTILITY LOCATION INFORMATION FOR EXCAVATION
1-800-892-0123

CONTRACT NO. 91382

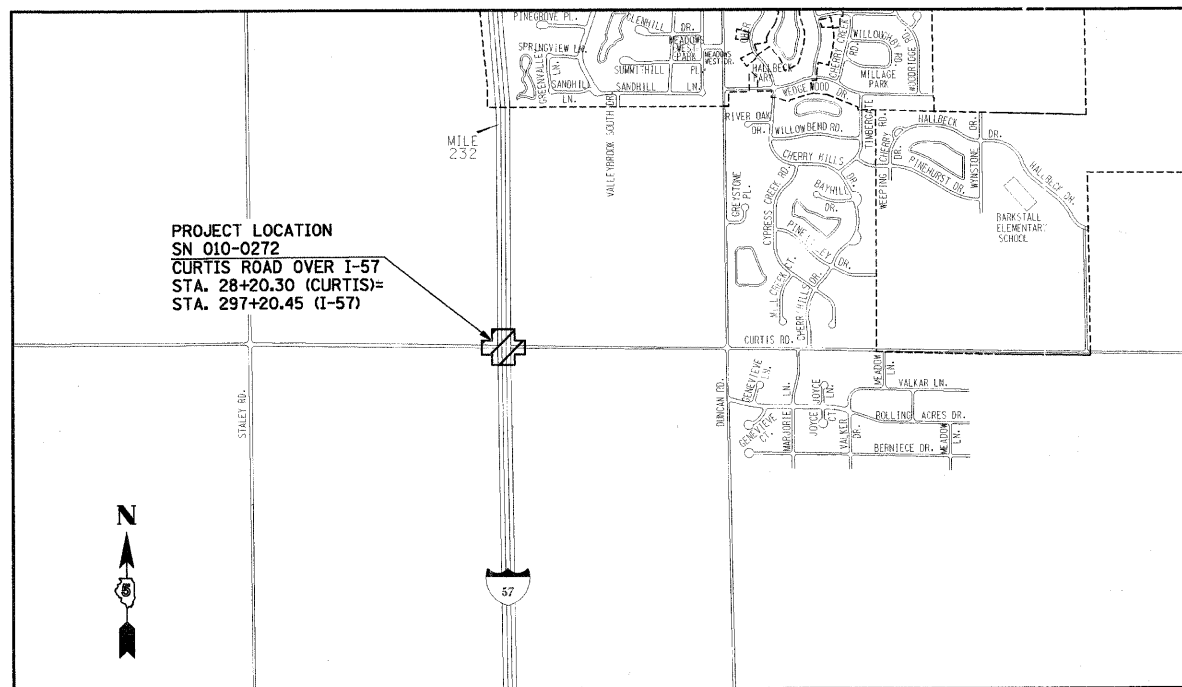

LOCATION MAP

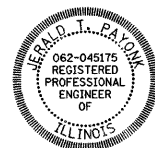
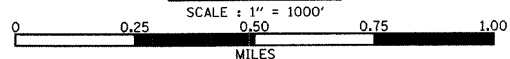

PROFESSIONAL ENGINEER
CLARK DIETZ, INC.
DATE: 10 JAN 08
LICENSE EXPIRES 11-30-09

T 19 N

DESIGN DESIGNATION
INTERSTATE ROUTE 57
PRINCIPAL ARTERIAL ADT 27,600
CURTIS ROAD
MINOR ARTERIAL ADT 19,600

APPROVED *W. Roland White* Jan 11, 20 08
CHAMPAIGN CITY ENGINEER

PASSED *David A. Spill* 1/21 20 08
DISTRICT FIVE ENGINEER OF
LOCAL ROADS & STREETS

Releasing For Bid Based on Limited Review
JAN 22 20 08
John E. Brown
DEPUTY DIRECTOR OF HIGHWAYS,
REGION THREE ENGINEER

STATE OF ILLINOIS
DEPARTMENT OF TRANSPORTATION

Hitchcock Design Group
Creating Better Places®

Clark Dietz ENGINEERS
1817 SOUTH NEIL STREET
SUITE 100
CHAMPAIGN, IL 61820
PHONE : 217.373.8900
FAX : 217.373.8923
DESIGN FIRM REGISTRATION No. 184-000450