

F.A.U. RTE.	SECTION	COUNTY	TOTAL SHEETS	SHEET NO.
7982	*	SANGAMON	114	80
STA.	TO STA.			
FED. ROAD DIST. NO.	ILLINOIS	FED. AID PROJECT		
05-00447-01-PV	CITY OF SPRINGFIELD			

LEGEND

- LONGITUDINAL CONSTRUCTION JOINT
- SAWED LONGITUDINAL JOINT
- TRANSVERSE SAWED CONTRACTION JOINT
- TRANSVERSE SAWED OR CONSTRUCTION JOINT (CONTRACTOR'S OPTION).
- SEE STD. 420001 FOR JOINT DETAILS & REINFORCEMENT. ALL STATIONING & OFFSETS ARE TO C CAPITOL AVENUE
- [Hatched Box] PROPOSED CONCRETE PAVERS

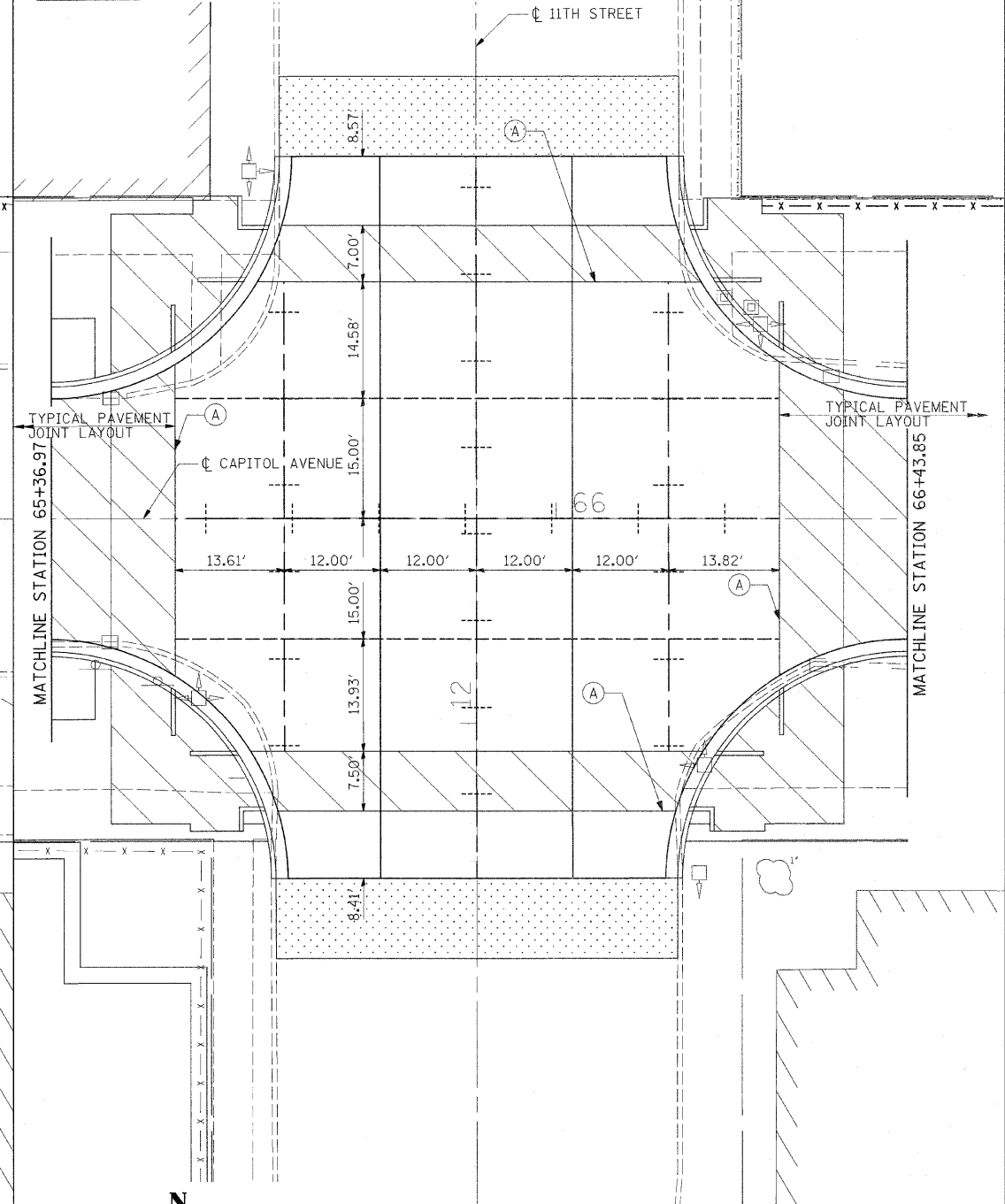
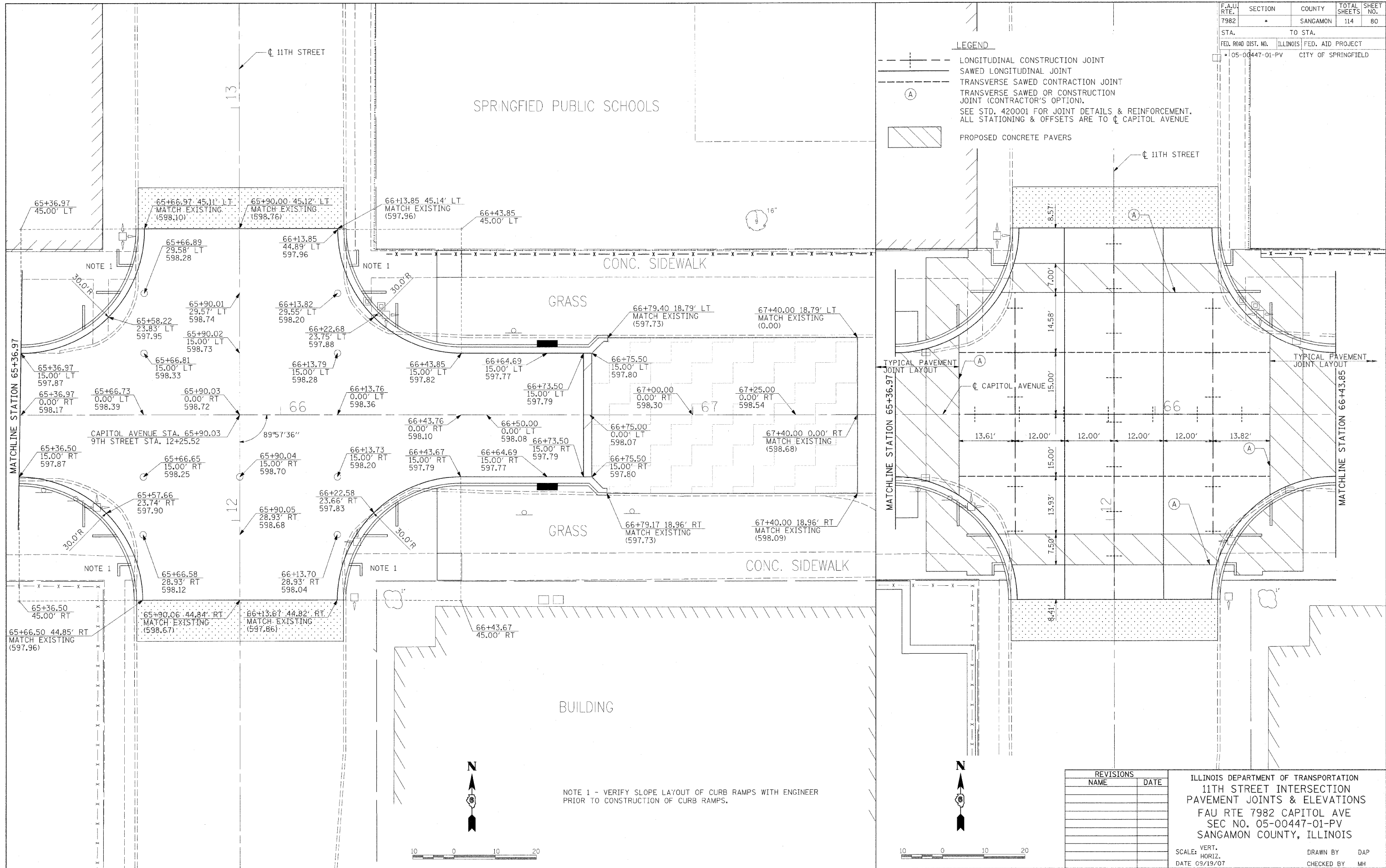

NOTE 1 - VERIFY SLOPE LAYOUT OF CURB RAMPS WITH ENGINEER PRIOR TO CONSTRUCTION OF CURB RAMPS.

REVISIONS	
NAME	DATE

ILLINOIS DEPARTMENT OF TRANSPORTATION  
 11TH STREET INTERSECTION  
 PAVEMENT JOINTS & ELEVATIONS  
 FAU RTE 7982 CAPITOL AVE  
 SEC NO. 05-00447-01-PV  
 SANGAMON COUNTY, ILLINOIS

SCALE: VERT. \_\_\_\_\_  
 HORIZ. \_\_\_\_\_  
 DATE 09/19/07

DRAWN BY DAP  
 CHECKED BY MH



© Copyright Hanson Professional Services Inc. 2008  
 PLOT DATE = 01/18/2008 10:23 AM  
 FILE NAME = I:\2008\05\02\915\Access\Road\microstation\sheet\section\_L17b-11th-11th-797\_PJE\_11INT.dgn  
 USER = PJE  
 USER NAME = PJE

REVISED	DAP	03/14/07
DESIGNED	DAP	03/14/07
CHECKED	MH	03/19/07