

FAU RTE.	SECTION	COUNTY	TOTAL SHEETS	SHEET NO.
7982		SANGAMON	114	90
STA.	TO STA.			
FED. ROAD DIST. NO.	ILLINOIS	FED. AID PROJECT		
05-00447-01-PV	CITY OF SPRINGFIELD			

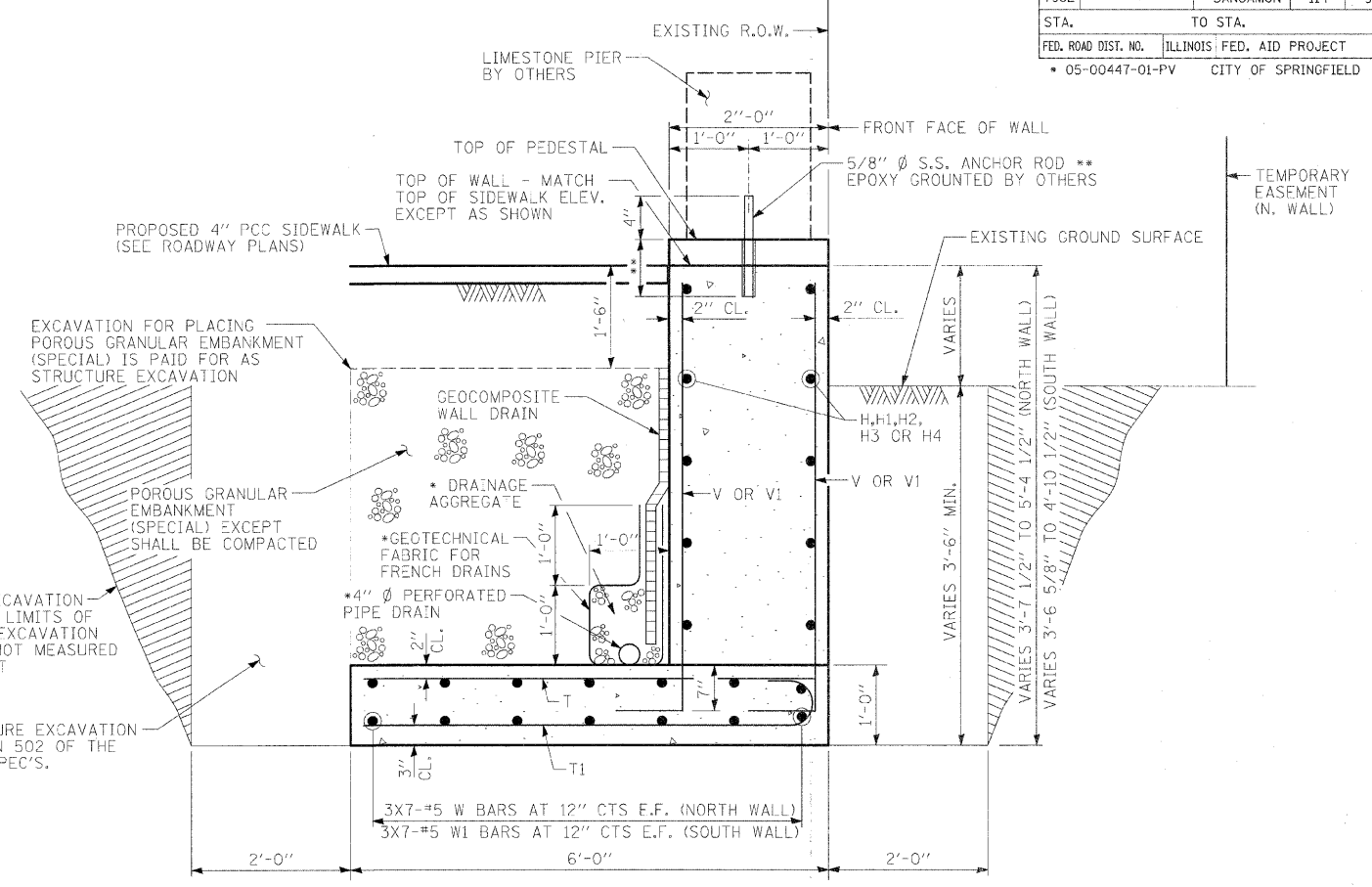
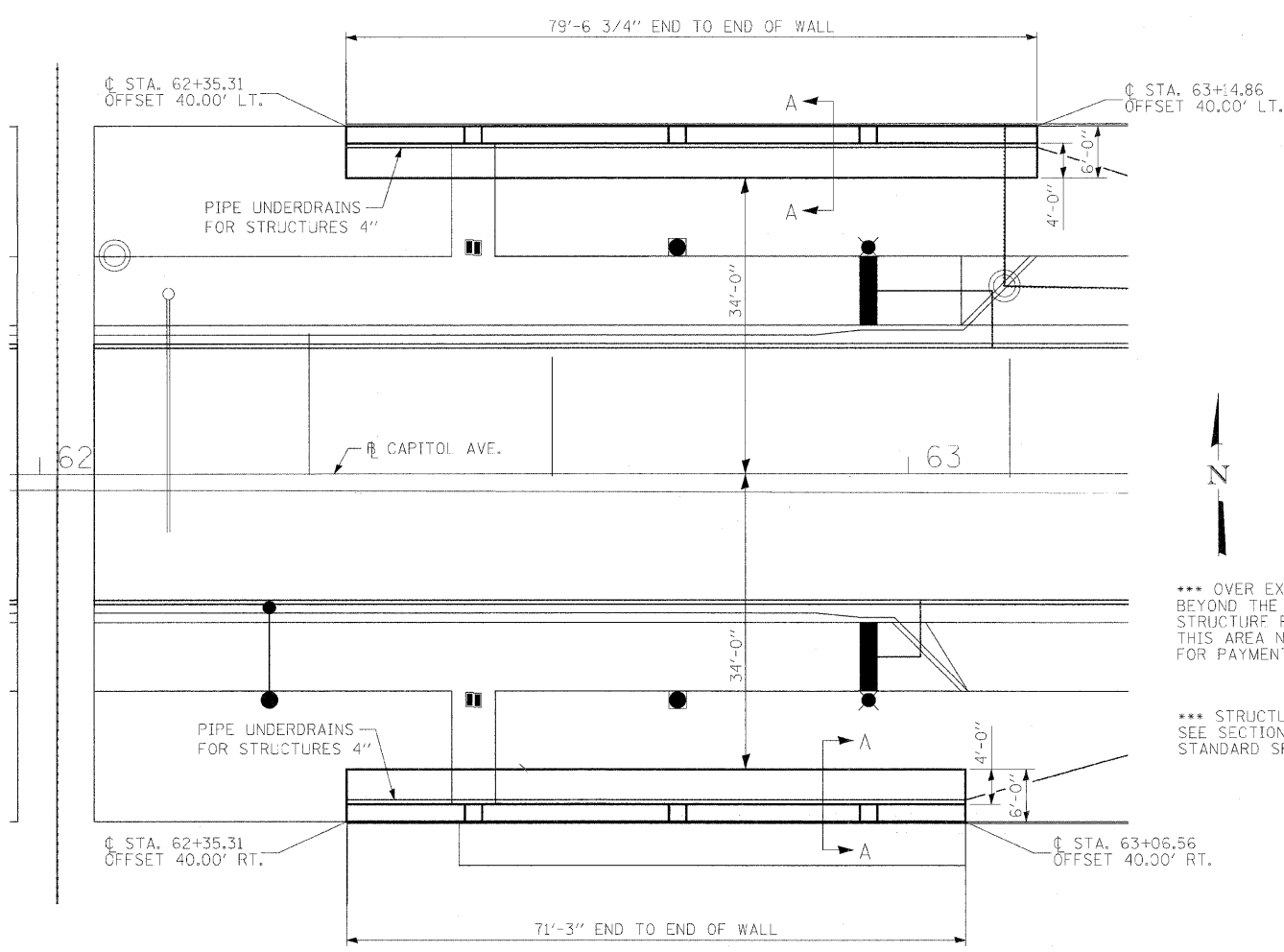

*** OVER EXCAVATION BEYOND THE LIMITS OF STRUCTURE EXCAVATION THIS AREA NOT MEASURED FOR PAYMENT

*** STRUCTURE EXCAVATION SEE SECTION 502 OF THE STANDARD SPEC'S.

SECTION A-A

- INCLUDED IN THE COST OF "PIPE UNDERDRAINS FOR STRUCTURES"
- ANCHOR ROD SHALL HAVE AN EMBEDMENT SUFFICIENT TO OBTAIN 1.25 X THE YIELD STRENGTH OF THE ANCHOR ROD
- BACKFILL REMAINDER OF STRUCTURE EXCAVATION WITH SAME MATERIAL SPECIFIED FOR ROADWAY EMBANKMENT

DESIGN SPECIFICATIONS
2002 (17th EDITION) AASHTO STANDARD SPECIFICATIONS FOR HIGHWAY BRIDGES

DESIGN STRESSES
FIELD UNITS
f'c = 3,500 PSI
fy = 60,000 PSI

GENERAL NOTES

- REINFORCEMENT BARS SHALL CONFORM TO THE REQUIREMENTS OF ASTM A706 GR. 60. SEE SPECIAL PROVISIONS.
 - STAINLESS STEEL ANCHOR RODS SHALL MEET THE REQUIREMENTS OF ASTM F593 (AISI 304/316). COST OF STAINLESS STEEL ANCHOR RODS SHALL BE INCLUDED WITH THE ORNAMENTAL FENCE. THIS WORK SHALL BE COMPLETED BY OTHERS.
 - MAXIMUM APPLIED BEARING PRESSURE=1600 PSF
- C.J. = CONSTRUCTION JOINT
E.F. = EACH FACE
B.F. = BACK FACE
F.F. = FRONT FACE

MIN BAR LAPS
#4 BAR 1'-8"
#5 BAR 2'-2"

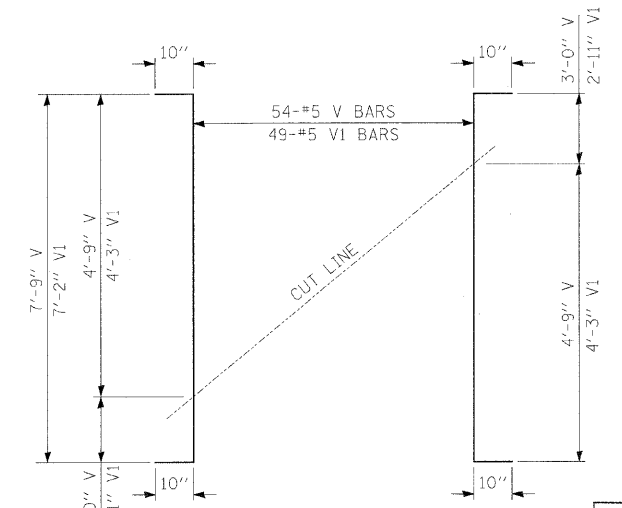

FIELD CUTTING DIAGRAM
ORDER V AND V1 BARS FULL LENGTH. CUT AS SHOWN AND USE ALTERNATING BARS TO COMPLETE THE RUN.

BILL OF MATERIAL SOUTH WALL

BAR	NO.	SIZE	LENGTH	SHAPE
H	8	#5	17'-10"	—
H1	8	#5	25'-8"	—
H2	8	#5	24'-2"	—
H2	8	#5	9'-10"	—
T	72	#5	5'-8"	—
T1	72	#7	6'-6"	—
V	49	#5	8'-10"	—
W1	42	#5	25'-3"	—
REINFORCEMENT BARS		POUNDS	3500	
CONCRETE STRUCTURES		CU. YD.	32.7	
STRUCTURE EXCAVATION		CU. YD.	90	
POROUS GRANULAR EMBANKMENT SPECIAL		CU. YD.	18	
GEOCOMPOSITE WALL DRAIN		SQ. YD	14	
PIPE UNDERDRAINS FOR STRUCTURES 4"		Foot	72	

BILL OF MATERIAL NORTH WALL

BAR	NO.	SIZE	LENGTH	SHAPE
H	8	#5	17'-10"	—
H1	8	#5	25'-8"	—
H2	8	#5	24'-2"	—
H3	8	#5	18'-2"	—
T	81	#5	5'-8"	—
T1	81	#7	6'-6"	—
V	54	#5	9'-5"	—
W	42	#5	28'-0"	—
REINFORCEMENT BARS		POUNDS	4030	
CONCRETE STRUCTURES		CU. YD.	38.9	
STRUCTURE EXCAVATION		CU. YD.	109	
POROUS GRANULAR EMBANKMENT SPECIAL		CU. YD.	24	
GEOCOMPOSITE WALL DRAIN		SQ. YD	18	
PIPE UNDERDRAINS FOR STRUCTURES 4"		Foot	80	

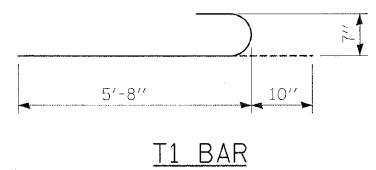

REVISIONS	
NAME	DATE

ILLINOIS DEPARTMENT OF TRANSPORTATION
RETAINING WALL DETAILS

FAU RTE 7982 CAPITOL AVE
SEC NO. 05-00447-01-PV
SANGAMON COUNTY, ILLINOIS

SCALE: VERT. HORIZ. DATE 09/19/07

DRAWN BY DAB
CHECKED BY MNM



PLT DATE = 01/19/2006 10:23 AM
FILE NAME = h:\02 jobs\022206\11a\cadd\road\microstation\sheet\secton\17h\11h\c-812_RET_WALL_10h.dgn
DRAWN = DAB 11/27/03
REVIEWED = MNM 11/27/03
USER NAME = Pcp00836