

RTE.	SECTION	COUNTY	TOTAL SHEETS	SHEET NO.
C.H. 17	*	MONTGOMERY	41	4

PROJECT * 07-00125-01-RS

PAVEMENT LEGEND

1. Existing Aggregate Base (±8" min.)
2. Existing Hot Mix Asphalt Overlay (±3" min.)
3. Existing P.C.C. Pavement 8"
4. Existing Stabilized Sub-Base 4"
5. Existing Aggregate Wedge
6. Existing Aggregate Shoulders 8"
7. Existing Stabilized Shoulders 8"
8. Existing Type B-6.12 Gutter
9. Existing Hot Mix Asphalt Surface Removal 3"
10. Existing Concrete Median Surface Removal
11. Proposed Hot Mix Asphalt Surface Course, Mix. D, N70 1½" min.
12. Proposed Hot Mix Asphalt Leveling Binder (Machine Method) N70 - (Variable Depth)
13. Proposed Hot Mix Asphalt Base Course Widening 8"
14. Proposed Hot Mix Asphalt Binder Course IL-19.0 N70 (8½")
15. Proposed Hot Mix Asphalt Shoulders
16. Proposed Turf Median
17. Proposed Concrete Curb & Gutter Removal and Replacement, Type M6.06 (Special)
18. Proposed Pavement Marking 4"
19. Proposed Aggregate Shoulders, Type B
20. Proposed P.C.C. Sidewalk 4"
21. Proposed Sub-base Granular Material 4"
22. Proposed Storm Sewers, Class A, Type 1 8"
23. Proposed Pipe Underdrains 4"
24. Proposed Temporary Pavement Marking 4"
25. Proposed Earth Shoulder

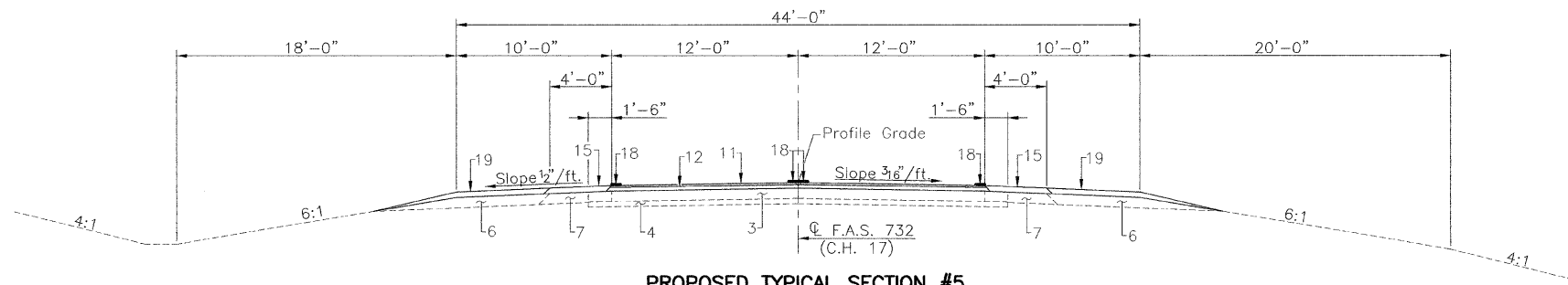

PROPOSED TYPICAL SECTION #5
(Sta. 33+92 to Sta. 34+50)

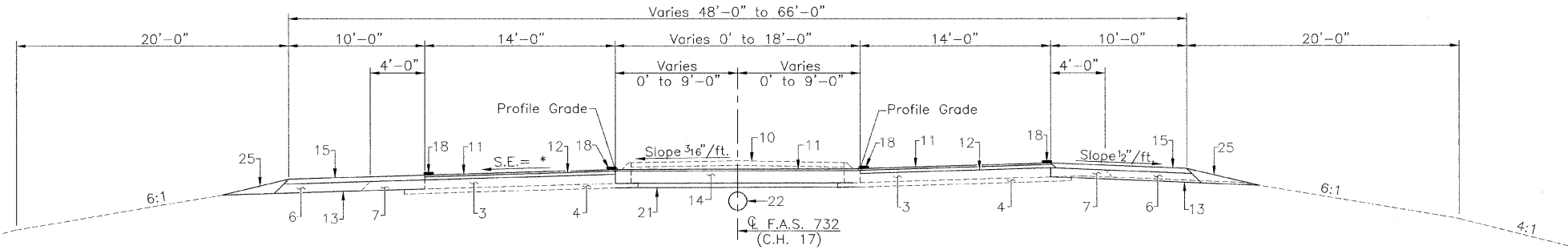

PROPOSED TYPICAL SECTION #6
(Sta. 34+50 to Sta. 39+53.64 & Sta. 61+30.16 to Sta. 67+00)

* - S.E. = 0.035'/ft. - Sta. 35+91.04 to Sta. 39+53.64
S.E. = 0.037'/ft. - Sta. 61+30.16 to Sta. 67+00.00

Note: HMA Overlay thickness is 2" from Sta. 61+30.16 to Sta. 65+00 and varies with 2" min. from Sta. 65+00 to Sta. 67+00

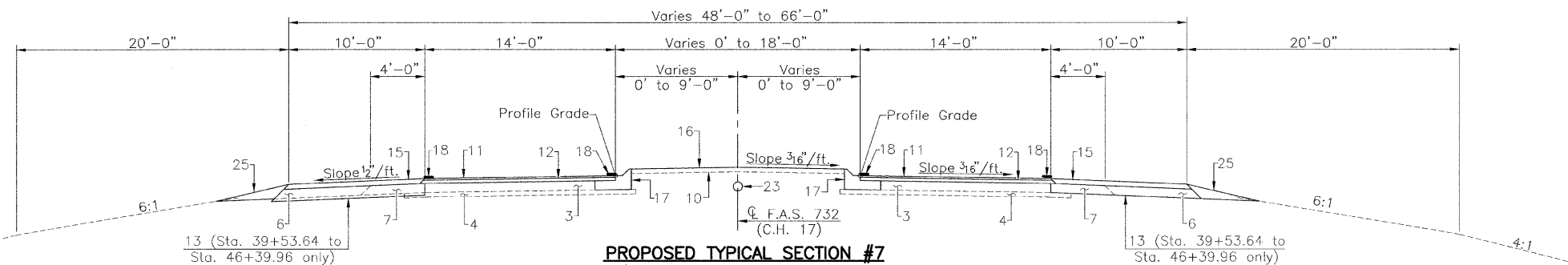

PROPOSED TYPICAL SECTION #7
(Sta. 39+53.64 to Sta. 46+39.96 & Sta. 59+29.48 to Sta. 61+30.16)

Note: HMA Overlay thickness is 2" from Sta. 59+29.48 to Sta. 61+30.16

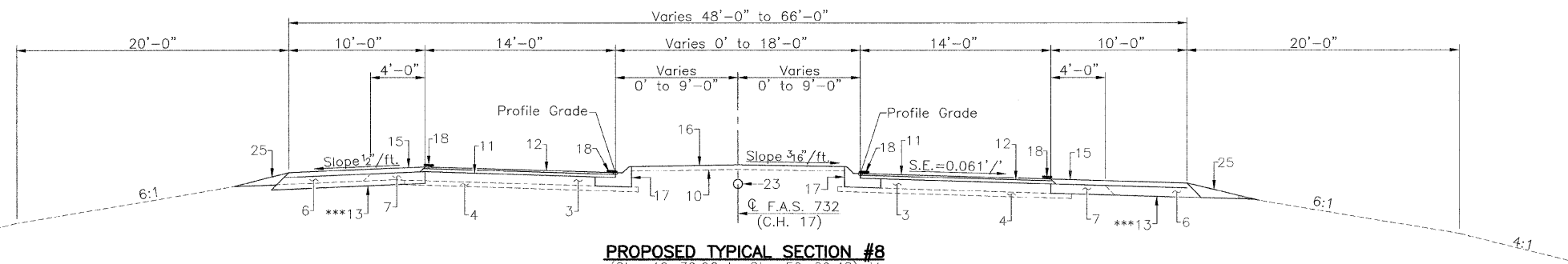

PROPOSED TYPICAL SECTION #8
(Sta. 46+39.96 to Sta. 59+29.48)

(Bridge Omission - Sta. 48+45.30 to Sta. 51+46.00)

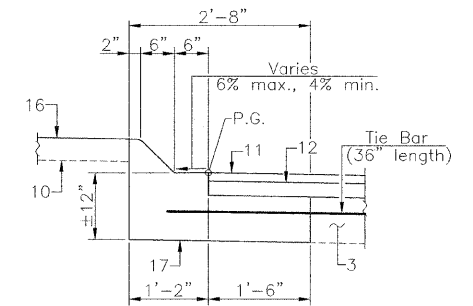

COMBINATION CURB & GUTTER DETAIL TYPE M6.06 (SPECIAL)

(Connect Curb to Exist. Pavement per Std. 606001)

(Sta. 39+54.50 to Sta. 44+93 Rt., Sta. 45+65.50 to Sta. 48+33 Lt., Sta. 45+65.50 to Sta. 48+23 Rt. & Sta. 51+66 to Sta. 55+97 Lt. & Rt.)

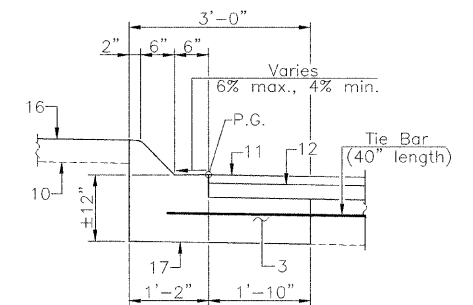

COMBINATION CURB & GUTTER DETAIL TYPE M6.06 (SPECIAL)

(Connect Curb to Exist. Pavement per Std. 606001)

(Sta. 39+54.50 to Sta. 44+93 Lt.)

DETAILS & TYPICAL SECTIONS F.A.S. 732 (C.H. 17) (FARMERSVILLE OVERPASS) SECTION 07-00125-01-RS MONTGOMERY COUNTY

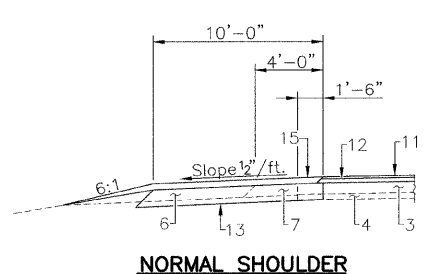

NORMAL SHOULDER

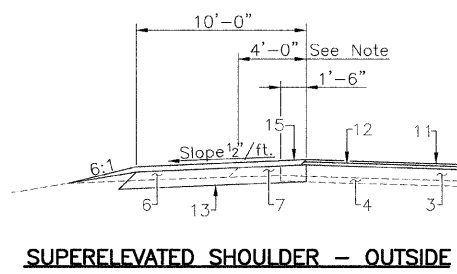

SUPERELEVATED SHOULDER - OUTSIDE

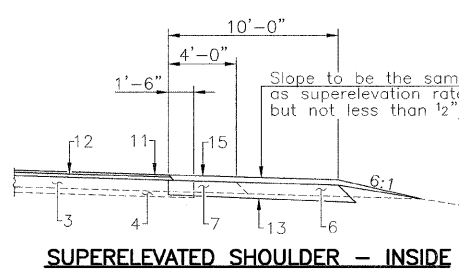

SUPERELEVATED SHOULDER - INSIDE

** HMA Thickness - 4" Sta. 46+39.96 to Sta. 48+45.3 & Sta. 51+46 to Sta. 56+00
4" to 2" - Sta. 56+00 to Sta. 56+60
2" - Sta. 56+60 to Sta. 59+29.48

*** - 10'-0" Width Ends at Sta. 58+00 Lt. & Rt.

Note: When the superelevation of pavement exceeds 0.04 Ft./Ft. a 2 foot portion of the shoulder that is adjacent to pavement shall be sloped so that the algebraic difference between pavement and shoulder will not be greater than 0.08 Ft./Ft.