

SECTION 33. T. 12 N., R. 5 W., 3rd P.M.

RTE.	SECTION	COUNTY	TOTAL SHEETS	SHEET NO.
C.H. 17	*	MONTGOMERY	41	15

PROJECT \* 07-00125-01-RS

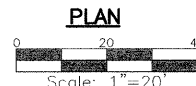
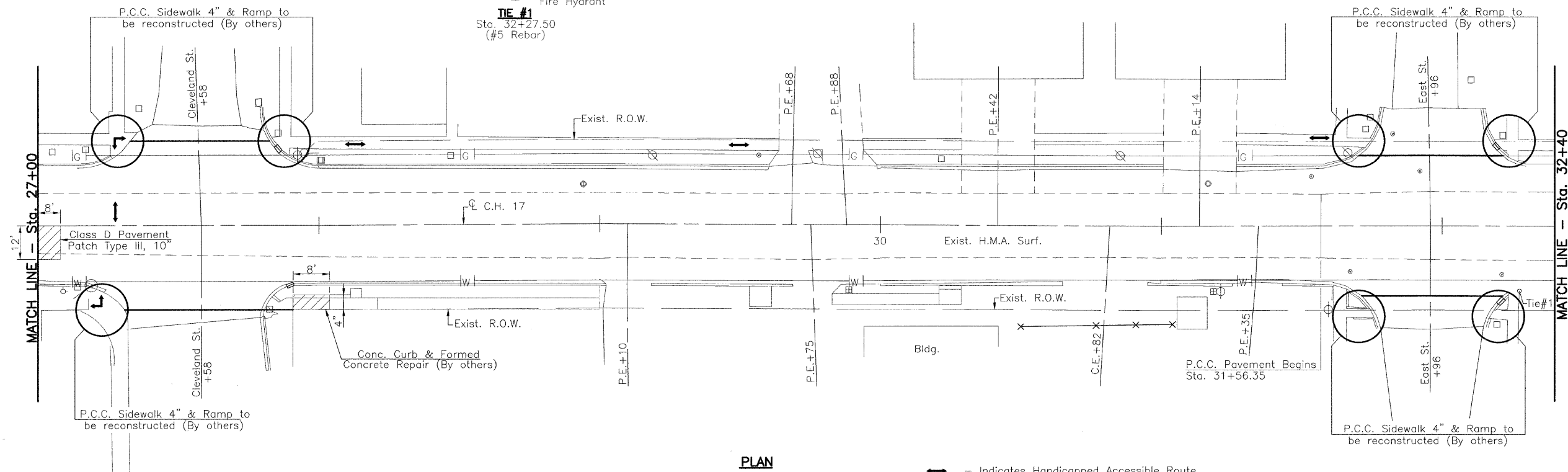
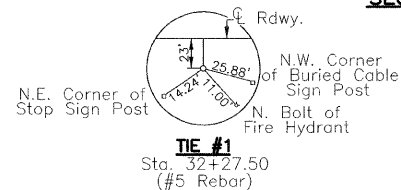

↔ - Indicates Handicapped Accessible Route

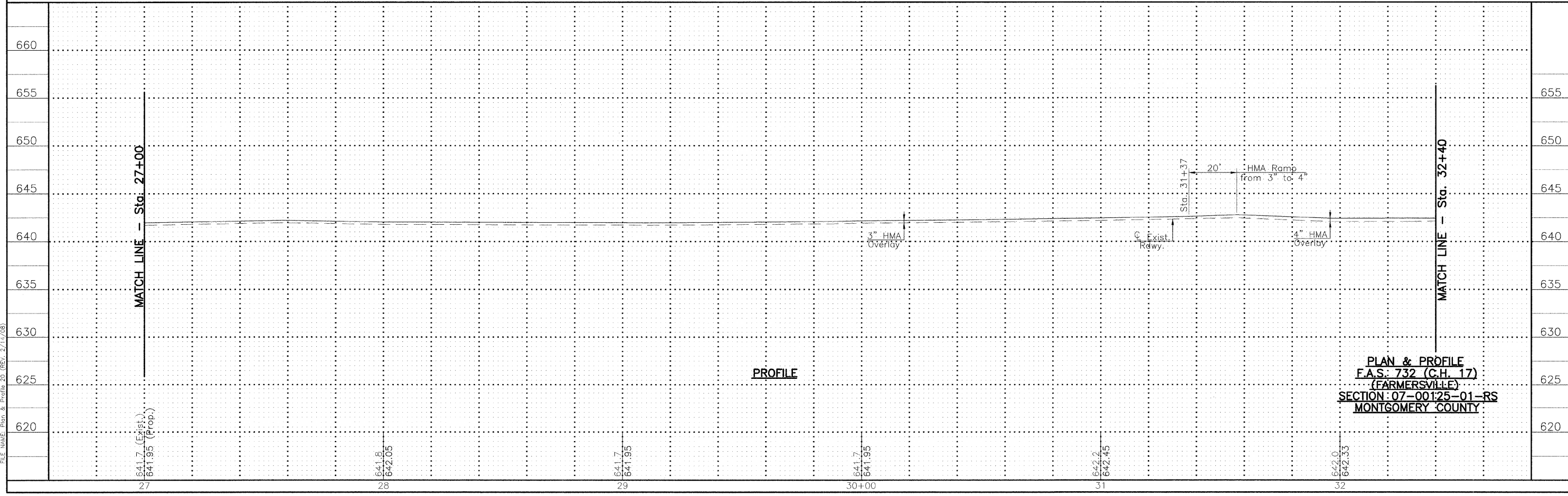

PROFILE

PLAN & PROFILE  
 F.A.S. 732 (C.H. 17)  
 (FARMERSVILLE)  
 SECTION 07-00125-01-RS  
 MONTGOMERY COUNTY

FILE NAME: Plan & Profile 20 (REV. 2/14/08)