

F.A.S. RTE.	SECTION	COUNTY	TOTAL SHEETS	SHEET NO.
642	00-00127-00-WR	COLES	91	53
STA.		TO STA.		
FED. ROAD DIST. NO.		ILLINOIS	FED. AID PROJECT	

EXTEND NO PASSING ZONE STRIPING
500' WEST OF STATION 533+24.36

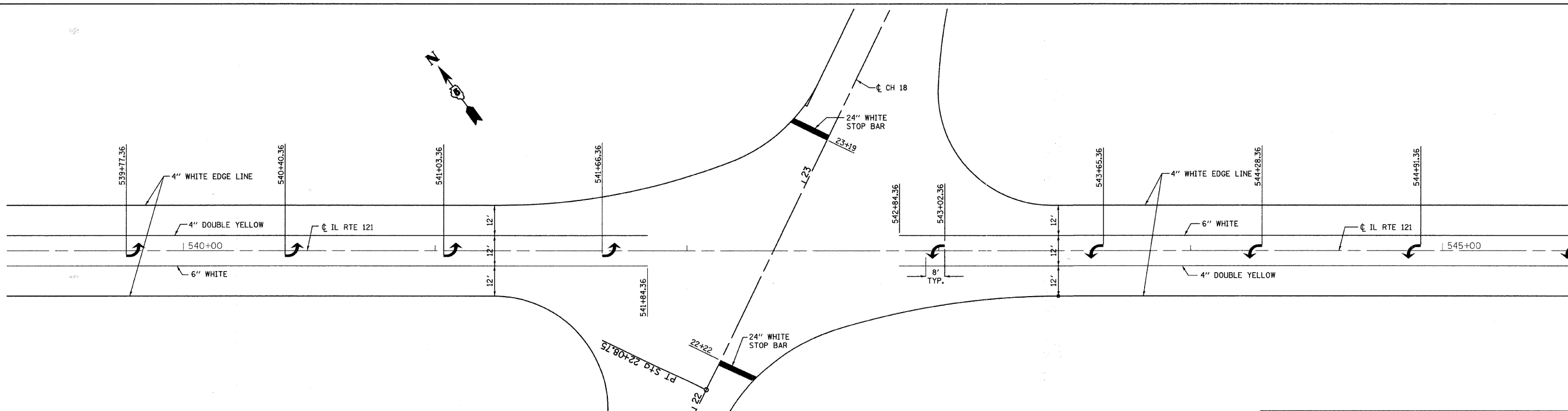
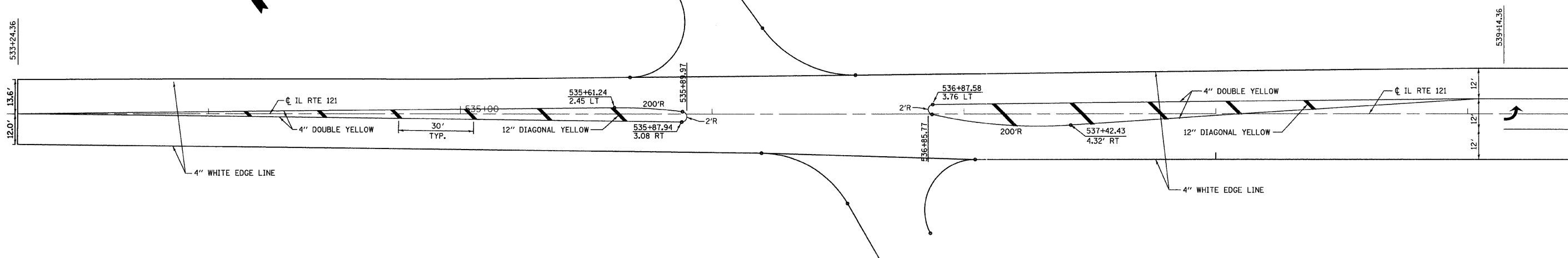

REVISIONS	
NAME	DATE

ILLINOIS DEPARTMENT OF TRANSPORTATION
PAVEMENT MARKING PLAN
SCALE: VERT. 1"=20'
HORIZ. 1"=20'
DATE 02/28/2008
DRAWN BY SJF
CHECKED BY MED

TUG PROJ. #3103027
...WHITESTOPPING.SHEETPLN.dgn