

F.A. RTE.	SECTION	COUNTY	TOTAL SHEETS	SHEET NO.
..	..	MACON	106	30
STA. TO STA.		FED. ROAD DIST. NO. ILLINOIS FED. AID PROJECT		
..		05-00525-00SW		

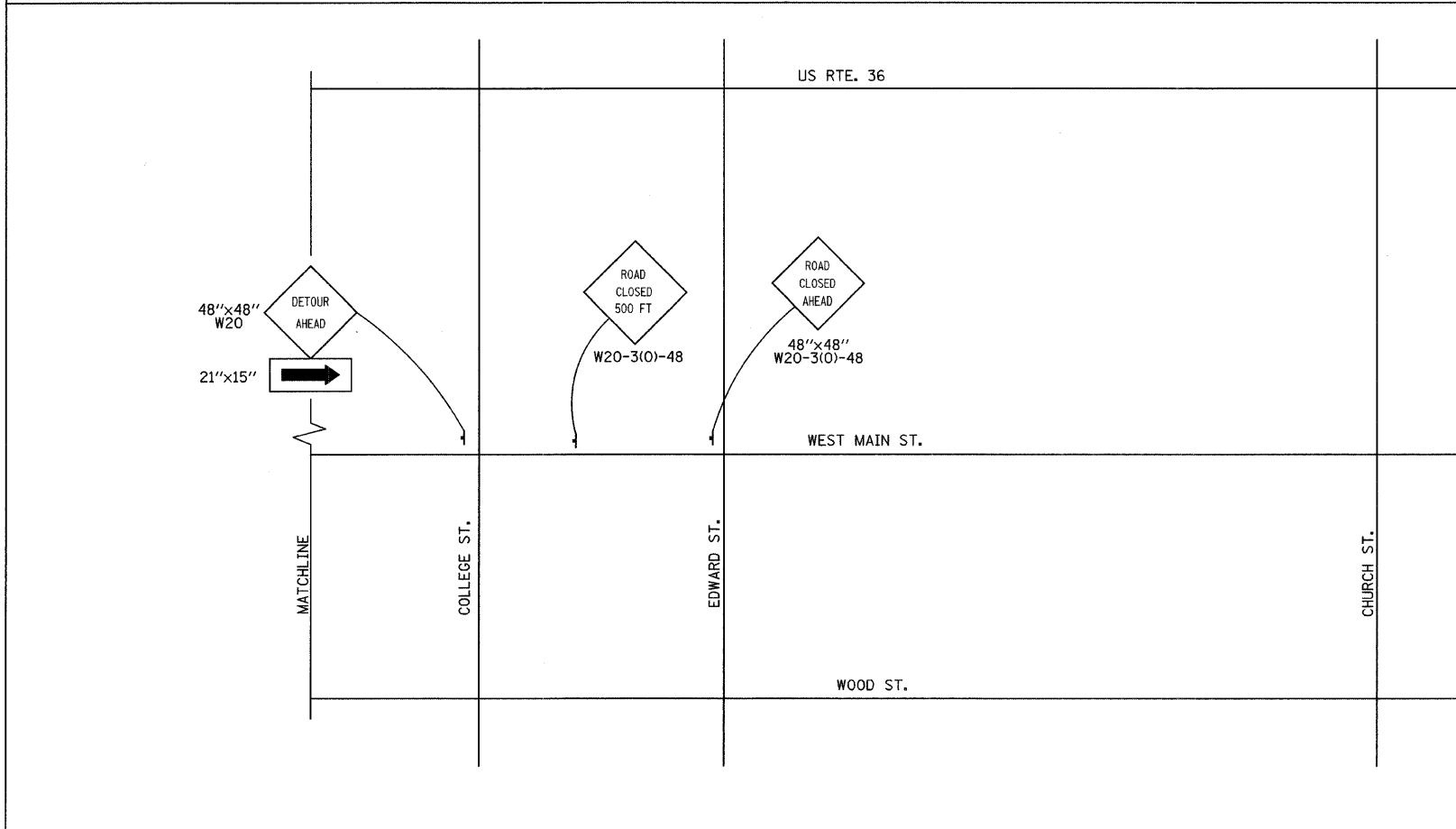
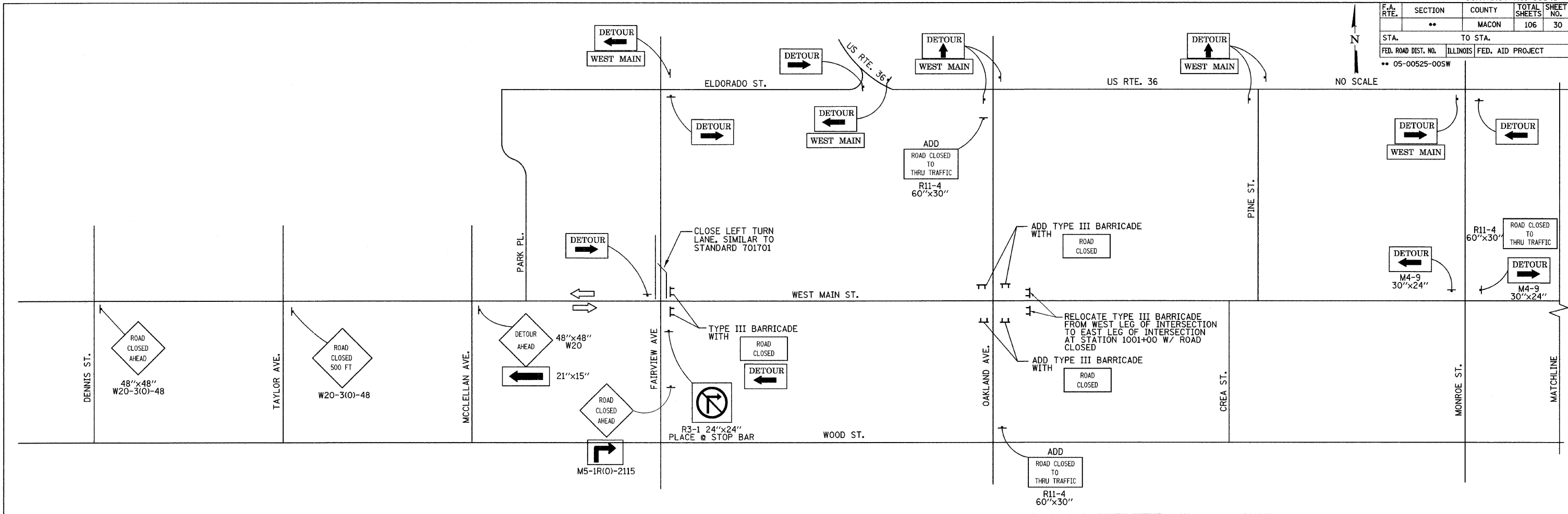

SUGGESTED SEQUENCE OF CONSTRUCTION

1. PLACE ADDITIONAL SIGNS, ADDITIONAL TYPE III BARRICADES, AND RELOCATE TYPE III BARRICADES AS SHOWN ON THIS PLAN

SHEET NOTES

1. OAKLAND AVENUE ROAD CLOSURE MUST BE SCHEDULED TO BEGIN ON A MONDAY AT OR AFTER 7:00AM AND BE OPENED THE FOLLOWING FRIDAY ON OR BEFORE 5:00PM.
2. PLACING ADDITIONAL SIGNS RELOCATING EXISTING SIGNS, AND REMOVAL OF ADDITIONAL SIGNS WILL NOT BE MEASURED FOR PAYMENT, BUT SHALL BE INCLUDED IN THE CONTRACT UNIT PRICE FOR "TRAFFIC CONTROL AND PROTECTION DETOUR 1".

LEGEND

DETOUR (arrow pointing left)	M4-9 30"x24"
DETOUR (arrow pointing right)	M4-8 24"x12"
ROAD CLOSED	R11-2 48"x30"