

F.A. RTE.	SECTION	COUNTY	TOTAL SHEETS	SHEET NO.
	05-00525-00 SW	MACON	106	46
STA. _____		TO STA. _____		
FED. ROAD DIST. NO. _____ ILLINOIS FED. AID PROJECT				

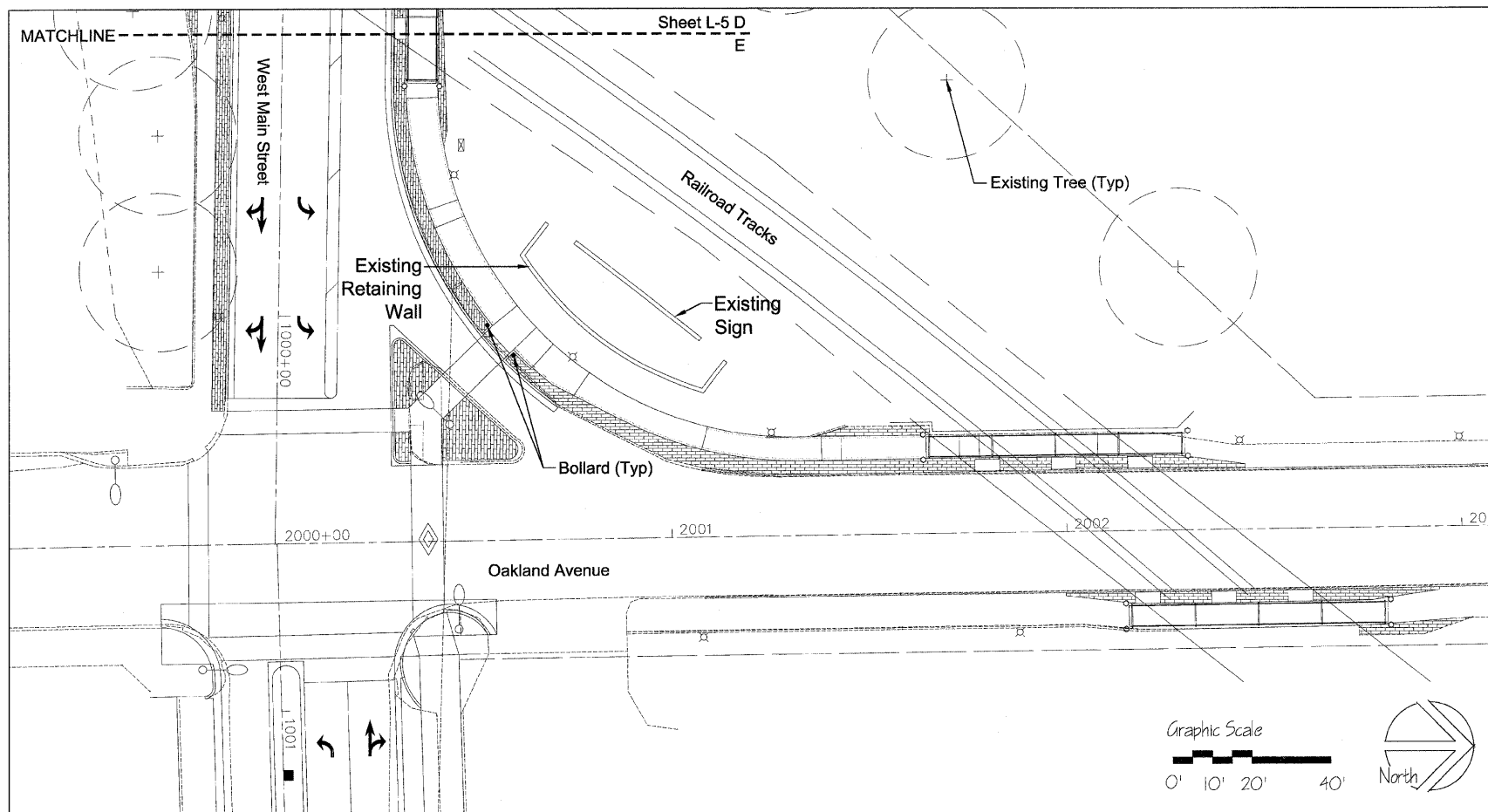

- Notes:
1. Each Decorative Steel Railing section to be divided into equally spaced segments approximately 5' in length.
 2. Decorative Steel Railing must stay parallel to sidewalk / trail.
 3. Top rail to be 38" above pavement.
 4. Pavers run with sidewalk edge and are cut near the street curb, retaining wall, etc.

REV. NO.	DESCRIPTION	BY	DATE	APPROVED			
HARDSCAPE PLAN - OAKLAND AVENUE							
DESIGN KLM	WEST MAIN STREET PH 2 IMPROVEMENTS CITY OF DECATUR	SCALE 1"=20'					
DATE 12/07		PROJECT NO.					
DRAWN MRG		DATE					
DATE 12/07		1/11/08					
CHECKED KLM	APPROVED DATE CLIENT APPR. DATE						
DATE 12/07							
Massie Massie & Associates LAND PLANNING AND LANDSCAPE ARCHITECTURE 421 West Main Street, Decatur, IL 62522 217/424-0792 www.Massie-Massie-Associates.com							
L-6							