

F.A. RTE.	SECTION	COUNTY	TOTAL SHEETS	SHEET NO.
..	..	MACON	106	53
STA. TO STA.		FED. ROAD DIST. NO. ILLINOIS FED. AID PROJECT		
..		05-00525-00SW		
8'-0" CLEAR				

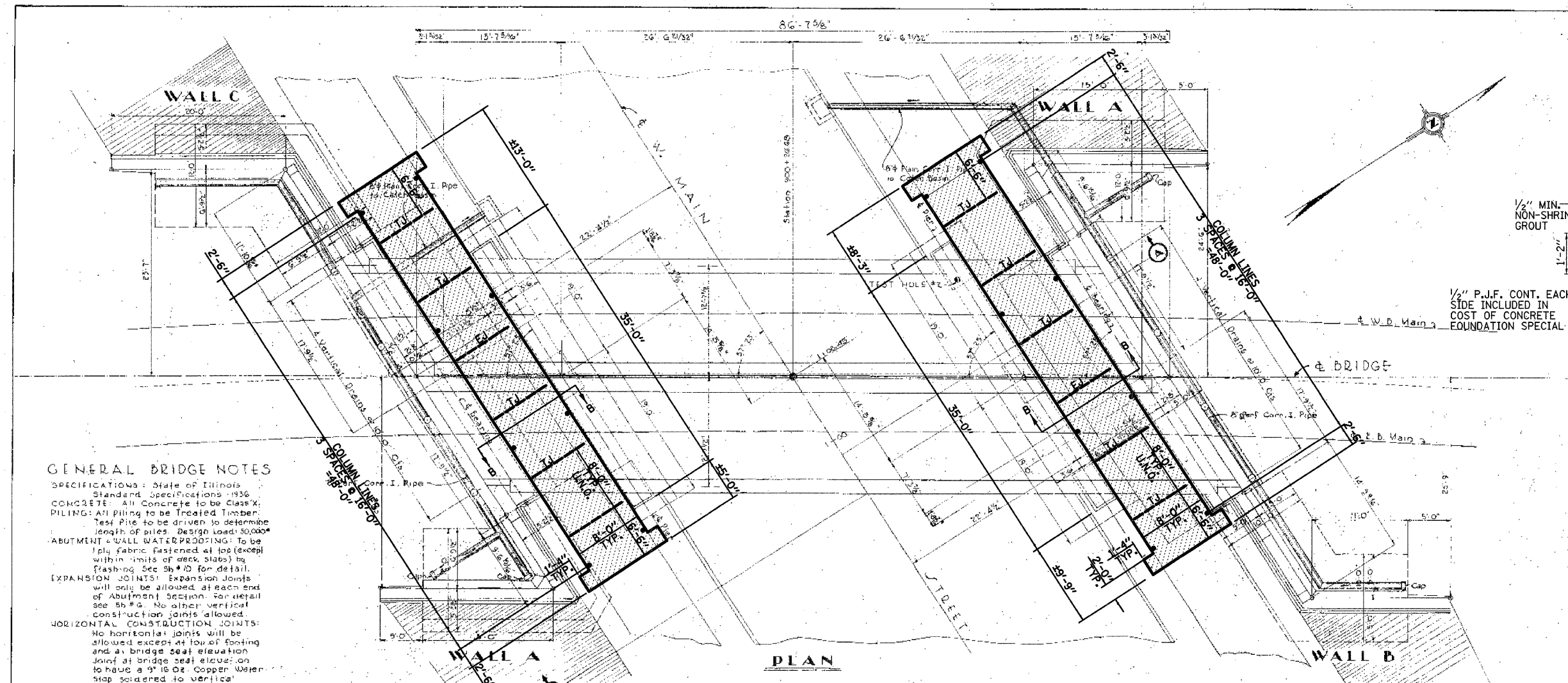

GENERAL BRIDGE NOTES

SPECIFICATIONS: State of Illinois Standard Specifications 1936
 CONCRETE: All concrete to be Class 'X'.
 PILING: All piling to be treated timber.
 Test Pile to be driven to determine length of piles. Design load: 30,000 lbs.
 ABUTMENT & WALL WATERPROOFING: To be 1 ply fabric fastened at top (except within limits of deck slabs) by flashing. See 5b*10 for detail.
 EXPANSION JOINTS: Expansion joints will only be allowed at each end of Abutment section. For detail see 5b*9. No other vertical construction joints allowed.
 HORIZONTAL CONSTRUCTION JOINTS: No horizontal joints will be allowed except at top of footing and at bridge seat elevation to have a 9" 16 Oz Copper Water stop soldered to vertical copper in exp. joints.

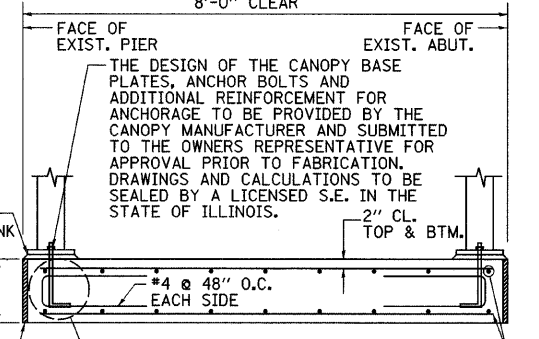
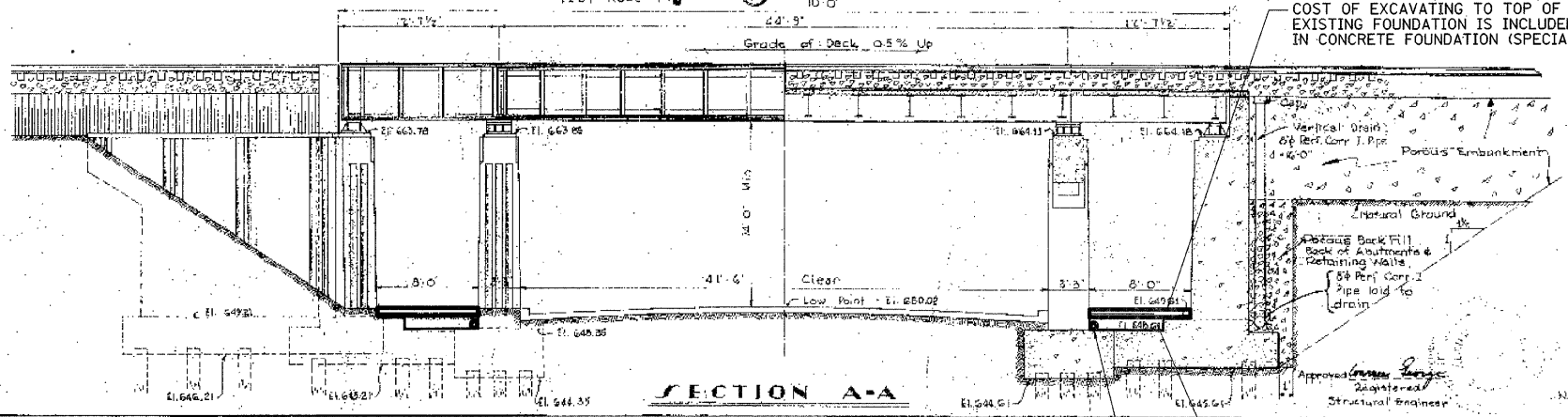

THE DESIGN OF THE CANOPY BASE PLATES, ANCHOR BOLTS AND ADDITIONAL REINFORCEMENT FOR ANCHORAGE TO BE PROVIDED BY THE CANOPY MANUFACTURER AND SUBMITTED TO THE OWNERS REPRESENTATIVE FOR APPROVAL PRIOR TO FABRICATION. DRAWINGS AND CALCULATIONS TO BE SEALED BY A LICENSED S.E. IN THE STATE OF ILLINOIS.

THE COST OF ANCHOR BOLTS AND ADDITIONAL REINFORCEMENT OR CONCRETE FOR CANOPY ANCHORAGE IS INCLUDED IN THE COST OF CANOPIES SPECIAL.

#5 @ 12" O.C. E.W. COST OF REINF. INCLUDED IN CONCRETE FOUNDATION SPECIAL.

SECTION B-B

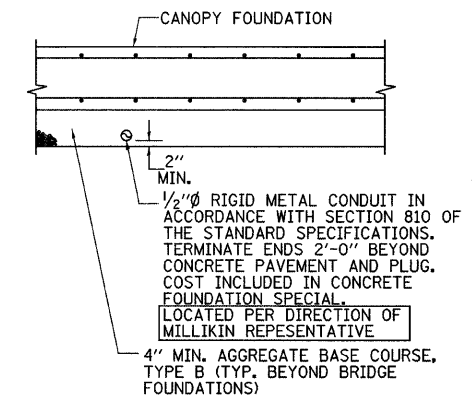

- NOTES:**
- MIN. LAP LENGTH FOR #5 BARS = 2'-2".
 - CONCRETE WORK SHALL BE IN ACCORDANCE WITH SECTION 503 OF THE STANDARD SPECIFICATIONS.
 - THE FINISH ON THE TOP OF THE FOUNDATION SHALL BE IN ACCORDANCE WITH SECTION 424.06 OF THE STANDARD SPECIFICATIONS.
 - JOINTS INDICATED BY "TJ" OR "EJ" TOOLED OR EXPANSION ON PLANS SHALL BE PLACED IN ACCORDANCE WITH SECTION 424.06 OF THE STANDARD SPECIFICATIONS. TOOLED JOINTS SHALL HAVE A GROOVE DEPTH OF 1".

WABASH RAILWAY COMPANY
 OFFICE OF CHIEF ENGINEER
 W. MAIN ST. - OAKLAND AVE. GRADE SEPI'S
 DECATUR, ILLINOIS
W. MAIN ST. BRIDGE
 GENERAL BRIDGE PLAN

DATE: Dec. 1 1935
 SCALE: 3/8" = 1'-0"
 DESIGNED BY: DEB
 DESIGN CHD: [Signature]

DRAWN BY: D.E.B.
 CHECKED BY: HCK

SHEET 3 OF 23

CONCRETE FOUNDATIONS (SPECIAL)
 37.6 CU YD

SUB-BASE GRANULAR MATERIAL, TYPE B
 62.6 TON

WEST MAIN ST.

GENERAL BRIDGE PLAN WAS PROVIDED BY NORFOLK SOUTHERN CORPORATION AND SCANNED INTO DRAWING.

REV. NO.	DESCRIPTION	BY	DATE	APPROVED
CANOPY FOUNDATIONS				
DESIGN BWC	WEST MAIN STREET PHASE II CITY OF DECATUR			SCALE
DATE				N.T.S.
DRAWN RJC				BWC PROJECT NO.
CHECKED				009-0605
DATE				DATE
APPROVED			1/08	
CLIENT APPR.			SHEET	
DATE			1 OF 2	

BWC BLANK, WESSELINK, COOK & ASSOCIATES, INC.
 ARCHITECTS ENGINEERS
 2623 EAST PERSHING ROAD DECATUR, IL 62524
 (217) 428-0973 FAX (217) 428-6934