

ROUTE NO.	SECTION	COUNTY	TOTAL SHEETS	SHEET NO.
C.H. 9 (WRINGE RD)	98-00070-00-BR	CLINTON	6 + 67	1

FEDERAL AID PROJECT BROS-027(36) 12
CONTRACT NO. 97330

HIGHWAY BRIDGE REPLACEMENT & REHABILITATION PROGRAM DETAIL PLANS FOR

PROPOSED BRIDGE

C.H. 9 (WRINGE ROAD) OVER TRIB. TO BEAVER CREEK
SECTION 98-00070-00-BR
CLINTON COUNTY
PROJECT: BROS-027(36)
JOB NO: C-98-316-08

INDEX OF SHEETS

- COVER SHEET
- SUMMARY OF QUANTITIES AND TYPICAL CROSS SECTIONS
- PLAN AND PROFILE OF EXISTING AND PROPOSED ROADWAY
- CROSS SECTIONS EXISTING AND PROPOSED ROADWAY
- GENERAL PLAN AND ELEVATION

HIGHWAY STANDARDS: 280001-04
630301-04
701901
BLR 21-7
BLR 27

BRIDGE STANDARDS: CS-2821-45
CB-2821-48
CA-2821-10
CR-TS1
CN
CX-1

DESIGN CLASSIFICATION

COLLECTOR
CURRENT A.D.T. = 225
DESIGN SPEED = 40 M.P.H.
DESIGN A.D.T. = 325 (2026)

UTILITIES:

CALL J.U.L.I.E. BEFORE YOU DIG
800-892-0123

ELECTRIC:

CLINTON COUNTY ELECTRIC COOPERATIVE
475 N. MAIN
BREESE, ILLINOIS
(618) 526-7282

WATER:

CARLYLE NORTH WATER CO., INC.
17217 DIERKES ROAD
CARLYLE, IL 62231
(618) 594-2508

TELEPHONE:

SBC AMERITECH ILLINOIS
203 GOETHE STREET
COLLINSVILLE, IL 62234
(618) 346-6400

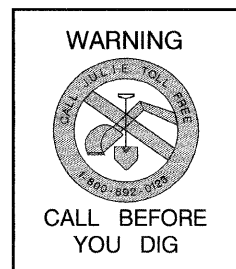

THESE PLANS WERE PREPARED
BY ME OR BY A FULL TIME MEMBER
OF MY STAFF WORKING UNDER MY
PERSONAL SUPERVISION.



Daniel L. Behrens DATE 1-25-08
COUNTY ENGINEER
ILLINOIS P.E. # 62-050860 EXPIRES 11/30/09

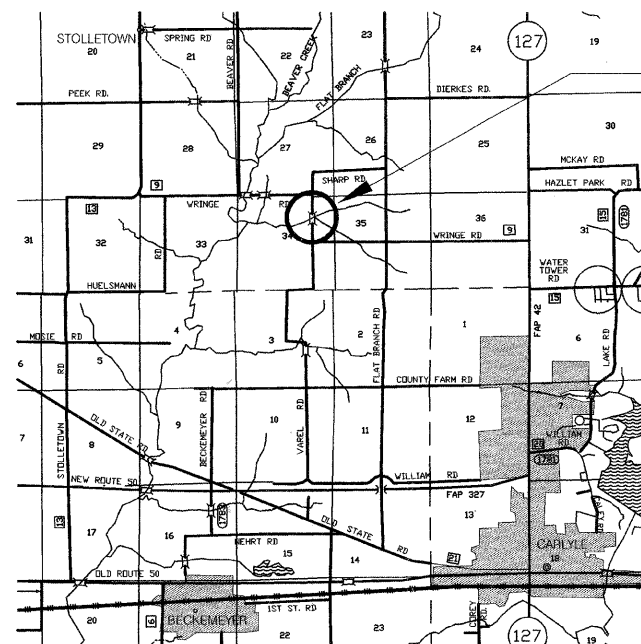

LOCATION MAP

NET LENGTH OF PROJECT = 171.5 FEET OR 0.0324 MILES

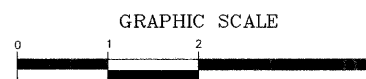

1 INCH = 1 MILE

PROJECT LOCATION

PROPOSED STRUCTURE NO. 014-5113 @ STATION 132+75
SINGLE SPAN PRECAST, PRESTRESSED CONCRETE
DECK BEAMS, (21" DEPTH) ON SPILL THRU PILE BENT
ABUTMENTS, MEASURING 46'-6" BK./BK. OF THE
ABUTMENTS WITH A 28'-0" CLEAR ROADWAY WIDTH.

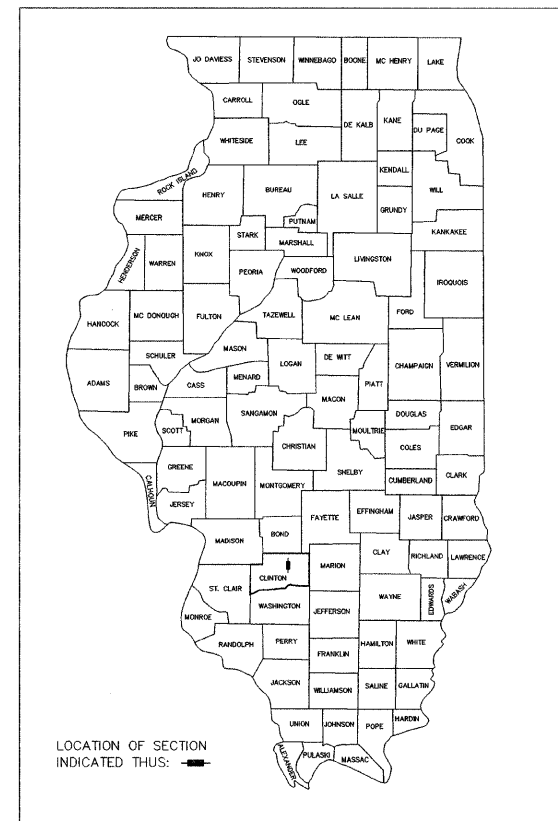

LOCATION OF SECTION
INDICATED THUS: [Symbol]

ILLINOIS DEPARTMENT OF TRANSPORTATION

APPROVED: *1-25* 2008
Daniel L. Behrens
CLINTON COUNTY, COUNTY ENGINEER

PASSED: *January 28* 2008
Richard C. Marchese
DISTRICT 8 ENGINEER OF LOCAL ROADS & STREETS

Releasing for Bid
Based on Limited
Review: *January 28* 2008
Maury C. Farnie, Jr.
DEPUTY DIRECTOR OF HIGHWAYS
REGION FIVE ENGINEER