

F.A.U. RTE.	SECTION	COUNTY	TOTAL SHEETS	SHEET NO.
9103	05-00046-01-PV	MADISON	25	12
FED. ROAD DIST. NO.	ILLINOIS	FED. AID PROJECT		

CONTRACT NO. 97339

FINAL SURVEY PLOTTED	BY	DATE
NOTE BOOK TEMPLATE		
AREAS CHECKED		
NO.		

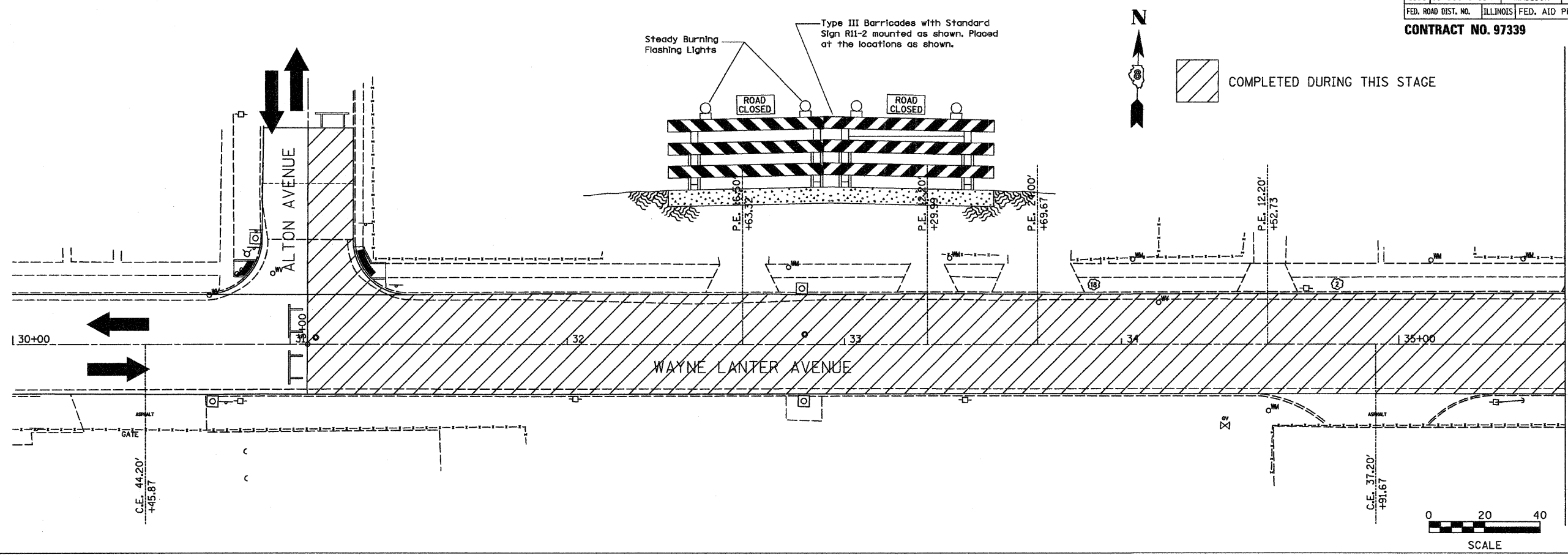

ORIGINAL SURVEY PLOTTED	BY	DATE
NOTE BOOK TEMPLATE		
AREAS CHECKED		
NO.		

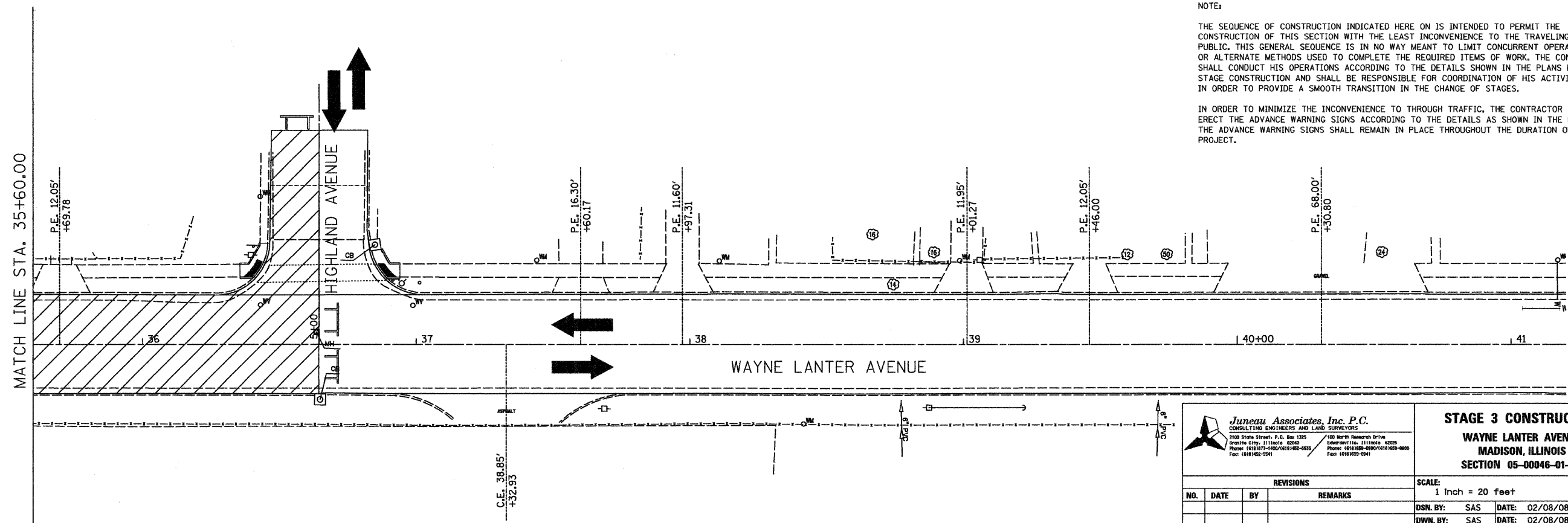

NOTE:

THE SEQUENCE OF CONSTRUCTION INDICATED HERE ON IS INTENDED TO PERMIT THE CONSTRUCTION OF THIS SECTION WITH THE LEAST INCONVENIENCE TO THE TRAVELING PUBLIC. THIS GENERAL SEQUENCE IS IN NO WAY MEANT TO LIMIT CONCURRENT OPERATIONS OR ALTERNATE METHODS USED TO COMPLETE THE REQUIRED ITEMS OF WORK. THE CONTRACTOR SHALL CONDUCT HIS OPERATIONS ACCORDING TO THE DETAILS SHOWN IN THE PLANS FOR STAGE CONSTRUCTION AND SHALL BE RESPONSIBLE FOR COORDINATION OF HIS ACTIVITIES IN ORDER TO PROVIDE A SMOOTH TRANSITION IN THE CHANGE OF STAGES.

IN ORDER TO MINIMIZE THE INCONVENIENCE TO THROUGH TRAFFIC, THE CONTRACTOR SHALL ERECT THE ADVANCE WARNING SIGNS ACCORDING TO THE DETAILS AS SHOWN IN THE PLANS. THE ADVANCE WARNING SIGNS SHALL REMAIN IN PLACE THROUGHOUT THE DURATION OF THE PROJECT.

Juneau Associates, Inc. P.C.
 CONSULTING ENGINEERS AND LAND SURVEYORS
 2100 State Street, P.O. Box 1325
 Granite City, Illinois 62040
 Phone: (618) 977-1400 / (618) 952-5535
 Fax: (618) 952-2541

100 North Research Drive
 Edwardsville, Illinois 62025
 Phone: (618) 398-0900 / (618) 395-0800
 Fax: (618) 395-0941

STAGE 3 CONSTRUCTION
WAYNE LANTER AVENUE
MADISON, ILLINOIS
SECTION 05-00046-01-PV

REVISIONS			
NO.	DATE	BY	REMARKS

SCALE: 1 inch = 20 feet		SHEET 12
DSN. BY: SAS	DATE: 02/08/08	
DWN. BY: SAS	DATE: 02/08/08	JOB NO. E071005
CHKD: BFK	DATE: 02/08/08	
DWG. NO.		DGN. NAME: STG 4 OF 25 SHTS