

| TR                             | SECTION        | COUNTY | TOTAL SHEETS     | SHEET NO. |
|--------------------------------|----------------|--------|------------------|-----------|
| 71                             | 07-01114-00-BR | WHITE  | 13               | 1         |
| FED. ROAD DIST. NO. 9 ILLINOIS |                |        |                  |           |
| PROJECT # BROS-193(34)         |                |        | FED. AID PROJECT |           |
| JOB # C-99-542-07              |                |        | LIMEKILN CREEK   |           |

323 W. 3RD ST.  
P.O. BOX 160  
MT. CARMEL, IL  
62863  
PHONE: (618)-262-8651  
FAX: (618)-263-3327  
LEC JOB # H07L011WH

### INDEX OF SHEETS

| SHEET NO. | DESCRIPTION                                      |
|-----------|--|
| 1         | TITLE SHEET & SUMMARY OF QUANTITIES              |
| 2         | PLAN & PROFILE, TYPICAL SECTIONS & GENERAL NOTES |
| 3-4       | ROADWAY CROSS SECTIONS                           |
| 5-12      | BRIDGE DESIGN                                    |
| 13        | CURLED END SECTIONS & STONE RIPRAP DITCH DESIGN  |

**THE FOLLOWING STANDARDS ARE A PART OF THESE PLANS AND ARE INCLUDED IN THE PROPOSAL:**

|             |  |
|-------------|--|
| 000001-05   | STANDARD SYMBOLS, ABBREVIATIONS & PATTERNS   |
| 280001-04   | TEMPORARY EROSION CONTROL SYSTEMS  |
| 701901      | TRAFFIC CONTROL DEVICES  |
| B.L.R. 21-7 | TYPICAL APPLICATION OF TRAFFIC CONTROL DEVICES FOR CONSTRUCTION ON RURAL LOCAL HIGHWAYS  |
| B.L.R. 22-5 | TYPICAL APPLICATION OF TRAFFIC CONTROL DEVICES FOR CONSTRUCTION ON RURAL LOCAL HIGHWAYS (TWO-LANE TWO-WAY RURAL TRAFFIC) (ROAD CLOSED TO THRU TRAFFIC) |

### SUMMARY OF QUANTITIES

| CODE NO. | ITEM  | UNIT  | QUANTITY |
|----------|---|-------|----------|
| 20100500 | TREE REMOVAL, ACRES                                 | ACRE  | 0.10     |
| 20200100 | EARTH EXCAVATION                                    | CU YD | 410.00   |
| 20300100 | CHANNEL EXCAVATION                                  | CU YD | 301.00   |
| 20400800 | FURNISHED EXCAVATION                                | CU YD | 1261.00  |
| 25001000 | SEEDING, CLASS 2 (SPECIAL)                          | ACRE  | 0.50     |
| 28000300 | TEMPORARY DITCH CHECKS                              | EACH  | 3.00     |
| 28001000 | AGGREGATE (EROSION CONTROL)                         | TON   | 15.00    |
| 28100807 | STONE DUMPED RIPRAP, CLASS A4                       | TON   | 640.00   |
| 28102600 | STONE RIPRAP DITCH                                  | TON   | 105.00   |
| 40200800 | AGGREGATE SURFACE COURSE, TYPE B                    | TON   | 360.00   |
| 50100100 | REMOVAL OF EXISTING STRUCTURES                      | EACH  | 1.00     |
| 50300225 | CONCRETE STRUCTURES                                 | CU YD | 21.40    |
| 50300280 | CONCRETE ENCASMENT                                  | CU YD | 2.10     |
| 50400505 | PRECAST PRESTRESSED CONCRETE DECK BEAMS (27" DEPTH) | SQ FT | 1440.00  |
| 50800105 | REINFORCEMENT BARS                                  | POUND | 2620.00  |
| 50900205 | STEEL RAILING, TYPE S1                              | FOOT  | 120.00   |
| 51201400 | FURNISHING STEEL PILES HP10X42                      | FOOT  | 384.00   |
| 51202305 | DRIVING PILES                                       | FOOT  | 384.00   |
| 51500100 | NAME PLATES   | EACH  | 1.00     |
| 54200220 | PIPE CULVERTS, CLASS D, TYPE 1 15"                  | FOOT  | 40.00    |
| 67100100 | MOBILIZATION  | L SUM | 1.00     |

DESIGN DESIGNATION:  
DESIGN SPEED: 30 MPH  
HIGHWAY CLASS - LOCAL ROAD  
EXISTING STRUCTURE NO.: 097-3053  
PROPOSED STRUCTURE NO.: 097-3263  
CURRENT A.D.T. = 50  
CONTRACT NO. 99321

**J.U.L.I.E.**  
**JOINT UTILITY LOCATION INFORMATION FOR EXCAVATION**  
**1-800-892-0123**

## STATE OF ILLINOIS

### DEPARTMENT OF TRANSPORTATION

# PLANS FOR PROPOSED FEDERAL AID - H.B.P. PROJECT

T.R. 71 WHITE COUNTY SECTION 07-01114-00-BR

PROJECT NO. BROS-193(34) JOB NO. C-99-542-07

CONTRACT # 99321 LIMEKILN CREEK

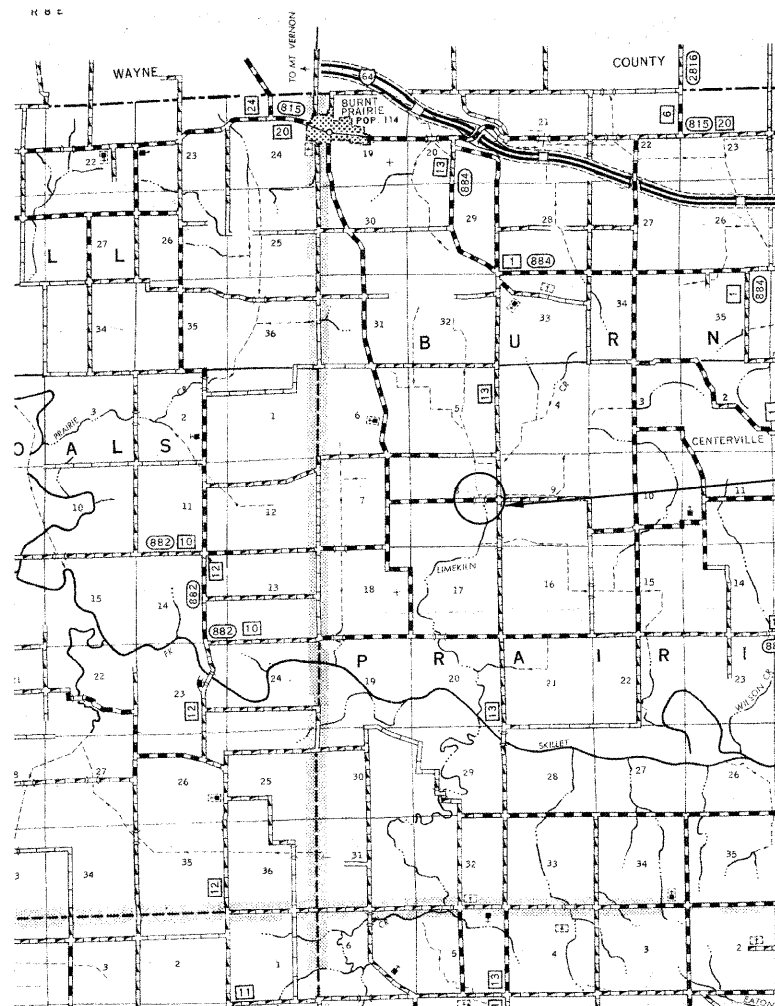

|              | FEET      | MILES       |
|--------------|-----------|-------------|
| GROSS LENGTH | 600.00 FT | 0.114 MILES |
| OMISSIONS    | 0.00 FT   | 0.000 MILES |
| NET LENGTH   | 600.00 FT | 0.114 MILES |

|               |          |            |
|---------------|----------|------------|
| PLAN          | 1" = 50' | 0 50' 100' |
| PROFILE       | 1" = 50' | 0 50' 100' |
| PROFILE VERT. | 1" = 5'  | 0 5' 10'   |
| CROSS SECTION | 1" = 5'  | 0 5' 10'   |

SECTION 07-01114-00-BR  
BEGINS STATION 2+00

STATION 5+00, STRUCTURE NO. 097-3263  
A 60' LONG SINGLE SPAN PRECAST  
PRESTRESSED CONCRETE DECK BEAM  
BRIDGE (27" DEPTH), 24' ROADWAY, 0.00%  
GRADE, 25° RT FWD SKEW.

SECTION 07-01114-00-BR  
ENDS STATION 8+00

STATE OF ILLINOIS  
DEPARTMENT OF TRANSPORTATION

APPROVED 1/11/08  
*Brian A. Kay*  
COUNTY ENGINEER

PASSED Jan. 22, 2008  
*Dennis W. Hillman*  
ENGINEER OF LOCAL ROADS AND STREETS

RELEASING FOR BID  
BASED ON LIMITED  
REVIEW: Jan 22, 2008  
*Mary C. Lamie*  
MARY C. LAMIE, P.E.  
DEPUTY DIRECTOR OF HIGHWAY  
REGION FIVE ENGINEER

405 W. STATE ST.  
SUITE 1  
PRINCETON, IN  
47670  
PHONE: (812)-386-7611  
FAX: (812)-385-2812

**LAMAC**  
ENGINEERING CO.

PROFESSIONAL DESIGN FIRM  
LAND SURVEY & PROFESSIONAL ENGINEERING CORPORATION  
184-00887  
(62-032435)(35-002769)

AARON M. MEFFORD  
REGISTERED PROFESSIONAL ENGINEER  
OF ILLINOIS  
56284

AARON M. MEFFORD  
NAME  
*Aaron M. Mefford*  
SIGNATURE  
1-11-08  
DATE

11-30-09  
EXPIRES

TOWNSHIP ROUTE 71  
OVER LIMEKILN CREEK  
WHITE COUNTY, ILLINOIS

SHEET TITLE:  
TITLE SHEET

SCALE: VPIES  
BY: AMM  
DATE: 12/17/07  
REV:

1 OF 13  
SHEETS

SHEET NO.  
1