

10+00

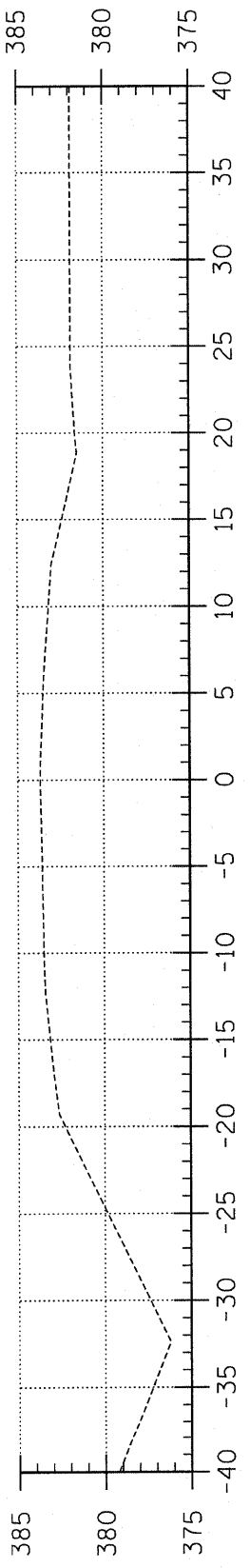

9+00

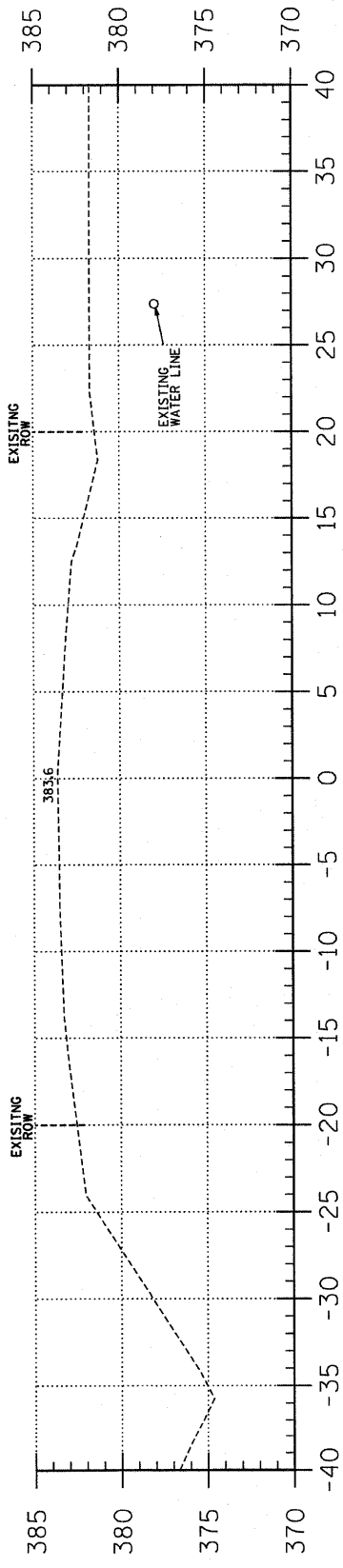

8+00

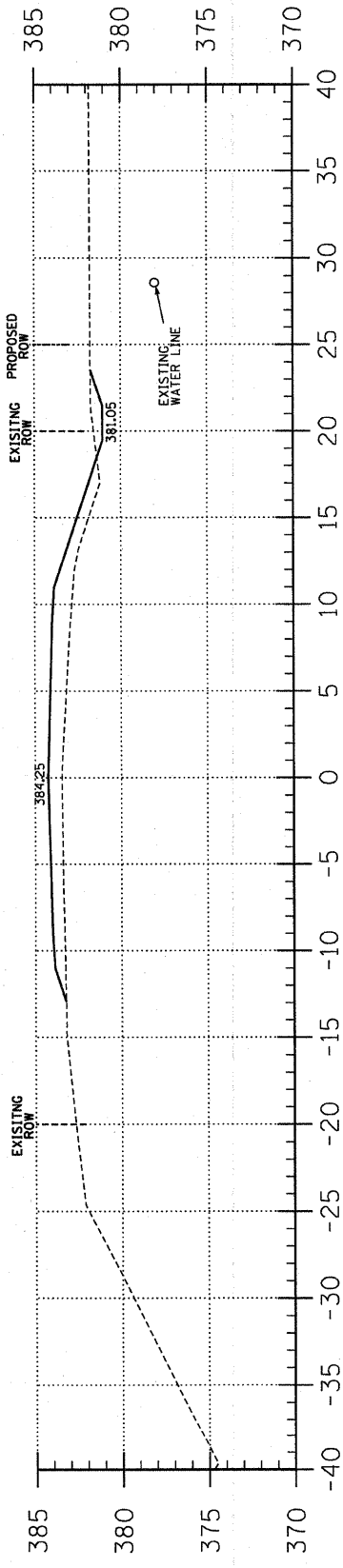

7+00

C = 2.1  
F = 24.0

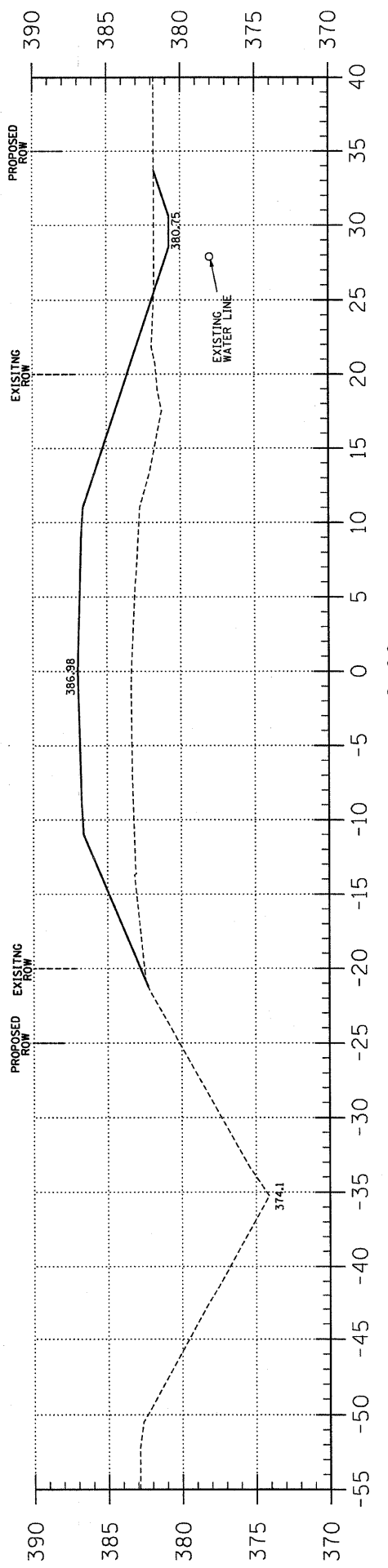

6+00

C = 5.2  
F = 130.1

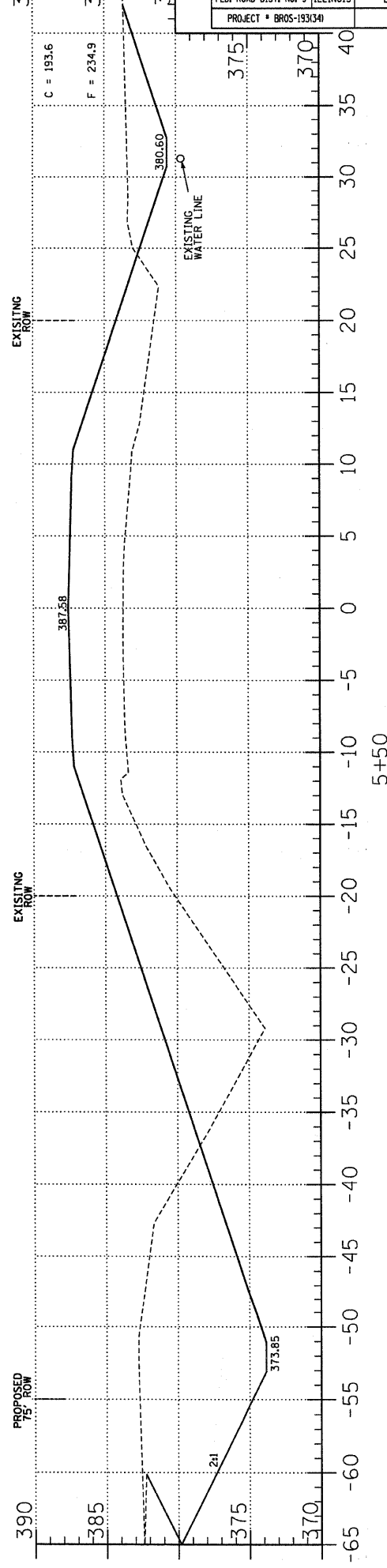

5+50

TR	SECTION	COUNTY	TOTAL SHEETS	SHEET NO.
71	07-01114-00-BR	WHITE	13	4

323 W. 3RD ST.  
P.O. BOX 160  
MT. CARMEL, IL  
62863  
PHONE: (618)-262-8651  
FAX: (618)-263-3327

405 W. STATE ST.  
SUITE 1  
PRINCETON, IN  
47670  
PHONE: (812)-386-7611  
FAX: (812)-386-2812



PROFESSIONAL DESIGN FIRM  
LAND SURVEY & PROFESSIONAL ENGINEERING CORPORATION  
184-00087  
(62-032435)(35-002769)



AARON M. MEFFORD  
NAME  
SIGNATURE  
1-14-08  
DATE  
11-30-09  
EXPIRES

TOWNSHIP ROUTE 71  
OVER LIMEKILN CREEK  
WHITE COUNTY, ILLINOIS

SHEET TITLE:

CROSS-SECTIONS

SCALE: 1" = 5'  
BY: AMM  
DATE: 12/07  
REV:

4 OF 13 SHEETS

SHEET NO. 4