

MAR 12 2008 9:08 AM HAGL000382
 \\AIRPORTS\VA\NDALIA\0740088\CAD\SHETS\R-131DRN.DWG - DRAINAGE

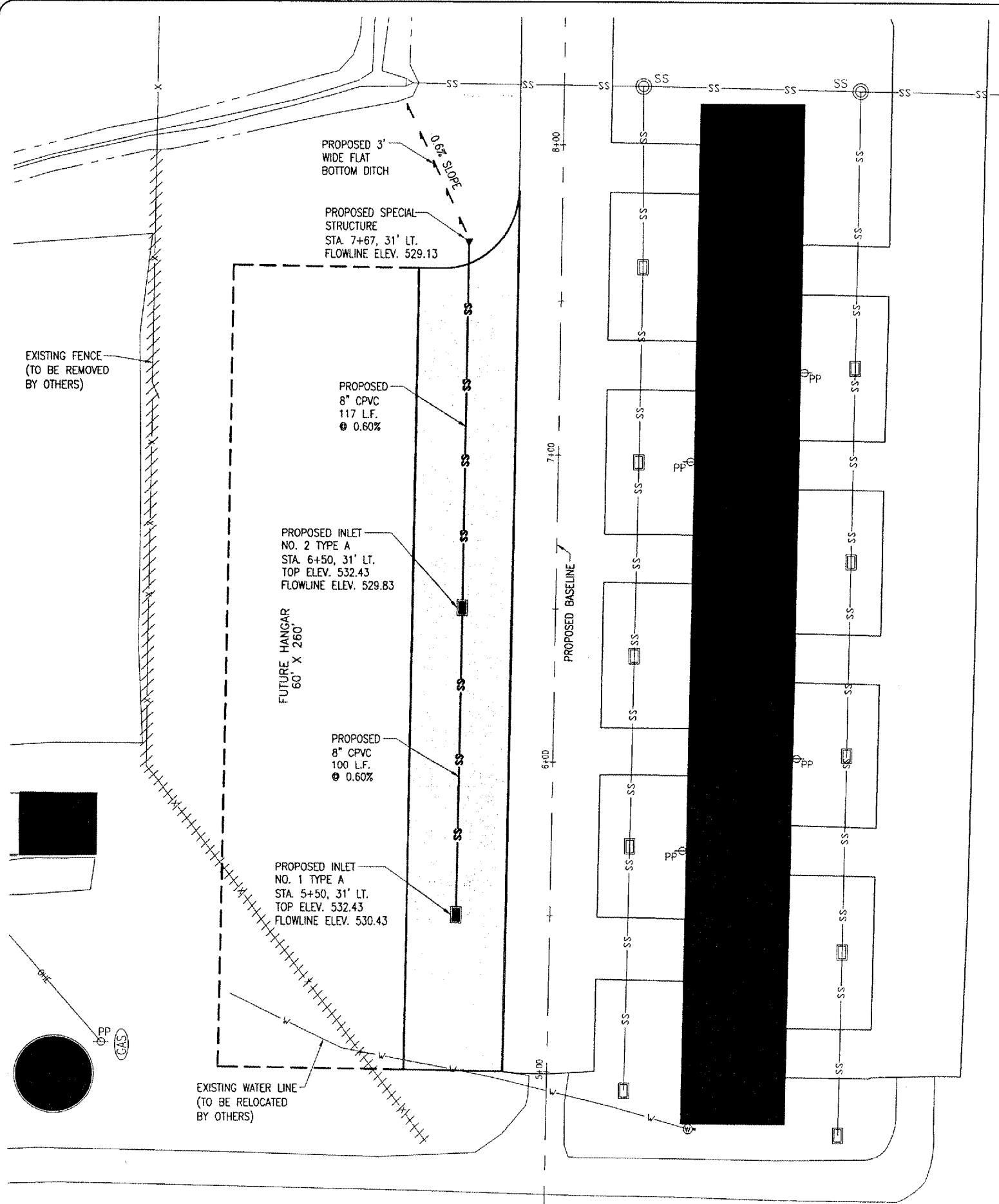

THE LOCATION, SIZE AND TYPE OF MATERIAL OF EXISTING UNDERGROUND UTILITIES INDICATED ON THE PLANS IS NOT REPRESENTED AS BEING ACCURATE, SUFFICIENT OR COMPLETE. IT SHALL BE THE CONTRACTOR'S RESPONSIBILITY TO DETERMINE THE ACTUAL LOCATION OF ALL SUCH FACILITIES, INCLUDING SERVICE CONNECTIONS TO UNDERGROUND UTILITIES. PRIOR TO CONSTRUCTION, THE CONTRACTOR SHALL NOTIFY THE UTILITY COMPANIES OF HIS OPERATIONAL PLANS AND SHALL OBTAIN FROM THE RESPECTIVE UTILITY COMPANIES DETAILED INFORMATION AND ASSISTANCE RELATIVE TO THE LOCATION OF THEIR FACILITIES AND THE WORKING SCHEDULE OF THE COMPANIES FOR REMOVAL OR ADJUSTMENT WHERE REQUIRED. IN THE EVENT AN UNEXPECTED UTILITY INTERFERENCE IS ENCOUNTERED DURING CONSTRUCTION, THE CONTRACTOR SHALL IMMEDIATELY NOTIFY THE UTILITY COMPANY OF JURISDICTION. THE ENGINEER SHALL ALSO BE IMMEDIATELY NOTIFIED. ANY SUCH MAINS AND SERVICES SHALL BE RESTORED TO SERVICE AT ONCE AND PAID FOR BY THE CONTRACTOR AT NO ADDITIONAL COST TO THE CONTRACT.

CALL J.U.L.I.E. FOR UTILITY INFORMATION AT 1-800-892-0123.

FENCE REMOVAL

THE EXISTING FENCE WILL BE REMOVED BY THE PARK DISTRICT PERSONNEL PRIOR TO THE START OF THE PROJECT.

WATER LINE RELOCATION

THE EXISTING WATER LINE WILL BE RELOCATED BY THE PARK DISTRICT PERSONNEL PRIOR TO THE START OF THE PROJECT.

DRAINAGE NOTES

PROPOSED INLETS 1 AND 2 WILL BE CONSTRUCTED IN ACCORDANCE TO THE DETAIL SHOWN ON SHEET NO. 8. THEY WILL BE CONSTRUCTED USING A NEENAH R-3475-A, DEETER 2425-E OR EQUAL GRATE AT THE LOCATIONS SHOWN ON THIS SHEET.

THE PROPOSED PIPE WILL BE 8" CORRUGATED POLY VINYL CHLORIDE WITH A SMOOTH INTERIOR. THE PROPOSED PIPE WILL BE CONNECTED WITH FITTINGS AS RECOMMENDED BY THE PIPE MANUFACTURER.

THE PART OF THE PIPE THAT IS UNDER PAVEMENT WILL BE BACKFILLED WITH IDOT CA-14 OR IDOT CA-16 UP TO THE PROPOSED SUBGRADE. THE PART OF THE PIPE THAT IS NOT UNDER THE PAVEMENT WILL BE BACKFILLED HALF WAY UP THE PIPE WITH IDOT CA-14 OR IDOT CA-16 AND UNCLASSIFIED EXCAVATION THE REST OF THE WAY.

THE PROPOSED PIPE WILL BE PAID FOR UNDER:
 AR701008 8" PVC STORM SEWER _____ PER L.F.

THE PROPOSED INLETS WILL BE PAID FOR UNDER:
 AR751411 INLET-TYPE A _____ PER EACH

THE PROPOSED SPECIAL STRUCTURE WILL BE PAID FOR UNDER:
 AR752850 SPECIAL STRUCTURE _____ PER EACH

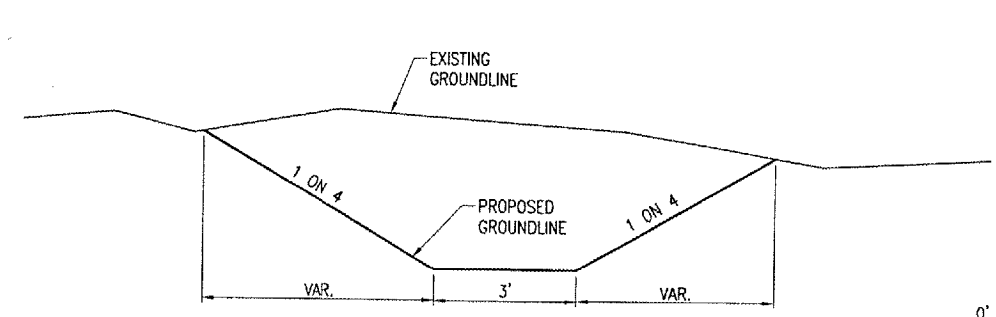

FLAT BOTTOM DITCH DETAIL
 "NOT TO SCALE"

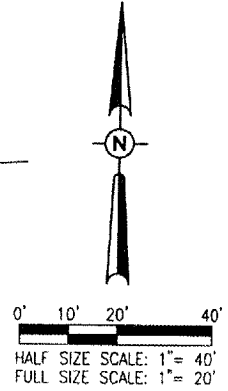

LEGEND

- [] EXISTING PAVEMENT
- [] PROPOSED PAVEMENT
- [] EXISTING BUILDING
- [] FUTURE BUILDING
- SS— EXISTING STORM SEWER
- SS— PROPOSED STORM SEWER
- X— EXISTING FENCE
- ////// EXISTING FENCE (TO BE REMOVED)
- OHE— EXISTING OVERHEAD ELECTRIC LINE
- W— EXISTING WATER LINE (TO BE RELOCATED)
- ==== EXISTING DRAINAGE DITCH
- >— PROPOSED DRAINAGE DITCH
- ⊙ EXISTING WATER SPIGOT
- [] EXISTING INLET
- [] PROPOSED INLET
- ⊙SS EXISTING DROP INLET
- ▷ EXISTING FLARED END SECTION
- ▶ PROPOSED SPECIAL STRUCTURE
- ⊙PP EXISTING POWER POLE
- (GAS) EXISTING PROPANE TANK

VA018

DATE	REVISION	BY

VANDALIA MUNICIPAL AIRPORT
 VANDALIA, ILLINOIS

A.I.P. PROJ.: 3-17-0102-B10
 I.L. PROJ.: VLA-3724

Project No. 0740088D_0800	DATE 12/18/07
Drawn R-131DRN.DWG	DATE 12/18/07
Scale 1" = 20'	DATE 01/11/08
LAYOUT	BAK
DRAWN	BAK
REVIEWED	CAH

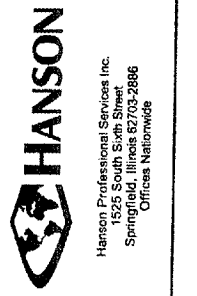

CONSTRUCT HANGAR
 ACCESS TAXIWAY

PROPOSED
 DRAINAGE
 PLAN