

F.A.I. RTE.	SECTION	COUNTY	TOTAL SHEETS	SHEET NO.
180	D-3 OVD SIN STR REPL 14-50	BUREAU	24	1
		ILLINOIS	CONTRACT NO. 46316	

**INDEX OF SHEETS**

1. COVER SHEET
2. GENERAL NOTES
3. SUMMARY OF QUANTITIES
4. TYPICAL SECTIONS
5. SCHEDULES
- 6-9. ROADWAY PLAN DETAILS
- 10-20. OVERHEAD SIGN STRUCTURE - SPAN DESIGN SHEETS
- 21-24. OVERHEAD SIGN STRUCTURE - BRIDGE MOUNTED DESIGN SHEETS

**STANDARDS**

- 000001-00 STANDARD SYMBOLS, ABBREVIATIONS AND PATTERNS
- 001001-02 AREAS OF REINFORCEMENT BARS
- 001006 DECIMAL OF AN INCH AND OF A FOOT
- 643001-02 SAND MODULE IMPACT ATTENUATORS
- 701101-04 OFF-ROAD OPERATIONS MULTILANE, 15' (4.5 m) TO 24' (600 mm) FROM PAVEMENT EDGE
- 701106-02 OFF-ROAD OPERATIONS, MULTILANE, MORE THAN 15' (4.5 m) AWAY
- 701400-07 APPROACH TO LANE CLOSURE, FREEWAY/EXPRESSWAY
- 701406-08 LANE CLOSURE, FREEWAY/EXPRESSWAY, DAY OPERATIONS ONLY
- 701901-03 TRAFFIC CONTROL DEVICES

**STATE OF ILLINOIS**  
**DEPARTMENT OF TRANSPORTATION**  
**DIVISION OF HIGHWAYS**  
**PROPOSED**  
**HIGHWAY PLANS**

**FAI ROUTE 180**  
**SECTION D3 OVD SIN STR REPL 14-50**

**OVERHEAD SIGN TRUSS REMOVAL,**  
**REPLACEMENT, AND BRIDGE**  
**MOUNTED SIGN STRUCTURES.**  
**BUREAU COUNTY**

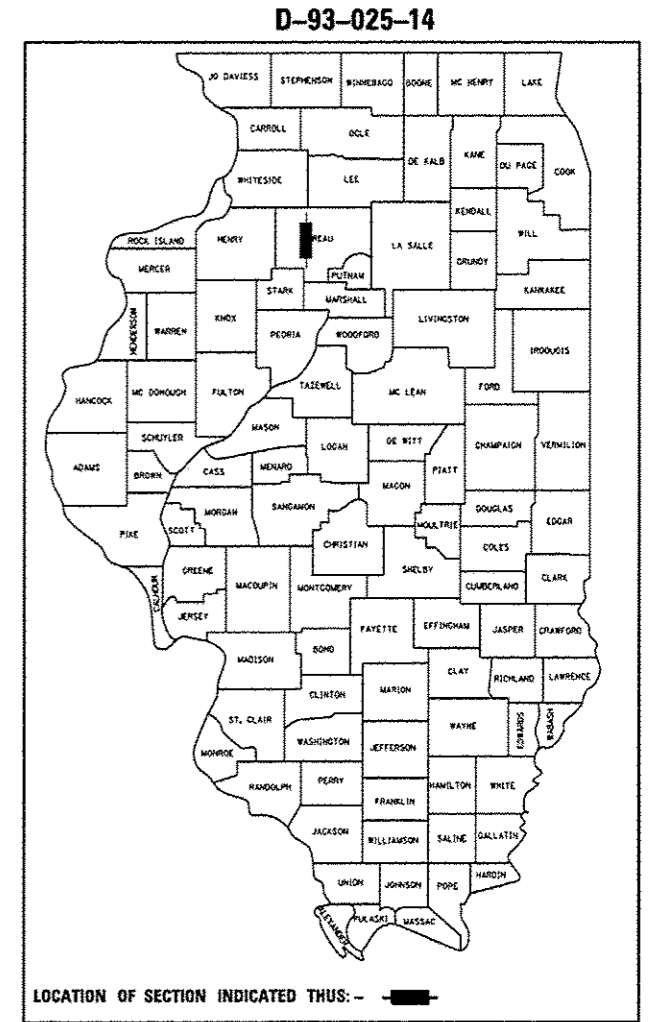

DESIGN DESIGNATION: INTERSTATE  
 ADT 3550 (2012)  
 PV=82.2% SU=3.7% MU=14.1%

STATE OF ILLINOIS  
 DEPARTMENT OF TRANSPORTATION  
 DIVISION OF HIGHWAYS

SUBMITTED 2-7-2014  
*Paul Coetzee*  
 DEPUTY DIRECTOR OF HIGHWAYS, REGION ENGINEER

March 21, 2014  
*John D. Baranzelli*  
 ENGINEER OF DESIGN AND ENVIRONMENT

March 21, 2014  
*Omer Osman*  
 DIRECTOR OF HIGHWAYS, CHIEF ENGINEER

**PRINTED BY THE AUTHORITY**  
**OF THE STATE OF ILLINOIS**

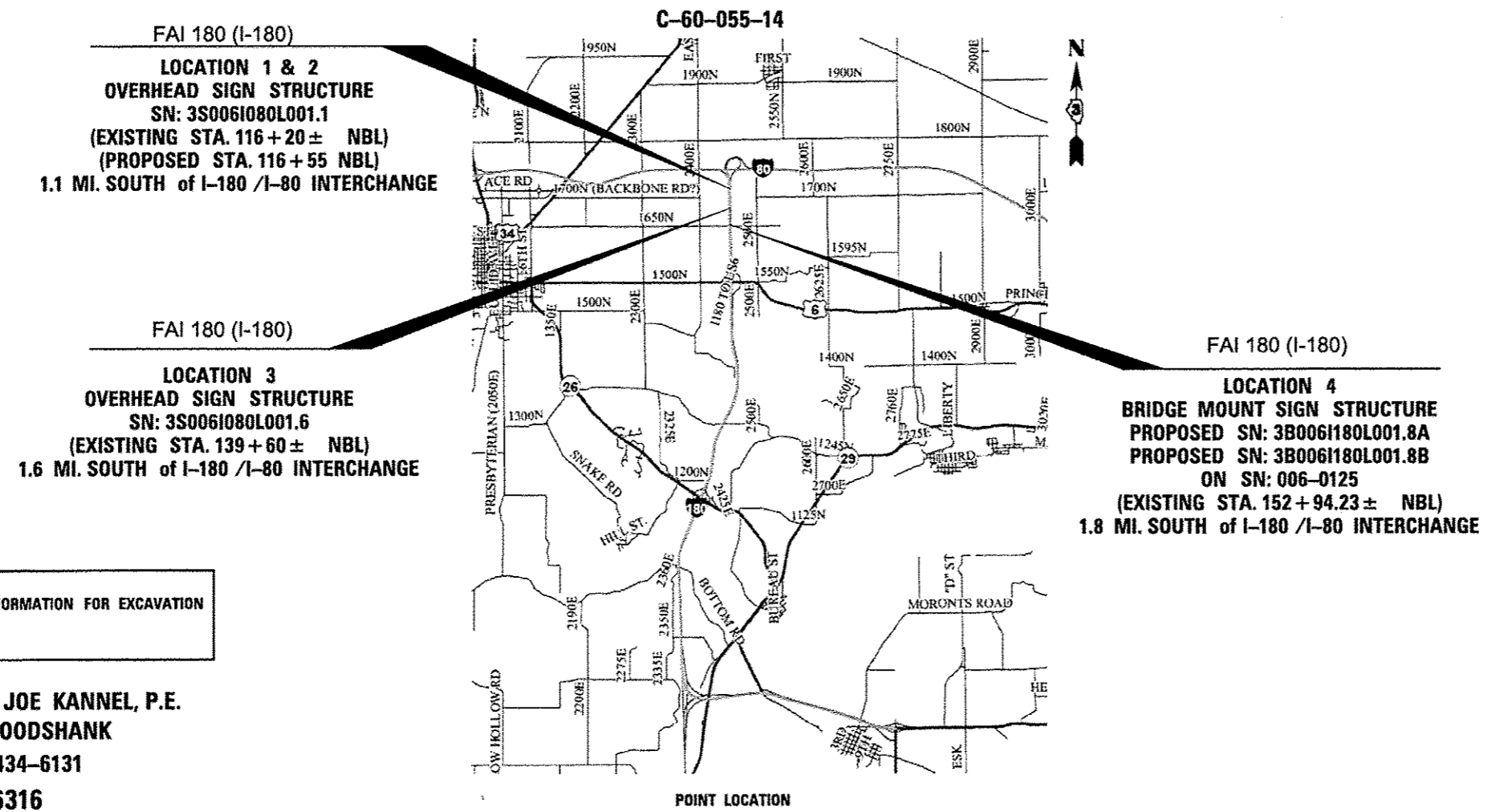

J.U.L.I.E.  
 JOINT UTILITY LOCATION INFORMATION FOR EXCAVATION  
 1-800-892-0123  
 OR 811

**PROJECT ENGINEER: JOE KANNEL, P.E.**  
**UNIT CHIEF: RON WOODSHANK**  
**DISTRICT NO. (815)-434-6131**  
**CONTRACT NO. 46316**

POINT LOCATION