

MATCH LINE STA. 132+50

MATCH LINE STA. 138+00

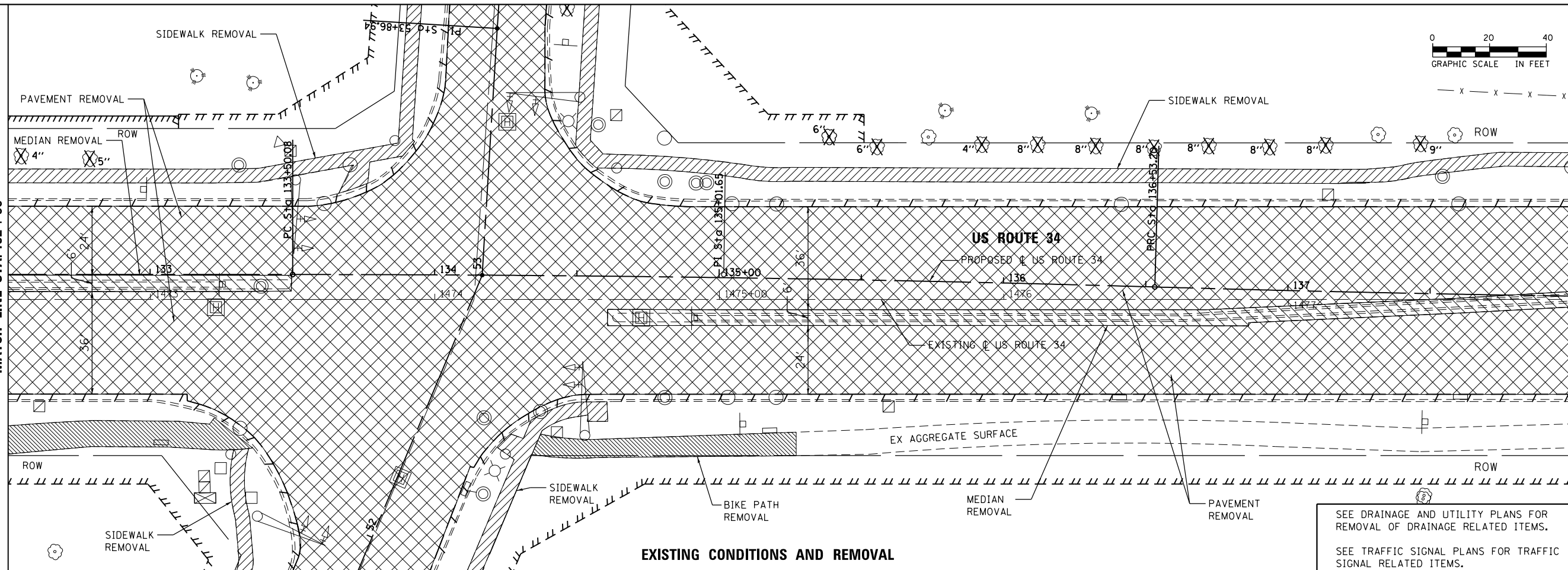

EXISTING CONDITIONS AND REMOVAL

SEE DRAINAGE AND UTILITY PLANS FOR REMOVAL OF DRAINAGE RELATED ITEMS.
SEE TRAFFIC SIGNAL PLANS FOR TRAFFIC SIGNAL RELATED ITEMS.

MATCH LINE STA. 132+50

MATCH LINE STA. 138+00

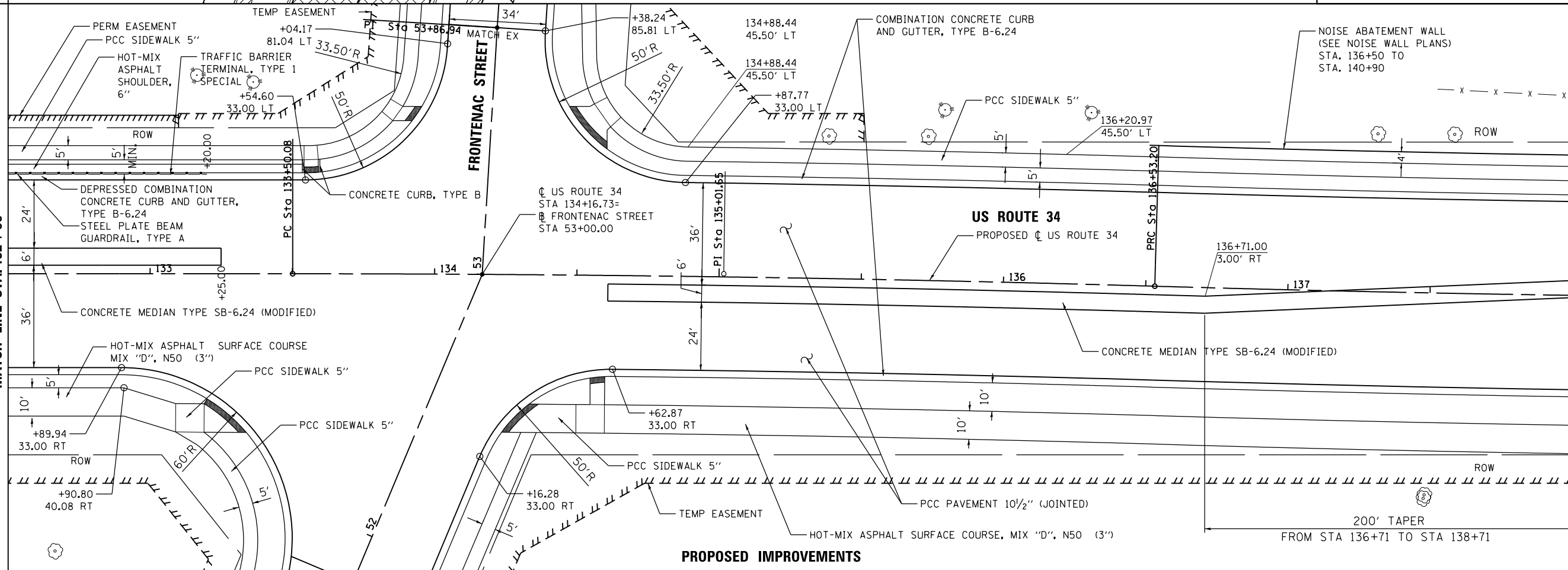

PROPOSED IMPROVEMENTS

200' TAPER
FROM STA 136+71 TO STA 138+71



USER NAME = URS	DESIGNED - MB	REVISED -
DRAWN - KJB	REVISOR -	REVISOR -
CHECKED - SPF	REVISOR -	REVISOR -
DATE - 02/28/2014	DATE - 02/28/2014	DATE -

STATE OF ILLINOIS
DEPARTMENT OF TRANSPORTATION

ROADWAY PLAN
US ROUTE 34

SCALE: 20 SHEET NO. 7 OF 8 SHEETS STA. 132+50 TO STA. 138+00

F.A.P. RTE.	SECTION	COUNTY	TOTAL SHEETS	SHEET NO.
311	652-A	DUPAGE	383	52
CONTRACT NO. 60R06				
FED. ROAD DIST. NO. 1 ILLINOIS FED. AID PROJECT				

FILE NAME = Q:\1001_25368367_US_34.ctb; DN Path: Drawings\Roadway\Plan&Profile\16\60R06-sht-Plan_007.dgn