

MATCH LINE STA. 127+00

MATCH LINE STA. 132+50

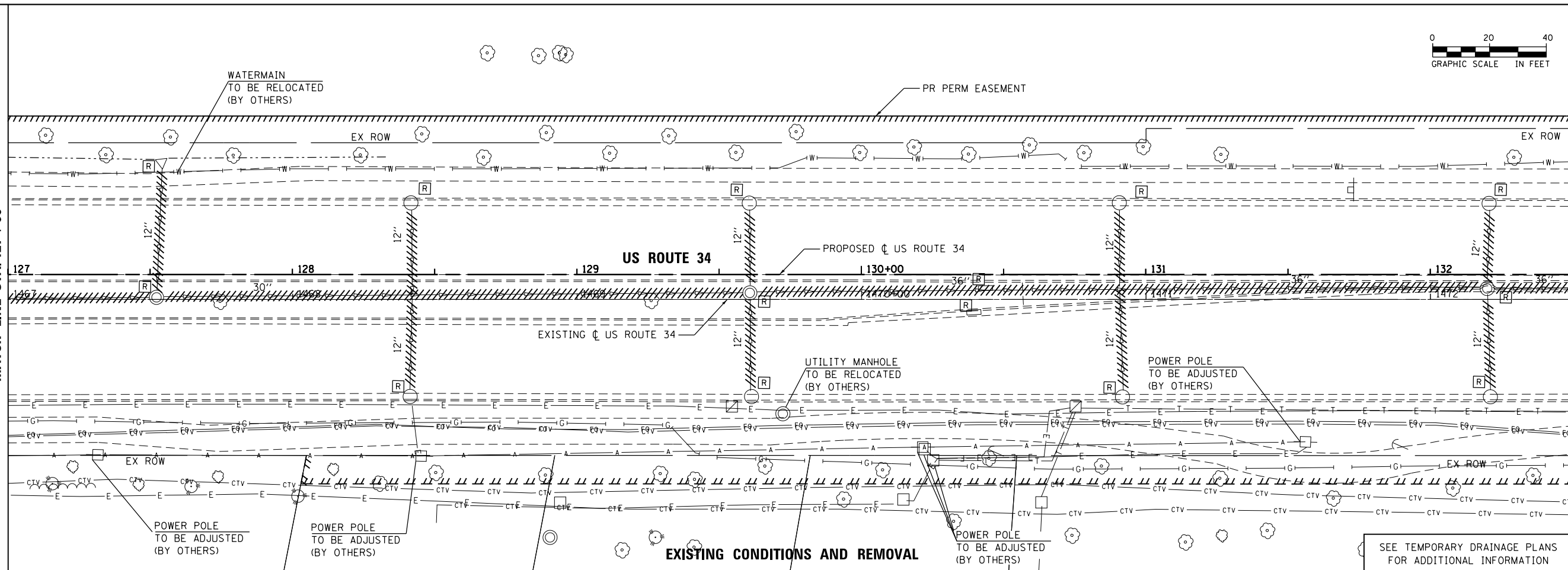

**EXISTING CONDITIONS AND REMOVAL**

MATCH LINE STA. 127+00

MATCH LINE STA. 132+50

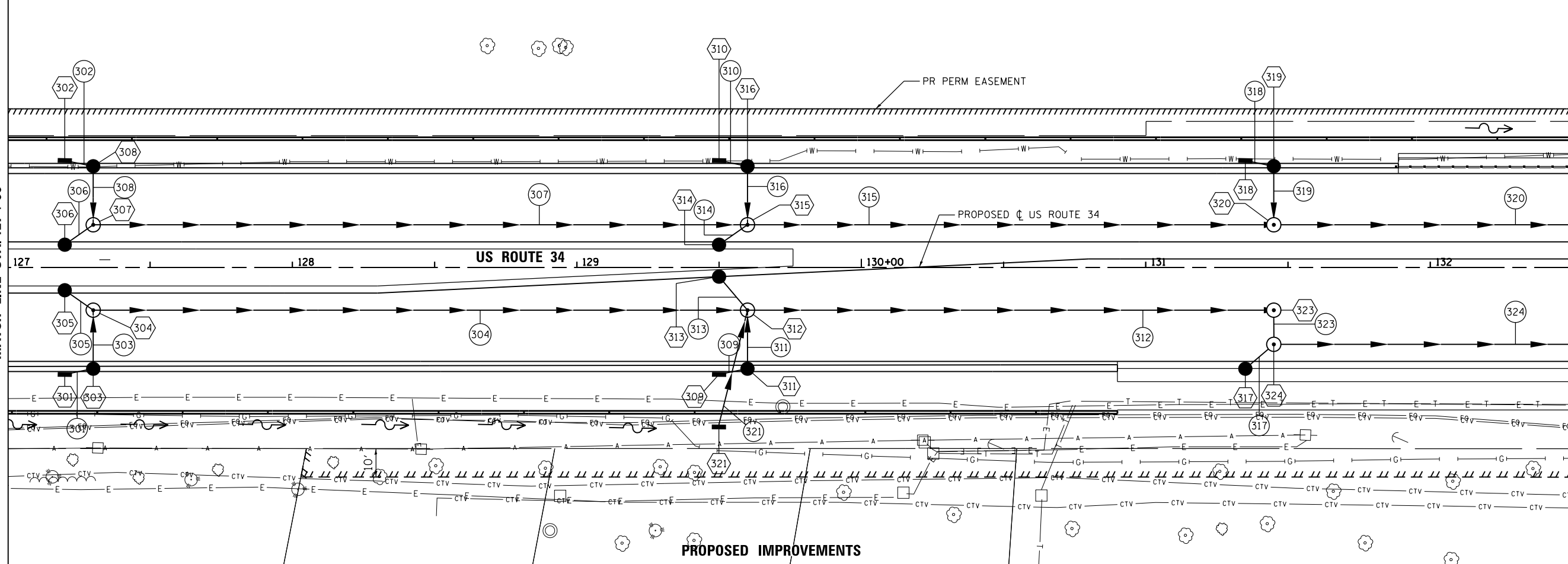

**PROPOSED IMPROVEMENTS**



USER NAME = URS	DESIGNED - MB	REVISED -
	DRAWN - KJB	REVISED -
PLOT SCALE = 48.0000' / in.	CHECKED - SPF	REVISED -
PLOT DATE = 02/28/2014	DATE - 02/28/2014	REVISED -

**STATE OF ILLINOIS  
DEPARTMENT OF TRANSPORTATION**

**DRAINAGE AND UTILITY PLAN  
US ROUTE 34**

SCALE: 20 SHEET NO. 6 OF 8 SHEETS STA. 127+00 TO STA. 132+50

F.A.P. RTE.	SECTION	COUNTY	TOTAL SHEETS	SHEET NO.
311	652-A	DUPAGE	383	97
CONTRACT NO. 60R06				
FED. ROAD DIST. NO. 1 ILLINOIS FED. AID PROJECT				

FILE NAME = Q:\1\DOT\_25368367\_US\_34.ctb; CN: P:\2\Drawings\Roadway\DrainageUtility\116161026-sht-Dr-am\_006.dgn