

ELEVATION

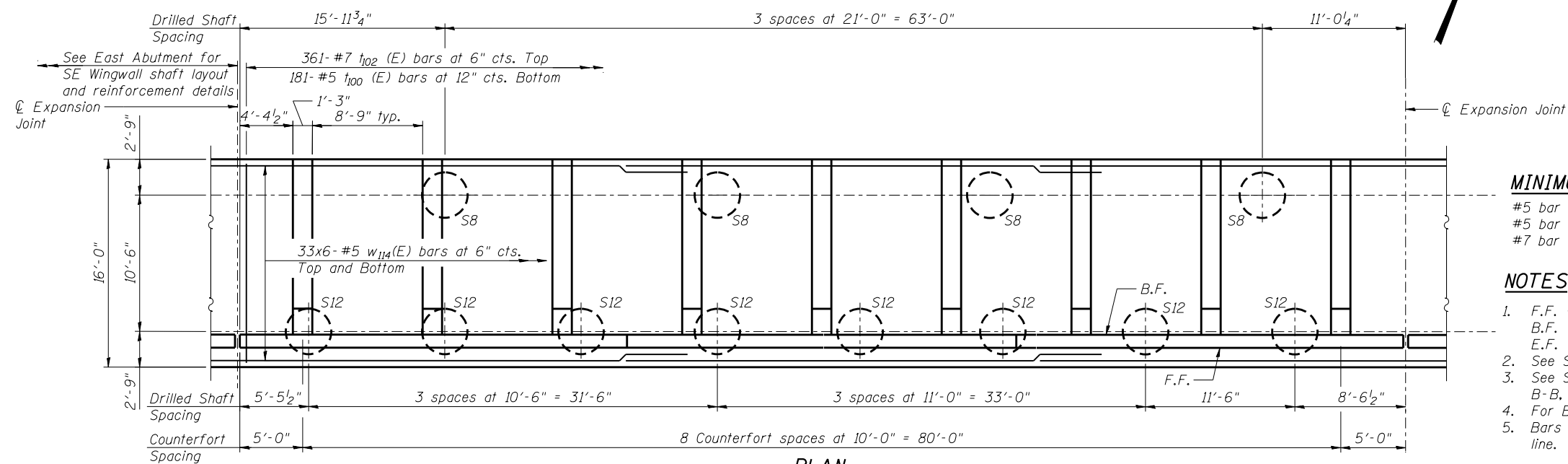

PLAN

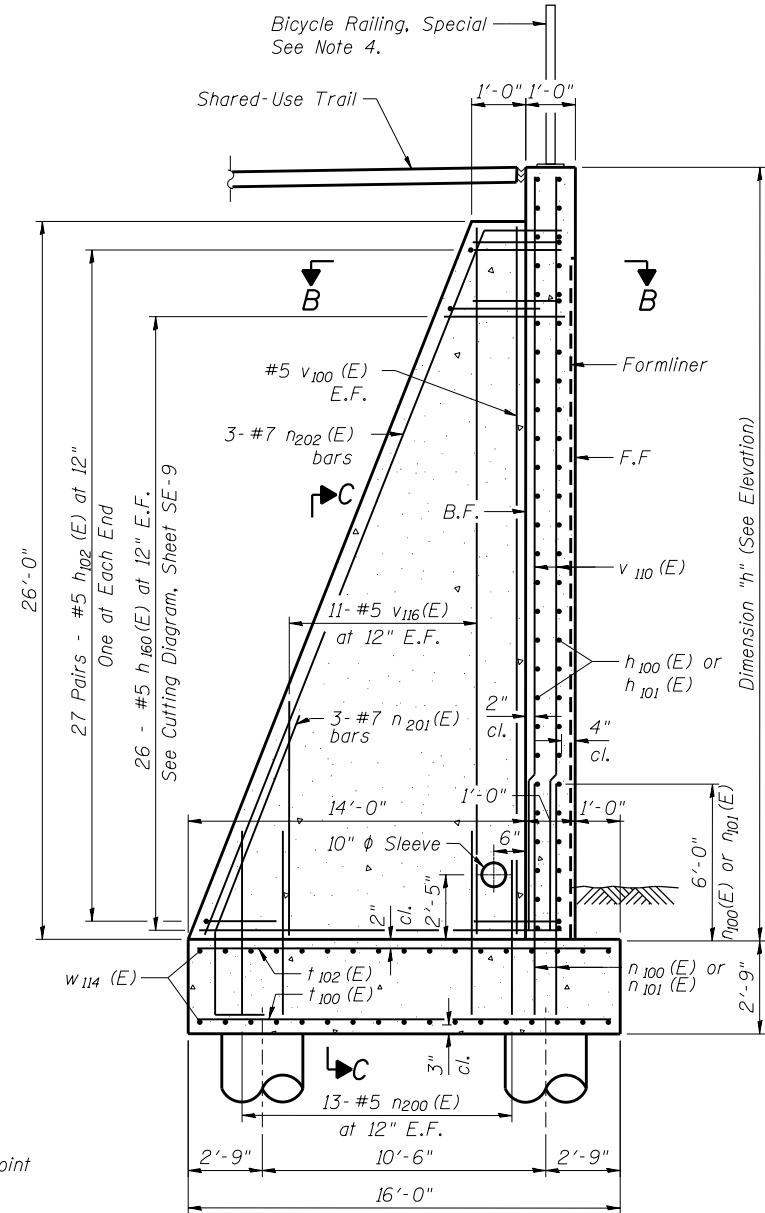

SECTION A-A

MINIMUM BAR LAP

- #5 bar = 2'-11" (Horizontal)
- #5 bar = 2'-7" (Vertical)
- #7 bar = 5'-2"

NOTES

1. F.F. - Denotes Front Face
B.F. - Denotes Back Face
E.F. - Denotes Each Face
2. See Sheet SE-2 for Bill of Material.
3. See Sheet SE-9 for Bar Bending Diagrams, Bill of Bars, Construction Joint, Section B-B, C-C, and Expansion Joint details.
4. For Bicycle Railing post location spacing, see General Plan and Elevation Sheet.
5. Bars indicated thus 20 x 3-#5 etc. indicates 20 lines of bars with 3 lengths per line.



USER NAME =
PLOT SCALE =
PLOT DATE = 02/28/2014

DESIGNED - KMP
CHECKED - AMK
DRAWN - KMP
CHECKED - AMK

REVISED
REVISED
REVISED
REVISED

STATE OF ILLINOIS
DEPARTMENT OF TRANSPORTATION

DETAIL PLAN AND ELEVATION 1
STRUCTURE NO. 022-W071

SHEET NO. SE-3 OF SE-15 SHEETS

F.A.P. RTE.	SECTION	COUNTY	TOTAL SHEETS	SHEET NO.
311	652-A	DuPAGE	383	268
CONTRACT NO. 60R06			ILLINOIS FED. AID PROJECT	