

ELEVATION

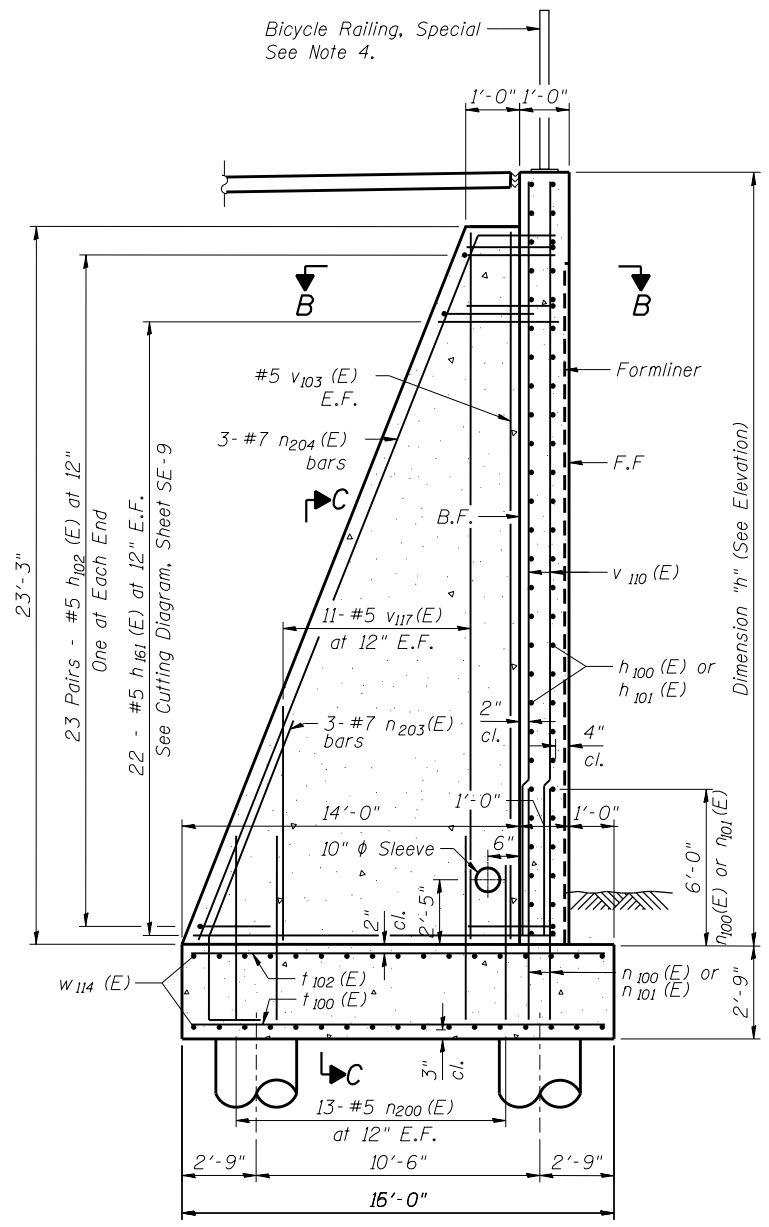

SECTION A-A

MINIMUM BAR LAP

- #5 bar = 2'-11" (Horizontal)
- #5 bar = 2'-7" (Vertical)
- #7 bar = 5'-2"

NOTES

- F.F. - Denotes Front Face
B.F. - Denotes Back Face
E.F. - Denotes Each Face
- See Sheet SE-2 for Bill of Material.
- See Sheet SE-9 for Bar Bending Diagrams, Bill of Bars, Construction Joint, Section B-B, C-C, and Expansion Joint details.
- For Bicycle Railing post location spacing, see General Plan and Elevation Sheet.
- Bars indicated thus 20 x 3-#5 etc. indicates 20 lines of bars with 3 lengths per line.

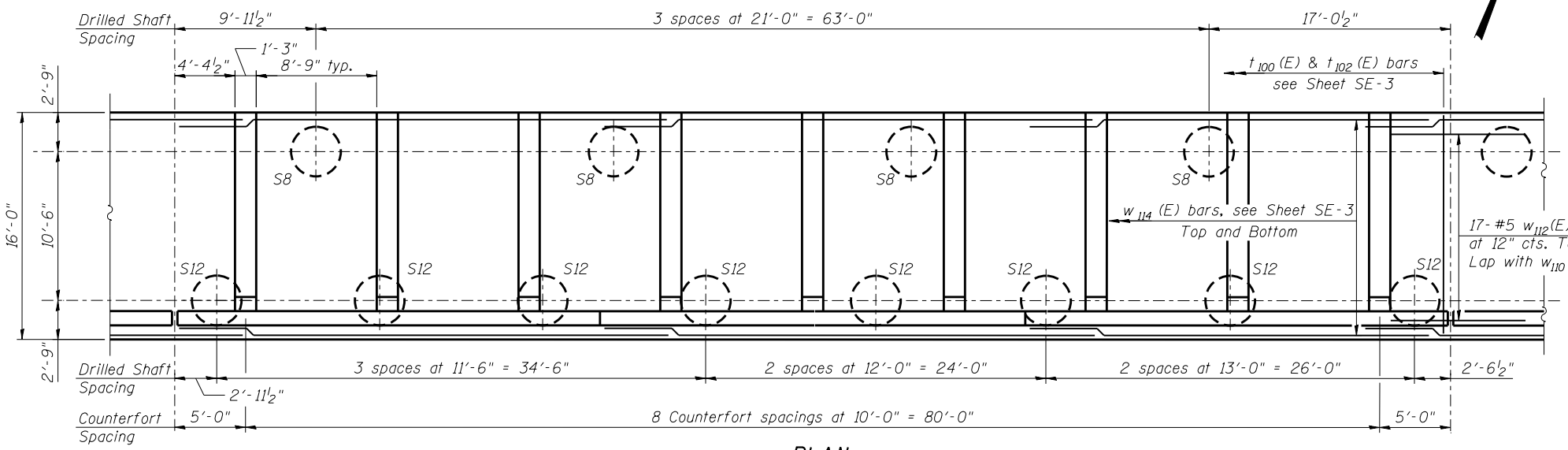

PLAN



USER NAME =	DESIGNED - KMP	REVISED
	CHECKED - AMK	REVISED
PLOT SCALE =	DRAWN - KMP	REVISED
PLOT DATE = 02/28/2014	CHECKED - AMK	REVISED

STATE OF ILLINOIS
DEPARTMENT OF TRANSPORTATION

DETAIL PLAN AND ELEVATION 2
STRUCTURE NO. 022-W071

SHEET NO. SE-4 OF SE-15 SHEETS

F.A.P. RTE.	SECTION	COUNTY	TOTAL SHEETS	SHEET NO.
311	652-A	DuPAGE	383	269
CONTRACT NO. 60R06				
ILLINOIS FED. AID PROJECT				