

ELEVATION

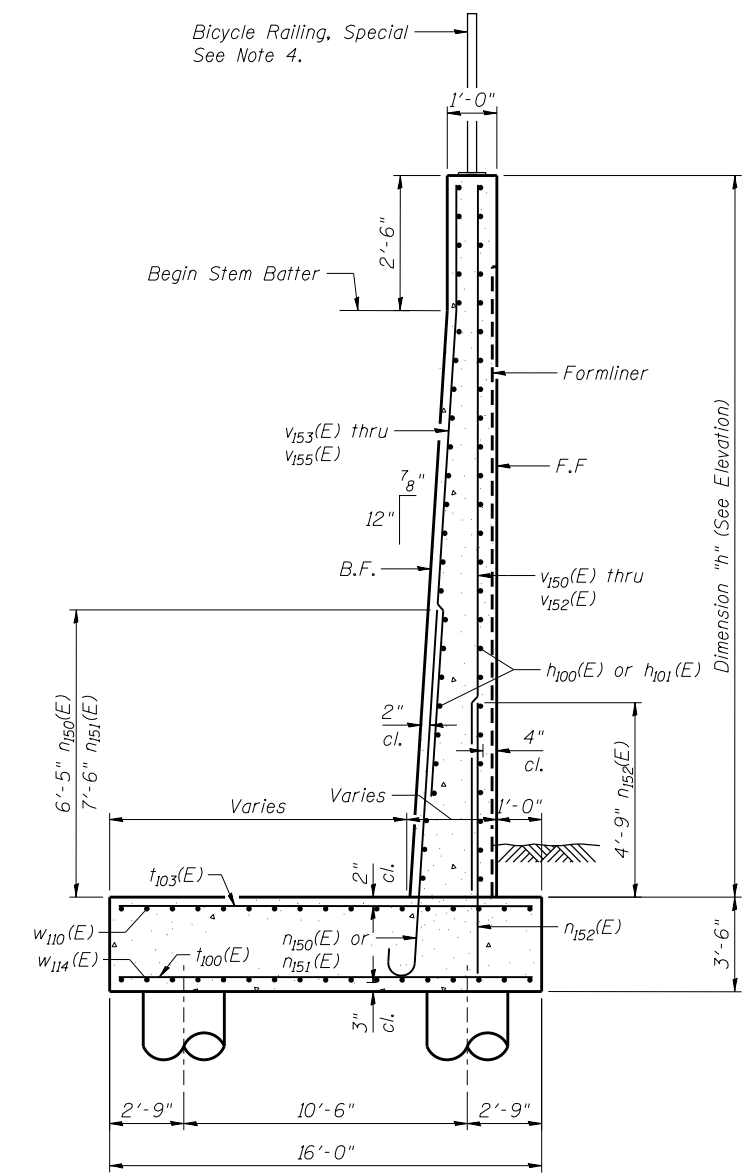

SECTION A-A

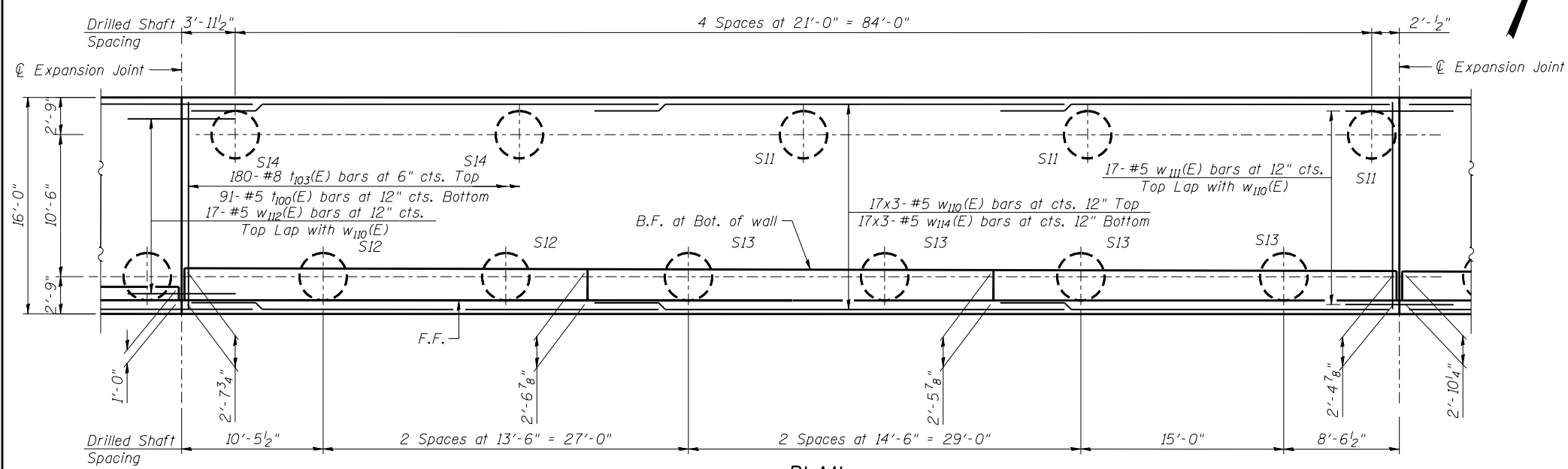

PLAN

MINIMUM BAR LAP

- #5 bar = 2'-7" (Vertical)
- #5 bar = 2'-11" (Horizontal)
- #7 bar = 4'-2"
- #8 bar = 5'-5"

NOTES

- F.F. - Denotes Front Face
B.F. - Denotes Back Face
E.F. - Denotes Each Face
- See Sheet SE-2 for Bill of Material.
- See Sheet SE-9 for Bar Bending Diagrams, Bill of Bars, Construction Joint, Section B-B, and Expansion Joint details.
- For Bicycle Railing post location spacing, see General Plan and Elevation Sheet.
- Bars indicated thus 20 x 3-#5 etc. indicates 20 lines of bars with 3 lengths per line.



| | | |
|------------------------|----------------|---------|
| USER NAME = | DESIGNED - KMP | REVISED |
| | CHECKED - AMK | REVISED |
| PLOT SCALE = | DRAWN - KMP | REVISED |
| PLOT DATE = 02/28/2014 | CHECKED - AMK | REVISED |

STATE OF ILLINOIS
DEPARTMENT OF TRANSPORTATION

DETAIL PLAN AND ELEVATION 3
STRUCTURE NO. 022-W071

SHEET NO. SE-5 OF SE-15 SHEETS

| | | | | |
|---------------------------|---------|--------|--------------|-----------|
| F.A.P. RTE. | SECTION | COUNTY | TOTAL SHEETS | SHEET NO. |
| 311 | 652-A | DuPAGE | 383 | 270 |
| CONTRACT NO. 60R06 | | | | |
| ILLINOIS FED. AID PROJECT | | | | |