

Benchmark: CP#3 - P.K. Rod in ground at driveway next to Nicor Gas pressure regulation station, Sta. 113+67.17, 50.22' Rt, Elev. 706.54.

Existing Structure: None. One lane of traffic in both directions to be maintained during construction utilizing stage construction and Temporary MSE Walls.

Salvage: None.

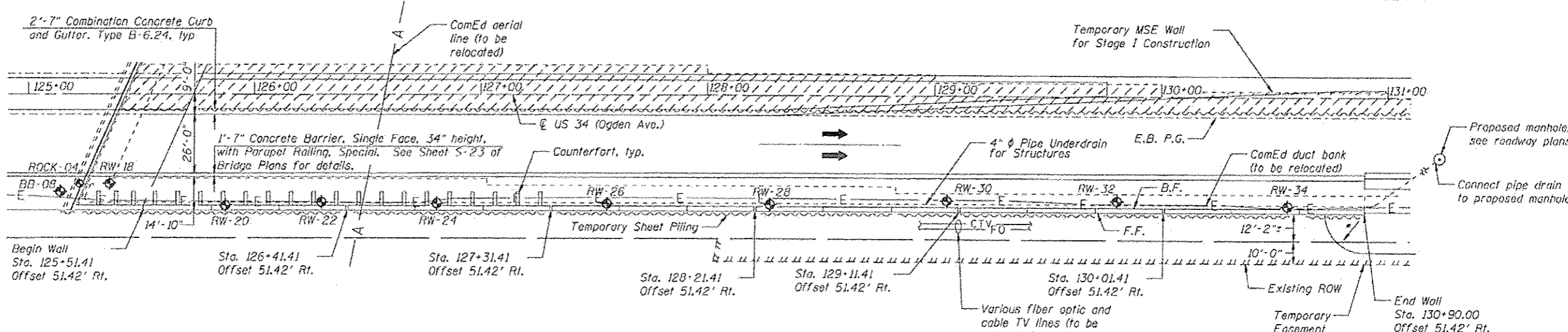
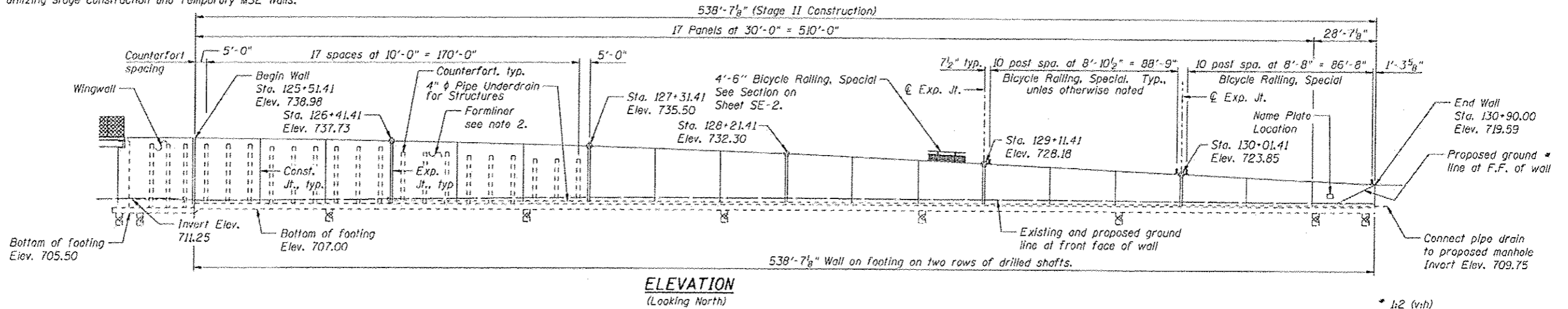

PLAN

APPROVED
For Structural Adequacy Only

Arslan M. Khan
Engineer of Bridges & Structures

STATION 125+51.41 TO 130+90.00
BUILT 20... BY
STATE OF ILLINOIS
F.A.P. RTE. 311 SEC. 652-A
LOADING HL-93
STR. NO. 022-W071

NAME PLATE
See Std. 515001



Arslan M. Khan
ARSALAN M. KHAN, S.E.
LICENSE NO.: 081-006258
EXPIRES: NOVEMBER 30, 2014
DATE: 02-26-2014

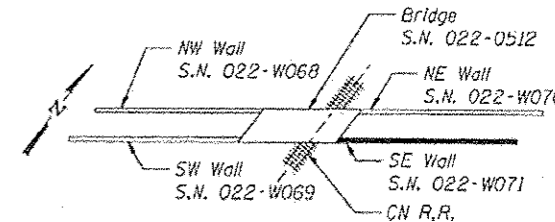

KEY PLAN

GENERAL PLAN & ELEVATION
SE RETAINING WALL - US 34 (OGDEN AVE.)
F.A.P. RTE. 311 - SECTION 652-A
DUPAGE COUNTY
STA. 125+51.41 TO STA. 130+90.00
STRUCTURE NO. 022-W071

NOTES

- All Offsets are taken from the $\text{C} \text{ US 34}$ to the front face of the retaining wall.
- Form liner textured surface shall be applied to the retaining walls. The finish shall consist of a rolled Ashlar Stone finish and shall have a minimum 0.75 in impression.

DESIGN SPECIFICATIONS
2012 AASHTO LRFD Bridge Design Specifications, 6th Edition

DESIGN STRESSES
FIELD UNITS

$f'_c = 3,500 \text{ psi}$
 $f_y = 60,000 \text{ psi (Reinforcement)}$

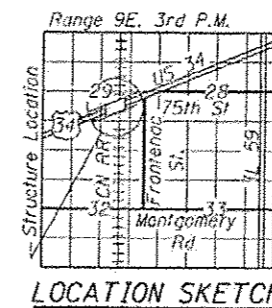

LOCATION SKETCH

LEGEND

- ◆ Soil Boring Location
- F.F. Front Face
- B.F. Back Face
- E.B. Eastbound
- W.B. Westbound
- ▨ Limits of reinforced soil mass

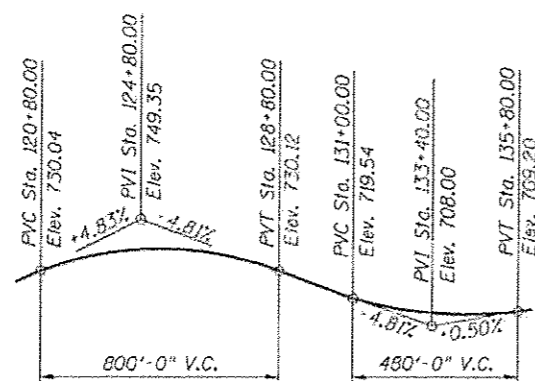

PROFILE GRADE - US 34
Along E.B. and W.B. P.G.'s



USER NAME *	DESIGNED - KMP/PMV	REVISED
PLLOT SCALE *	CHECKED - AMK	REVISED
PLLOT DATE * 03/19/2014	DRAWN - PMV	REVISED
	CHECKED - AMK	REVISED

STATE OF ILLINOIS
DEPARTMENT OF TRANSPORTATION

SHEET NO. SE-1 OF SE-15 SHEETS

F.A.P. RTE. 311	SECTION 652-A	COUNTY DuPAGE	TOTAL SHEETS 383	SHEET NO. 266
			CONTRACT NO. 60R06	

ILLINOIS DEPT. OF TRANSPORTATION