

CONTROL POINTS

C.P. NO.	NORTHING	EASTING	ELEVATION	STATION	OFFSET
202	1759370.664	1206074.429	636.556	303+65.63	0.47' RT
203	1759504.313	1205681.022	636.612	299+52.35	54.41' LT
204	1759499.546	1205280.671	637.862	295+68.16	46.26' RT
205	1759693.215	1204796.160	636.585	290+95.83	148.66' RT
206	1760040.128	1204667.834	630.484	287+68.51	52.60' RT
207	1760488.843	1204584.511	632.789	283+25.92	24.63' RT
208	1761095.166	1204576.295	632.824	277+19.92	23.31' RT
209	1761471.540	1204487.773	629.544	105+68.43*	57.06' RT*
210	1761938.962	1204452.349	630.308	268+69.43	51.52' LT
211	1762429.147	1204150.139	628.043	262+98.04	47.18' LT

\* STATION AND OFFSET FROM W. FRONTAGE ROAD

CURVE US 30-2 (US ROUTE 30)  
 PI STA. = 291+29.73  
 $\Delta = 76^\circ 29' 05''$  (LT)  
 $D = 5^\circ 30' 33''$   
 $R = 1,040.00'$   
 $T = 819.64'$   
 $L = 1,388.30'$   
 $E = 284.17'$   
 $e = \text{NORMAL CROWN (2.0\%)}$   
 P.C. STA. = 283+10.09  
 P.T. STA. = 296+98.39

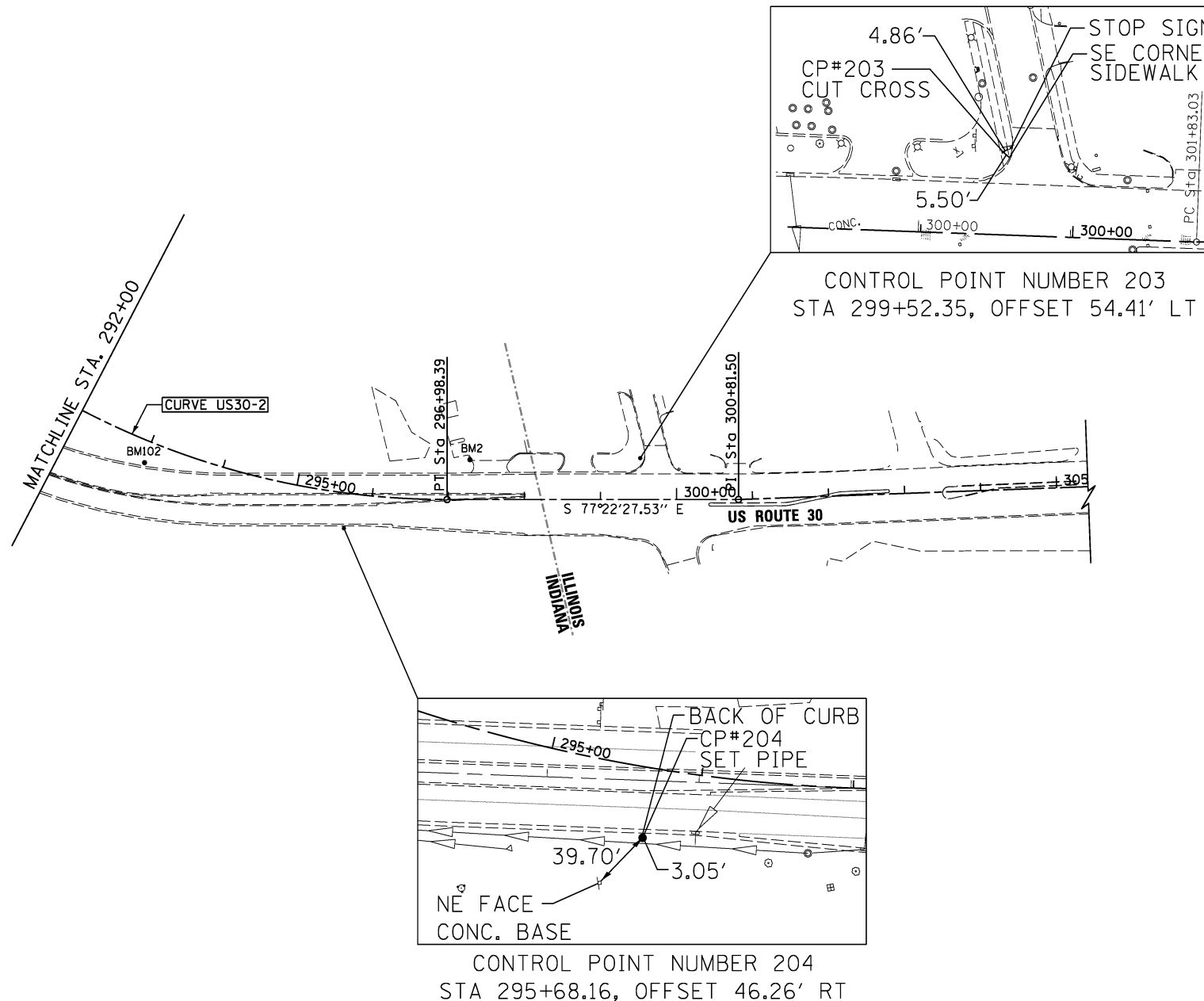

US30 AT EJ&E AND CN RAILROAD - ADJUSTED BENCHMARK ELEVATIONS

BENCHMARK	ELEVATION	DESCRIPTION
BM1	643.24	CUT "X" ON S. BOLT OF TRAFFIC SIGNAL AT N.E. CORNER OF JOLIET AND HART ST.
BM102	635.53	CUT SQUARE ON N.E. CORNER OF TRAFFIC SIGNAL MANHOLE, NEAR PT CURVE ALONG US-30 AND EAST OF SAUK TRAIL, ON NORTH SIDE OF US-30
BM103	633.67	CUT SQUARE AT CORNER OF TRAFFIC MANHOLE ON EAST SIDE OF US-30 AND EAST LINE OF SAUK TRAIL
BM2	637.03	CUT SQUARE ON CENTER OF SOUTH EDGE OF LIGHT POLE AT S.W. CORNER OF BP GAS STATION AT N.W. CORNER OF SUNNYSIDE AND JOLIET.
BM3	631.16	CUT SQUARE ON N.E. CORNER OF LARGE STRUCTURE SOUTH OF THE NORTH SET OF TRACKS (NS RAILROAD) AND NEAR THE EAST ROW LINE OF US-30
BM4	631.47	CUT SQUARE IN TOP OF WINGWALL AT THE N.W. CORNER OF US-30 BRIDGE OF NORTH DITCH ± STA. 257+66.51, 34.74' RT

• DATUM ADJUSTED TO STATIC GPS ELEVATION ON CPT 201 (ELEV. 641.32)

US ROUTE 30 ALIGNMENT

DESCRIPTION	STATION	NORTHING	EASTING
B.O.A.	260+00	1762656.94	1203952.24
P.C.	267+05.42	1762058.62	1204325.93
P.I.	272+06.26	1761633.83	1204591.24
P.T.	276+82.39	1761133.05	1204599.02
P.C.	283+10.09	1760505.43	1204608.76
P.I.	291+29.73	1759685.89	1204621.49
P.T.	296+98.39	1759506.73	1205421.31
P.I.	300+81.50	1759422.99	1205795.16
E.O.A.	305+00	1759346.60	1206206.63

SAUK TRAIL ALIGNMENT

DESCRIPTION	STATION	NORTHING	EASTING
B.O.A.	380+00	1759680.85	1204067.29
P.C.	382+56.94	1759648.08	1204322.13
P.I.	385+23.35	1759614.11	1204586.37
P.T.	387+58.39	1759787.34	1204788.78
E.O.A.	388+49.24	1759787.34	1204788.78

RELOC. ALPINE VILLAGE ENTRANCE

DESCRIPTION	STATION	NORTHING	EASTING
B.O.A.	500+00	1762019.08	1204349.92
P.C.	501+50.03	1762096.34	1204478.54
P.I.	501+74.26	1762108.82	1204499.31
P.T.	501+97.35	1762109.04	1204523.54
E.O.A.	502+77.35	1762109.79	1204603.53

W. FRONTAGE ROAD NORTH ALIGNMENT

DESCRIPTION	STATION	NORTHING	EASTING
B.O.A.	100+00	1762019.08	1204349.92
P.C.	100+69.86	1761983.11	1204290.03
P.I.	101+04.42	1761965.32	1204260.42
P.T.	101+30.34	1761931.32	1204266.58
P.C.	101+46.18	1761915.73	1204269.41
P.I.	101+66.69	1761895.90	1204273.08
P.T.	101+85.11	1761883.75	1204289.86
P.C.	102+40.00	1761852.19	1204334.76
P.I.	102+97.37	1761819.20	1204381.70
P.R.C.	103+51.74	1761766.34	1204404.01
P.I.	106+23.81	1761515.68	1204509.81
P.T.	108+89.19	1761243.64	1204514.04
E.O.A.	113+80.66	1760752.23	1204521.67

W. FRONTAGE ROAD SOUTH ALIGNMENT

DESCRIPTION	STATION	NORTHING	EASTING
B.O.A.	400+00	1760643.97	1760643.97
P.C.	403+11.98	1760332.24	1204530.30
P.I.	404+00.87	1760243.41	1204533.77
P.R.C.	404+89.21	1760156.92	1204554.33
P.I.	405+97.24	1760051.82	1204579.30
P.T.	407+04.41	1759943.81	1204580.98
P.C.	408+21.46	1759826.77	1204582.80
P.I.	408+96.37	1759751.87	1204583.96
P.T.	409+69.65	1759682.18	1759682.18

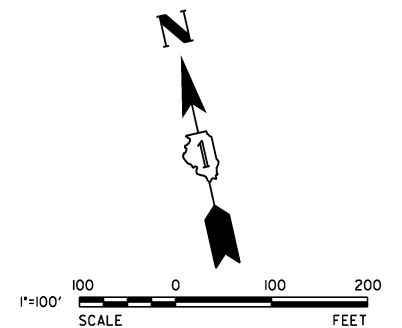

USER NAME = hshsh  
 PLOT SCALE = 100.0000' / 1" = 100'  
 PLOT DATE = 8/21/2013

DESIGNED - DTE  
 DRAWN - DRP  
 CHECKED - VJD  
 DATE - 08/14/2013

REVISED -  
 REVISED -  
 REVISED -  
 REVISED -

STATE OF ILLINOIS  
 DEPARTMENT OF TRANSPORTATION

U.S. ROUTE 30  
 ALIGNMENT, TIES AND BENCHMARKS  
 SCALE: 1" = 100' SHEET NO. 2 OF 2 SHEETS

F.A.P. RTE. 353 SECTION 11-Y-A COUNTY COOK TOTAL SHEETS 354 SHEET NO. 38 CONTRACT NO. 60R19 ILLINOIS FED. AID PROJECT